

# Lismore Public School

Information pack | August 2022



The NSW Department of Education is coordinating an emergency response effort that is unprecedented in terms of scale and impact. A large number of schools in the Northern Rivers Region have damage to either their entire site or some buildings and facilities.

At the peak of the flood events on Wednesday, 9 March 2022, 331 schools had temporarily ceased operations.

The local North Coast School Infrastructure NSW office inspected 87 schools in the region that sustained a degree of impact from flood waters.

Individual impact assessments were undertaken at 52 affected public school sites, each requiring the removal of rubbish, cleaning and securing to ensure they were safe for entry.

Lismore Public School suffered damage as a result of the flood events, with water entering lower lying buildings and playgrounds on the site.

# Lismore Public School

Lower lying grounds of the Lismore Public School site were inundated by flood water, with repair, remediation and refurbishment work now underway.

School Infrastructure NSW and Public Works are working with Lismore Public School to remediate the flood-damaged buildings and provide refurbished spaces to support student learning and teaching.

## What has happened so far?

- Students have remained at the school and continue to learn from unaffected learning spaces and facilities.
- The copy room (Building C), classrooms (Building D), and the hall and canteen (Building E) have been stripped out, cleaned, disinfected and made safe.
- Sub-flooring under Building C has high moisture levels and is being mechanically ventilated.
- Toilets and storerooms (Building L) have been hosed out, cleaned and disinfected, and made operational.
- The sports oval has been treated with lime and the shade structures (SS1, SS4 and SS5) cleaned and disinfected.
- A temporary building was installed on-site and is being used by Lismore Preschool.
- The main works contract was awarded in June 2022 to remediate flood-impacted facilities and spaces.

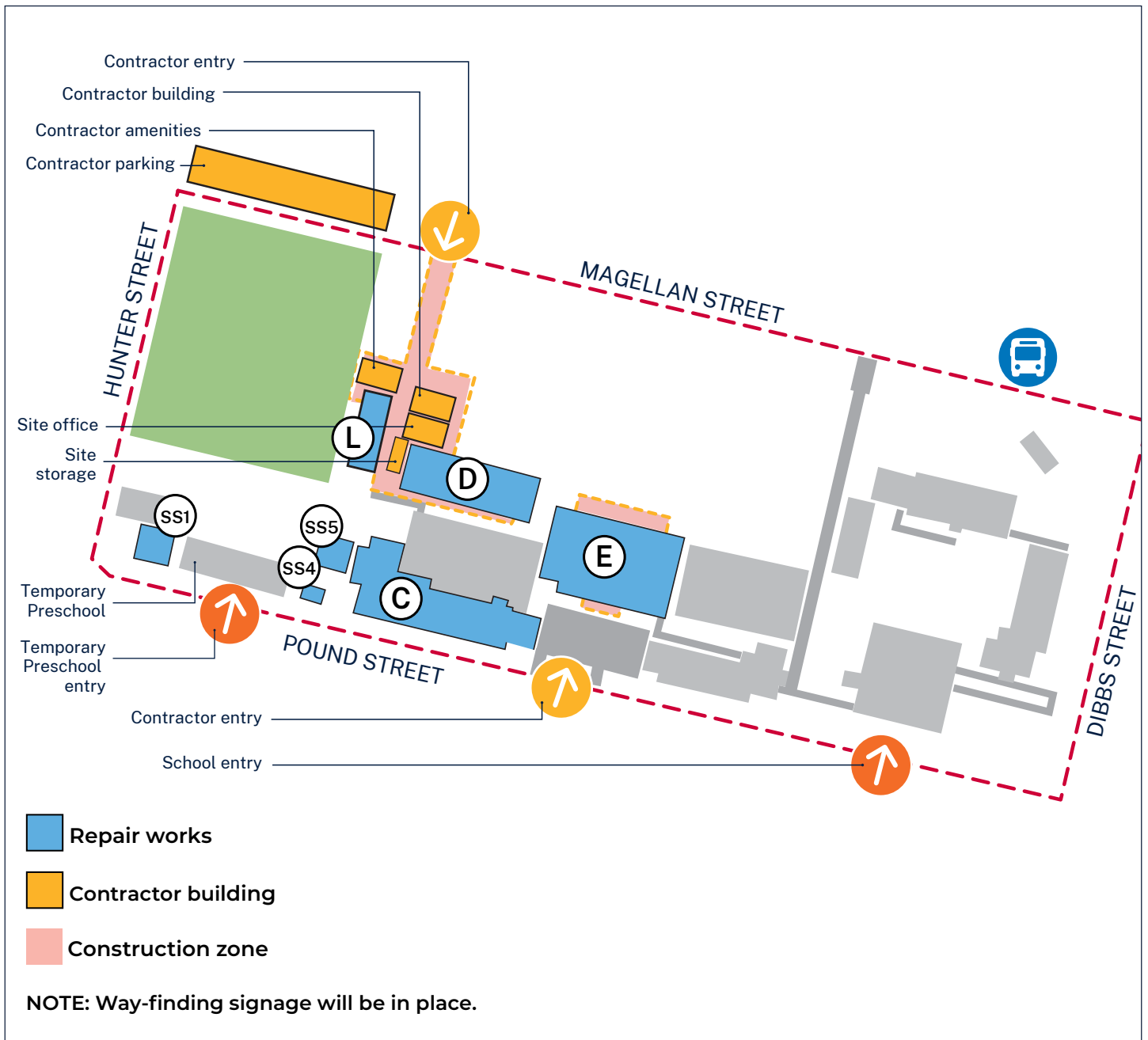

## What work is happening at Lismore Public School?

Work is expected to start mid Term 3, 2022 to repair flood-damaged rooms and outdoor spaces.

Building	Summary of works
<b>Copy room (Building C)</b>	<ul style="list-style-type: none"> <li>Mould remediation under the sub-flooring</li> <li>Drying out brickwork and sub-flooring</li> </ul>
<b>Classrooms (Building D)</b>	<ul style="list-style-type: none"> <li>Mould remediation</li> <li>Drying out brickwork</li> <li>Walls to be re-lined and interior painted</li> <li>Flooring remediated</li> <li>Fit-out (e.g. carpet, lighting, furniture, seating, desks, etc)</li> </ul>
<b>Hall and canteen (Building E)</b>	<ul style="list-style-type: none"> <li>Mould remediation</li> <li>Drying out brickwork</li> <li>Walls to be re-lined and interior painted</li> <li>Flooring remediated</li> <li>Fit-out (e.g. carpet, lighting, furniture, etc)</li> </ul>
<b>Shade structures (SS1, SS4, SS5)</b>	<ul style="list-style-type: none"> <li>Softfall being replaced</li> </ul>

### Modernising our school spaces for Lismore students and staff

- Flood-damaged building rooms will be modernised in line with the latest design standards for school spaces.
- The project team is working with Lismore Public School to provide flexible classroom layouts that meet future-focused learning models.
- Colour selections and furniture layout have been finalised after consultation with the school.

### Managing work on-site

Students will continue to learn from Lismore Public School while work is underway.

- Rigorous safety and security measures will be in place for the duration of the work.
- Security fencing and hoarding will be installed to separate the construction site from the rest of the school.
- Contractors will enter the site via dedicated entryways and have designated parking.
- The project team will work with the school to ensure activity is scheduled to avoid busy times and important events, as much as possible.



## How long will the work take?

We anticipate work to be completed in early 2023, pending site and weather conditions.



Note: Ongoing weather, supply chain and contractor shortages are also affecting building projects across the Northern Rivers region.



## Keeping you informed

Work at Lismore Public School is being managed by School Infrastructure NSW and Public Works and co-ordinated by the building contractor.

We are committed to working with the Lismore community throughout the project lifecycle.

Standard working hours will be 7am to 5pm, Monday to Saturday. No work will take place on Sundays or public holidays, however, if there's a need (e.g. safely remediating contaminated materials), the community will be notified.

Neighbours and the community will be notified of any work that has the potential to impact surrounding roads.

School Infrastructure NSW will continue to share information with the Lismore community as work progresses, through regular project updates.

We thank you for your patience during this important work.

## Contact us



### Website

Stay up to date by visiting the School Infrastructure NSW website [schoolinfrastructure.nsw.gov.au](https://schoolinfrastructure.nsw.gov.au)



### Email

Contact the Community Engagement team by emailing [schoolinfrastructure@det.nsw.edu.au](mailto:schoolinfrastructure@det.nsw.edu.au)



### Phone

Contact us between 9:00am and 5:00pm, Monday to Friday on **1300 482 651**