

VENTILATION AUDIT REPORT Version 2

SCHOOL:	Newcastle Senior School (5511)
AMU REGION:	Hunter/Central Coast
STATE ELECTORATE:	Wallsend
LOCAL GOVERNMENT AREA:	Newcastle

5511 - Newcastle Senior School
Site Plan (12028)

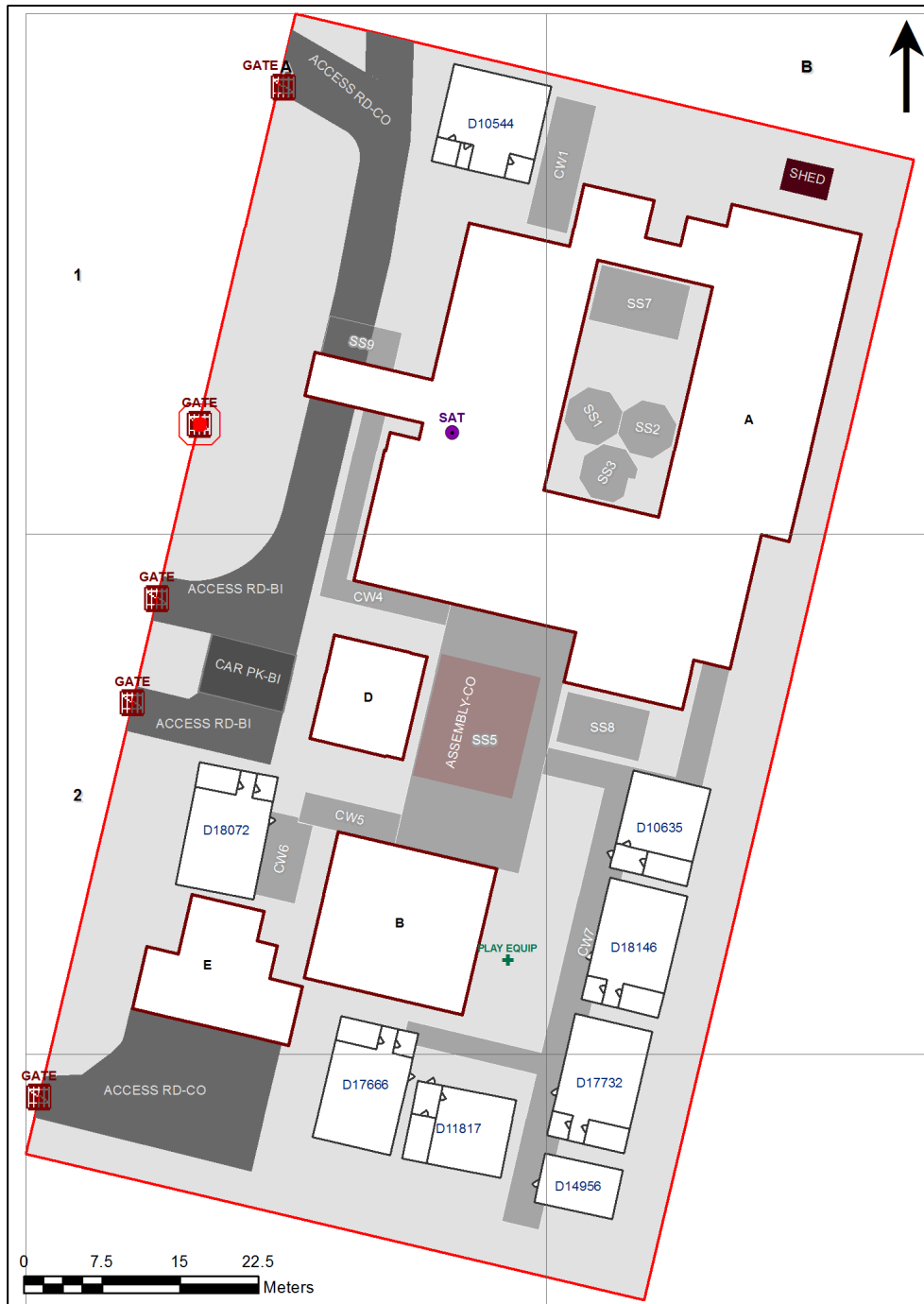

1:455

Printed: 21-Mar-2020

Site plan is indicative only and is included to show building numbers used by the Department.

Ventilation Audit Key

Category	Description
	Category A Operate this space in line with COVID safe school operations . It has the required level of natural ventilation. NB. Circulation and storage areas should not be used for groups or gatherings.
	Category B This space should be occupied at 1 person per 4m ² to comply with COVID safe school operations and the guided use of spaces . The report details the number of people who can be accommodated safely in each of the identified spaces.

Entity Location	Audit Condition Classification (Capacity)	Comment
B00A - R0009 - Staff Room Annexe - (11.86 SQM)	Office (2)	
B00A - R0019 - Practical Activities - P - 1hb - (6.44 SQM)	Student Space (2)	
B00A - R0020 - Home Base - P - (58.75 SQM) - Teaching Space: 1	Student Space (67)	
B00A - R0022 - Home Base - P - (59.09 SQM) - Teaching Space: 1	Student Space (67)	
B00A - R0023 - Practical Activities - P - 1hb - (7.02 SQM)	Student Space (3)	
B00A - R0028 - Practical Activities - P - 1hb - (7.25 SQM)	Student Space (3)	
B00A - R0029 - Movement - (11.02 SQM)	Not Applicable	Circulation or storage space.
B00A - R0030 - Home Base - P - (76.09 SQM) - Teaching Space: 1	Student Space (67)	
B00A - R0032 - Entry Vestibule - (13.67 SQM)	Not Applicable	Circulation or storage space.
B00A - R0036 - Staff Room - (27.66 SQM)	Office (6)	
B00A - R0039 - Principal - (17.01 SQM)	Office (4)	
B00A - R0040 - Clerical Office - (13.85 SQM)	Office (3)	
B00A - R0041 - Movement - (13.4 SQM)	Not Applicable	Circulation or storage space.
B00A - R0042 - Movement - (334.84 SQM)	Not Applicable	Circulation or storage space.
B00A - R0043 - Movement - (24.4 SQM)	Not Applicable	Circulation or storage space.
B00A - R0046 - Staff Kitchen - (63.82 SQM)	Office (15)	
B00A - R0047 - Outdoor Learning Area - (27.79 SQM)	Not Applicable	Circulation or storage space.
B00B - R0005 - Movement - (11.17 SQM)	Not Applicable	Circulation or storage space.
B00B - R0006 - Hydrotherapy - Pool - (169.08 SQM)	Not Applicable	Circulation or storage space.
B00D - R0002 - Reading Area - (60.86 SQM)	Student Space (28)	
NS 120 10544 - NS 120 10544 - Learning Unit Primary Single - PWD - (76 SQM)	Student Space (35)	
OS 621 17666 - OS 621 17666 - Learning Unit Single - PWD - (95 SQM)	Student Space (44)	
OS 621 17732 - OS 621 17732 - Learning Unit Single - PWD - (95 SQM)	Student Space (44)	
OS 621 18072 - OS 621 18072 - Learning Unit Single - PWD - (95 SQM)	Student Space (44)	
OS 621 18146 - OS 621 18146 - Learning Unit Single - PWD - (95 SQM)	Student Space (44)	