

<b>SCHOOL:</b>	<b>Mungindi Central School (2675)</b>
<b>AMU REGION:</b>	<b>North Western NSW</b>
<b>STATE ELECTORATE:</b>	<b>Northern Tablelands</b>
<b>LOCAL GOVERNMENT AREA:</b>	<b>Moree Plains</b>

2675 - Mungindi Central School  
Site Plan (10087)

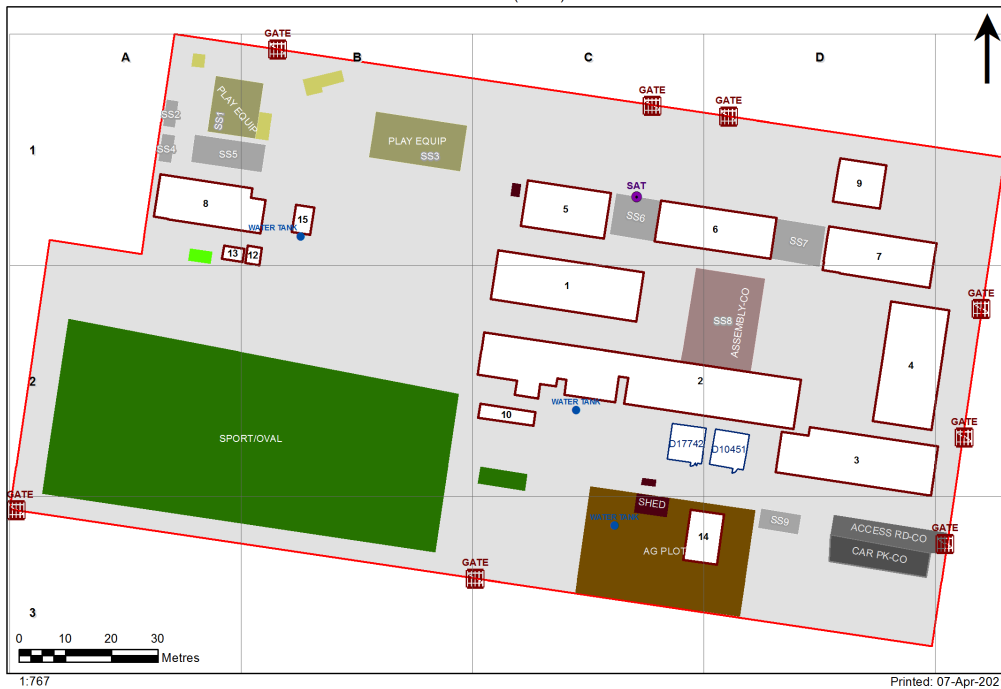

Site plan is indicative only and is included to show building numbers used by the Department.

## Ventilation Audit Key

Category	Description
	Category A Operate this space in line with <a href="#">COVID safe school operations</a> . It has the required level of natural ventilation. NB. Circulation and storage areas should not be used for groups or gatherings.
	Category B This space should be occupied at 1 person per 4m <sup>2</sup> to comply with <a href="#">COVID safe school operations and the guided use of spaces</a> . The report details the number of people who can be accommodated safely in each of the identified spaces.

Entity Location	Audit Condition Classification (Capacity)	Comment
B001 - R0001 - Movement - (70.83 SQM)	Not Applicable	Circulation or storage space.
B001 - R0009 - Home Base - (88.62 SQM) - Teaching Space: 1	● Student Space (156)	
B001 - R0010 - Home Base - (58.94 SQM) - Teaching Space: 1	● Student Space (32)	
B002 - R0001 - Movement - (159.89 SQM)	Not Applicable	Circulation or storage space.
B002 - R0007 - Staff Kitchen - (14.42 SQM)	● Office (3)	
B002 - R0008 - Food Technology L.S. - (72.97 SQM) - Teaching Space: 1	● Student Space (40)	
B002 - R0012 - Materials Technology L.S. - (111.3 SQM) - Teaching Space: 1	● Student Space (61)	
B002 - R0013 - Welding Area - (5.51 SQM)	Not Applicable	Circulation or storage space.
B002 - R0017 - Art Learning Space - (85.8 SQM) - Teaching Space: 1	● Student Space (39)	
B002 - R0018 - Clerical Office - (14.25 SQM)	● Office (3)	
B002 - R0019 - Staff Room Annexe - (19.4 SQM)	● Office (4)	
B002 - R0025 - General Learning Space - (41.38 SQM) - Teaching Space: 1	● Student Space (56)	
B003 - R0001 - Movement - (51.55 SQM)	Not Applicable	Circulation or storage space.
B003 - R0002 - Withdrawal Space - 1hb - (17.89 SQM)	● Student Space (8)	
B003 - R0005 - Reading Area - (163.03 SQM)	● Student Space (75)	
B003 - R0008 - Staff Room Annexe - (37.08 SQM)	● Office (9)	
B003 - R0009 - Movement - (7.18 SQM)	Not Applicable	Circulation or storage space.
B004 - R0001 - Movement - (77.18 SQM)	Not Applicable	Circulation or storage space.
B004 - R0002 - Canteen - (20.21 SQM)	Not Applicable	Circulation or storage space.
B004 - R0006 - Staff Room - (35.06 SQM)	● Office (8)	
B004 - R0007 - Interview - (18.28 SQM)	● Office (4)	
B004 - R0008 - Movement - (25.18 SQM)	Not Applicable	Circulation or storage space.
B004 - R0009 - Clerical Office - (14.24 SQM)	● Office (3)	
B004 - R0012 - Principal - (17.74 SQM)	● Office (4)	
B004 - R0013 - Duplicating Workroom - (13.39 SQM)	● Office (3)	
B004 - R0018 - Movement - (6.58 SQM)	Not Applicable	Circulation or storage space.
B004 - R0019 - Movement - (27.63 SQM)	Not Applicable	Circulation or storage space.
B005 - R0001 - Movement - (40.91 SQM)	Not Applicable	Circulation or storage space.
B005 - R0004 - Home Base - (53.57 SQM) - Teaching Space: 1	● Student Space (29)	
B005 - R0005 - Home Base - (53.57 SQM) - Teaching Space: 1	● Student Space (126)	
B005 - R0006 - Staff Study - (22.35 SQM)	● Office (5)	
B006 - R0004 - Movement - (12.79 SQM)	Not Applicable	Circulation or storage space.
B006 - R0008 - Movement - (7.17 SQM)	Not Applicable	Circulation or storage space.
B006 - R1001 - Movement - (31.94 SQM)	Not Applicable	Circulation or storage space.
B006 - R1003 - General Learning Space - (46.39 SQM) - Teaching Space: 1	● Student Space (103)	
B006 - R1004 - General Learning Space - (46.79 SQM) - Teaching Space: 1	● Student Space (75)	
B006 - R1005 - Computer Learning Space - (47.49 SQM) - Teaching Space: 1	● Student Space (26)	
B006 - R1006 - Staff Room Annexe - (23.89 SQM)	● Office (5)	
B007 - R0001 - Movement - (17.45 SQM)	Not Applicable	Circulation or storage space.
B007 - R0002 - Music Learning Space - (57.67 SQM) - Teaching Space: 1	● Student Space (31)	
B007 - R0005 - Laboratory L.S. - (82.76 SQM) - Teaching Space: 1	● Student Space (46)	
B007 - R0010 - Preparation - (26.53 SQM)	Not Applicable	Circulation or storage space.
B008 - R0001 - Movement - (61.87 SQM)	Not Applicable	Circulation or storage space.
B008 - R0006 - Staff Room - (10.03 SQM)	● Office (2)	
B008 - R0007 - Practical Activities - Pre - (5.05 SQM)	● Student Space (2)	
B008 - R0008 - Home Base - Pre - (92.58 SQM) - Teaching Space: 1	● Student Space (75)	
B009 - R0001 - Communal Space - (61.5 SQM)	● Student Space (28)	
OS 712 10451 - OS 712 10451 - TTC/Hospitality - (57 SQM)	● Student Space (26)	

Entity Location	Audit Condition Classification (Capacity)	Comment
OS 771 17742 - OS 771 17742 - TTC/Metal Technology - (57 SQM)	 Student Space (26)	