

Windsor High School

Works notification | 24 November 2025

Dear staff, parents and carers,

Works are underway to construct a new shed at Windsor High School to house its award-winning goats.

Located beside the oval next to Building AC, the new goat shed will accommodate the school's show goats and chickens, while also providing storage space and a small office with associated amenities.

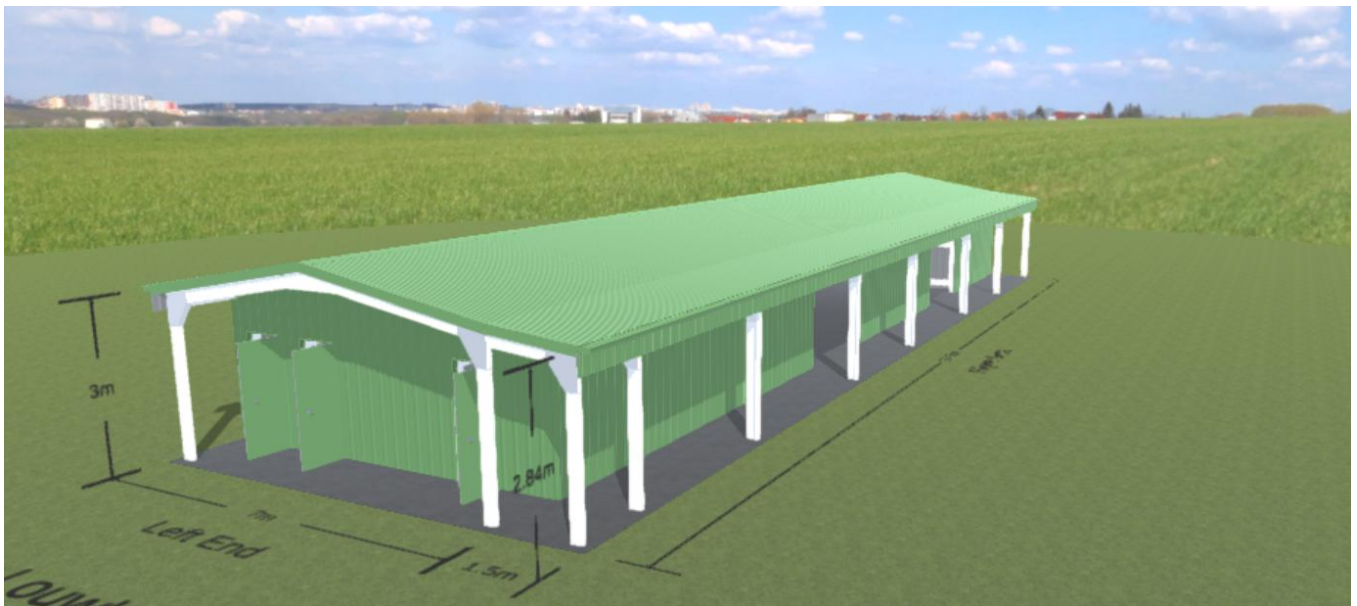

Artist impression of goat shed, subject to change

What works will be undertaken at the school?

Due for completion mid-March 2026, all work on the new shed will be carried out between 7 am and 5 pm Monday to Friday and on Saturdays between the hours of 8 am and 1 pm, in line with NSW Environment Protection Authority guidelines.

Site establishment is currently in progress, while fencing is put in place and sediment control is finalised. Works to excavate trenches and install concrete slabs will take place throughout December 2025 and January 2026.

The site will remain isolated from students and staff, and the oval will have fencing installed to prevent access. There will be no disruption to regular school activities, and all work will be carried out in accordance with work health and safety laws.



Email: schoolinfrastructure@det.nsw.edu.au
Phone: 1300 482 651
schoolinfrastructure.nsw.gov.au

Safety measures including sediment control, construction site hoarding and fencing will be in place throughout the project. Personal protective equipment will be worn by all contractors onsite.

The health, safety, and wellbeing of all members of our school and the local community are our highest priorities. We will keep the community updated.

Thank you for your cooperation during this important work.

Did you know?

The NSW Government is committed to expanding high potential and gifted education (HPGE) opportunities in NSW public schools. This includes a multi-million-dollar investment into the HPGE Partner School Program.

Under the program, 33 high schools including Windsor High School will receive facility upgrades to accommodate increased enrolments, broaden educational opportunities and facilitate the delivery of tailored HPGE offerings.

You can find more information about the project by scanning the QR code opposite.

