

# VENTILATION AUDIT REPORT

<b>SCHOOL:</b>	<b>Yennora Public School (3986)</b>
<b>AMU REGION:</b>	<b>South Western Sydney</b>
<b>STATE ELECTORATE:</b>	<b>Fairfield</b>
<b>LOCAL GOVERNMENT AREA:</b>	<b>Fairfield</b>

3986 - Yennora Public School  
Site Plan (12923)

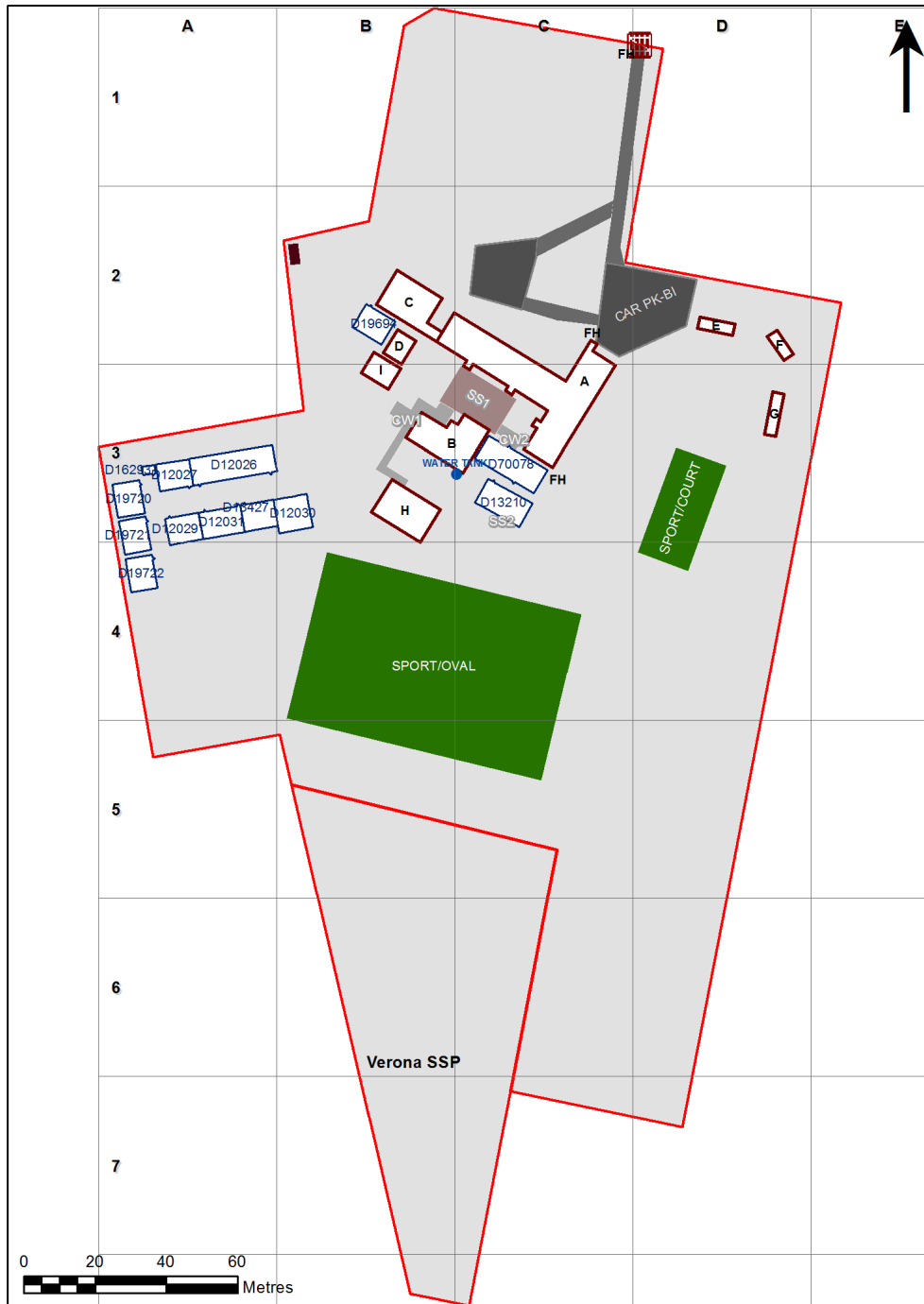

1:1,330

Printed: 24-Dec-2020

## Ventilation Audit Key

Category	Description
	Category A Operate this space in line with <a href="#">COVID safe school operations</a> . It has the required level of natural ventilation. NB. Circulation and storage areas should not be used for groups or gatherings.
	Category B This space should be occupied at 1 person per 4m <sup>2</sup> to comply with <a href="#">COVID safe school operations and the guided use of spaces</a> . The report details the number of people who can be accommodated safely in each of the identified spaces.

Entity Location	Audit Condition Classification (Capacity)	Comment
B00A - R0001 - Special Programs Room - (53.59 SQM)	● Student Space (24)	
B00A - R0002 - Home Base - (53.59 SQM) - Teaching Space: 1	● Student Space (24)	
B00A - R0006 - Home Base - (53.3 SQM) - Teaching Space: 1	● Student Space (24)	
B00A - R0010 - Home Base - (53.44 SQM) - Teaching Space: 1	● Student Space (24)	
B00A - R0012 - Movement - (49.63 SQM)	Not Applicable	Circulation or storage space.
B00A - R0013 - Movement - (13.67 SQM)	Not Applicable	Circulation or storage space.
B00A - R0015 - Movement - (64.68 SQM)	Not Applicable	Circulation or storage space.
B00A - R0018 - Home Base - (53.59 SQM) - Teaching Space: 1	● Student Space (24)	
B00A - R0019 - Home Base - (53.59 SQM) - Teaching Space: 1	● Student Space (24)	
B00A - R0024 - Sick Bay - (6.64 SQM)	● Student Space (3)	
B00A - R0026 - Home Base - (53.59 SQM) - Teaching Space: 1	● Student Space (24)	
B00A - R0027 - Home Base - (53.59 SQM) - Teaching Space: 1	● Student Space (24)	
B00B - R0011 - Home Base - (79.19 SQM) - Teaching Space: 1	● Student Space (36)	
B00B - R0014 - Interview - (15.76 SQM)	● Office (3)	
B00B - R0016 - Movement - (12.46 SQM)	Not Applicable	Circulation or storage space.
B00C - R0001 - Movement - (14.11 SQM)	Not Applicable	Circulation or storage space.
B00C - R0006 - Practical Activities - 1hb - (9.27 SQM)	● Student Space (4)	
B00C - R0007 - Home Base - (79.4 SQM) - Teaching Space: 1	● Student Space (36)	
B00D - R0001 - Canteen - (20.17 SQM)	Not Applicable	Circulation or storage space.
B00H - R0002 - Reading Area - (91.45 SQM)	● Student Space (42)	
NS 120 12030 - NS 120 12030 - Learning Unit Primary Single - PWD - (76 SQM)	● Student Space (35)	
OS 503 70078 - OS 503 70078 - Admin Lib Staff/Principal/Clerk/Store - (152 SQM)	● Office (38)	
OS 510 13210 - OS 510 13210 - Staff Common Room - (114 SQM)	● Office (28)	
OS 601 12027 - OS 601 12027 - Learning Unit - Standard/Withdrawal - (76 SQM)	● Student Space (35)	
OS 601 12029 - OS 601 12029 - Learning Unit - Standard/Withdrawal - (76 SQM)	● Student Space (35)	
OS 601 13427 - OS 601 13427 - Learning Unit - Standard/Withdrawal - (76 SQM)	● Student Space (35)	
OS 601 19720 - OS 601 19720 - Learning Unit - Standard/Withdrawal - (76 SQM)	● Student Space (35)	
OS 601 19721 - OS 601 19721 - Learning Unit - Standard/Withdrawal - (76 SQM)	● Student Space (35)	
OS 601 19722 - OS 601 19722 - Learning Unit - Standard/Withdrawal - (76 SQM)	● Student Space (35)	
OS 602 19694 - OS 602 19694 - Learning Unit - Standard With P.A.A. - (76 SQM)	● Student Space (35)	
OS 614 12026 - OS 614 12026 - Learning Unit - Double Kindergarten - (190 SQM)	● Student Space (88)	