

VENTILATION AUDIT REPORT

SCHOOL:	Yagoona Public School (3869)
AMU REGION:	South Western Sydney
STATE ELECTORATE:	Bankstown
LOCAL GOVERNMENT AREA:	Canterbury-Bankstown

3869 - Yagoona Public School
Site Plan (10852)

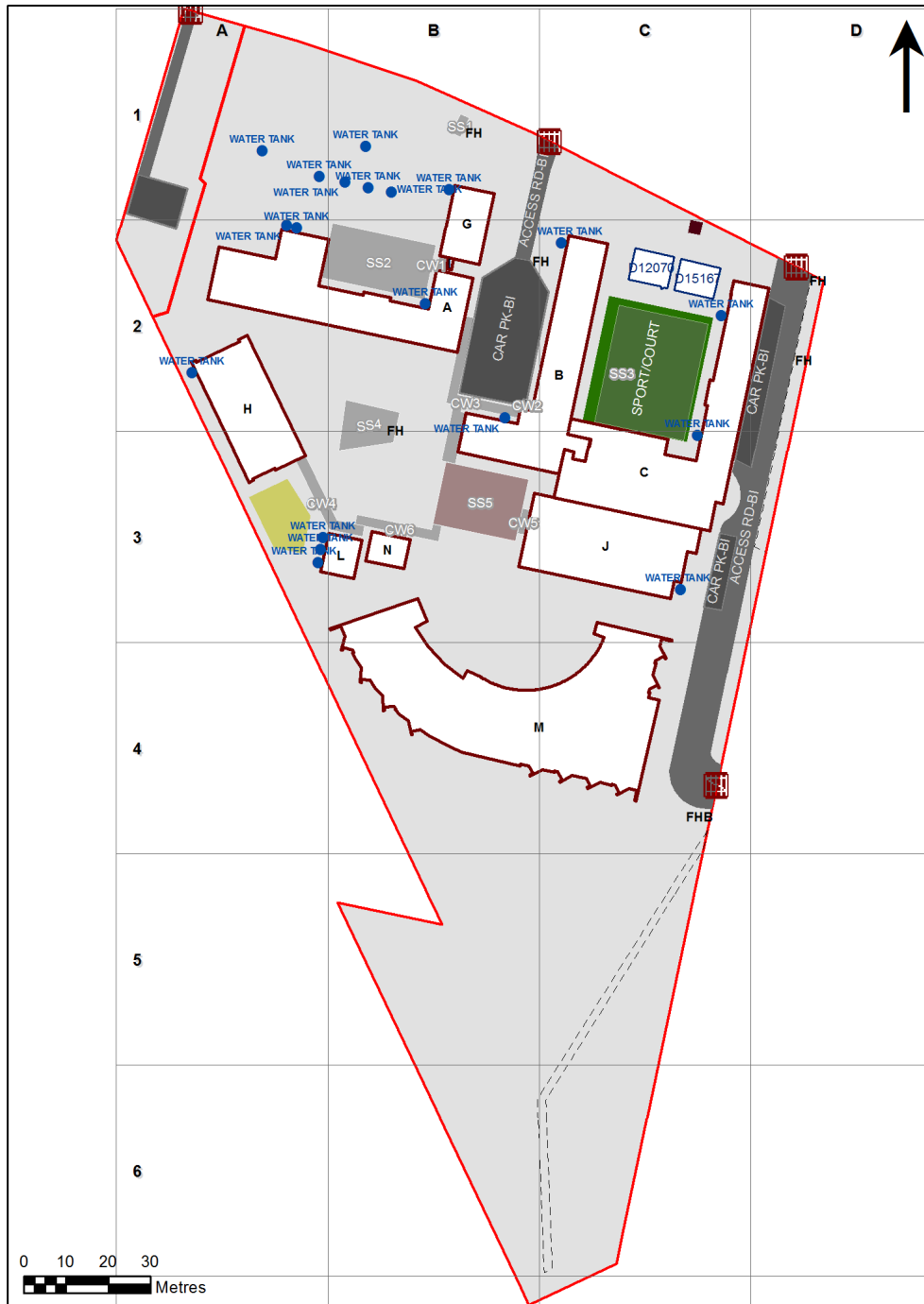

1:1,121

Printed: 27-May-2021

Ventilation Audit Key

Category	Description
	Category A Operate this space in line with COVID safe school operations . It has the required level of natural ventilation. NB. Circulation and storage areas should not be used for groups or gatherings.
	Category B This space should be occupied at 1 person per 4m ² to comply with COVID safe school operations and the guided use of spaces . The report details the number of people who can be accommodated safely in each of the identified spaces.

Entity Location	Audit Condition Classification (Capacity)	Comment
B00A - R0004 - Special Programs Room - (47.01 SQM)	● Student Space (21)	
B00A - R0005 - Movement - (16.09 SQM)	Not Applicable	Circulation or storage space.
B00A - R0008 - Movement - (10.32 SQM)	Not Applicable	Circulation or storage space.
B00A - R0009 - Home Base - (47 SQM) - Teaching Space: 1	● Student Space (21)	
B00A - R0010 - Home Base - (46.88 SQM) - Teaching Space: 1	● Student Space (21)	
B00A - R0012 - Movement - (5.23 SQM)	Not Applicable	Circulation or storage space.
B00A - R0013 - Withdrawal Space - 1hb - (18.19 SQM)	● Student Space (8)	
B00A - R0014 - Movement - (11.8 SQM)	Not Applicable	Circulation or storage space.
B00A - R0016 - Home Base - (47.01 SQM) - Teaching Space: 1	● Student Space (21)	
B00A - R0017 - Home Base - (46.88 SQM) - Teaching Space: 1	● Student Space (21)	
B00A - R0018 - Home Base - (47 SQM) - Teaching Space: 1	● Student Space (21)	
B00A - R0023 - Home Base - (68.21 SQM) - Teaching Space: 1	● Student Space (31)	
B00A - R0024 - Movement - (17.43 SQM)	Not Applicable	Circulation or storage space.
B00A - R0025 - Practical Activities - 1hb - (61.97 SQM)	● Student Space (28)	
B00A - R0027 - Movement - (13.2 SQM)	Not Applicable	Circulation or storage space.
B00A - R0031 - Home Base - (67.32 SQM) - Teaching Space: 1	● Student Space (31)	
B00A - R0032 - Movement - (38.74 SQM)	Not Applicable	Circulation or storage space.
B00A - R0033 - Movement - (62.33 SQM)	Not Applicable	Circulation or storage space.
B00B - R0003 - Home Base - (53.53 SQM) - Teaching Space: 1	● Student Space (24)	
B00B - R0004 - Home Base - (53.53 SQM) - Teaching Space: 1	● Student Space (24)	
B00B - R0008 - Movement - (15.24 SQM)	Not Applicable	Circulation or storage space.
B00B - R0009 - Home Base - (53.61 SQM) - Teaching Space: 1	● Student Space (24)	
B00B - R0011 - Deputy Principal - (12.93 SQM)	● Office (3)	
B00B - R0012 - Deputy Principal - (11.64 SQM)	● Office (2)	
B00B - R0014 - Interview - (8.96 SQM)	● Office (2)	
B00B - R0017 - Duplicating Workroom - (30.46 SQM)	● Office (7)	
B00B - R0019 - Staff Room Annexe - (10.54 SQM)	● Office (2)	
B00B - R0020 - Staff Room Annexe - (6.63 SQM)	● Office (1)	
B00B - R0021 - Staff Room - (89.36 SQM)	● Office (22)	
B00B - R0024 - Principal - (17.55 SQM)	● Office (4)	
B00B - R0026 - Clerical Office - (16.61 SQM)	● Office (4)	
B00B - R0027 - Sick Bay - (8.61 SQM)	● Student Space (3)	
B00B - R0032 - Movement - (6.1 SQM)	Not Applicable	Circulation or storage space.
B00B - R0034 - Movement - (32.61 SQM)	Not Applicable	Circulation or storage space.
B00B - R0037 - Movement - (74.22 SQM)	Not Applicable	Circulation or storage space.
B00B - R0039 - Movement - (9.63 SQM)	Not Applicable	Circulation or storage space.
B00C - R0004 - Communal Space - (15.1 SQM)	● Student Space (7)	
B00C - R0005 - Home Base - (46.94 SQM) - Teaching Space: 1	● Student Space (21)	
B00C - R0006 - Home Base - (46.94 SQM) - Teaching Space: 1	● Student Space (21)	
B00C - R0007 - Home Base - (46.94 SQM) - Teaching Space: 1	● Student Space (21)	
B00C - R0008 - Interview - (9 SQM)	● Office (2)	
B00C - R0009 - Interview - (10.19 SQM)	● Office (2)	
B00C - R0010 - Home Base - (46.95 SQM) - Teaching Space: 1	● Student Space (21)	
B00C - R0011 - Home Base - (47 SQM) - Teaching Space: 1	● Student Space (21)	
B00C - R0012 - Home Base - (53.48 SQM) - Teaching Space: 1	● Student Space (24)	
B00C - R0016 - Home Base - (46.94 SQM) - Teaching Space: 1	● Student Space (21)	
B00C - R0017 - Home Base - (46.94 SQM) - Teaching Space: 1	● Student Space (21)	
B00C - R0018 - Home Base - (46.94 SQM) - Teaching Space: 1	● Student Space (21)	
B00G - R0002 - Home Base - S - (53.6 SQM) - Teaching Space: 1	● Student Space (24)	

Entity Location	Audit Condition Classification (Capacity)	Comment
B00G - R0003 - Home Base - (53.53 SQM) - Teaching Space: 1	● Student Space (24)	
B00G - R0004 - Movement - (25.67 SQM)	Not Applicable	Circulation or storage space.
B00H - R0001 - Reading Area - (231.36 SQM)	● Student Space (107)	
B00J - R0001 - Communal Space - (199.11 SQM)	● Student Space (92)	
B00J - R0002 - Raised Platform - (57.42 SQM)	Not Applicable	Circulation or storage space.
B00J - R0016 - Movement - (6.44 SQM)	Not Applicable	Circulation or storage space.
B00J - R0018 - Movement - (16.74 SQM)	Not Applicable	Circulation or storage space.
B00J - R0020 - Canteen - (41.59 SQM)	Not Applicable	Circulation or storage space.
B00M - R0004 - Home Base - (60.58 SQM) - Teaching Space: 1	● Student Space (28)	
B00M - R0005 - Withdrawal Space - 2hb - (11.9 SQM)	● Student Space (5)	
B00M - R0006 - Home Base - (61.66 SQM) - Teaching Space: 1	● Student Space (28)	
B00M - R0007 - Practical Activities - 2hb - (44.53 SQM)	● Student Space (20)	
B00M - R0012 - Entry Vestibule - (20.56 SQM)	Not Applicable	Circulation or storage space.
B00M - R0013 - Interview - (11.51 SQM)	● Office (2)	
B00M - R0014 - Interview - (11.17 SQM)	● Office (2)	
B00M - R0015 - Deputy Principal - Type 1 - (10.05 SQM)	● Office (2)	
B00M - R0016 - Movement - (19.3 SQM)	Not Applicable	Circulation or storage space.
B00M - R0017 - Interview - (16.9 SQM)	● Office (4)	
B00M - R0018 - Principal - (18.9 SQM)	● Office (4)	
B00M - R0019 - Deputy Principal - Type 2 - (25.39 SQM)	● Office (6)	
B00M - R0021 - Clerical Office - (60.66 SQM)	● Office (15)	
B00M - R0023 - Clerical/Printing - (22.95 SQM)	Not Applicable	Circulation or storage space.
B00M - R0024 - Movement - (22.12 SQM)	Not Applicable	Circulation or storage space.
B00M - R0025 - Sick Bay - (8.16 SQM)	● Student Space (3)	
B00M - R0031 - Staff Kitchen - (23.4 SQM)	● Office (5)	
B00M - R0032 - Staff Room - (81.39 SQM)	● Office (20)	
B00M - R0040 - Practical Activities - 4hb - (106.33 SQM)	● Student Space (49)	
B00M - R0041 - Movement - (30.08 SQM)	Not Applicable	Circulation or storage space.
B00M - R0043 - Home Base - (64.72 SQM) - Teaching Space: 1	● Student Space (30)	
B00M - R0044 - Withdrawal Space - 2hb - (11.94 SQM)	● Student Space (5)	
B00M - R0045 - Home Base X2 - (129.37 SQM) - Teaching Space: 2	● Student Space (60)	
B00M - R0047 - Withdrawal Space - 2hb - (11.86 SQM)	● Student Space (5)	
B00M - R0048 - Home Base - (60.92 SQM) - Teaching Space: 1	● Student Space (28)	
B00M - R1003 - Home Base - (61.78 SQM) - Teaching Space: 1	● Student Space (28)	
B00M - R1004 - Withdrawal Space - 2hb - (11.93 SQM)	● Student Space (5)	
B00M - R1005 - Home Base - (61.29 SQM) - Teaching Space: 1	● Student Space (28)	
B00M - R1007 - Practical Activities - 2hb - (51.21 SQM)	● Student Space (23)	
B00M - R1011 - Practical Activities - 4hb - (112.27 SQM)	● Student Space (52)	
B00M - R1012 - Home Base - (61.84 SQM) - Teaching Space: 1	● Student Space (28)	
B00M - R1013 - Withdrawal Space - 2hb - (12.11 SQM)	● Student Space (5)	
B00M - R1014 - Home Base X2 - (129.89 SQM) - Teaching Space: 2	● Student Space (60)	
B00M - R1016 - Withdrawal Space - 2hb - (11.96 SQM)	● Student Space (5)	
B00M - R1017 - Home Base - (61.92 SQM) - Teaching Space: 1	● Student Space (28)	
B00M - R1024 - Home Base - (63.85 SQM) - Teaching Space: 1	● Student Space (29)	
B00M - R1025 - Withdrawal Space - 2hb - (12.03 SQM)	● Student Space (5)	
B00M - R1026 - Home Base X2 - (130.36 SQM) - Teaching Space: 2	● Student Space (60)	
B00M - R1028 - Withdrawal Space - 2hb - (11.95 SQM)	● Student Space (5)	
B00M - R1029 - Home Base - (60.48 SQM) - Teaching Space: 1	● Student Space (28)	

Entity Location	Audit Condition Classification (Capacity)	Comment
B00M - R1031 - Movement - (21.22 SQM)	Not Applicable	Circulation or storage space.
B00M - R1033 - Practical Activities - 4hb - (109.8 SQM)	● Student Space (50)	
B00N - R0001 - Community Languages - (61.31 SQM)	● Student Space (28)	
OS 602 12070 - OS 602 12070 - Learning Unit - Standard With P.A.A. - (76 SQM)	● Student Space (35)	
OS 606 15167 - OS 606 15167 - Learning Unit - Standard With P.A.A A/C - (76 SQM)	● Student Space (35)	