

VENTILATION AUDIT REPORT

SCHOOL:	Wyong High School (8166)
AMU REGION:	Hunter/Central Coast
STATE ELECTORATE:	Wyong
LOCAL GOVERNMENT AREA:	Central Coast

8166 - Wyong High School
Site Plan (13056)

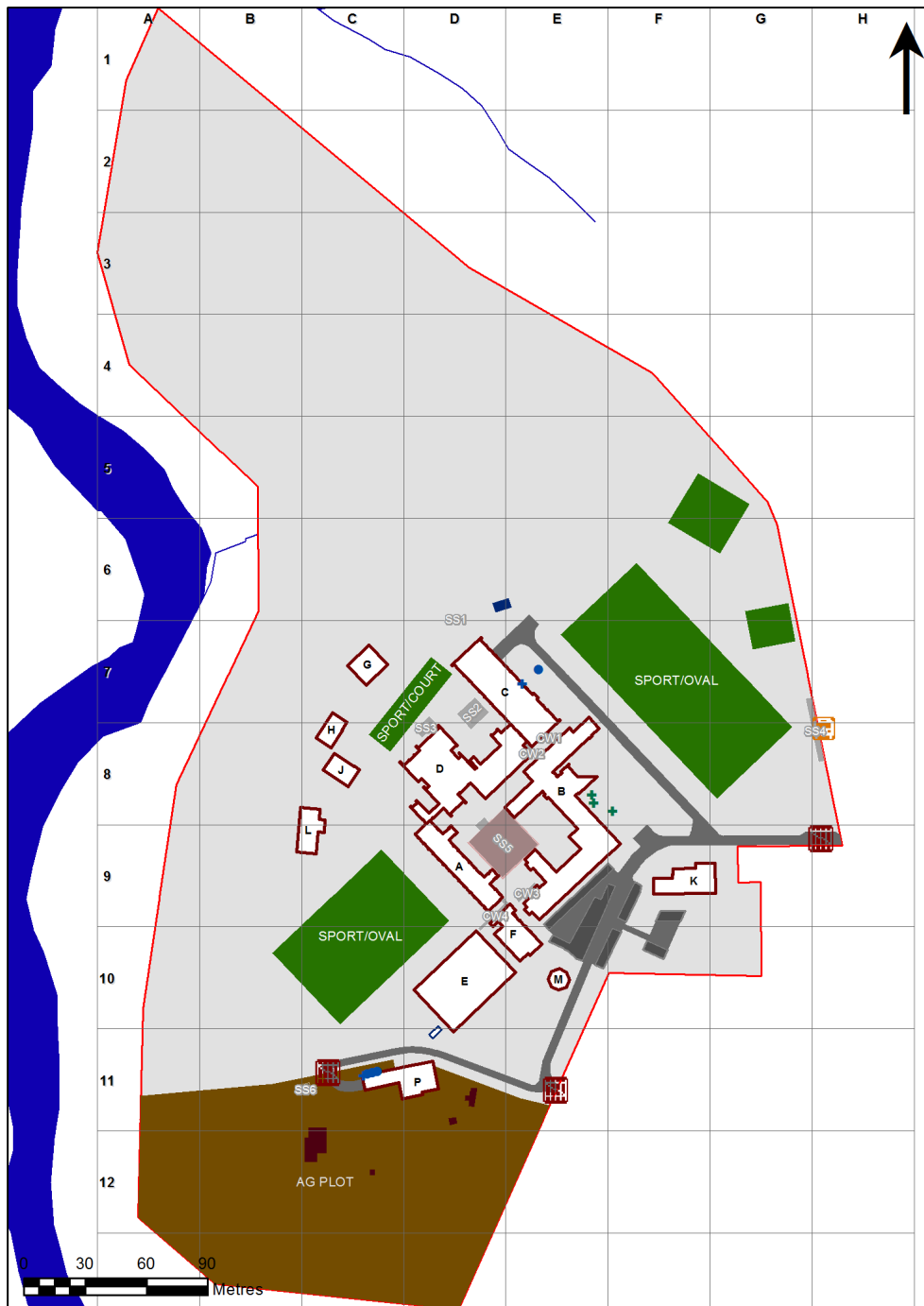

1:2,320

Printed: 18-Sep-2020









Ventilation Audit Key

Category	Description
	Category A Operate this space in line with COVID safe school operations . It has the required level of natural ventilation. NB. Circulation and storage areas should not be used for groups or gatherings.
	Category B This space should be occupied at 1 person per 4m ² to comply with COVID safe school operations and the guided use of spaces . The report details the number of people who can be accommodated safely in each of the identified spaces.

Entity Location	Audit Condition Classification (Capacity)	Comment
B00A - M0003 - Movement - (5.53 SQM)	Not Applicable	Circulation or storage space.
B00A - M0004 - Movement - (5.61 SQM)	Not Applicable	Circulation or storage space.
B00A - M1004 - Movement - (5.35 SQM)	Not Applicable	Circulation or storage space.
B00A - R0001 - General Learning Space - (53.11 SQM) - Teaching Space: 1	● Student Space (24)	
B00A - R0003 - General Learning Space - (52.74 SQM) - Teaching Space: 1	● Student Space (24)	
B00A - R0007 - Materials Technology L.S. - (49.92 SQM) - Teaching Space: 1	● Student Space (23)	
B00A - R0009 - Fitness Laboratory - (51.89 SQM)	● Student Space (24)	
B00A - R0010 - Fitness Laboratory - (65.41 SQM)	● Student Space (30)	
B00A - R0020 - Staff Study - (45.52 SQM)	○ Office (11)	
B00A - R0022 - Movement - (7.29 SQM)	Not Applicable	Circulation or storage space.
B00A - R0023 - Movement - (7.27 SQM)	Not Applicable	Circulation or storage space.
B00A - R1001 - General Learning Space - (53.03 SQM) - Teaching Space: 1	● Student Space (24)	
B00A - R1003 - Computer Learning Space - (52.52 SQM) - Teaching Space: 1	● Student Space (24)	
B00A - R1006 - Laboratory L.S. - (92.97 SQM) - Teaching Space: 1	● Student Space (43)	
B00A - R1009 - Laboratory L.S. - (93.28 SQM) - Teaching Space: 1	● Student Space (43)	
B00A - R1013 - Preparation - (37.89 SQM)	Not Applicable	Circulation or storage space.
B00A - R2001 - General Learning Space - (53.1 SQM) - Teaching Space: 1	● Student Space (24)	
B00A - R2003 - General Learning Space - (51.64 SQM) - Teaching Space: 1	● Student Space (23)	
B00A - R2004 - General Learning Space - (52.52 SQM) - Teaching Space: 1	● Student Space (24)	
B00A - R2006 - Movement - (9.06 SQM)	Not Applicable	Circulation or storage space.
B00A - R2008 - Staff Lounge - (16.08 SQM)	○ Office (4)	
B00A - R2014 - General Learning Space - (40.01 SQM) - Teaching Space: 1	● Student Space (18)	
B00A - R2020 - Staff Study - (21.23 SQM)	○ Office (5)	
B00B - R0007 - Administration - Clerical - (7.43 SQM)	○ Office (1)	
B00B - R0008 - Deputy Principal Office - (15.55 SQM)	○ Office (3)	
B00B - R0009 - Deputy Principal Office - (16.16 SQM)	○ Office (4)	
B00B - R0022 - Principal Office - (19.37 SQM)	○ Office (4)	
B00B - R0024 - Administration - Clerical - (10.6 SQM)	○ Office (2)	
B00B - R0030 - General Learning Space - (52.11 SQM) - Teaching Space: 1	● Student Space (24)	
B00B - R0031 - General Learning Space - (52.16 SQM) - Teaching Space: 1	● Student Space (24)	
B00B - R0032 - General Learning Space - (52.13 SQM) - Teaching Space: 1	● Student Space (24)	
B00B - R0033 - Leading Teacher - (13.43 SQM)	○ Office (3)	
B00B - R0037 - Interview/Office - Type 1 - (15.16 SQM)	○ Office (3)	
B00B - R0039 - Wood Technology L.S. - (89.65 SQM) - Teaching Space: 1	● Student Space (41)	
B00B - R0043 - Metal Technology L.S. - (83.37 SQM) - Teaching Space: 1	● Student Space (38)	
B00B - R0045 - Welding Area - (23.99 SQM)	Not Applicable	Circulation or storage space.
B00B - R0047 - Materials Technology L.S. - (90.37 SQM) - Teaching Space: 1	● Student Space (41)	
B00B - R0049 - Movement - (85.05 SQM)	Not Applicable	Circulation or storage space.
B00B - R0052 - Movement - (89.95 SQM)	Not Applicable	Circulation or storage space.
B00B - R0059 - Staff Study - (60.69 SQM)	○ Office (15)	
B00B - R0061 - Food Technology L.S. - (100.78 SQM) - Teaching Space: 1	● Student Space (46)	
B00B - R0063 - Preparation - Materials - (7.83 SQM)	Not Applicable	Circulation or storage space.
B00B - R0065 - Movement - (10.76 SQM)	Not Applicable	Circulation or storage space.
B00B - R0068 - Movement - (32.17 SQM)	Not Applicable	Circulation or storage space.
B00B - R0079 - Movement - (51.61 SQM)	Not Applicable	Circulation or storage space.
B00B - R0080 - Movement - (39.21 SQM)	Not Applicable	Circulation or storage space.
B00B - R0081 - Tea Room - (9.75 SQM)	Not Applicable	Circulation or storage space.
B00B - R0083 - Clinic - (17.56 SQM)	○ Office (4)	
B00B - R0085 - Interview/Meeting - (20.21 SQM)	○ Office (5)	

Entity Location	Audit Condition Classification (Capacity)	Comment
B00B - R0086 - Movement - (28.33 SQM)	Not Applicable	Circulation or storage space.
B00B - R0087 - Administration - Clerical - (58.3 SQM)	Office (14)	
B00B - R1001 - General Learning Space - (52.1 SQM) - Teaching Space: 1	Student Space (24)	
B00B - R1002 - General Learning Space - (52.1 SQM) - Teaching Space: 1	Student Space (24)	
B00B - R1005 - Computer Learning Space - (52.32 SQM) - Teaching Space: 1	Student Space (24)	
B00B - R1006 - General Learning Space - (39.58 SQM) - Teaching Space: 1	Student Space (18)	
B00B - R1009 - Computer Learning Space - (57.63 SQM) - Teaching Space: 1	Student Space (26)	
B00B - R1015 - Movement - (93.17 SQM)	Not Applicable	Circulation or storage space.
B00B - R1016 - Movement - (18.28 SQM)	Not Applicable	Circulation or storage space.
B00B - R1017 - Staff Study - (49.24 SQM)	Office (12)	
B00C - R0004 - General Assistants - (44.19 SQM)	Office (11)	
B00C - R0005 - General Assistants - (14.67 SQM)	Office (3)	
B00C - R0007 - Student Canteen - (47.3 SQM)	Not Applicable	Circulation or storage space.
B00C - R0011 - Design L.S. - (130.27 SQM) - Teaching Space: 1	Student Space (60)	
B00C - R0016 - Practical Activity Area - (38.86 SQM)	Student Space (18)	
B00C - R0017 - Movement - (30.6 SQM)	Not Applicable	Circulation or storage space.
B00C - R0021 - Movement - (69 SQM)	Not Applicable	Circulation or storage space.
B00C - R0022 - Movement - (81.99 SQM)	Not Applicable	Circulation or storage space.
B00C - R1004 - Staff Study - (38.71 SQM)	Office (9)	
B00C - R1005 - Special Learning Space - (39.44 SQM) - Teaching Space: 1	Student Space (18)	
B00C - R1006 - Special Learning Space - (38.33 SQM) - Teaching Space: 1	Student Space (17)	
B00C - R1009 - Interview/Office - Type 1 - (10.77 SQM)	Office (2)	
B00C - R1011 - Interview/Office - Type 1 - (15.68 SQM)	Office (3)	
B00C - R1015 - Design L.S. - (64.7 SQM) - Teaching Space: 1	Student Space (30)	
B00C - R1040 - Food Technology L.S. - (108.07 SQM) - Teaching Space: 1	Student Space (50)	
B00C - R1042 - Preparation - (20.5 SQM)	Not Applicable	Circulation or storage space.
B00C - R1044 - Seminar - (47.05 SQM)	Office (11)	
B00C - R1045 - General Learning Space - M - (51.12 SQM) - Teaching Space: 1	Student Space (23)	
B00C - R1046 - Practical Activity Area - (13 SQM)	Student Space (6)	
B00C - R1047 - Practical Activity Area - (14.94 SQM)	Student Space (6)	
B00C - R1048 - General Learning Space - M - (43.71 SQM) - Teaching Space: 1	Student Space (20)	
B00C - R1050 - Staff Lounge - (16.67 SQM)	Office (4)	
B00C - R1051 - Staff Kitchen - (21.04 SQM)	Office (5)	
B00C - R1052 - Movement - (7.57 SQM)	Not Applicable	Circulation or storage space.
B00C - R1053 - Movement - (89.4 SQM)	Not Applicable	Circulation or storage space.
B00C - R1054 - Movement - (72.98 SQM)	Not Applicable	Circulation or storage space.
B00C - R2001 - Computer Learning Space - (51.73 SQM) - Teaching Space: 1	Student Space (24)	
B00C - R2003 - General Learning Space - (51.59 SQM) - Teaching Space: 1	Student Space (23)	
B00C - R2009 - General Learning Space - (51.66 SQM) - Teaching Space: 1	Student Space (23)	
B00C - R2010 - Workshop - (25.4 SQM)	Student Space (11)	
B00C - R2011 - Art Learning Space - (64.01 SQM) - Teaching Space: 1	Student Space (29)	
B00C - R2019 - Music Learning Space - (51.51 SQM) - Teaching Space: 1	Student Space (23)	
B00C - R2020 - Music Learning Space - (51.51 SQM) - Teaching Space: 1	Student Space (23)	
B00C - R2022 - Movement - (161.5 SQM)	Not Applicable	Circulation or storage space.
B00C - R2025 - Staff Kitchen - (10.53 SQM)	Office (2)	
B00C - R2026 - Commonroom - (93.5 SQM)	Office (23)	
B00C - R2027 - Staff Study - (19.07 SQM)	Office (4)	
B00C - R2028 - Staff Study - (36.2 SQM)	Office (9)	

Entity Location	Audit Condition Classification (Capacity)	Comment
B00C - R2032 - Dark Room - (18.02 SQM)	Office (4)	
B00C - R2033 - Art Learning Space - (104.67 SQM) - Teaching Space: 1	Student Space (48)	
B00D - M0001 - Senior Study - (42.55 SQM)	Office (10)	
B00D - M0003 - Senior Study - (11.06 SQM)	Office (2)	
B00D - M0004 - Interview/Office - Type 1 - (11.06 SQM)	Office (2)	
B00D - M0005 - Interview/Office - Type 1 - (11.06 SQM)	Office (2)	
B00D - R0001 - Tea Room - (11.63 SQM)	Not Applicable	Circulation or storage space.
B00D - R0002 - Staff Study - (51.1 SQM)	Office (12)	
B00D - R0003 - General Learning Space - (51.73 SQM) - Teaching Space: 1	Student Space (24)	
B00D - R0004 - General Learning Space - (50.43 SQM) - Teaching Space: 1	Student Space (23)	
B00D - R0005 - General Learning Space - (51.3 SQM) - Teaching Space: 1	Student Space (23)	
B00D - R0018 - Audio Visual Workroom - (8.06 SQM)	Student Space (3)	
B00D - R0019 - Main Area - (268.75 SQM)	Not Applicable	Circulation or storage space.
B00D - R0024 - Seminar - (63.86 SQM)	Office (15)	
B00D - R0034 - Main Entry - (47.37 SQM)	Not Applicable	Circulation or storage space.
B00D - R0035 - General Learning Space - (48.65 SQM) - Teaching Space: 1	Student Space (22)	
B00D - R0040 - Movement - (31.77 SQM)	Not Applicable	Circulation or storage space.
B00D - R0042 - Tiered Learning Area - (8.26 SQM)	Student Space (3)	
B00D - R1001 - Laboratory L.S. - (95.56 SQM) - Teaching Space: 1	Student Space (44)	
B00D - R1002 - Preparation - Science - (47.46 SQM)	Not Applicable	Circulation or storage space.
B00D - R1003 - Laboratory L.S. - (96.9 SQM) - Teaching Space: 1	Student Space (44)	
B00D - R1005 - Leading Teacher - (11.05 SQM)	Office (2)	
B00D - R1012 - Laboratory L.S. - (95.69 SQM) - Teaching Space: 1	Student Space (44)	
B00D - R1022 - Staff Study - (30 SQM)	Office (7)	
B00D - R2001 - General Learning Space - (50.97 SQM) - Teaching Space: 1	Student Space (23)	
B00D - R2002 - Computer Learning Space - (51.36 SQM) - Teaching Space: 1	Student Space (23)	
B00D - R2005 - General Learning Space - (50.51 SQM) - Teaching Space: 1	Student Space (23)	
B00D - R2006 - General Learning Space - (51.37 SQM) - Teaching Space: 1	Student Space (23)	
B00D - R2013 - General Learning Space - (51.52 SQM) - Teaching Space: 1	Student Space (23)	
B00D - R2014 - General Learning Space - (51.02 SQM) - Teaching Space: 1	Student Space (23)	
B00D - R2015 - General Learning Space - (51.15 SQM) - Teaching Space: 1	Student Space (23)	
B00E - R0008 - Stage - (68.17 SQM)	Not Applicable	Circulation or storage space.
B00E - R0012 - Staff Kitchen - (15.27 SQM)	Office (3)	
B00E - R0024 - Movement - (15.36 SQM)	Not Applicable	Circulation or storage space.
B00E - R0025 - Movement - (15.34 SQM)	Not Applicable	Circulation or storage space.
B00E - R0026 - Multi-Purpose Space - (486.79 SQM)	Student Space (225)	
B00F - R0008 - Wood Technology L.S. - (133.3 SQM) - Teaching Space: 1	Student Space (61)	
B00F - R0009 - Outdoor Workshop - (86.53 SQM)	Not Applicable	Circulation or storage space.
B00G - R0003 - Art Learning Space - (70.19 SQM) - Teaching Space: 1	Student Space (32)	
B00G - R0004 - Workshop - (20.23 SQM)	Student Space (9)	
B00H - R0007 - Performance Workspace - (44.14 SQM) - Teaching Space: 1	Student Space (20)	
B00H - R0008 - General Learning Space - (44.29 SQM) - Teaching Space: 1	Student Space (20)	
B00J - R0002 - Special Learning Space - (52.3 SQM) - Teaching Space: 1	Student Space (24)	
B00J - R0003 - Special Learning Space - (52.45 SQM) - Teaching Space: 1	Student Space (24)	
B00K - R0001 - Computer Learning Space - (63.83 SQM) - Teaching Space: 1	Student Space (29)	
B00K - R0002 - Computer Learning Space - (64.37 SQM) - Teaching Space: 1	Student Space (29)	
B00K - R0004 - Staff Study - (12.43 SQM)	Office (3)	

Entity Location	Audit Condition Classification (Capacity)	Comment
B00K - R0008 - Computer Learning Space - (64.85 SQM) - Teaching Space: 1	 Student Space (30)	
B00K - R0009 - Movement - (52.95 SQM)	Not Applicable	Circulation or storage space.
B00L - R0002 - Special Learning Space - (43.44 SQM) - Teaching Space: 1	 Student Space (20)	
B00L - R0003 - Seminar - Type 1 - (22.17 SQM)	 Office (5)	
B00L - R0006 - Special Learning Space - (32.49 SQM) - Teaching Space: 1	 Student Space (15)	
B00L - R0015 - Movement - (17.03 SQM)	Not Applicable	Circulation or storage space.
B00L - R0016 - Staff Kitchen - (10.5 SQM)	 Office (2)	
B00M - R0001 - General Learning Space - (74.24 SQM) - Teaching Space: 1	 Student Space (34)	
B00P - R0001 - General Learning Space - (60.41 SQM) - Teaching Space: 1	 Student Space (28)	
B00P - R0002 - Growing/Breeding - (19.39 SQM)	Not Applicable	Circulation or storage space.
B00P - R0003 - Growing/Breeding - (23.42 SQM)	Not Applicable	Circulation or storage space.
B00P - R0006 - Staff Study - (7.57 SQM)	 Office (1)	
B00P - R0007 - Tea Room - (5.12 SQM)	Not Applicable	Circulation or storage space.
B00P - R0013 - Outdoor Learning Space - Type 1 - (81.61 SQM)	Not Applicable	Circulation or storage space.