

VENTILATION AUDIT REPORT

SCHOOL:	Winston Heights Public School (4471)
AMU REGION:	Western Sydney
STATE ELECTORATE:	Seven Hills
LOCAL GOVERNMENT AREA:	Parramatta

4471 - Winston Heights Public School
Site Plan (11941)

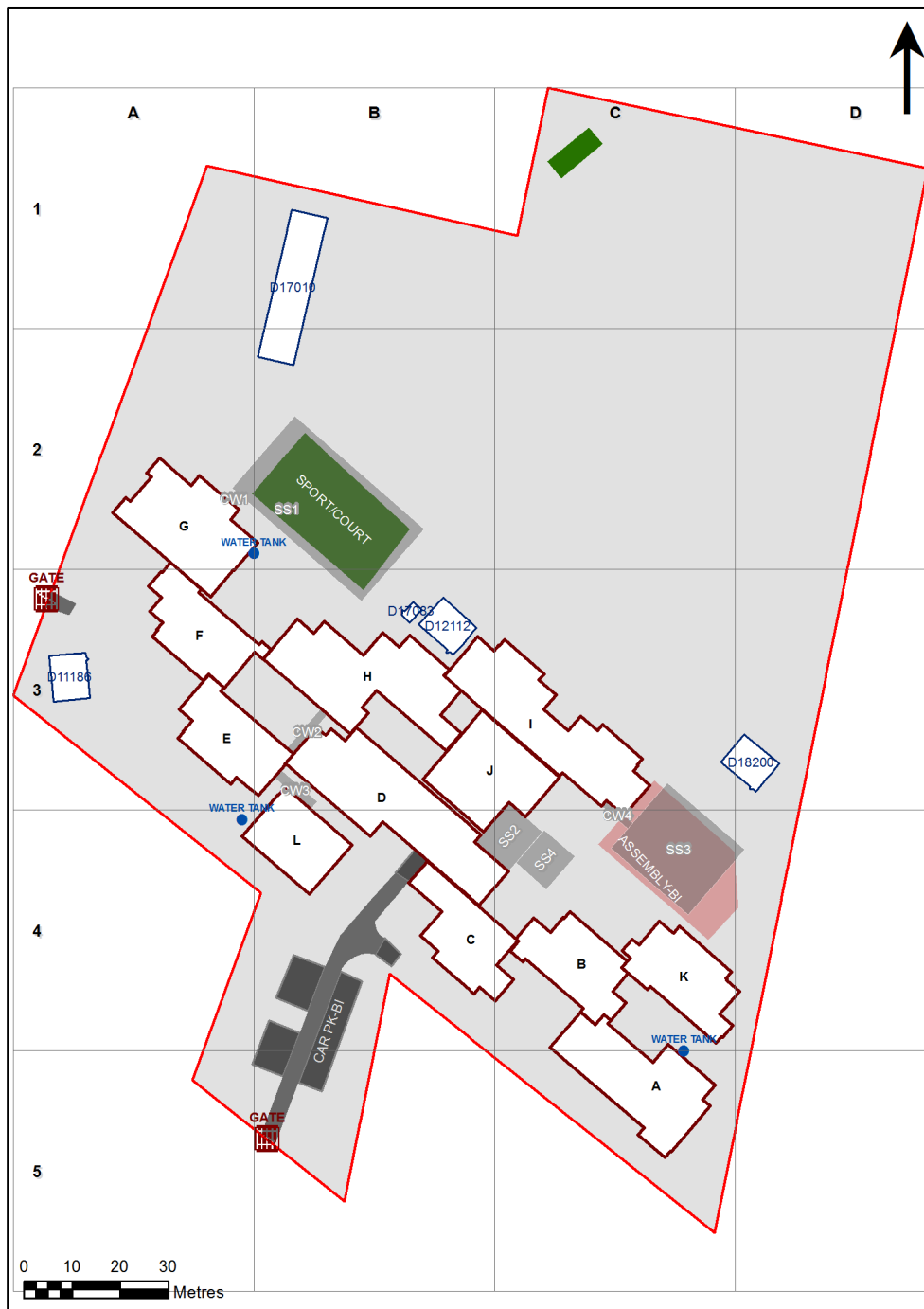

1:986

Printed: 31-Aug-2021

Ventilation Audit Key

Category	Description
	Category A Operate this space in line with COVID safe school operations . It has the required level of natural ventilation. NB. Circulation and storage areas should not be used for groups or gatherings.
	Category B This space should be occupied at 1 person per 4m ² to comply with COVID safe school operations and the guided use of spaces . The report details the number of people who can be accommodated safely in each of the identified spaces.

Entity Location	Audit Condition Classification (Capacity)	Comment
B00A - R0001 - Movement - (12.84 SQM)	Not Applicable	Circulation or storage space.
B00A - R0002 - Home Base - (71.91 SQM) - Teaching Space: 1	● Student Space (33)	
B00A - R0003 - Practical Activities - 1hb - (18.47 SQM)	● Student Space (8)	
B00A - R0006 - Practical Activities - 1hb - (17.41 SQM)	● Student Space (8)	
B00A - R0008 - Home Base - (75.2 SQM) - Teaching Space: 1	● Student Space (34)	
B00A - R0009 - Withdrawal Space - 1hb - (74.36 SQM)	● Student Space (34)	
B00A - R0010 - Practical Activities - 1hb - (17.38 SQM)	● Student Space (8)	
B00A - R0013 - Movement - (71.27 SQM)	Not Applicable	Circulation or storage space.
B00B - R0001 - Movement - (23.99 SQM)	Not Applicable	Circulation or storage space.
B00B - R0002 - Movement - (41.44 SQM)	Not Applicable	Circulation or storage space.
B00B - R0003 - Movement - (27.63 SQM)	Not Applicable	Circulation or storage space.
B00B - R0007 - Withdrawal Space - 1hb - (22.69 SQM)	● Student Space (10)	
B00B - R0008 - Home Base - (101.13 SQM) - Teaching Space: 1	● Student Space (46)	
B00B - R0009 - Practical Activities - 1hb - (26.46 SQM)	● Student Space (12)	
B00C - R0001 - Practical Activities - 1hb - (27.62 SQM)	● Student Space (12)	
B00C - R0002 - Movement - (19.67 SQM)	Not Applicable	Circulation or storage space.
B00C - R0003 - Home Base - (98.77 SQM) - Teaching Space: 1	● Student Space (45)	
B00C - R0004 - Withdrawal Space - 1hb - (27.27 SQM)	● Student Space (12)	
B00C - R0009 - Movement - (73.04 SQM)	Not Applicable	Circulation or storage space.
B00D - R0001 - Movement - (124.62 SQM)	Not Applicable	Circulation or storage space.
B00D - R0002 - Movement - (18.67 SQM)	Not Applicable	Circulation or storage space.
B00D - R0003 - Principal - (13.58 SQM)	● Office (3)	
B00D - R0007 - Staff Room - (71.07 SQM)	● Office (17)	
B00D - R0008 - Movement - (6.26 SQM)	Not Applicable	Circulation or storage space.
B00D - R0009 - Movement - (17.21 SQM)	Not Applicable	Circulation or storage space.
B00D - R0011 - Deputy Principal - (15.93 SQM)	● Office (3)	
B00D - R0012 - Movement - (61.15 SQM)	Not Applicable	Circulation or storage space.
B00D - R0013 - Movement - (16.38 SQM)	Not Applicable	Circulation or storage space.
B00D - R0015 - Clerical Office/Workroom - (30.83 SQM)	● Office (7)	
B00D - R0017 - Sick Bay - (16.43 SQM)	● Student Space (7)	
B00D - R0018 - Entry Vestibule - (26.31 SQM)	Not Applicable	Circulation or storage space.
B00D - R0019 - Principal - (16.27 SQM)	● Office (4)	
B00D - R0021 - Interview - (8.56 SQM)	● Office (2)	
B00D - R0022 - Canteen - (24.54 SQM)	Not Applicable	Circulation or storage space.
B00D - R0026 - Movement - (5.34 SQM)	Not Applicable	Circulation or storage space.
B00E - R0001 - Movement - (74.58 SQM)	Not Applicable	Circulation or storage space.
B00E - R0003 - Practical Activities - 1hb - (12.15 SQM)	● Student Space (5)	
B00E - R0004 - Home Base - (65.46 SQM) - Teaching Space: 1	● Student Space (30)	
B00E - R0005 - Movement - (26.75 SQM)	Not Applicable	Circulation or storage space.
B00E - R0006 - Home Base - (65 SQM) - Teaching Space: 1	● Student Space (30)	
B00E - R0007 - Practical Activities - 1hb - (13.56 SQM)	● Student Space (6)	
B00F - R0002 - Movement - (25.85 SQM)	Not Applicable	Circulation or storage space.
B00F - R0003 - Practical Activities - 1hb - (12.5 SQM)	● Student Space (5)	
B00F - R0006 - Home Base - (62.91 SQM) - Teaching Space: 1	● Student Space (29)	
B00F - R0007 - Movement - (67.19 SQM)	Not Applicable	Circulation or storage space.
B00F - R0008 - Home Base - (65.18 SQM) - Teaching Space: 1	● Student Space (30)	
B00G - R0001 - Movement - (23.18 SQM)	Not Applicable	Circulation or storage space.
B00G - R0002 - Communal Space - (239.64 SQM)	● Student Space (111)	
B00G - R0004 - Raised Platform - (38.75 SQM)	Not Applicable	Circulation or storage space.
B00G - R0006 - Movement - (18.42 SQM)	Not Applicable	Circulation or storage space.
B00H - R0001 - Movement - (58.43 SQM)	Not Applicable	Circulation or storage space.

Entity Location	Audit Condition Classification (Capacity)	Comment
B00H - R0002 - Practical Activities - 1hb - (25.68 SQM)	Student Space (11)	
B00H - R0003 - Home Base - (100.84 SQM) - Teaching Space: 1	Student Space (46)	
B00H - R0004 - Movement - (19.94 SQM)	Not Applicable	Circulation or storage space.
B00H - R0005 - Withdrawal Space - 1hb - (22.93 SQM)	Student Space (10)	
B00H - R0006 - Movement - (11.65 SQM)	Not Applicable	Circulation or storage space.
B00H - R0007 - Practical Activities - 1hb - (24.79 SQM)	Student Space (11)	
B00H - R0008 - Movement - (11.36 SQM)	Not Applicable	Circulation or storage space.
B00H - R0013 - Movement - (45.85 SQM)	Not Applicable	Circulation or storage space.
B00H - R0017 - Movement - (17.02 SQM)	Not Applicable	Circulation or storage space.
B00H - R0018 - Withdrawal Space - 1hb - (22.42 SQM)	Student Space (10)	
B00H - R0019 - Computer Room - (96.97 SQM)	Student Space (44)	
B00I - R0001 - Practical Activities - 1hb - (24.99 SQM)	Student Space (11)	
B00I - R0002 - Movement - (93.07 SQM)	Not Applicable	Circulation or storage space.
B00I - R0003 - Practical Activities - 1hb - (25.29 SQM)	Student Space (11)	
B00I - R0004 - Movement - (11.3 SQM)	Not Applicable	Circulation or storage space.
B00I - R0005 - Movement - (17.42 SQM)	Not Applicable	Circulation or storage space.
B00I - R0006 - Home Base - (95.49 SQM) - Teaching Space: 1	Student Space (44)	
B00I - R0007 - Withdrawal Space - 1hb - (27.08 SQM)	Student Space (12)	
B00I - R0011 - Movement - (17.56 SQM)	Not Applicable	Circulation or storage space.
B00I - R0014 - Withdrawal Space - 1hb - (26.94 SQM)	Student Space (12)	
B00I - R0015 - Movement - (18.7 SQM)	Not Applicable	Circulation or storage space.
B00I - R0016 - Home Base - (95.84 SQM) - Teaching Space: 1	Student Space (44)	
B00I - R0017 - Movement - (11.31 SQM)	Not Applicable	Circulation or storage space.
B00J - R0007 - Movement - (21.18 SQM)	Not Applicable	Circulation or storage space.
B00J - R0008 - Movement - (8.64 SQM)	Not Applicable	Circulation or storage space.
B00J - R0009 - Movement - (9.73 SQM)	Not Applicable	Circulation or storage space.
B00J - R0011 - Reading Area - (131.41 SQM)	Student Space (60)	
B00J - R0012 - Reading Area - (78.12 SQM)	Student Space (36)	
B00K - R0001 - Movement - (35.91 SQM)	Not Applicable	Circulation or storage space.
B00K - R0002 - Movement - (10.42 SQM)	Not Applicable	Circulation or storage space.
B00K - R0005 - Practical Activities - 1hb - (12.22 SQM)	Student Space (5)	
B00K - R0006 - Movement - (9.26 SQM)	Not Applicable	Circulation or storage space.
B00K - R0007 - Movement - (24.89 SQM)	Not Applicable	Circulation or storage space.
B00K - R0008 - Home Base - (64.52 SQM) - Teaching Space: 1	Student Space (29)	
B00K - R0009 - Home Base - (65.08 SQM) - Teaching Space: 1	Student Space (30)	
B00K - R0010 - Movement - (8.96 SQM)	Not Applicable	Circulation or storage space.
B00K - R0011 - Practical Activities - 1hb - (12.18 SQM)	Student Space (5)	
B00L - R0001 - Home Base - (60.91 SQM) - Teaching Space: 1	Student Space (28)	
B00L - R0003 - Practical Activities - 1hb - (18.95 SQM)	Student Space (8)	
B00L - R0004 - Withdrawal Space - 2hb - (11.58 SQM)	Student Space (5)	
B00L - R0005 - Home Base - (60.91 SQM) - Teaching Space: 1	Student Space (28)	
B00L - R0007 - Practical Activities - 1hb - (18.95 SQM)	Student Space (8)	
OH 060 17010 - OH 060 17010 - OSHC Hub 60 - (247 SQM)	Student Space (114)	
OS 602 11186 - OS 602 11186 - Learning Unit - Standard With P.A.A. - (76 SQM)	Student Space (35)	
OS 602 12112 - OS 602 12112 - Learning Unit - Standard With P.A.A. - (76 SQM)	Student Space (35)	
OS 602 18200 - OS 602 18200 - Learning Unit - Standard With P.A.A. - (76 SQM)	Student Space (35)	