

VENTILATION AUDIT REPORT

SCHOOL:	Windsor Public School (3459)
AMU REGION:	Western Sydney
STATE ELECTORATE:	Hawkesbury
LOCAL GOVERNMENT AREA:	Hawkesbury

3459 - Windsor Public School
Site Plan (12907)

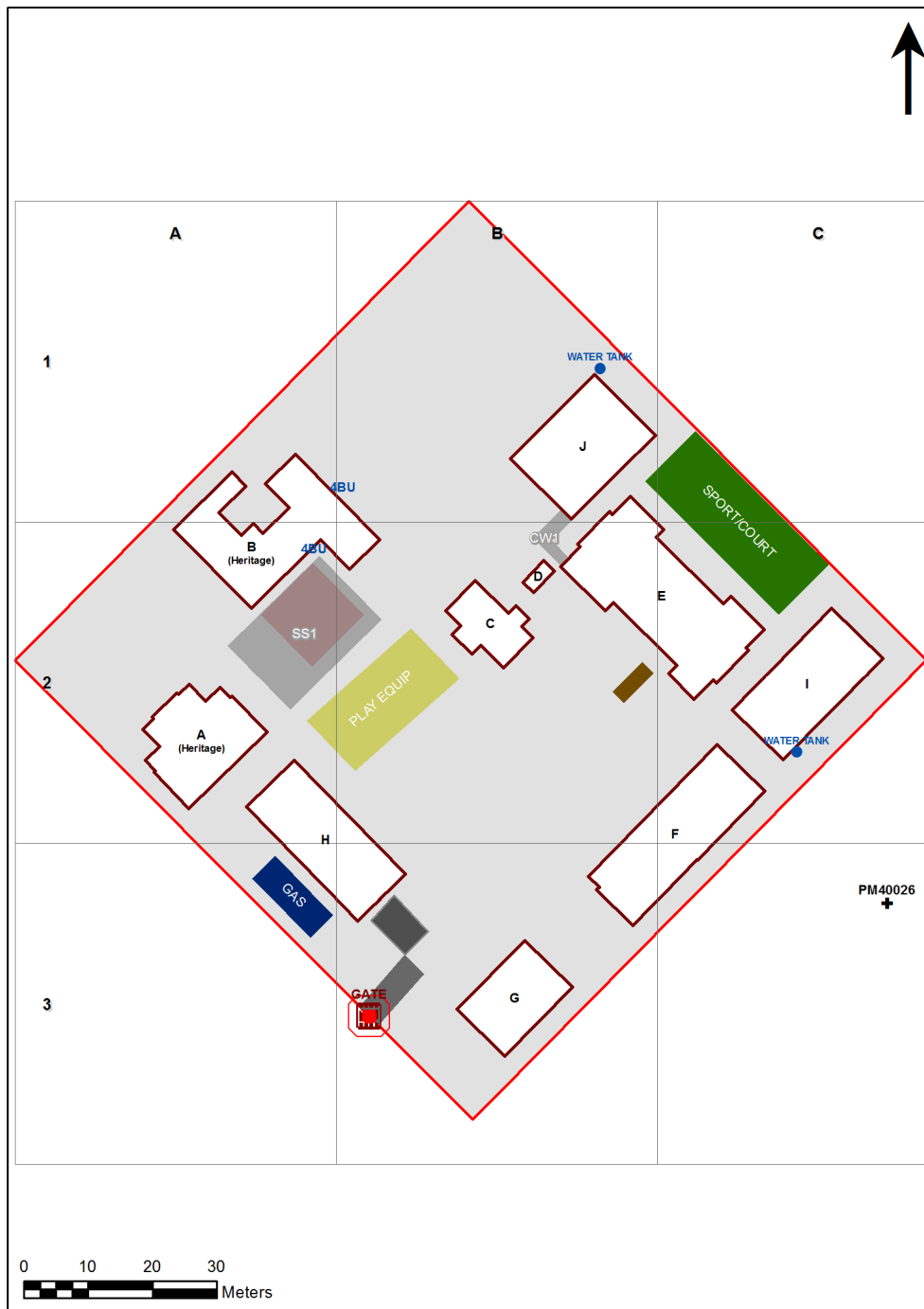

1:739

Printed: 21-Mar-2020

Ventilation Audit Key

Category	Description
	Category A Operate this space in line with COVID safe school operations . It has the required level of natural ventilation. NB. Circulation and storage areas should not be used for groups or gatherings.
	Category B This space should be occupied at 1 person per 4m ² to comply with COVID safe school operations and the guided use of spaces . The report details the number of people who can be accommodated safely in each of the identified spaces.

Entity Location	Audit Condition Classification (Capacity)	Comment
B00A - R0003 - Movement - (10.92 SQM)	Not Applicable	Circulation or storage space.
B00A - R0004 - Staff Room - (65.12 SQM)	Office (16)	
B00A - R0005 - Duplicating Workroom - (8.12 SQM)	Office (2)	
B00A - R0006 - Duplicating Workroom - (9.72 SQM)	Office (2)	
B00A - R0007 - Clerical Office - (11.46 SQM)	Office (2)	
B00A - R0010 - Movement - (11.11 SQM)	Not Applicable	Circulation or storage space.
B00A - R0011 - Sick Bay - (7.63 SQM)	Student Space (3)	
B00A - R0013 - Principal - (20.37 SQM)	Office (5)	
B00A - R0014 - Movement - (8.72 SQM)	Not Applicable	Circulation or storage space.
B00A - R0015 - Entry Vestibule - (10.79 SQM)	Not Applicable	Circulation or storage space.
B00A - R0016 - Clerical Office - (12.08 SQM)	Office (3)	
B00B - R0004 - Canteen - (17.91 SQM)	Not Applicable	Circulation or storage space.
B00B - R0005 - Movement - (8.55 SQM)	Not Applicable	Circulation or storage space.
B00B - R0007 - Communal Space - (83.87 SQM)	Student Space (38)	
B00B - R0008 - Raised Platform - (16.97 SQM)	Not Applicable	Circulation or storage space.
B00C - R0001 - Movement - (8.58 SQM)	Not Applicable	Circulation or storage space.
B00E - R0004 - Home Base - (47.1 SQM) - Teaching Space: 1	Student Space (21)	
B00E - R0005 - Home Base - (46.91 SQM) - Teaching Space: 1	Student Space (21)	
B00E - R0006 - Home Base - (47.04 SQM) - Teaching Space: 1	Student Space (21)	
B00E - R0007 - Home Base - (47.04 SQM) - Teaching Space: 1	Student Space (21)	
B00E - R0014 - Practical Activities - 1hb - (23.76 SQM)	Student Space (11)	
B00E - R0016 - Withdrawal Space - 2hb - (11 SQM)	Student Space (5)	
B00E - R0017 - Practical Activities - 1hb - (19.38 SQM)	Student Space (8)	
B00F - R0002 - Home Base - (52.33 SQM) - Teaching Space: 1	Student Space (24)	
B00F - R0003 - Home Base - (52.48 SQM) - Teaching Space: 1	Student Space (24)	
B00F - R0005 - Home Base - (66.97 SQM) - Teaching Space: 1	Student Space (31)	
B00F - R0007 - Staff Room Annexe - (15.51 SQM)	Office (3)	
B00G - R0001 - Movement - (34.86 SQM)	Not Applicable	Circulation or storage space.
B00G - R0002 - Home Base - (52.48 SQM) - Teaching Space: 1	Student Space (24)	
B00G - R0003 - Home Base - (52.41 SQM) - Teaching Space: 1	Student Space (24)	
B00H - R0001 - Movement - (44.5 SQM)	Not Applicable	Circulation or storage space.
B00H - R0012 - Home Base - (86.06 SQM) - Teaching Space: 1	Student Space (39)	
B00I - R0001 - Reading Area - (165.55 SQM)	Student Space (76)	
B00I - R0003 - Duplicating Workroom - (7.86 SQM)	Office (1)	
B00I - R0006 - Movement - (10.98 SQM)	Not Applicable	Circulation or storage space.
B00J - R0001 - Home Base - (58.55 SQM) - Teaching Space: 1	Student Space (27)	
B00J - R0003 - Practical Activities - 1hb - (18.86 SQM)	Student Space (8)	
B00J - R0004 - Withdrawal Space - 2hb - (11.44 SQM)	Student Space (5)	
B00J - R0005 - Home Base - (58.55 SQM) - Teaching Space: 1	Student Space (27)	
B00J - R0007 - Practical Activities - 1hb - (18.84 SQM)	Student Space (8)	