

VENTILATION AUDIT REPORT

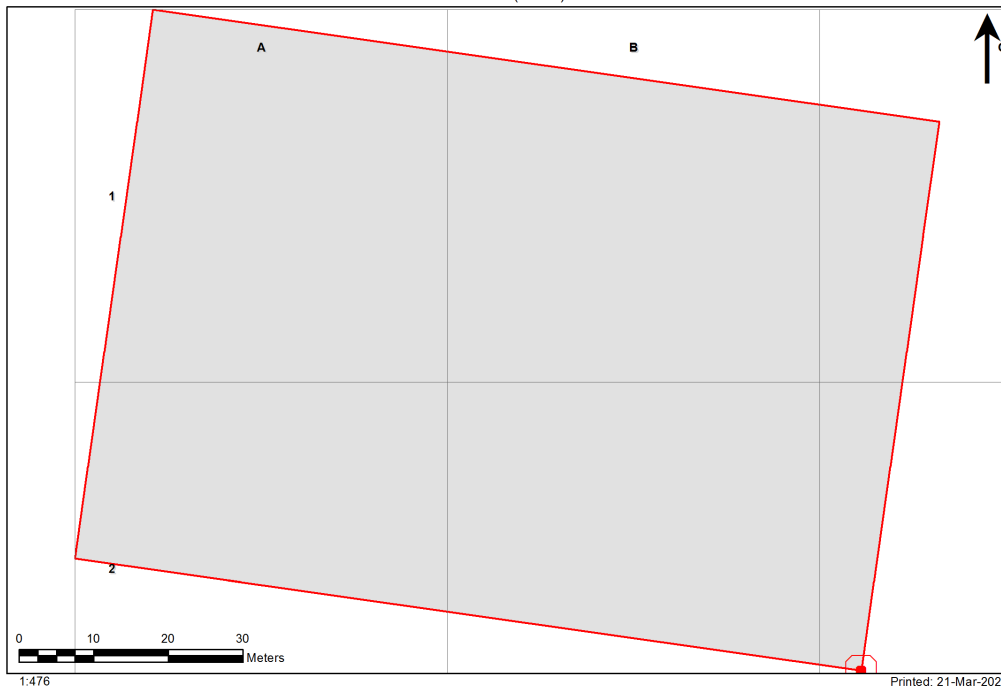







SCHOOL:	Whitton-Murrami Public School (3438)
AMU REGION:	Southern NSW
STATE ELECTORATE:	Murray
LOCAL GOVERNMENT AREA:	Leeton

3438 - Whitton-Murrami Public School
Site Plan (13332)



Ventilation Audit Key

Category	Description
	Category A Operate this space in line with COVID safe school operations . It has the required level of natural ventilation. NB. Circulation and storage areas should not be used for groups or gatherings.
	Category B This space should be occupied at 1 person per 4m ² to comply with COVID safe school operations and the guided use of spaces . The report details the number of people who can be accommodated safely in each of the identified spaces.

Entity Location	Audit Condition Classification (Capacity)	Comment
B00A - R0001 - Principal - (14.35 SQM)	 Office (3)	
B00A - R0005 - Reading Area - (54.89 SQM)	 Student Space (25)	
B00A - R0006 - Home Base - (84.78 SQM) - Teaching Space: 1	 Student Space (39)	
B00A - R0011 - Staff Room - (13.47 SQM)	 Office (3)	
B00A - R0013 - Home Base - (57.2 SQM) - Teaching Space: 1	 Student Space (26)	
B00A - R0015 - Entry Vestibule - (17 SQM)	Not Applicable	Circulation or storage space.
B00A - R0016 - Clerical Office - (8.71 SQM)	 Office (2)	
B00B - R0003 - Movement - (24.39 SQM)	Not Applicable	Circulation or storage space.
B00E - R0001 - Reading Area - (91.68 SQM)	 Student Space (42)	
B00H - R0002 - Home Base - (61.19 SQM) - Teaching Space: 1	 Student Space (28)	