

VENTILATION AUDIT REPORT

SCHOOL:	Westmead Public School (3883)
AMU REGION:	Western Sydney
STATE ELECTORATE:	Granville
LOCAL GOVERNMENT AREA:	Cumberland

3883 - Westmead Public School
Site Plan (12901)

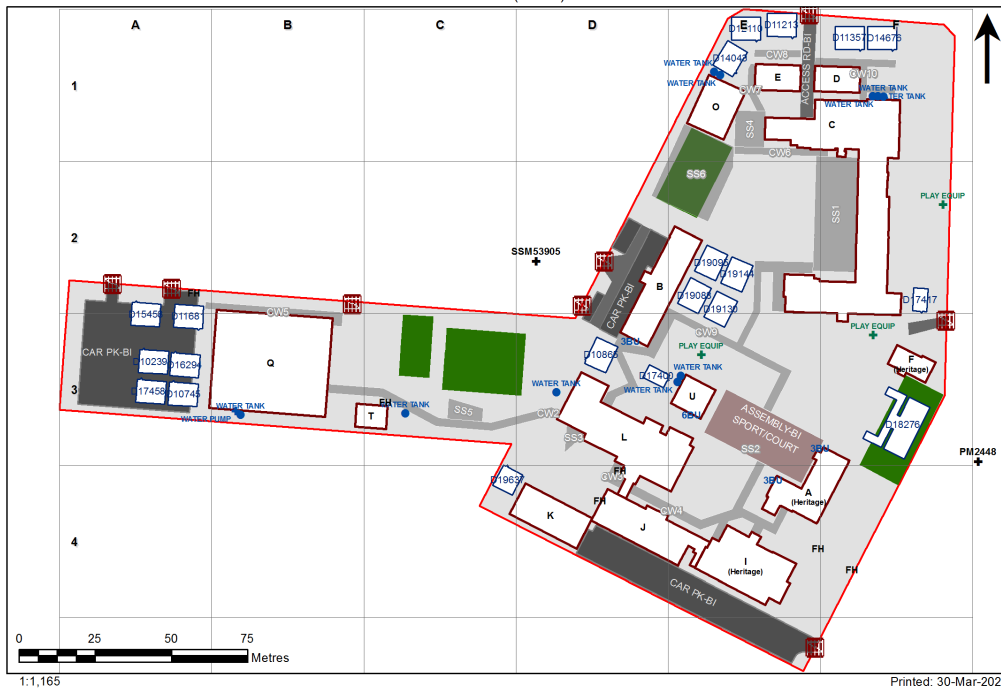

1:1,165

Printed: 30-Mar-2021

Ventilation Audit Key

Category	Description
	Category A Operate this space in line with COVID safe school operations . It has the required level of natural ventilation. NB. Circulation and storage areas should not be used for groups or gatherings.
	Category B This space should be occupied at 1 person per 4m ² to comply with COVID safe school operations and the guided use of spaces . The report details the number of people who can be accommodated safely in each of the identified spaces.

Entity Location	Audit Condition Classification (Capacity)	Comment
B00A - R0005 - Interview - (16.77 SQM)	Office (4)	
B00A - R0018 - Movement - (13.22 SQM)	Not Applicable	Circulation or storage space.
B00A - R0019 - Seminar/Study - (12.41 SQM)	Office (3)	
B00A - R0022 - Staff Room - (150.71 SQM)	Office (37)	
B00A - R0023 - Staff Kitchen - (13.1 SQM)	Office (3)	
B00A - R1011 - Home Base - (64.75 SQM) - Teaching Space: 1	Student Space (30)	
B00A - R1012 - Withdrawal Space - 2hb - (16.07 SQM)	Student Space (7)	
B00A - R1013 - Home Base - (67.42 SQM) - Teaching Space: 1	Student Space (31)	
B00A - R1014 - Movement - (67.72 SQM)	Not Applicable	Circulation or storage space.
B00B - R0002 - Home Base - (53.23 SQM) - Teaching Space: 1	Student Space (24)	
B00B - R0003 - Home Base - (53.16 SQM) - Teaching Space: 1	Student Space (24)	
B00B - R0004 - Staff Room Annexe - (10.95 SQM)	Office (2)	
B00B - R0006 - Home Base - (53.53 SQM) - Teaching Space: 1	Student Space (24)	
B00B - R0007 - Home Base - (53.24 SQM) - Teaching Space: 1	Student Space (24)	
B00B - R0010 - Movement - (93.2 SQM)	Not Applicable	Circulation or storage space.
B00B - R0011 - Movement - (6.81 SQM)	Not Applicable	Circulation or storage space.
B00C - R0002 - Home Base - (107.59 SQM) - Teaching Space: 1	Student Space (49)	
B00C - R0006 - Home Base - (59.36 SQM) - Teaching Space: 1	Student Space (27)	
B00C - R0012 - Deputy Principal - (15.62 SQM)	Office (3)	
B00C - R0014 - Entry Vestibule - (7.66 SQM)	Not Applicable	Circulation or storage space.
B00C - R0015 - Special Programs Room - (29.42 SQM)	Student Space (13)	
B00C - R0017 - Home Base - (51.83 SQM) - Teaching Space: 1	Student Space (24)	
B00C - R0018 - Movement - (6.09 SQM)	Not Applicable	Circulation or storage space.
B00C - R0019 - Movement - (6.09 SQM)	Not Applicable	Circulation or storage space.
B00C - R0020 - Home Base - (52.16 SQM) - Teaching Space: 1	Student Space (24)	
B00C - R0021 - Home Base - (52.16 SQM) - Teaching Space: 1	Student Space (24)	
B00C - R0022 - Movement - (6.1 SQM)	Not Applicable	Circulation or storage space.
B00C - R0023 - Movement - (5.63 SQM)	Not Applicable	Circulation or storage space.
B00C - R0024 - Home Base - (52.03 SQM) - Teaching Space: 1	Student Space (24)	
B00C - R0025 - Home Base - (73.24 SQM) - Teaching Space: 1	Student Space (33)	
B00C - R0027 - Withdrawal Space - 1hb - (14.45 SQM)	Student Space (6)	
B00C - R0028 - Movement - (85.62 SQM)	Not Applicable	Circulation or storage space.
B00C - R0029 - Movement - (7.21 SQM)	Not Applicable	Circulation or storage space.
B00C - R0035 - Movement - (11.56 SQM)	Not Applicable	Circulation or storage space.
B00C - R0036 - Movement - (12.17 SQM)	Not Applicable	Circulation or storage space.
B00C - R0037 - Movement - (106.74 SQM)	Not Applicable	Circulation or storage space.
B00C - R0041 - Movement - (79.16 SQM)	Not Applicable	Circulation or storage space.
B00C - R0042 - Movement - (5.2 SQM)	Not Applicable	Circulation or storage space.
B00C - R0043 - Movement - (6.42 SQM)	Not Applicable	Circulation or storage space.
B00C - R0048 - Home Base - (52.06 SQM) - Teaching Space: 1	Student Space (24)	
B00C - R0049 - Home Base - (52.03 SQM) - Teaching Space: 1	Student Space (24)	
B00C - R0050 - Withdrawal Space - 1hb - (10.57 SQM)	Student Space (4)	
B00D - R0002 - Home Base - (46.81 SQM) - Teaching Space: 1	Student Space (21)	
B00D - R0003 - Withdrawal Space - 1hb - (46.87 SQM)	Student Space (21)	
B00E - R0002 - Home Base - (47.09 SQM) - Teaching Space: 1	Student Space (21)	
B00E - R0003 - Home Base - (47.08 SQM) - Teaching Space: 1	Student Space (21)	
B00F - R0003 - Movement - (12.2 SQM)	Not Applicable	Circulation or storage space.
B00F - R0006 - Movement - (15.25 SQM)	Not Applicable	Circulation or storage space.
B00I - R0007 - Principal - (28.7 SQM)	Office (7)	
B00I - R0015 - Movement - (10.41 SQM)	Not Applicable	Circulation or storage space.

Entity Location	Audit Condition Classification (Capacity)	Comment
B00I - R0022 - Staff Room Annexe - (27.89 SQM)	Office (6)	
B00I - R0024 - Interview - (14.56 SQM)	Office (3)	
B00I - R0025 - Movement - (87.84 SQM)	Not Applicable	Circulation or storage space.
B00I - R0030 - Sick Bay - (8.63 SQM)	Student Space (4)	
B00I - R0031 - Clerical Office - (26.27 SQM)	Office (6)	
B00I - R0032 - Duplicating Workroom - (28.8 SQM)	Office (7)	
B00I - R0035 - Movement - (7.95 SQM)	Not Applicable	Circulation or storage space.
B00I - R0036 - Staff Room - (56.85 SQM)	Office (14)	
B00I - R0037 - Staff Kitchen - (11.2 SQM)	Office (2)	
B00I - R1001 - Movement - (8.64 SQM)	Not Applicable	Circulation or storage space.
B00I - R1002 - Staff Room Annexe - (8.72 SQM)	Office (2)	
B00I - R1003 - Movement - (5.88 SQM)	Not Applicable	Circulation or storage space.
B00I - R1004 - Deputy Principal - (15.72 SQM)	Office (3)	
B00I - R1005 - Movement - (9.03 SQM)	Not Applicable	Circulation or storage space.
B00I - R1006 - Home Base - (79.54 SQM) - Teaching Space: 1	Student Space (36)	
B00I - R1008 - Withdrawal Space - 1hb - (9.54 SQM)	Student Space (4)	
B00I - R1009 - Home Base - (49.33 SQM) - Teaching Space: 1	Student Space (22)	
B00I - R1010 - Movement - (9.83 SQM)	Not Applicable	Circulation or storage space.
B00I - R1011 - Movement - (46.34 SQM)	Not Applicable	Circulation or storage space.
B00I - R1012 - Withdrawal Space - 1hb - (28.61 SQM)	Student Space (13)	
B00J - R0002 - Movement - (8.1 SQM)	Not Applicable	Circulation or storage space.
B00J - R0006 - Communal Space - (228.07 SQM)	Student Space (105)	
B00J - R0016 - Movement - (11.99 SQM)	Not Applicable	Circulation or storage space.
B00J - R1004 - Movement - (6.73 SQM)	Not Applicable	Circulation or storage space.
B00J - R1005 - Staff Room Annexe - (14.99 SQM)	Office (3)	
B00J - R1006 - Home Base - (55.77 SQM) - Teaching Space: 1	Student Space (25)	
B00J - R1007 - Home Base - (55.6 SQM) - Teaching Space: 1	Student Space (25)	
B00J - R1008 - Home Base - (56.64 SQM) - Teaching Space: 1	Student Space (26)	
B00J - R1015 - Movement - (91.4 SQM)	Not Applicable	Circulation or storage space.
B00J - R2010 - Home Base - (55.9 SQM) - Teaching Space: 1	Student Space (25)	
B00J - R2018 - Home Base - (66.56 SQM) - Teaching Space: 1	Student Space (30)	
B00J - R2019 - Home Base - (81.03 SQM) - Teaching Space: 1	Student Space (37)	
B00J - R2020 - Movement - (91.08 SQM)	Not Applicable	Circulation or storage space.
B00K - R0001 - Movement - (60.13 SQM)	Not Applicable	Circulation or storage space.
B00K - R0002 - Staff Kitchen - (20.81 SQM)	Office (5)	
B00K - R0009 - Movement - (20.03 SQM)	Not Applicable	Circulation or storage space.
B00L - R0003 - Movement - (18.07 SQM)	Not Applicable	Circulation or storage space.
B00L - R0012 - Canteen - (22.9 SQM)	Not Applicable	Circulation or storage space.
B00L - R0013 - Staff Kitchen - (9.14 SQM)	Office (2)	
B00L - R0018 - Movement - (21.92 SQM)	Not Applicable	Circulation or storage space.
B00L - R0023 - Movement - (112.07 SQM)	Not Applicable	Circulation or storage space.
B00L - R0026 - Movement - (23.52 SQM)	Not Applicable	Circulation or storage space.
B00L - R0028 - Canteen - (60.33 SQM)	Not Applicable	Circulation or storage space.
B00L - R0029 - Child Care Centre - (81.72 SQM)	Student Space (37)	
B00L - R0030 - Child Care Centre - (41.4 SQM)	Student Space (19)	
B00L - R1009 - Movement - (57.13 SQM)	Not Applicable	Circulation or storage space.
B00L - R1010 - Special Programs Room - (27.98 SQM)	Student Space (12)	
B00L - R1013 - Movement - (5.24 SQM)	Not Applicable	Circulation or storage space.
B00L - R1014 - Movement - (15.6 SQM)	Not Applicable	Circulation or storage space.
B00L - R1015 - Movement - (15.42 SQM)	Not Applicable	Circulation or storage space.
B00L - R1018 - Movement - (8.73 SQM)	Not Applicable	Circulation or storage space.

Entity Location	Audit Condition Classification (Capacity)	Comment
B00L - R1021 - Withdrawal Space - 1hb - (10.57 SQM)	● Student Space (4)	
B00L - R1022 - Practical Activities - 1hb - (17.63 SQM)	● Student Space (8)	
B00L - R1023 - Home Base - (54.19 SQM) - Teaching Space: 1	● Student Space (25)	
B00L - R1024 - Home Base - (62.65 SQM) - Teaching Space: 1	● Student Space (29)	
B00L - R1025 - Practical Activities - 1hb - (17.95 SQM)	● Student Space (8)	
B00L - R1026 - Withdrawal Space - 1hb - (11.48 SQM)	● Student Space (5)	
B00L - R2025 - Withdrawal Space - 1hb - (11.59 SQM)	● Student Space (5)	
B00L - R2028 - Movement - (57.83 SQM)	Not Applicable	Circulation or storage space.
B00L - R2031 - Movement - (5.27 SQM)	Not Applicable	Circulation or storage space.
B00L - R2032 - Movement - (15.71 SQM)	Not Applicable	Circulation or storage space.
B00L - R2034 - Movement - (17.37 SQM)	Not Applicable	Circulation or storage space.
B00L - R2035 - Movement - (8.37 SQM)	Not Applicable	Circulation or storage space.
B00L - R2040 - Withdrawal Space - 1hb - (9.42 SQM)	● Student Space (4)	
B00L - R2041 - Movement - (10.42 SQM)	Not Applicable	Circulation or storage space.
B00L - R2044 - Home Base - (64.44 SQM) - Teaching Space: 1	● Student Space (29)	
B00L - R2045 - Practical Activities - 1hb - (14.26 SQM)	● Student Space (6)	
B00L - R2046 - Practical Activities - 1hb - (17.22 SQM)	● Student Space (7)	
B00L - R2047 - Home Base - (70.36 SQM) - Teaching Space: 1	● Student Space (32)	
B00O - R0001 - Movement - (38.49 SQM)	Not Applicable	Circulation or storage space.
B00O - R0002 - Practical Activities - 1hb - (19.41 SQM)	● Student Space (9)	
B00O - R0004 - Home Base - (59.22 SQM) - Teaching Space: 1	● Student Space (27)	
B00O - R0005 - Withdrawal Space - 2hb - (11.36 SQM)	● Student Space (5)	
B00O - R0006 - Home Base - (59.22 SQM) - Teaching Space: 1	● Student Space (27)	
B00O - R0008 - Practical Activities - 1hb - (19.41 SQM)	● Student Space (9)	
B00Q - M1003 - Special Programs Room - (23.66 SQM)	● Student Space (10)	
B00Q - R0026 - Movement - (7.42 SQM)	Not Applicable	Circulation or storage space.
B00Q - R0030 - Movement - (127.37 SQM)	Not Applicable	Circulation or storage space.
B00Q - R0031 - Movement - (35.71 SQM)	Not Applicable	Circulation or storage space.
B00Q - R0036 - Interview - (13.51 SQM)	● Office (3)	
B00Q - R0038 - Home Base - (71.16 SQM) - Teaching Space: 1	● Student Space (33)	
B00Q - R0039 - Home Base - (77.91 SQM) - Teaching Space: 1	● Student Space (36)	
B00Q - R0040 - Practical Activities - (118.75 SQM)	● Student Space (55)	
B00Q - R0041 - Special Programs Room - (89.02 SQM)	● Student Space (41)	
B00Q - R0044 - Home Base - (62.7 SQM) - Teaching Space: 1	● Student Space (29)	
B00Q - R0046 - Home Base - (81.76 SQM) - Teaching Space: 1	● Student Space (37)	
B00Q - R0047 - Home Base - (76.33 SQM) - Teaching Space: 1	● Student Space (35)	
B00Q - R0048 - Home Base - (76.67 SQM) - Teaching Space: 1	● Student Space (35)	
B00Q - R0049 - Special Programs Room - (65.16 SQM)	● Student Space (30)	
B00Q - R0050 - Home Base - (69.31 SQM) - Teaching Space: 1	● Student Space (32)	
B00Q - R0051 - Movement - (15.43 SQM)	Not Applicable	Circulation or storage space.
B00Q - R0058 - Movement - (51.96 SQM)	Not Applicable	Circulation or storage space.
B00Q - R1002 - Movement - (17.78 SQM)	Not Applicable	Circulation or storage space.
B00Q - R1003 - Reading Area - (134.31 SQM)	● Student Space (62)	
B00Q - R1005 - Seminar/Study - (23.8 SQM)	● Office (5)	
B00Q - R1013 - Staff Kitchen - (6.85 SQM)	● Office (1)	
B00Q - R1014 - Staff Room - (26 SQM)	● Office (6)	
B00Q - R1015 - Movement - (34.6 SQM)	Not Applicable	Circulation or storage space.
B00Q - R1022 - Staff Room Annexe - (19.17 SQM)	● Office (4)	

Entity Location	Audit Condition Classification (Capacity)	Comment
B00Q - R1023 - Staff Room Annexe - (12.64 SQM)	Office (3)	
B00Q - R1024 - Movement - (21.44 SQM)	Not Applicable	Circulation or storage space.
B00Q - R1025 - Staff Room Annexe - (19.17 SQM)	Office (4)	
B00Q - R1026 - Movement - (16.02 SQM)	Not Applicable	Circulation or storage space.
B00Q - R1027 - Movement - (85.85 SQM)	Not Applicable	Circulation or storage space.
B00Q - R1033 - Special Programs Room - (82.16 SQM)	Student Space (38)	
B00Q - R1035 - Movement - (81.57 SQM)	Not Applicable	Circulation or storage space.
B00T - R0001 - Movement - (5.71 SQM)	Not Applicable	Circulation or storage space.
DS 615 18276 - DS 615 18276 - Learning Unit - Quad with PAA 2 Storey - (304 SQM)	Student Space (141)	
OS 600 19637 - OS 600 19637 - Learning Unit - Small - (57 SQM)	Student Space (26)	
OS 601 11213 - OS 601 11213 - Learning Unit - Standard/Withdrawal - (76 SQM)	Student Space (35)	
OS 601 11357 - OS 601 11357 - Learning Unit - Standard/Withdrawal - (76 SQM)	Student Space (35)	
OS 601 11953 - OS 601 11953 - Learning Unit - Standard/Withdrawal - (76 SQM)	Student Space (35)	
OS 601 12110 - OS 601 12110 - Learning Unit - Standard/Withdrawal - (76 SQM)	Student Space (35)	
OS 601 14676 - OS 601 14676 - Learning Unit - Standard/Withdrawal - (76 SQM)	Student Space (35)	
OS 602 10239 - OS 602 10239 - Learning Unit - Standard With P.A.A. - (76 SQM)	Student Space (35)	
OS 602 10865 - OS 602 10865 - Learning Unit - Standard With P.A.A. - (76 SQM)	Student Space (35)	
OS 602 11681 - OS 602 11681 - Learning Unit - Standard With P.A.A. - (76 SQM)	Student Space (35)	
OS 602 13542 - OS 602 13542 - Learning Unit - Standard With P.A.A. - (76 SQM)	Student Space (35)	
OS 602 15458 - OS 602 15458 - Learning Unit - Standard With P.A.A. - (76 SQM)	Student Space (35)	
OS 602 16294 - OS 602 16294 - Learning Unit - Standard With P.A.A. - (76 SQM)	Student Space (35)	
OS 602 18280 - OS 602 18280 - Learning Unit - Standard With P.A.A. - (76 SQM)	Student Space (35)	
OS 603 10745 - OS 603 10745 - Learning Unit - Standard With P.A.A. A/C - (76 SQM)	Student Space (35)	
OS 603 17458 - OS 603 17458 - Learning Unit - Standard With P.A.A. A/C - (76 SQM)	Student Space (35)	
OS 606 10347 - OS 606 10347 - Learning Unit - Standard With P.A.A A/C - (76 SQM)	Student Space (35)	
OS 606 19088 - OS 606 19088 - Learning Unit - Standard With P.A.A A/C - (76 SQM)	Student Space (35)	
OS 606 19095 - OS 606 19095 - Learning Unit - Standard With P.A.A A/C - (76 SQM)	Student Space (35)	
OS 606 19130 - OS 606 19130 - Learning Unit - Standard With P.A.A A/C - (76 SQM)	Student Space (35)	
OS 606 19143 - OS 606 19143 - Learning Unit - Standard With P.A.A A/C - (76 SQM)	Student Space (35)	
OS 606 19144 - OS 606 19144 - Learning Unit - Standard With P.A.A A/C - (76 SQM)	Student Space (35)	
OS 606 19157 - OS 606 19157 - Learning Unit - Standard With P.A.A A/C - (76 SQM)	Student Space (35)	
OS 750 17400 - OS 750 17400 - Learning Unit - ESL - (38 SQM)	Student Space (17)	
OS 750 17417 - OS 750 17417 - Learning Unit - ESL - (38 SQM)	Student Space (17)	
OS 751 14043 - OS 751 14043 - Learning Unit - ESL - (76 SQM)	Student Space (35)	