

VENTILATION AUDIT REPORT

SCHOOL:	West Pymble Public School (4283)
AMU REGION:	Northern Sydney
STATE ELECTORATE:	Ku-Ring-Gai
LOCAL GOVERNMENT AREA:	Ku-Ring-Gai

4283 - West Pymble Public School
Site Plan (10518)

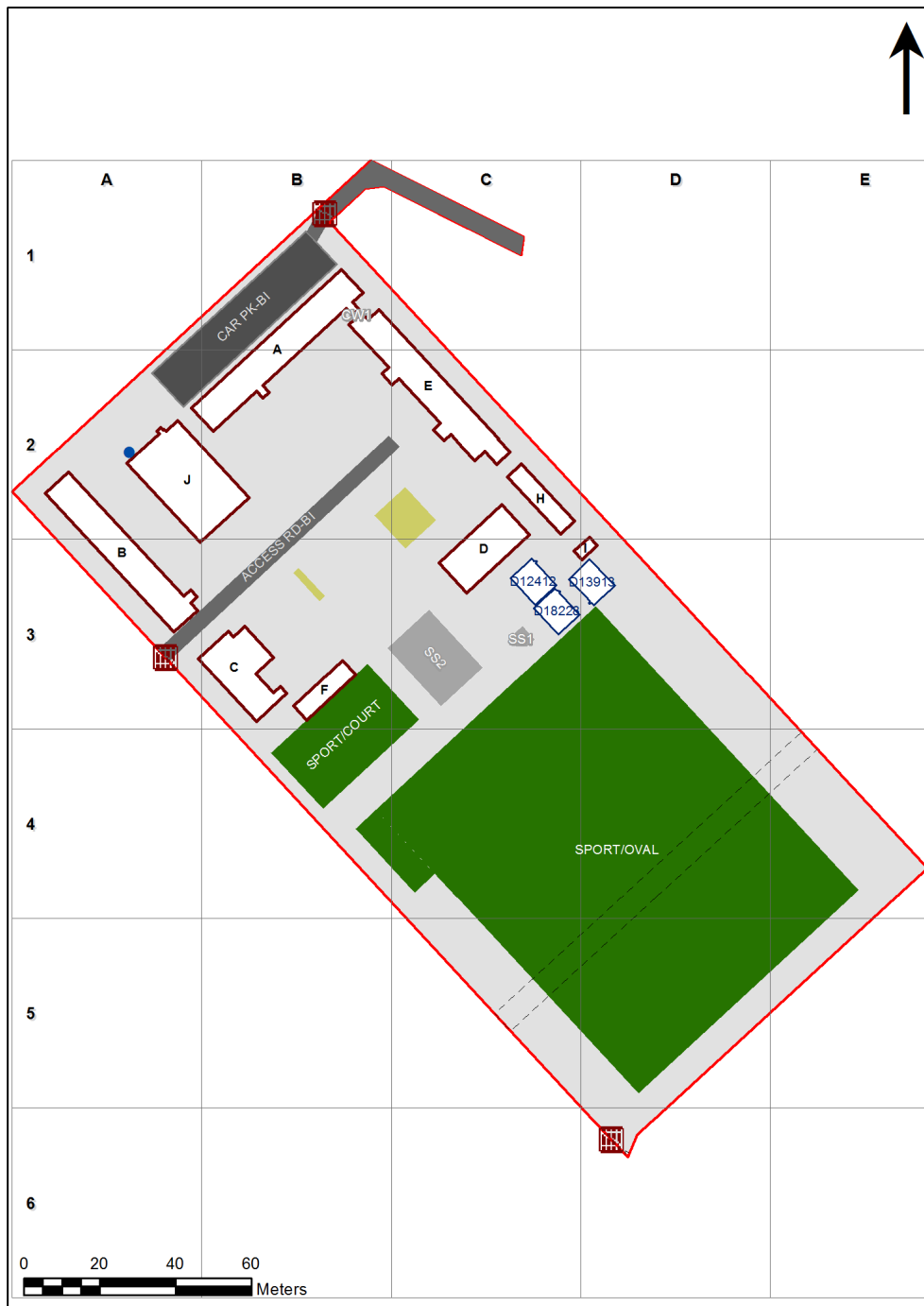

1:1,250

Printed: 06-May-2020

Ventilation Audit Key

Category	Description
	Category A Operate this space in line with COVID safe school operations . It has the required level of natural ventilation. NB. Circulation and storage areas should not be used for groups or gatherings.
	Category B This space should be occupied at 1 person per 4m ² to comply with COVID safe school operations and the guided use of spaces . The report details the number of people who can be accommodated safely in each of the identified spaces.

Entity Location	Audit Condition Classification (Capacity)	Comment
B00A - R0003 - Canteen - (17.04 SQM)	Not Applicable	Circulation or storage space.
B00A - R0004 - Movement - (23.82 SQM)	Not Applicable	Circulation or storage space.
B00A - R0005 - Home Base - (55.41 SQM) - Teaching Space: 1	● Student Space (25)	
B00A - R0008 - Movement - (6.62 SQM)	Not Applicable	Circulation or storage space.
B00A - R0010 - Home Base - (56.75 SQM) - Teaching Space: 1	● Student Space (26)	
B00A - R0012 - Home Base - (57.22 SQM) - Teaching Space: 1	● Student Space (26)	
B00A - R0020 - Staff Room - (56.74 SQM)	● Office (14)	
B00A - R0021 - Clerical Office - (21.6 SQM)	● Office (5)	
B00A - R0023 - Sick Bay - (6.24 SQM)	● Student Space (2)	
B00A - R0031 - Principal - (15.12 SQM)	● Office (3)	
B00A - R0034 - Entry Vestibule - (16.08 SQM)	Not Applicable	Circulation or storage space.
B00B - R0011 - Home Base - (56.89 SQM) - Teaching Space: 1	● Student Space (26)	
B00B - R0015 - Movement - (5.18 SQM)	Not Applicable	Circulation or storage space.
B00B - R0019 - Home Base - (56.81 SQM) - Teaching Space: 1	● Student Space (26)	
B00B - R0020 - Home Base - (56.81 SQM) - Teaching Space: 1	● Student Space (26)	
B00B - R0023 - Movement - (5.06 SQM)	Not Applicable	Circulation or storage space.
B00B - R0025 - Home Base - (57.12 SQM) - Teaching Space: 1	● Student Space (26)	
B00C - R0003 - Home Base - (85.08 SQM) - Teaching Space: 1	● Student Space (39)	
B00C - R0004 - Movement - (68.43 SQM)	Not Applicable	Circulation or storage space.
B00C - R0005 - Home Base - (55.83 SQM) - Teaching Space: 1	● Student Space (25)	
B00C - R9003 - Movement - (5.13 SQM)	Not Applicable	Circulation or storage space.
B00D - R0004 - Movement - (6.03 SQM)	Not Applicable	Circulation or storage space.
B00D - R0005 - Movement - (40.63 SQM)	Not Applicable	Circulation or storage space.
B00D - R0011 - Home Base - (56.53 SQM) - Teaching Space: 1	● Student Space (26)	
B00D - R0012 - Withdrawal - M - (9.4 SQM)	● Student Space (4)	
B00D - R0013 - Practical Activities - M - 2hb - (7.88 SQM)	● Student Space (3)	
B00D - R0016 - Home Base - (56.3 SQM) - Teaching Space: 1	● Student Space (26)	
B00D - R1002 - Movement - (53.42 SQM)	Not Applicable	Circulation or storage space.
B00D - R1004 - Home Base - (57.19 SQM) - Teaching Space: 1	● Student Space (26)	
B00D - R1007 - Special Programs Room - (57.02 SQM)	● Student Space (26)	
B00E - R0003 - Movement - (8.26 SQM)	Not Applicable	Circulation or storage space.
B00E - R0004 - Movement - (8.19 SQM)	Not Applicable	Circulation or storage space.
B00E - R0011 - Movement - (9.35 SQM)	Not Applicable	Circulation or storage space.
B00E - R0012 - Movement - (8.2 SQM)	Not Applicable	Circulation or storage space.
B00E - R0016 - Movement - (14.08 SQM)	Not Applicable	Circulation or storage space.
B00E - R0017 - Duplicating Workroom - (13.83 SQM)	● Office (3)	
B00E - R0021 - Movement - (14.44 SQM)	Not Applicable	Circulation or storage space.
B00E - R0024 - Reading Area - (190.6 SQM)	● Student Space (88)	
B00J - R0002 - Communal Space - (144.11 SQM)	● Student Space (66)	
B00J - R0003 - Raised Platform - (63.72 SQM)	Not Applicable	Circulation or storage space.
B00J - R0017 - Movement - (5.47 SQM)	Not Applicable	Circulation or storage space.
B00J - R0019 - Movement - (13.26 SQM)	Not Applicable	Circulation or storage space.
OS 601 12412 - OS 601 12412 - Learning Unit - Standard/Withdrawal - (76 SQM)	● Student Space (35)	
OS 601 13913 - OS 601 13913 - Learning Unit - Standard/Withdrawal - (76 SQM)	● Student Space (35)	
OS 602 18228 - OS 602 18228 - Learning Unit - Standard With P.A.A. - (76 SQM)	● Student Space (35)	