

VENTILATION AUDIT REPORT

SCHOOL:	Wee Waa Public School (3416)
AMU REGION:	North Western NSW
STATE ELECTORATE:	Barwon
LOCAL GOVERNMENT AREA:	Narrabri

3416 - Wee Waa Public School
Site Plan (13252)

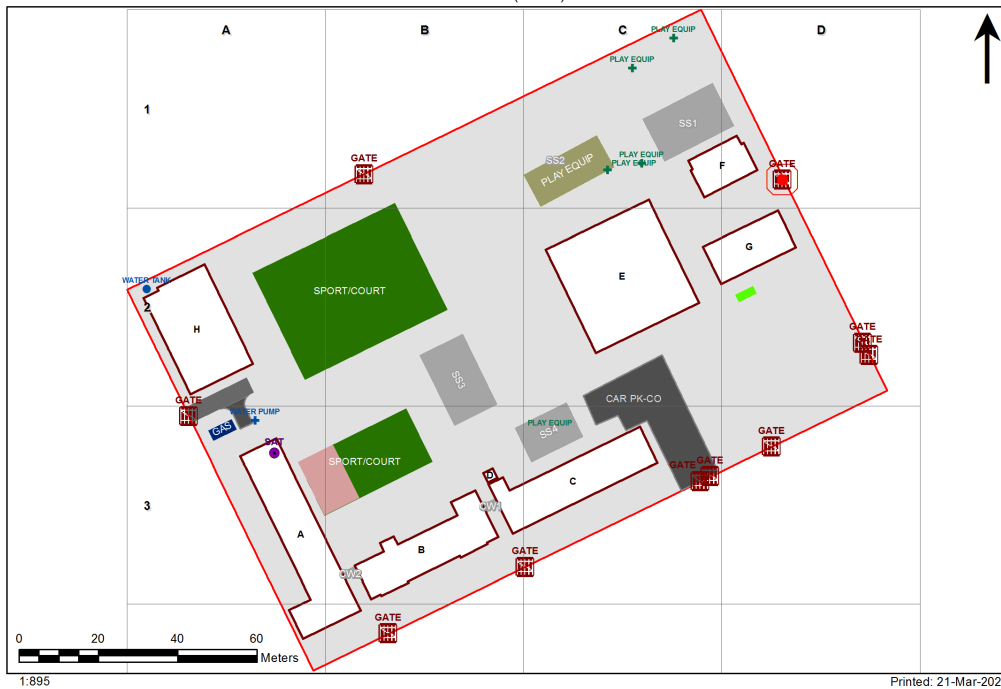

Ventilation Audit Key

Category	Description
	Category A Operate this space in line with COVID safe school operations . It has the required level of natural ventilation. NB. Circulation and storage areas should not be used for groups or gatherings.
	Category B This space should be occupied at 1 person per 4m ² to comply with COVID safe school operations and the guided use of spaces . The report details the number of people who can be accommodated safely in each of the identified spaces.

Entity Location	Audit Condition Classification (Capacity)	Comment
B00A - R0003 - Movement - (22.17 SQM)	Not Applicable	Circulation or storage space.
B00A - R0005 - Movement - (182.23 SQM)	Not Applicable	Circulation or storage space.
B00A - R1001 - Staff Room Annexe - (9.96 SQM)	Office (2)	
B00A - R1002 - Staff Room Annexe - (9.23 SQM)	Office (2)	
B00A - R1003 - Home Base - (89.56 SQM) - Teaching Space: 1	Student Space (41)	
B00A - R1004 - Movement - (6.84 SQM)	Not Applicable	Circulation or storage space.
B00A - R1005 - Movement - (59.08 SQM)	Not Applicable	Circulation or storage space.
B00A - R1008 - Home Base - (66.92 SQM) - Teaching Space: 1	Student Space (31)	
B00A - R1009 - Reading Area - (137.31 SQM)	Student Space (63)	
B00A - R1014 - Movement - (6.75 SQM)	Not Applicable	Circulation or storage space.
B00B - R0001 - Movement - (112.47 SQM)	Not Applicable	Circulation or storage space.
B00B - R0002 - Special Programs Room - (82.84 SQM)	Student Space (38)	
B00B - R0005 - Movement - (7.61 SQM)	Not Applicable	Circulation or storage space.
B00B - R1002 - Home Base - (50.05 SQM) - Teaching Space: 1	Student Space (23)	
B00B - R1003 - Home Base - (46.47 SQM) - Teaching Space: 1	Student Space (21)	
B00B - R1004 - Home Base - (46.13 SQM) - Teaching Space: 1	Student Space (21)	
B00B - R1005 - Home Base - (50.08 SQM) - Teaching Space: 1	Student Space (23)	
B00B - R1008 - Movement - (71.7 SQM)	Not Applicable	Circulation or storage space.
B00B - R1011 - Movement - (15.91 SQM)	Not Applicable	Circulation or storage space.
B00C - R0001 - Movement - (188.94 SQM)	Not Applicable	Circulation or storage space.
B00C - R0002 - Movement - (133.23 SQM)	Not Applicable	Circulation or storage space.
B00C - R0004 - Duplicating Workroom - (32.23 SQM)	Office (8)	
B00C - R1001 - Movement - (77.53 SQM)	Not Applicable	Circulation or storage space.
B00C - R1003 - Home Base - (53.1 SQM) - Teaching Space: 1	Student Space (24)	
B00C - R1005 - Movement - (15.08 SQM)	Not Applicable	Circulation or storage space.
B00C - R1006 - Home Base - (53.03 SQM) - Teaching Space: 1	Student Space (24)	
B00C - R1008 - Home Base - M - (52.81 SQM) - Teaching Space: 1	Student Space (24)	
B00C - R1010 - Movement - (15.04 SQM)	Not Applicable	Circulation or storage space.
B00C - R1013 - Home Base - (52.81 SQM) - Teaching Space: 1	Student Space (24)	
B00E - R0002 - Principal - (16.34 SQM)	Office (4)	
B00E - R0003 - Clerical Office - (16.72 SQM)	Office (4)	
B00E - R0005 - Entry Vestibule - (19.4 SQM)	Not Applicable	Circulation or storage space.
B00E - R0006 - Sick Bay - (11.52 SQM)	Student Space (5)	
B00E - R0009 - Movement - (36.46 SQM)	Not Applicable	Circulation or storage space.
B00E - R0019 - Staff Room - (44.69 SQM)	Office (11)	
B00E - R0021 - Practical Activities - 1hb - (16.04 SQM)	Student Space (7)	
B00E - R0023 - Home Base - (83.39 SQM) - Teaching Space: 1	Student Space (38)	
B00E - R0026 - Practical Activities - 1hb - (12.78 SQM)	Student Space (5)	
B00E - R0027 - Home Base - (61.85 SQM) - Teaching Space: 1	Student Space (28)	
B00E - R0028 - Staff Room Annexe - (15.3 SQM)	Office (3)	
B00E - R0029 - Staff Room Annexe - (11.64 SQM)	Office (2)	
B00E - R0031 - Movement - (197.32 SQM)	Not Applicable	Circulation or storage space.
B00E - R0032 - Canteen - (35.97 SQM)	Not Applicable	Circulation or storage space.
B00F - R0001 - Movement - (31.16 SQM)	Not Applicable	Circulation or storage space.
B00F - R0002 - Home Base - (53.83 SQM) - Teaching Space: 1	Student Space (24)	
B00F - R0003 - Home Base - (53.83 SQM) - Teaching Space: 1	Student Space (24)	
B00G - R0001 - Movement - (37.31 SQM)	Not Applicable	Circulation or storage space.
B00G - R0003 - Home Base - (55.97 SQM) - Teaching Space: 1	Student Space (25)	
B00G - R0005 - Home Base - (73.94 SQM) - Teaching Space: 1	Student Space (34)	
B00G - R0006 - Movement - (7.32 SQM)	Not Applicable	Circulation or storage space.

Entity Location	Audit Condition Classification (Capacity)	Comment
B00H - R0001 - Communal Space - (148.39 SQM)	● Student Space (68)	
B00H - R0002 - Raised Platform - (60.5 SQM)	Not Applicable	Circulation or storage space.
B00H - R0016 - Movement - (7.18 SQM)	Not Applicable	Circulation or storage space.
B00H - R0018 - Movement - (13.02 SQM)	Not Applicable	Circulation or storage space.