

VENTILATION AUDIT REPORT

SCHOOL:	Warrawee Public School (3390)
AMU REGION:	Northern Sydney
STATE ELECTORATE:	Ku-Ring-Gai
LOCAL GOVERNMENT AREA:	Ku-Ring-Gai

3390 - Warrawee Public School
Site Plan (11384)

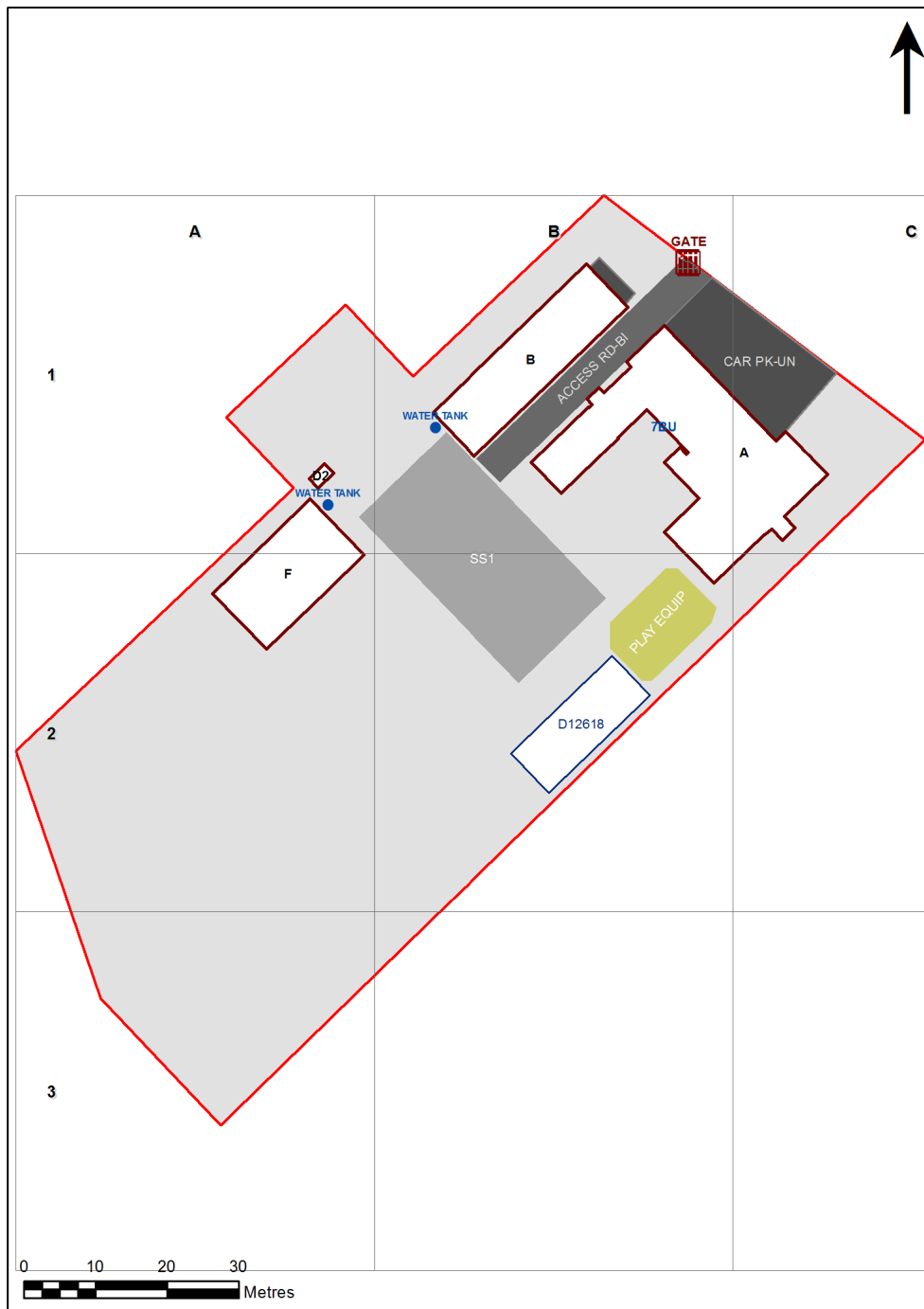

1:663

Printed: 07-Jul-2021

Ventilation Audit Key

Category	Description
	Category A Operate this space in line with COVID safe school operations . It has the required level of natural ventilation. NB. Circulation and storage areas should not be used for groups or gatherings.
	Category B This space should be occupied at 1 person per 4m ² to comply with COVID safe school operations and the guided use of spaces . The report details the number of people who can be accommodated safely in each of the identified spaces.

Entity Location	Audit Condition Classification (Capacity)	Comment
B00A - R0001 - Home Base - (66.19 SQM) - Teaching Space: 1	● Student Space (30)	
B00A - R0005 - Movement - (37.01 SQM)	Not Applicable	Circulation or storage space.
B00A - R0006 - Special Programs Room - (59.56 SQM)	● Student Space (27)	
B00A - R0007 - Staff Room - (42.28 SQM)	● Office (10)	
B00A - R0010 - Movement - (11.32 SQM)	Not Applicable	Circulation or storage space.
B00A - R0012 - Movement - (29.16 SQM)	Not Applicable	Circulation or storage space.
B00A - R0014 - Clerical Office - (11.29 SQM)	● Office (2)	
B00A - R0015 - Principal - (25.85 SQM)	● Office (6)	
B00A - R0018 - Clerical Office - (47.41 SQM)	● Office (11)	
B00A - R0023 - Canteen - (20.65 SQM)	Not Applicable	Circulation or storage space.
B00A - R0024 - Movement - (24.9 SQM)	Not Applicable	Circulation or storage space.
B00A - R1001 - Movement - (8.83 SQM)	Not Applicable	Circulation or storage space.
B00A - R1004 - Withdrawal Space - 1hb - (48.12 SQM)	● Student Space (22)	
B00A - R1005 - Home Base - (48.33 SQM) - Teaching Space: 1	● Student Space (22)	
B00A - R1006 - Home Base - (42.99 SQM) - Teaching Space: 1	● Student Space (19)	
B00A - R1007 - Home Base - (60.32 SQM) - Teaching Space: 1	● Student Space (27)	
B00A - R1008 - Movement - (20.67 SQM)	Not Applicable	Circulation or storage space.
B00A - R1010 - Movement - (25.37 SQM)	Not Applicable	Circulation or storage space.
B00A - R1013 - Home Base - (66.84 SQM) - Teaching Space: 1	● Student Space (31)	
B00B - R0001 - Home Base - (56.77 SQM) - Teaching Space: 1	● Student Space (26)	
B00B - R0004 - Movement - (5.46 SQM)	Not Applicable	Circulation or storage space.
B00B - R0010 - Home Base - (56.61 SQM) - Teaching Space: 1	● Student Space (26)	
B00B - R0011 - Home Base - (55.98 SQM) - Teaching Space: 1	● Student Space (25)	
B00B - R0012 - Interview - (19.53 SQM)	● Office (4)	
B00B - R0013 - Movement - (5.62 SQM)	Not Applicable	Circulation or storage space.
B00F - R0001 - Home Base - (56.86 SQM) - Teaching Space: 1	● Student Space (26)	
B00F - R0004 - Home Base - (56.71 SQM) - Teaching Space: 1	● Student Space (26)	
B00G - R0001 - Home Base - (85.63 SQM) - Teaching Space: 1	● Student Space (39)	
B00G - R0008 - Interview - (10.89 SQM)	● Office (2)	
B00G - R0009 - Sick Bay - (7.53 SQM)	● Student Space (3)	
B00G - R0010 - Entry Vestibule - (7.3 SQM)	Not Applicable	Circulation or storage space.
B00G - R0011 - Clerical Office - (11.78 SQM)	● Office (2)	
B00G - R0012 - Movement - (14.93 SQM)	Not Applicable	Circulation or storage space.
B00G - R0013 - Duplicating Workroom - (16.57 SQM)	● Office (4)	
B00G - R0015 - Principal - (11.09 SQM)	● Office (2)	
B00G - R0016 - Staff Room - (56.74 SQM)	● Office (14)	
B00G - R0019 - Movement - (5.13 SQM)	Not Applicable	Circulation or storage space.
B00G - R0025 - Home Base - (56.9 SQM) - Teaching Space: 1	● Student Space (26)	
B00G - R9008 - Staff Kitchen - (10.5 SQM)	● Office (2)	
B00G - R9009 - Clerical Office - (9.72 SQM)	● Office (2)	
B00H - R0001 - Home Base - (57.67 SQM) - Teaching Space: 1	● Student Space (26)	
B00H - R0009 - Home Base - (57.52 SQM) - Teaching Space: 1	● Student Space (26)	
B00H - R9003 - Special Programs Room - (86.23 SQM)	● Student Space (40)	
B00I - R0002 - Home Base - (61.4 SQM) - Teaching Space: 1	● Student Space (28)	
B00I - R0004 - Withdrawal Space - 1hb - (11.29 SQM)	● Student Space (5)	
B00I - R0007 - Home Base - (61.39 SQM) - Teaching Space: 1	● Student Space (28)	
B00I - R0012 - Practical Activities - 1hb - (35.69 SQM)	● Student Space (16)	
B00I - R0015 - Movement - (11.05 SQM)	Not Applicable	Circulation or storage space.
B00J - R0001 - Home Base - (53.15 SQM) - Teaching Space: 1	● Student Space (24)	

Entity Location	Audit Condition Classification (Capacity)	Comment
B00J - R0002 - Home Base - (53.15 SQM) - Teaching Space: 1	● Student Space (24)	
B00K - R0002 - Home Base - M - (53.66 SQM) - Teaching Space: 1	● Student Space (24)	
B00K - R0003 - Withdrawal Space - 1hb - (53.8 SQM)	● Student Space (24)	
B00L - R0008 - Home Base - (66.19 SQM) - Teaching Space: 1	● Student Space (30)	
B00L - R0009 - Withdrawal Space - 2hb - (14.63 SQM)	● Student Space (6)	
B00L - R0010 - Practical Activities - 2hb - (16.46 SQM)	● Student Space (7)	
B00L - R0011 - Home Base - (54.12 SQM) - Teaching Space: 1	● Student Space (25)	
B00O - R0002 - Communal Space - (199.9 SQM)	● Student Space (92)	
B00O - R0003 - Raised Platform - (56.64 SQM)	Not Applicable	Circulation or storage space.
B00O - R0016 - Movement - (6.3 SQM)	Not Applicable	Circulation or storage space.
B00O - R0017 - Movement - (16.77 SQM)	Not Applicable	Circulation or storage space.
B00O - R0018 - Movement - (12.91 SQM)	Not Applicable	Circulation or storage space.
OS 534 12618 - OS 534 12618 - Library/Group Study/Office/A V Store - (152 SQM)	● Student Space (70)	
OS 600 18032 - OS 600 18032 - Learning Unit - Small - (57 SQM)	● Student Space (26)	
OS 602 10244 - OS 602 10244 - Learning Unit - Standard With P.A.A. - (76 SQM)	● Student Space (35)	
OS 602 11709 - OS 602 11709 - Learning Unit - Standard With P.A.A. - (76 SQM)	● Student Space (35)	
OS 602 12245 - OS 602 12245 - Learning Unit - Standard With P.A.A. - (76 SQM)	● Student Space (35)	
OS 602 12629 - OS 602 12629 - Learning Unit - Standard With P.A.A. - (76 SQM)	● Student Space (35)	
OS 602 13946 - OS 602 13946 - Learning Unit - Standard With P.A.A. - (76 SQM)	● Student Space (35)	
OS 602 16194 - OS 602 16194 - Learning Unit - Standard With P.A.A. - (76 SQM)	● Student Space (35)	
OS 606 19219 - OS 606 19219 - Learning Unit - Standard With P.A.A A/C - (76 SQM)	● Student Space (35)	
OS 606 19602 - OS 606 19602 - Learning Unit - Standard With P.A.A A/C - (76 SQM)	● Student Space (35)	
OS 606 19606 - OS 606 19606 - Learning Unit - Standard With P.A.A A/C - (76 SQM)	● Student Space (35)	