

# VENTILATION AUDIT REPORT

<b>SCHOOL:</b>	<b>Turramurra High School (8435)</b>
<b>AMU REGION:</b>	<b>Northern Sydney</b>
<b>STATE ELECTORATE:</b>	<b>Ku-Ring-Gai</b>
<b>LOCAL GOVERNMENT AREA:</b>	<b>Ku-Ring-Gai</b>

8435 - Turramurra High School  
Site Plan (10757)

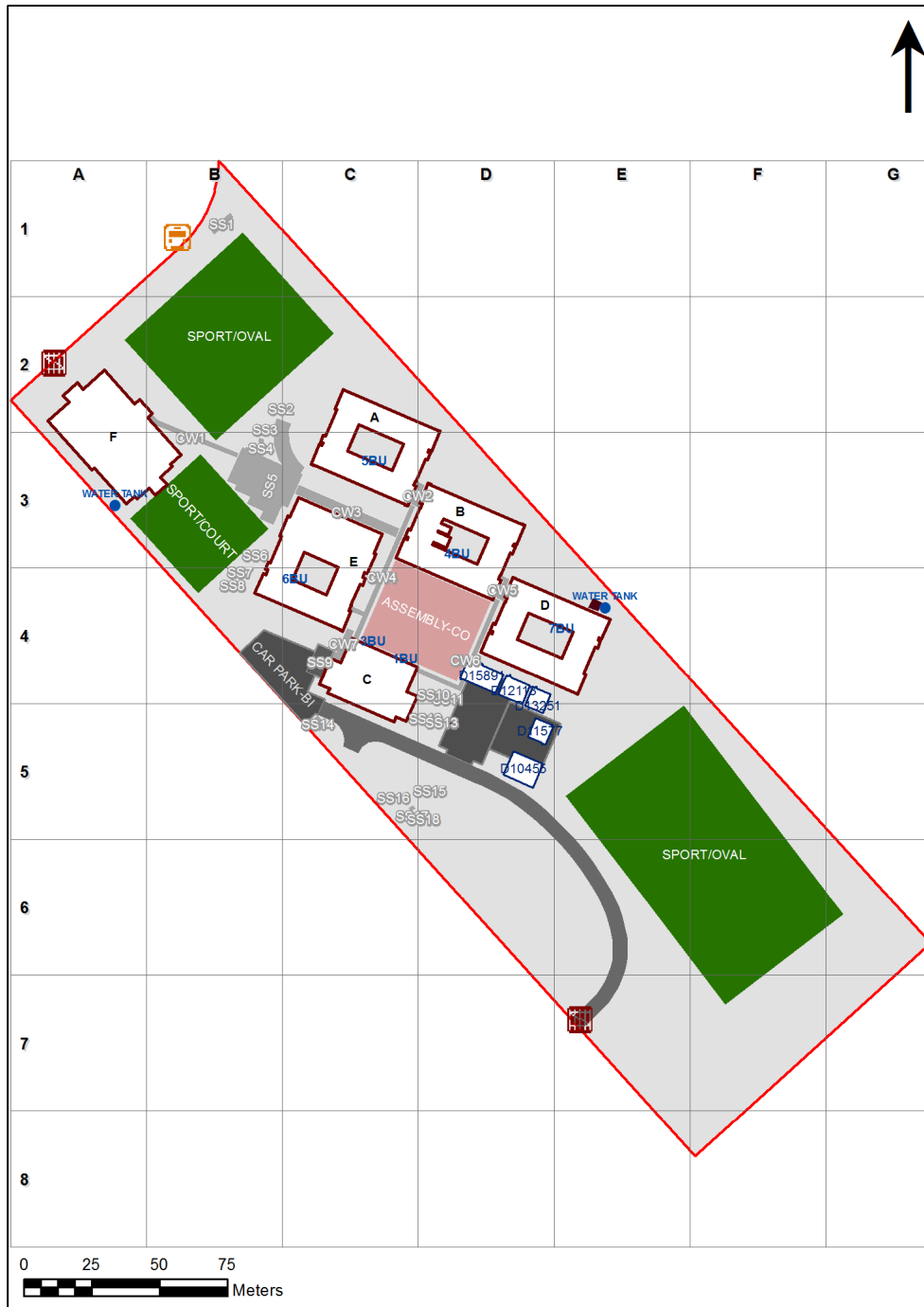

1:1,748

Printed: 17-Apr-2020

## Ventilation Audit Key

Category	Description
	Category A Operate this space in line with <a href="#">COVID safe school operations</a> . It has the required level of natural ventilation. NB. Circulation and storage areas should not be used for groups or gatherings.
	Category B This space should be occupied at 1 person per 4m <sup>2</sup> to comply with <a href="#">COVID safe school operations and the guided use of spaces</a> . The report details the number of people who can be accommodated safely in each of the identified spaces.

Entity Location	Audit Condition Classification (Capacity)	Comment
B00A - R0004 - General Learning Space - (52.73 SQM) - Teaching Space: 1	Student Space (24)	
B00A - R0007 - Deputy Principal Office - (18.56 SQM)	Office (4)	
B00A - R0024 - Principal Office - (20.75 SQM)	Office (5)	
B00A - R0031 - Deputy Principal Office - (24.92 SQM)	Office (6)	
B00A - R0032 - General Learning Space - (58.44 SQM) - Teaching Space: 1	Student Space (27)	
B00A - R0037 - Staff Lounge - (12.11 SQM)	Office (3)	
B00A - R0038 - Staff Kitchen - (12.45 SQM)	Office (3)	
B00A - R0040 - Laboratory L.S. - (93.19 SQM) - Teaching Space: 1	Student Space (43)	
B00A - R0041 - Preparation - Science - (29.04 SQM)	Not Applicable	Circulation or storage space.
B00A - R0042 - Laboratory L.S. - (85.52 SQM) - Teaching Space: 1	Student Space (39)	
B00A - R0043 - Administration - Clerical - (13.38 SQM)	Office (3)	
B00A - R0044 - Administration - Clerical - (48.63 SQM)	Office (12)	
B00A - R0045 - Public Reception - (40.23 SQM)	Not Applicable	Circulation or storage space.
B00A - R0046 - Deputy Principal Office - (17.07 SQM)	Office (4)	
B00A - R0048 - Clinic - (15.79 SQM)	Office (3)	
B00A - R1003 - General Learning Space - (52.44 SQM) - Teaching Space: 1	Student Space (24)	
B00A - R1007 - General Learning Space - (52.58 SQM) - Teaching Space: 1	Student Space (24)	
B00A - R1008 - General Learning Space - (52.65 SQM) - Teaching Space: 1	Student Space (24)	
B00A - R1012 - General Learning Space - (52.65 SQM) - Teaching Space: 1	Student Space (24)	
B00A - R1014 - Interview/Office - Type 1 - (12.96 SQM)	Office (3)	
B00A - R1015 - Computer Learning Space - (58.67 SQM) - Teaching Space: 1	Student Space (27)	
B00A - R1017 - General Learning Space - (52.8 SQM) - Teaching Space: 1	Student Space (24)	
B00A - R1019 - Textiles Technology L.S. - (65.96 SQM) - Teaching Space: 1	Student Space (30)	
B00A - R1022 - Textiles Technology L.S. - (71.69 SQM) - Teaching Space: 1	Student Space (33)	
B00A - R1027 - Commonroom - (58.66 SQM)	Office (14)	
B00A - R1028 - Seminar - (79.49 SQM)	Office (19)	
B00B - R0004 - Music Learning Space - (52.8 SQM) - Teaching Space: 1	Student Space (24)	
B00B - R0006 - Practice/Seminar - (5.58 SQM)	Not Applicable	Circulation or storage space.
B00B - R0007 - Metal Technology L.S. - (85.02 SQM) - Teaching Space: 1	Student Space (39)	
B00B - R0010 - Metal Technology L.S. - (92.98 SQM) - Teaching Space: 1	Student Space (43)	
B00B - R0015 - Design L.S. - (52.13 SQM) - Teaching Space: 1	Student Space (24)	
B00B - R0017 - Staff Study - (31.97 SQM)	Office (7)	
B00B - R0029 - General Learning Space - (25.81 SQM) - Teaching Space: 1	Student Space (11)	
B00B - R0030 - Food Technology L.S. - (66.33 SQM) - Teaching Space: 1	Student Space (30)	
B00B - R0031 - Preparation - Materials - (16.69 SQM)	Not Applicable	Circulation or storage space.
B00B - R0033 - Food Technology L.S. - (89.93 SQM) - Teaching Space: 1	Student Space (41)	
B00B - R0034 - Staff Study - (31.69 SQM)	Office (7)	
B00B - R0037 - Welding Area - (14.2 SQM)	Not Applicable	Circulation or storage space.
B00B - R0043 - Computer Learning Space - (55.77 SQM) - Teaching Space: 1	Student Space (25)	
B00B - R1003 - Music Learning Space - (52.73 SQM) - Teaching Space: 1	Student Space (24)	
B00B - R1006 - Wood Technology L.S. - (85.24 SQM) - Teaching Space: 1	Student Space (39)	
B00B - R1007 - Materials Workshop - Type 3 - (17.41 SQM)	Student Space (8)	
B00B - R1009 - Wood Technology L.S. - (79.56 SQM) - Teaching Space: 1	Student Space (36)	
B00B - R1010 - General Learning Space - (58.36 SQM) - Teaching Space: 1	Student Space (27)	
B00B - R1013 - General Learning Space - (52.65 SQM) - Teaching Space: 1	Student Space (24)	
B00B - R1014 - Staff Study - (31.42 SQM)	Office (7)	
B00B - R1016 - Art Learning Space - (52.58 SQM) - Teaching Space: 1	Student Space (24)	

Entity Location	Audit Condition Classification (Capacity)	Comment
B00B - R1019 - Art Learning Space - (52.43 SQM) - Teaching Space: 1	● Student Space (24)	
B00B - R1021 - Art Learning Space - (71.55 SQM) - Teaching Space: 1	● Student Space (33)	
B00C - R0005 - Movement - (14.29 SQM)	Not Applicable	Circulation or storage space.
B00C - R0006 - Multi-Purpose Space - (334.94 SQM)	● Student Space (155)	
B00C - R0007 - Student Canteen - (56.83 SQM)	Not Applicable	Circulation or storage space.
B00C - R0012 - General Assistants - (13.89 SQM)	● Office (3)	
B00C - R0014 - Movement - (13.99 SQM)	Not Applicable	Circulation or storage space.
B00C - R1006 - Movement - (12.38 SQM)	Not Applicable	Circulation or storage space.
B00C - R1012 - Movement - (12.08 SQM)	Not Applicable	Circulation or storage space.
B00D - R0004 - General Learning Space - (52.8 SQM) - Teaching Space: 1	● Student Space (24)	
B00D - R0006 - Staff Study - (13 SQM)	● Office (3)	
B00D - R0007 - General Learning Space - (58.73 SQM) - Teaching Space: 1	● Student Space (27)	
B00D - R0008 - Laboratory L.S. - (92.86 SQM) - Teaching Space: 1	● Student Space (43)	
B00D - R0009 - Preparation - Science - (29.76 SQM)	Not Applicable	Circulation or storage space.
B00D - R0011 - Laboratory L.S. - (85.17 SQM) - Teaching Space: 1	● Student Space (39)	
B00D - R0015 - General Learning Space - (52.58 SQM) - Teaching Space: 1	● Student Space (24)	
B00D - R0022 - Staff Study - (39.3 SQM)	● Office (9)	
B00D - R0029 - Laboratory L.S. - (93.4 SQM) - Teaching Space: 1	● Student Space (43)	
B00D - R0030 - Preparation - Science - (18.46 SQM)	Not Applicable	Circulation or storage space.
B00D - R1003 - General Learning Space - (52.44 SQM) - Teaching Space: 1	● Student Space (24)	
B00D - R1006 - General Learning Space - (58.67 SQM) - Teaching Space: 1	● Student Space (27)	
B00D - R1007 - General Learning Space - (52.66 SQM) - Teaching Space: 1	● Student Space (24)	
B00D - R1008 - General Learning Space - (52.73 SQM) - Teaching Space: 1	● Student Space (24)	
B00D - R1012 - General Learning Space - (58.07 SQM) - Teaching Space: 1	● Student Space (26)	
B00D - R1015 - General Learning Space - (52.29 SQM) - Teaching Space: 1	● Student Space (24)	
B00D - R1016 - General Learning Space - (58.51 SQM) - Teaching Space: 1	● Student Space (27)	
B00D - R1018 - Staff Study - (12.75 SQM)	● Office (3)	
B00D - R1019 - Staff Study - (39.22 SQM)	● Office (9)	
B00D - R1022 - Computer Learning Space - (58.07 SQM) - Teaching Space: 1	● Student Space (26)	
B00D - R1029 - General Learning Space - (52.8 SQM) - Teaching Space: 1	● Student Space (24)	
B00D - R1035 - Staff Study - (53.23 SQM)	● Office (13)	
B00E - R0005 - General Learning Space - (50.71 SQM) - Teaching Space: 1	● Student Space (23)	
B00E - R0006 - General Learning Space - (57.4 SQM) - Teaching Space: 1	● Student Space (26)	
B00E - R0007 - Staff Study - (25.5 SQM)	● Office (6)	
B00E - R0008 - Staff Study - (19.04 SQM)	● Office (4)	
B00E - R0015 - Senior Study - (51.72 SQM)	● Office (12)	
B00E - R0016 - Seminar - (14.8 SQM)	● Office (3)	
B00E - R0017 - Seminar - (15.54 SQM)	● Office (3)	
B00E - R0019 - Study Space - (11.96 SQM)	Not Applicable	Circulation or storage space.
B00E - R0020 - Main Area - (323.79 SQM)	Not Applicable	Circulation or storage space.
B00E - R0023 - Audio Visual Workroom - (24.14 SQM)	● Student Space (11)	
B00E - R0028 - Performance Workspace - (64.52 SQM) - Teaching Space: 1	● Student Space (29)	
B00E - R0029 - Performance Workshop - (31.43 SQM)	● Student Space (14)	
B00E - R1003 - General Learning Space - (50.64 SQM) - Teaching Space: 1	● Student Space (23)	
B00E - R1007 - Laboratory L.S. - (91.34 SQM) - Teaching Space: 1	● Student Space (42)	
B00E - R1008 - Preparation - Science - (22.53 SQM)	Not Applicable	Circulation or storage space.
B00E - R1011 - Laboratory L.S. - (83.58 SQM) - Teaching Space: 1	● Student Space (38)	
B00E - R1014 - Computer Learning Space - (50.71 SQM) - Teaching Space: 1	● Student Space (23)	

Entity Location	Audit Condition Classification (Capacity)	Comment
B00E - R1016 - Study Space - (12.43 SQM)	Not Applicable	Circulation or storage space.
B00E - R1017 - General Learning Space - (57.41 SQM) - Teaching Space: 1	● Student Space (26)	
B00E - R1018 - General Learning Space - (51.72 SQM) - Teaching Space: 1	● Student Space (23)	
B00E - R1019 - General Learning Space - (51.5 SQM) - Teaching Space: 1	● Student Space (23)	
B00E - R1020 - Staff Study - (25.28 SQM)	● Office (6)	
B00E - R1021 - General Learning Space - (57.25 SQM) - Teaching Space: 1	● Student Space (26)	
B00E - R1031 - Staff Study - (46.68 SQM)	● Office (11)	
B00F - R0002 - Movement - (55.72 SQM)	Not Applicable	Circulation or storage space.
B00F - R0007 - Staff Kitchen - (17.19 SQM)	● Office (4)	
B00F - R0008 - Fitness Laboratory - (36.74 SQM)	● Student Space (17)	
B00F - R0012 - Multi-Purpose Space - (495.8 SQM)	● Student Space (230)	
B00F - R0018 - Movement - (10.81 SQM)	Not Applicable	Circulation or storage space.
B00F - R0022 - Staff Study - (37.97 SQM)	● Office (9)	
B00F - R0025 - Movement - (13.78 SQM)	Not Applicable	Circulation or storage space.
B00F - R0029 - Movement - (15.56 SQM)	Not Applicable	Circulation or storage space.
B00F - R0034 - Stage - (112.51 SQM)	Not Applicable	Circulation or storage space.
B00F - R0036 - Movement - (21.9 SQM)	Not Applicable	Circulation or storage space.
NS 200 10455 - NS 200 10455 - Art Learning Space/Workshop/Bulk Store - (95 SQM)	Not Applicable	Circulation or storage space.
OS 600 11577 - OS 600 11577 - Learning Unit - Small - (57 SQM)	● Student Space (26)	
OS 600 13251 - OS 600 13251 - Learning Unit - Small - (57 SQM)	● Student Space (26)	
OS 601 10975 - OS 601 10975 - Learning Unit - Standard/Withdrawal - (76 SQM)	● Student Space (35)	
OS 601 11562 - OS 601 11562 - Learning Unit - Standard/Withdrawal - (76 SQM)	● Student Space (35)	
OS 601 12113 - OS 601 12113 - Learning Unit - Standard/Withdrawal - (76 SQM)	● Student Space (35)	
OS 601 15422 - OS 601 15422 - Learning Unit - Standard/Withdrawal - (76 SQM)	● Student Space (35)	
OS 720 15891 - OS 720 15891 - Science Laboratory/Prep Room - (114 SQM)	Not Applicable	Circulation or storage space.