

VENTILATION AUDIT REPORT

SCHOOL:	Tumbarumba High School (8450)
AMU REGION:	Southern NSW
STATE ELECTORATE:	Albury
LOCAL GOVERNMENT AREA:	Snowy Valleys

8450 - Tumbarumba High School
Site Plan (11353)

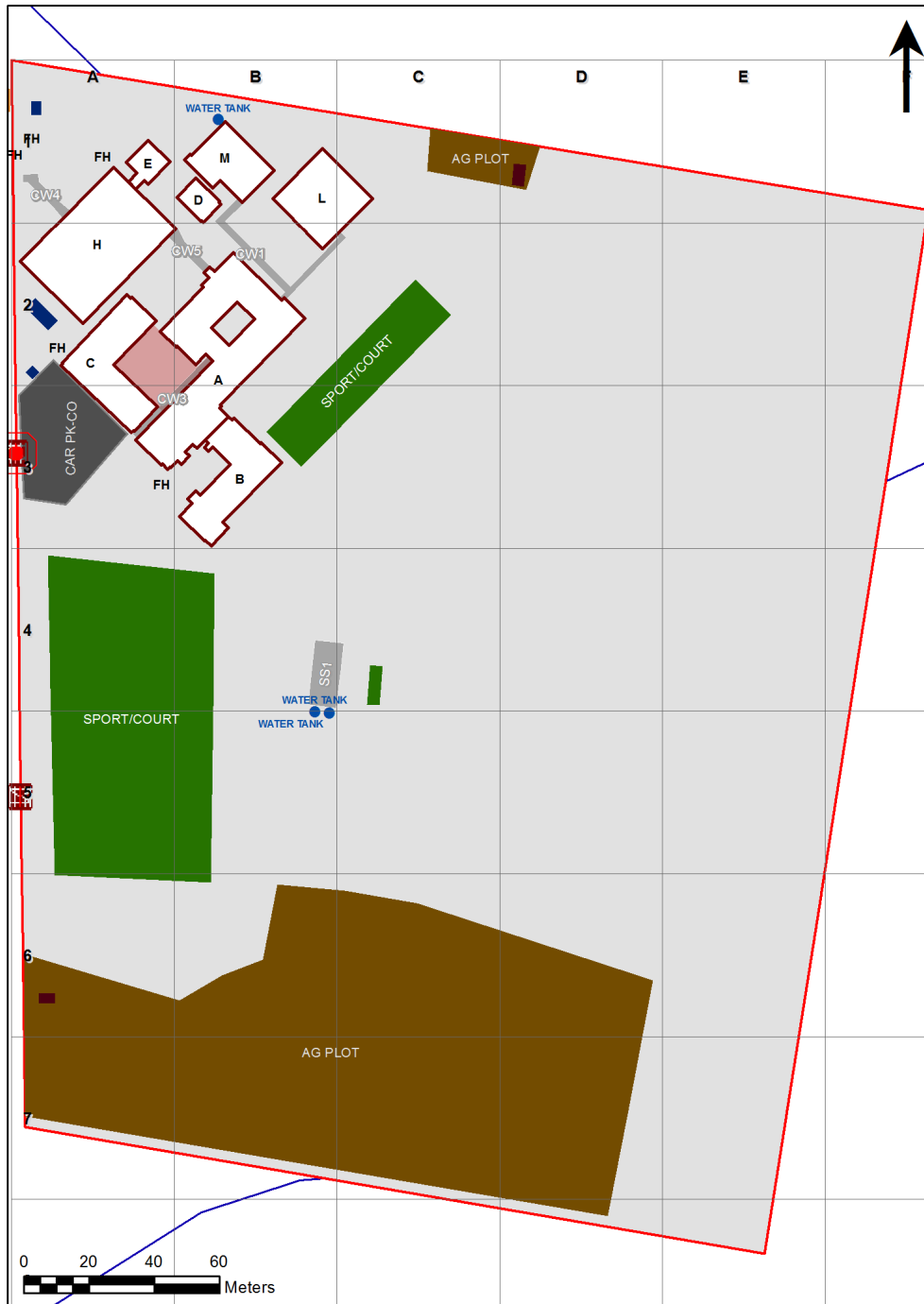

1:1,456

Printed: 21-Mar-2020

Ventilation Audit Key

Category	Description
	Category A Operate this space in line with COVID safe school operations . It has the required level of natural ventilation. NB. Circulation and storage areas should not be used for groups or gatherings.
	Category B This space should be occupied at 1 person per 4m ² to comply with COVID safe school operations and the guided use of spaces . The report details the number of people who can be accommodated safely in each of the identified spaces.

Entity Location	Audit Condition Classification (Capacity)	Comment
B00A - R0005 - Darkroom Space - (8.63 SQM)	Office (2)	
B00A - R0010 - Art Learning Space - (78.9 SQM) - Teaching Space: 1	Student Space (36)	
B00A - R0020 - Interview/Office - Type 1 - (11.14 SQM)	Office (2)	
B00A - R0021 - Deputy Principal Office - (14.88 SQM)	Office (3)	
B00A - R0022 - Duplicating Workroom - (18.87 SQM)	Office (4)	
B00A - R0029 - Administration - Clerical - (34.14 SQM)	Office (8)	
B00A - R0031 - Clinic - Boys - (7.77 SQM)	Office (1)	
B00A - R0032 - Movement - (26.85 SQM)	Not Applicable	Circulation or storage space.
B00A - R0036 - Materials Technology L.S. - (66.84 SQM) - Teaching Space: 1	Student Space (31)	
B00A - R0037 - Interview/Office - Type 1 - (25.91 SQM)	Office (6)	
B00A - R0042 - Movement - (298.98 SQM)	Not Applicable	Circulation or storage space.
B00A - R0043 - Movement - (14.37 SQM)	Not Applicable	Circulation or storage space.
B00A - R0044 - Movement - (8.88 SQM)	Not Applicable	Circulation or storage space.
B00A - R0045 - Movement - (33.46 SQM)	Not Applicable	Circulation or storage space.
B00A - R0046 - Principal Office - (21.18 SQM)	Office (5)	
B00A - R0050 - Food Technology L.S. - (87.17 SQM) - Teaching Space: 1	Student Space (40)	
B00A - R0051 - Food/Research Space - (13.17 SQM)	Not Applicable	Circulation or storage space.
B00A - R0052 - Computer Room - (26.03 SQM)	Student Space (12)	
B00A - R0054 - Workshop Area - (166.26 SQM)	Student Space (77)	
B00A - R0055 - Welding Area - (7.97 SQM)	Not Applicable	Circulation or storage space.
B00A - R1001 - Laboratory L.S. - (99.69 SQM) - Teaching Space: 1	Student Space (46)	
B00A - R1003 - Staff Study - (51.2 SQM)	Office (12)	
B00A - R1005 - General Learning Space - (52.03 SQM) - Teaching Space: 1	Student Space (24)	
B00A - R1006 - General Learning Space - (52.03 SQM) - Teaching Space: 1	Student Space (24)	
B00A - R1007 - Seminar - (29.37 SQM)	Office (7)	
B00A - R1013 - Materials Technology L.S. - (91.31 SQM) - Teaching Space: 1	Student Space (42)	
B00A - R1015 - Movement - (228.65 SQM)	Not Applicable	Circulation or storage space.
B00A - R1016 - Seminar/Technology Space - (26.41 SQM)	Office (6)	
B00A - R1018 - Commonroom - (65.18 SQM)	Office (16)	
B00A - R1019 - Pupil Entry - (5.26 SQM)	Not Applicable	Circulation or storage space.
B00A - R1020 - Computer Learning Space - (52.69 SQM) - Teaching Space: 1	Student Space (24)	
B00A - R1021 - Laboratory L.S. - (102.57 SQM) - Teaching Space: 1	Student Space (47)	
B00A - R1022 - Preparation - (28.39 SQM)	Not Applicable	Circulation or storage space.
B00A - R1031 - Movement - (19.57 SQM)	Not Applicable	Circulation or storage space.
B00A - R2005 - Movement - (18.66 SQM)	Not Applicable	Circulation or storage space.
B00B - R1017 - Seminar - Type 1 - (27.21 SQM)	Office (6)	
B00B - R1018 - General Learning Space - (51.96 SQM) - Teaching Space: 1	Student Space (24)	
B00B - R1019 - General Learning Space - (52.03 SQM) - Teaching Space: 1	Student Space (24)	
B00B - R1020 - General Learning Space - (51.82 SQM) - Teaching Space: 1	Student Space (24)	
B00B - R1026 - Movement - (103.9 SQM)	Not Applicable	Circulation or storage space.
B00B - R1028 - Movement - (25.6 SQM)	Not Applicable	Circulation or storage space.
B00B - R1036 - Staff Study - (51.36 SQM)	Office (12)	
B00B - R2001 - Laboratory L.S. - (96.62 SQM) - Teaching Space: 1	Student Space (44)	
B00B - R2003 - Staff Study - (38.56 SQM)	Office (9)	
B00B - R2004 - General Learning Space - (64.8 SQM) - Teaching Space: 1	Student Space (30)	
B00B - R2006 - Seminar - (13.1 SQM)	Office (3)	
B00B - R2011 - General Learning Space - (52.16 SQM) - Teaching Space: 1	Student Space (24)	
B00B - R2013 - Movement - (92.08 SQM)	Not Applicable	Circulation or storage space.
B00C - R0013 - Student Canteen - (37.01 SQM)	Not Applicable	Circulation or storage space.

Entity Location	Audit Condition Classification (Capacity)	Comment
B00C - R0017 - Movement - (35.74 SQM)	Not Applicable	Circulation or storage space.
B00C - R0018 - Movement - (159.24 SQM)	Not Applicable	Circulation or storage space.
B00D - R0002 - Movement - (6.36 SQM)	Not Applicable	Circulation or storage space.
B00D - R0005 - Movement - (18.63 SQM)	Not Applicable	Circulation or storage space.
B00E - R0001 - Staff Study - (11.86 SQM)	Office (2)	
B00E - R0002 - Staff Kitchen - (5.28 SQM)	Office (1)	
B00E - R0005 - Computer Learning Space - (62.6 SQM) - Teaching Space: 1	Student Space (29)	
B00H - R0006 - Stage - (64.64 SQM)	Not Applicable	Circulation or storage space.
B00H - R0010 - Staff Kitchen - (14.94 SQM)	Office (3)	
B00H - R0012 - Staff Study - (11.72 SQM)	Office (2)	
B00H - R0014 - Multi-Purpose Space - (459.46 SQM)	Student Space (213)	
B00H - R0016 - Stage - (62.85 SQM)	Not Applicable	Circulation or storage space.
B00L - R0001 - Main Area - (52.53 SQM)	Not Applicable	Circulation or storage space.
B00L - R0002 - Workroom - (19.78 SQM)	Office (4)	
B00L - R0007 - Audio Visual Workroom - (26.01 SQM)	Student Space (12)	
B00L - R0009 - Seminar - (12.78 SQM)	Office (3)	
B00L - R0010 - Seminar - (12.81 SQM)	Office (3)	
B00L - R0011 - Main Area - (191.02 SQM)	Not Applicable	Circulation or storage space.
B00M - R0001 - General Learning Space - Type 10 - (59.89 SQM) - Teaching Space: 0.5	Student Space (27)	
B00M - R0002 - Science Laboratory - (59.83 SQM)	Student Space (27)	
B00M - R0003 - Preparation - (30.28 SQM)	Not Applicable	Circulation or storage space.
B00M - R0004 - Staff Study - (21.02 SQM)	Office (5)	
B00M - R0005 - Seminar - Type 2 - (21.02 SQM)	Office (5)	
B00M - R0007 - Movement - (6.13 SQM)	Not Applicable	Circulation or storage space.
B00M - R0010 - Outdoor Learning Space - Type 4 - (88.97 SQM)	Not Applicable	Circulation or storage space.