

VENTILATION AUDIT REPORT

SCHOOL:	Tuggerah Lakes Secondary College The Entrance (8465)
AMU REGION:	Hunter/Central Coast
STATE ELECTORATE:	The Entrance
LOCAL GOVERNMENT AREA:	Central Coast

8465 - Tuggerah Lakes Secondary College The Entrance
Site Plan (11487)

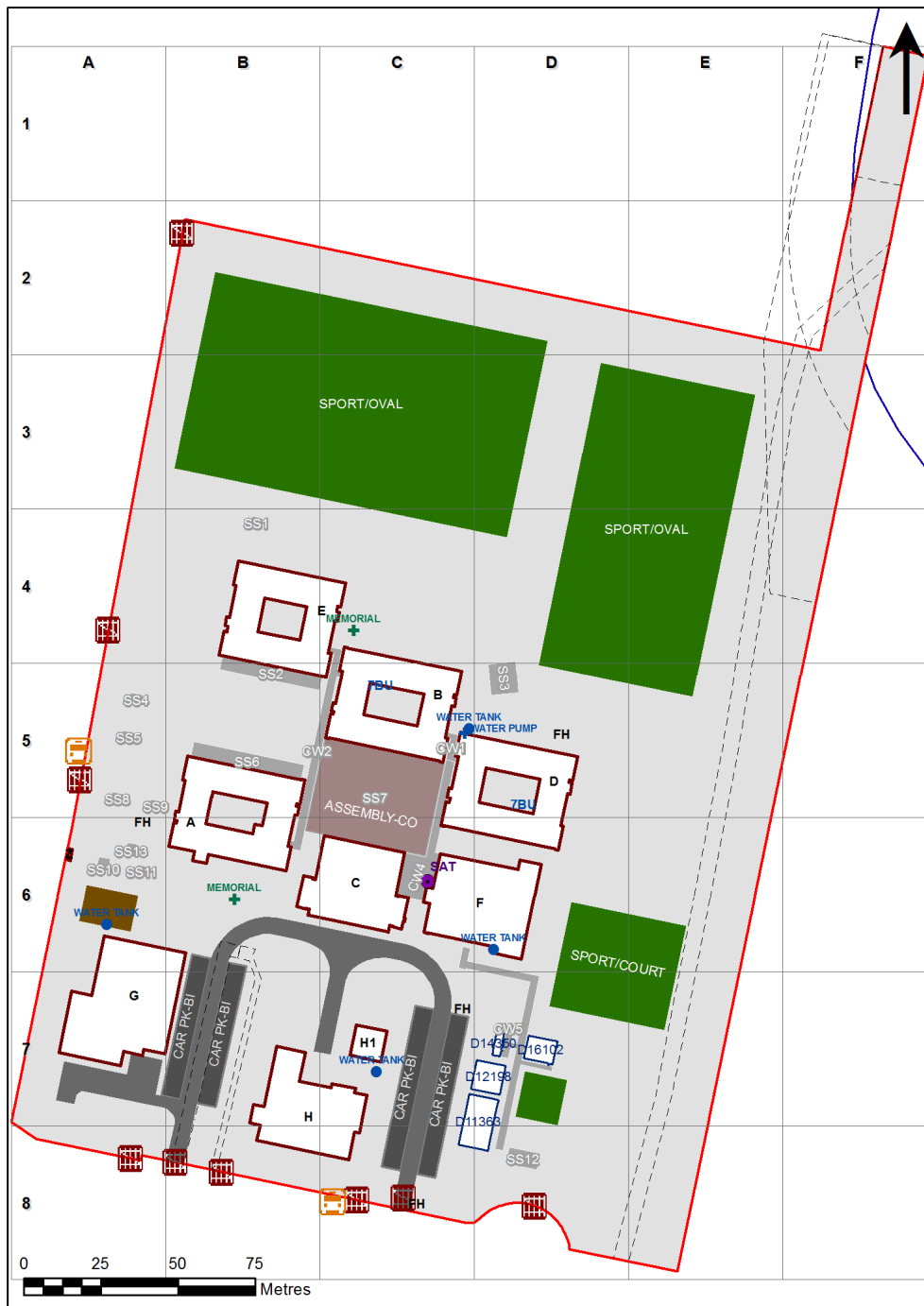

1:1,536

Printed: 22-Sep-2020

Ventilation Audit Key

Category	Description
	Category A Operate this space in line with COVID safe school operations . It has the required level of natural ventilation. NB. Circulation and storage areas should not be used for groups or gatherings.
	Category B This space should be occupied at 1 person per 4m ² to comply with COVID safe school operations and the guided use of spaces . The report details the number of people who can be accommodated safely in each of the identified spaces.

Entity Location	Audit Condition Classification (Capacity)	Comment
B00A - R0035 - Laboratory L.S. - (82.42 SQM) - Teaching Space: 1	● Student Space (38)	
B00A - R0042 - Clinic - Boys - (12.04 SQM)	○ Office (3)	
B00A - R0043 - Clinic - Girls - (11.16 SQM)	○ Office (2)	
B00A - R0047 - Interview/Office - Type 1 - (14.93 SQM)	○ Office (3)	
B00A - R0048 - Deputy Principal Office - (22.31 SQM)	○ Office (5)	
B00A - R0049 - Pupil Entry - (38.37 SQM)	Not Applicable	Circulation or storage space.
B00A - R0050 - Deputy Principal Office - (13.22 SQM)	○ Office (3)	
B00A - R0051 - Staff Study - (12.82 SQM)	○ Office (3)	
B00A - R0052 - Administration - Clerical - (84.71 SQM)	○ Office (21)	
B00A - R0053 - Public Reception - (20.9 SQM)	Not Applicable	Circulation or storage space.
B00A - R0054 - Interview/Meeting - (13.43 SQM)	○ Office (3)	
B00A - R0055 - Administration - Executive - (13.65 SQM)	○ Office (3)	
B00A - R0056 - Ancillary Staff - (13.92 SQM)	○ Office (3)	
B00A - R0059 - Principal Office - (24.95 SQM)	○ Office (6)	
B00A - R0060 - Principal Office - (25.36 SQM)	○ Office (6)	
B00A - R0061 - General Learning Space - (52.09 SQM) - Teaching Space: 1	● Student Space (24)	
B00A - R0062 - Special Learning Space - (50.2 SQM) - Teaching Space: 1	● Student Space (23)	
B00A - R1015 - General Learning Space - (51.08 SQM) - Teaching Space: 1	● Student Space (23)	
B00A - R1028 - Staff Study - (203.63 SQM)	○ Office (50)	
B00A - R1030 - Study Space - (26.25 SQM)	Not Applicable	Circulation or storage space.
B00A - R1031 - Study Space - (30.78 SQM)	Not Applicable	Circulation or storage space.
B00A - R1035 - Staff Study - (131.52 SQM)	○ Office (32)	
B00A - R1038 - Commonroom - (97.38 SQM)	○ Office (24)	
B00A - R1039 - Staff Kitchen - (12.09 SQM)	○ Office (3)	
B00B - R0007 - Metal Technology L.S. - (84.07 SQM) - Teaching Space: 1	● Student Space (39)	
B00B - R0009 - Welding Area - (20.96 SQM)	Not Applicable	Circulation or storage space.
B00B - R0010 - Wood Technology L.S. - (91.88 SQM) - Teaching Space: 1	● Student Space (42)	
B00B - R0012 - Materials Technology L.S. - (57.73 SQM) - Teaching Space: 1	● Student Space (26)	
B00B - R0019 - Seminar - (30.02 SQM)	○ Office (7)	
B00B - R0020 - Food Technology L.S. - (92.06 SQM) - Teaching Space: 1	● Student Space (42)	
B00B - R0021 - Preparation - Materials - (12.89 SQM)	Not Applicable	Circulation or storage space.
B00B - R0030 - General Learning Space - (61.68 SQM) - Teaching Space: 1	● Student Space (28)	
B00B - R0036 - Design/Technology L.S. - (49.17 SQM) - Teaching Space: 1	● Student Space (22)	
B00B - R0038 - Food Technology L.S. - (100.76 SQM) - Teaching Space: 1	● Student Space (46)	
B00B - R1003 - General Learning Space - (51 SQM) - Teaching Space: 1	● Student Space (23)	
B00B - R1006 - Materials Technology L.S. - (84.18 SQM) - Teaching Space: 1	● Student Space (39)	
B00B - R1010 - Materials Technology L.S. - (78.28 SQM) - Teaching Space: 1	● Student Space (36)	
B00B - R1011 - Materials Technology L.S. - (57.59 SQM) - Teaching Space: 1	● Student Space (26)	
B00B - R1014 - Art Learning Space - (51.36 SQM) - Teaching Space: 1	● Student Space (23)	
B00B - R1024 - Art Learning Space - (71.05 SQM) - Teaching Space: 1	● Student Space (32)	
B00B - R1028 - Art Learning Space - (106.01 SQM) - Teaching Space: 1	● Student Space (49)	
B00B - R1031 - General Learning Space - (56.89 SQM) - Teaching Space: 1	● Student Space (26)	
B00B - R1037 - Wood Technology Bay - (19.98 SQM)	Not Applicable	Circulation or storage space.
B00C - R0006 - Student Canteen - (57.2 SQM)	Not Applicable	Circulation or storage space.
B00C - R0017 - General Assistants - (14.75 SQM)	○ Office (3)	
B00C - R0018 - Movement - (6.25 SQM)	Not Applicable	Circulation or storage space.
B00C - R0019 - General Assistants - (13.53 SQM)	○ Office (3)	
B00C - R0026 - Movement - (10.55 SQM)	Not Applicable	Circulation or storage space.

Entity Location	Audit Condition Classification (Capacity)	Comment
B00C - R0027 - Movement - (13.4 SQM)	Not Applicable	Circulation or storage space.
B00C - R0034 - Art Entry/Display - (67.59 SQM)	Not Applicable	Circulation or storage space.
B00C - R1021 - Movement - (10.71 SQM)	Not Applicable	Circulation or storage space.
B00C - R1022 - Interview/Meeting - (10.58 SQM)	Office (2)	
B00C - R1024 - Multi-Purpose Space - (160.11 SQM)	Student Space (74)	
B00C - R1026 - Interview/Meeting - (10.57 SQM)	Office (2)	
B00C - R1027 - Movement - (10.76 SQM)	Not Applicable	Circulation or storage space.
B00D - R0003 - General Learning Space - (51.14 SQM) - Teaching Space: 1	Student Space (23)	
B00D - R0006 - General Learning Space - (57.74 SQM) - Teaching Space: 1	Student Space (26)	
B00D - R0007 - Laboratory L.S. - (92.13 SQM) - Teaching Space: 1	Student Space (42)	
B00D - R0010 - Laboratory L.S. - (84.06 SQM) - Teaching Space: 1	Student Space (39)	
B00D - R0014 - General Learning Space - (50.49 SQM) - Teaching Space: 1	Student Space (23)	
B00D - R0029 - Laboratory L.S. - (91.8 SQM) - Teaching Space: 1	Student Space (42)	
B00D - R0030 - Preparation - Science - (19.09 SQM)	Not Applicable	Circulation or storage space.
B00D - R0035 - Preparation - (38.96 SQM)	Not Applicable	Circulation or storage space.
B00D - R1003 - General Learning Space - (51.14 SQM) - Teaching Space: 1	Student Space (23)	
B00D - R1006 - General Learning Space - (57.74 SQM) - Teaching Space: 1	Student Space (26)	
B00D - R1007 - General Learning Space - (52.74 SQM) - Teaching Space: 1	Student Space (24)	
B00D - R1008 - General Learning Space - (52.02 SQM) - Teaching Space: 1	Student Space (24)	
B00D - R1018 - General Learning Space - (51.29 SQM) - Teaching Space: 1	Student Space (23)	
B00D - R1024 - General Learning Space - (52.02 SQM) - Teaching Space: 1	Student Space (24)	
B00D - R1031 - Performance Workshop - (15.5 SQM)	Student Space (7)	
B00D - R1033 - Performance Workspace - (104.97 SQM) - Teaching Space: 1	Student Space (48)	
B00D - R1036 - General Learning Space - (57.58 SQM) - Teaching Space: 1	Student Space (26)	
B00D - R1037 - Design L.S. - (57.95 SQM) - Teaching Space: 1	Student Space (26)	
B00E - R0005 - General Learning Space - (51.71 SQM) - Teaching Space: 1	Student Space (23)	
B00E - R0007 - General Learning Space - (45.77 SQM) - Teaching Space: 1	Student Space (21)	
B00E - R0012 - Fitness Laboratory - (52.73 SQM)	Student Space (24)	
B00E - R0019 - General Learning Space - (53.19 SQM) - Teaching Space: 1	Student Space (24)	
B00E - R0020 - Computer Learning Space - (65.77 SQM) - Teaching Space: 1	Student Space (30)	
B00E - R0023 - Computer Learning Space - (39.48 SQM) - Teaching Space: 1	Student Space (18)	
B00E - R0024 - General Learning Space - (47.19 SQM) - Teaching Space: 1	Student Space (21)	
B00E - R0030 - General Learning Space - (45.29 SQM) - Teaching Space: 1	Student Space (21)	
B00E - R0032 - Music Learning Space - (119.9 SQM) - Teaching Space: 1	Student Space (55)	
B00E - R0039 - Practice/Seminar - (18.93 SQM)	Not Applicable	Circulation or storage space.
B00E - R1004 - General Learning Space - (51.49 SQM) - Teaching Space: 1	Student Space (23)	
B00E - R1016 - General Learning Space - (51.42 SQM) - Teaching Space: 1	Student Space (23)	
B00E - R1019 - General Learning Space - (59.47 SQM) - Teaching Space: 1	Student Space (27)	
B00E - R1020 - General Learning Space - (52.59 SQM) - Teaching Space: 1	Student Space (24)	
B00E - R1021 - General Learning Space - (52.52 SQM) - Teaching Space: 1	Student Space (24)	
B00E - R1023 - General Learning Space - (59.38 SQM) - Teaching Space: 1	Student Space (27)	
B00E - R1028 - General Learning Space - (67.63 SQM) - Teaching Space: 1	Student Space (31)	
B00E - R1029 - General Learning Space - (57.75 SQM) - Teaching Space: 1	Student Space (26)	
B00E - R1030 - General Learning Space - (65.76 SQM) - Teaching Space: 1	Student Space (30)	
B00E - R1034 - Dark Room - (51.02 SQM)	Office (12)	
B00F - R0003 - General Learning Space - (69.55 SQM) - Teaching Space: 1	Student Space (32)	
B00F - R0005 - Senior Study - (36.21 SQM)	Office (9)	

Entity Location	Audit Condition Classification (Capacity)	Comment
B00F - R0006 - General Learning Space - (93.15 SQM) - Teaching Space: 1	● Student Space (43)	
B00F - R0012 - Main Entry - (16.14 SQM)	Not Applicable	Circulation or storage space.
B00F - R0023 - Main Area - (392.85 SQM)	Not Applicable	Circulation or storage space.
B00F - R0026 - Tea Room - (5.92 SQM)	Not Applicable	Circulation or storage space.
B00G - R0001 - Movement - (75.89 SQM)	Not Applicable	Circulation or storage space.
B00G - R0002 - Staff Kitchen - (11.08 SQM)	● Office (2)	
B00G - R0003 - Multi-Purpose Space - (395.18 SQM)	● Student Space (183)	
B00G - R0005 - Movement - (5.47 SQM)	Not Applicable	Circulation or storage space.
B00G - R0009 - Stage - (167.77 SQM)	Not Applicable	Circulation or storage space.
B00G - R0013 - Movement - (5.58 SQM)	Not Applicable	Circulation or storage space.
B00G - R0018 - Tiered Learning Area - (40.59 SQM)	● Student Space (18)	
B00G - R1001 - Movement - (5.95 SQM)	Not Applicable	Circulation or storage space.
B00G - R1002 - Tiered Learning Area - (167.42 SQM)	● Student Space (77)	
B00G - R1003 - Movement - (9.51 SQM)	Not Applicable	Circulation or storage space.
B00G - R1008 - Movement - (8.95 SQM)	Not Applicable	Circulation or storage space.
B00G - R2001 - Movement - (12.22 SQM)	Not Applicable	Circulation or storage space.
B00H - R0002 - General Learning Space - (63.16 SQM) - Teaching Space: 1	● Student Space (29)	
B00H - R0003 - Design/Technology L.S. - (56.71 SQM) - Teaching Space: 1	● Student Space (26)	
B00H - R0005 - Materials Workshop - Type 3 - (326.21 SQM)	● Student Space (151)	
B00H - R0018 - Staff Kitchen - (8.76 SQM)	● Office (2)	
B00H - R0024 - General Learning Space - (92.83 SQM) - Teaching Space: 1	● Student Space (43)	
B00H - R0025 - Movement - (16.46 SQM)	Not Applicable	Circulation or storage space.
NS 100 12198 - NS 100 12198 - Learning Unit - Single Primary/PAA - (76 SQM)	● Student Space (35)	
NS 101 11363 - NS 101 11363 - Learning Unit - Double Primary/PAA - (133 SQM)	● Student Space (61)	
OS 523 16102 - OS 523 16102 - Staff Study With Toilets - (76 SQM)	● Office (19)	