

# VENTILATION AUDIT REPORT

<b>SCHOOL:</b>	<b>Trangie Central School (3254)</b>
<b>AMU REGION:</b>	<b>North Western NSW</b>
<b>STATE ELECTORATE:</b>	<b>Dubbo</b>
<b>LOCAL GOVERNMENT AREA:</b>	<b>Narromine</b>

3254 - Trangie Central School  
Site Plan (11523)

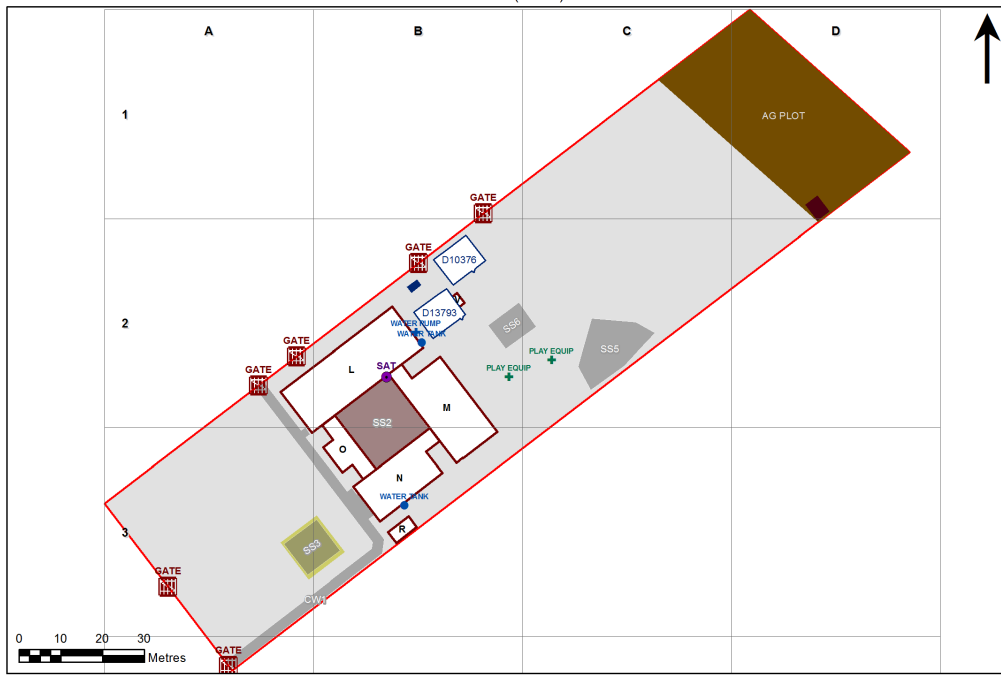





1:849

Printed: 02-Mar-2021

## Ventilation Audit Key

Category	Description
	Category A Operate this space in line with <a href="#">COVID safe school operations</a> . It has the required level of natural ventilation. NB. Circulation and storage areas should not be used for groups or gatherings.
	Category B This space should be occupied at 1 person per 4m <sup>2</sup> to comply with <a href="#">COVID safe school operations and the guided use of spaces</a> . The report details the number of people who can be accommodated safely in each of the identified spaces.

Entity Location	Audit Condition Classification (Capacity)	Comment
B00A - R0001 - Staff Room - (58.37 SQM)	Office (14)	
B00A - R0002 - Duplicating Workroom - (22.19 SQM)	Office (5)	
B00A - R0003 - Clerical Office/Workroom - (12.07 SQM)	Office (3)	
B00A - R0004 - Clerical Office - (14.43 SQM)	Office (3)	
B00A - R0005 - Entry Vestibule - (7.75 SQM)	Not Applicable	Circulation or storage space.
B00A - R0006 - Principal - (17.14 SQM)	Office (4)	
B00A - R0008 - Movement - (12.46 SQM)	Not Applicable	Circulation or storage space.
B00A - R0010 - Interview - (10.49 SQM)	Office (2)	
B00A - R0012 - Staff Room Annexe - (15.27 SQM)	Office (3)	
B00A - R0015 - Movement - (7.38 SQM)	Not Applicable	Circulation or storage space.
B00A - R0017 - Clinic - (6.59 SQM)	Office (1)	
B00B - R0001 - General Learning Space - (53.79 SQM) - Teaching Space: 1	Student Space (24)	
B00B - R0002 - Interview - (8.22 SQM)	Office (2)	
B00B - R0004 - Computer Learning Space - (53.79 SQM) - Teaching Space: 1	Student Space (24)	
B00B - R0005 - Staff Room Annexe - (40.6 SQM)	Office (10)	
B00B - R0006 - Seminar/Study - (40.51 SQM)	Office (10)	
B00B - R0009 - General Learning Space - (53.79 SQM) - Teaching Space: 1	Student Space (24)	
B00B - R0010 - Seminar/Study - (26.79 SQM)	Office (6)	
B00B - R0012 - Movement - (6.89 SQM)	Not Applicable	Circulation or storage space.
B00C - R0005 - Special Programs Room - (42.88 SQM)	Student Space (19)	
B00C - R0010 - Reading Area - (156.14 SQM)	Student Space (72)	
B00C - R0011 - Withdrawal - M - (15.58 SQM)	Student Space (7)	
B00C - R0012 - Withdrawal - M - (15.6 SQM)	Student Space (7)	
B00D - R0004 - General Learning Space - (53.57 SQM) - Teaching Space: 1	Student Space (24)	
B00D - R0005 - General Learning Space - (53.43 SQM) - Teaching Space: 1	Student Space (24)	
B00E - R0002 - Darkroom Space - (12.33 SQM)	Office (3)	
B00E - R0004 - Food/Research Space - (9.06 SQM)	Not Applicable	Circulation or storage space.
B00E - R0006 - Food Technology L.S. - (65.37 SQM) - Teaching Space: 1	Student Space (30)	
B00E - R0007 - Staff Room Annexe - (6.1 SQM)	Office (1)	
B00E - R0011 - Staff Room Annexe - (5.12 SQM)	Office (1)	
B00E - R0012 - Preparation - (18.27 SQM)	Not Applicable	Circulation or storage space.
B00E - R0013 - Laboratory L.S. - (94.12 SQM) - Teaching Space: 1	Student Space (43)	
B00F - R0002 - Materials Technology L.S. - (102.7 SQM) - Teaching Space: 1	Student Space (47)	
B00F - R0007 - Materials Technology L.S. - (52.02 SQM) - Teaching Space: 1	Student Space (24)	
B00F - R0008 - Materials Technology L.S. - (28.96 SQM) - Teaching Space: 1	Student Space (13)	
B00L - R0003 - Home Base - (57.08 SQM) - Teaching Space: 1	Student Space (26)	
B00L - R0007 - Home Base - (57.01 SQM) - Teaching Space: 1	Student Space (26)	
B00L - R0008 - Withdrawal Space - 1hb - (15.63 SQM)	Student Space (7)	
B00L - R0011 - Withdrawal Space - 1hb - (13.85 SQM)	Student Space (6)	
B00L - R0014 - Movement - (13.4 SQM)	Not Applicable	Circulation or storage space.
B00L - R0016 - Staff Room Annexe - (17.92 SQM)	Office (4)	
B00L - R0017 - Staff Room Annexe - (21.84 SQM)	Office (5)	
B00M - R0004 - Home Base - (86.12 SQM) - Teaching Space: 1	Student Space (39)	
B00M - R0005 - Home Base - (57.17 SQM) - Teaching Space: 1	Student Space (26)	
B00N - R0009 - Canteen - (11.98 SQM)	Not Applicable	Circulation or storage space.
B00Q - R0001 - Multi-Purpose Space - (619.99 SQM)	Student Space (287)	
B00Q - R0009 - Movement - (25.49 SQM)	Not Applicable	Circulation or storage space.
B00Q - R0014 - Canteen - (20.22 SQM)	Not Applicable	Circulation or storage space.

Entity Location	Audit Condition Classification (Capacity)	Comment
NS 200 14669 - NS 200 14669 - Art Learning Space/Workshop/Bulk Store - (95 SQM)	Not Applicable	Circulation or storage space.
OS 505 10376 - OS 505 10376 - Admin Staff/Principal/Secure Store - (76 SQM)	 Office (19)	
OS 600 17416 - OS 600 17416 - Learning Unit - Small - (57 SQM)	 Student Space (26)	
OS 601 10713 - OS 601 10713 - Learning Unit - Standard/Withdrawal - (76 SQM)	 Student Space (35)	
OS 601 13793 - OS 601 13793 - Learning Unit - Standard/Withdrawal - (76 SQM)	 Student Space (35)	