

VENTILATION AUDIT REPORT

SCHOOL:	The Rivers Sec College Richmond River High Campus (8214)
AMU REGION:	North Coast
STATE ELECTORATE:	Lismore
LOCAL GOVERNMENT AREA:	Lismore

8214 - The Rivers Sec College Richmond River High Campus
Site Plan (12084)

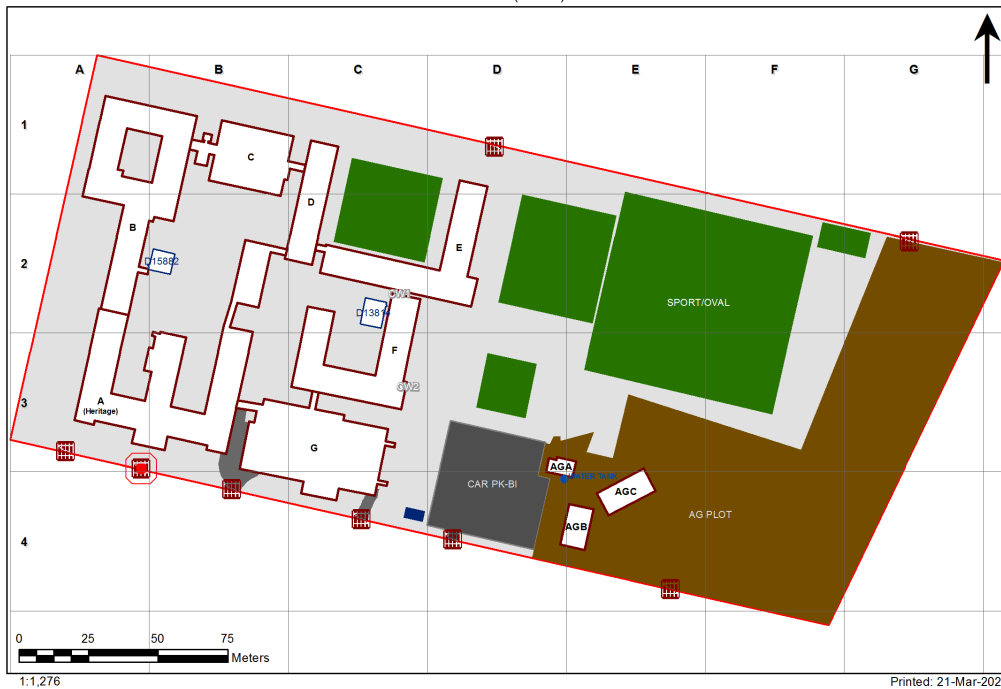

Ventilation Audit Key

Category	Description
	Category A Operate this space in line with COVID safe school operations . It has the required level of natural ventilation. NB. Circulation and storage areas should not be used for groups or gatherings.
	Category B This space should be occupied at 1 person per 4m ² to comply with COVID safe school operations and the guided use of spaces . The report details the number of people who can be accommodated safely in each of the identified spaces.

Entity Location	Audit Condition Classification (Capacity)	Comment
B00A - R0032 - Movement - (349.02 SQM)	Not Applicable	Circulation or storage space.
B00A - R0033 - Movement - (362.48 SQM)	Not Applicable	Circulation or storage space.
B00A - R1001 - Food Technology L.S. - (97.61 SQM) - Teaching Space: 1	● Student Space (45)	
B00A - R1003 - Food Technology L.S. - (79.67 SQM) - Teaching Space: 1	● Student Space (36)	
B00A - R1005 - Staff Study - (9.83 SQM)	○ Office (2)	
B00A - R1008 - Staff Study - (55.45 SQM)	○ Office (13)	
B00A - R1009 - General Learning Space - (49.52 SQM) - Teaching Space: 1	● Student Space (22)	
B00A - R1010 - General Learning Space - (49.52 SQM) - Teaching Space: 1	● Student Space (22)	
B00A - R1011 - Deputy Principal Office - (18.54 SQM)	○ Office (4)	
B00A - R1016 - Stage - (46.58 SQM)	Not Applicable	Circulation or storage space.
B00A - R1022 - Clerical Office - (28.93 SQM)	○ Office (7)	
B00A - R1023 - Pupil Entry - (12.66 SQM)	Not Applicable	Circulation or storage space.
B00A - R1024 - Tea Room - (6.36 SQM)	Not Applicable	Circulation or storage space.
B00A - R1029 - General Learning Space - (55.67 SQM) - Teaching Space: 1	● Student Space (25)	
B00A - R1030 - General Learning Space - (55.67 SQM) - Teaching Space: 1	● Student Space (25)	
B00A - R1031 - General Learning Space - (55.8 SQM) - Teaching Space: 1	● Student Space (25)	
B00A - R1032 - Movement - (336.35 SQM)	Not Applicable	Circulation or storage space.
B00A - R1037 - Movement - (86.58 SQM)	Not Applicable	Circulation or storage space.
B00A - R1038 - Movement - (27.84 SQM)	Not Applicable	Circulation or storage space.
B00A - R1039 - Principal Office - (19.42 SQM)	○ Office (4)	
B00A - R1042 - Administration - Clerical - (29.07 SQM)	○ Office (7)	
B00A - R1046 - Interview - (8.24 SQM)	○ Office (2)	
B00A - R1047 - Deputy Principal - (19.42 SQM)	○ Office (4)	
B00A - R1048 - Student Waiting - (12.77 SQM)	Not Applicable	Circulation or storage space.
B00A - R1050 - Deputy Principal - (14.19 SQM)	○ Office (3)	
B00A - R1051 - Clinic-Waiting - (11.11 SQM)	○ Office (2)	
B00A - R1053 - Clinic - Boys - (14.56 SQM)	○ Office (3)	
B00A - R1054 - Clinic - Girls - (14.56 SQM)	○ Office (3)	
B00A - R1056 - Movement - (7.76 SQM)	Not Applicable	Circulation or storage space.
B00A - R1057 - Movement - (16.79 SQM)	Not Applicable	Circulation or storage space.
B00A - R1060 - General Learning Space - M - (46.69 SQM) - Teaching Space: 1	● Student Space (21)	
B00A - R1061 - Seminar - Type 1 - (32.24 SQM)	○ Office (8)	
B00A - R1066 - Multi-Purpose Space - (155.72 SQM)	● Student Space (72)	
B00A - R1069 - Public Reception - (19.43 SQM)	Not Applicable	Circulation or storage space.
B00A - R1070 - Movement - (7.24 SQM)	Not Applicable	Circulation or storage space.
B00A - R1071 - Food/Research Space - (15.1 SQM)	Not Applicable	Circulation or storage space.
B00A - R1073 - General Learning Space - (58.1 SQM) - Teaching Space: 1	● Student Space (26)	
B00A - R2001 - Commonroom - (80.61 SQM)	○ Office (20)	
B00A - R2006 - Movement - (8.29 SQM)	Not Applicable	Circulation or storage space.
B00B - R0010 - Gymnasium - (87.6 SQM)	● Student Space (40)	
B00B - R0011 - Movement - (58.22 SQM)	Not Applicable	Circulation or storage space.
B00B - R0012 - Movement - (215.19 SQM)	Not Applicable	Circulation or storage space.
B00B - R0013 - Movement - (375.8 SQM)	Not Applicable	Circulation or storage space.
B00B - R0014 - Movement - (276.3 SQM)	Not Applicable	Circulation or storage space.
B00B - R1002 - Laboratory L.S. - (88.42 SQM) - Teaching Space: 1	● Student Space (41)	
B00B - R1003 - Preparation - (27.47 SQM)	Not Applicable	Circulation or storage space.
B00B - R1004 - Preparation - (10.85 SQM)	Not Applicable	Circulation or storage space.
B00B - R1005 - Laboratory L.S. - (86.94 SQM) - Teaching Space: 1	● Student Space (40)	
B00B - R1008 - Art Learning Space - (52.32 SQM) - Teaching Space: 1	● Student Space (24)	
B00B - R1011 - Art Learning Space - (59.16 SQM) - Teaching Space: 1	● Student Space (27)	
B00B - R1013 - Movement - (11.74 SQM)	Not Applicable	Circulation or storage space.

Entity Location	Audit Condition Classification (Capacity)	Comment
B00B - R1022 - Staff Study - (47.64 SQM)	Office (11)	
B00B - R1024 - Materials Technology L.S. - (49.83 SQM) - Teaching Space: 1	Student Space (23)	
B00B - R1025 - Materials Technology L.S. - (52.62 SQM) - Teaching Space: 1	Student Space (24)	
B00B - R1030 - Staff Study - (25.94 SQM)	Office (6)	
B00B - R1031 - Clinic - Boys - (6.79 SQM)	Office (1)	
B00B - R1033 - General Learning Space - (46.07 SQM) - Teaching Space: 1	Student Space (21)	
B00B - R1034 - Senior Study - (32.9 SQM)	Office (8)	
B00B - R1035 - Senior Study - (8.14 SQM)	Office (2)	
B00B - R1036 - Senior Study - (15.53 SQM)	Office (3)	
B00B - R1037 - General Learning Space - (52.84 SQM) - Teaching Space: 1	Student Space (24)	
B00B - R1038 - General Learning Space - (52.77 SQM) - Teaching Space: 1	Student Space (24)	
B00B - R1042 - Movement - (160.52 SQM)	Not Applicable	Circulation or storage space.
B00B - R1043 - Movement - (15.85 SQM)	Not Applicable	Circulation or storage space.
B00B - R1045 - Movement - (76.96 SQM)	Not Applicable	Circulation or storage space.
B00B - R1050 - Administration - Clerical - (12.8 SQM)	Office (3)	
B00B - R1052 - Dark Room - (31.65 SQM)	Office (7)	
B00B - R1054 - Interview/Meeting - (37.83 SQM)	Office (9)	
B00B - R1055 - Movement - (15.51 SQM)	Not Applicable	Circulation or storage space.
B00B - R1056 - Art Learning Space - (70.61 SQM) - Teaching Space: 1	Student Space (32)	
B00B - R1057 - Movement - (6.1 SQM)	Not Applicable	Circulation or storage space.
B00C - M2001 - Study Space - (69.21 SQM)	Not Applicable	Circulation or storage space.
B00C - R0011 - Movement - (509.04 SQM)	Not Applicable	Circulation or storage space.
B00C - R1003 - Laboratory L.S. - (90.69 SQM) - Teaching Space: 1	Student Space (42)	
B00C - R1006 - Laboratory L.S. - (90.69 SQM) - Teaching Space: 1	Student Space (42)	
B00C - R1007 - Laboratory L.S. - (90.89 SQM) - Teaching Space: 1	Student Space (42)	
B00C - R1010 - Laboratory L.S. - (90.88 SQM) - Teaching Space: 1	Student Space (42)	
B00C - R1011 - Movement - (59.27 SQM)	Not Applicable	Circulation or storage space.
B00C - R1015 - Movement - (12.86 SQM)	Not Applicable	Circulation or storage space.
B00C - R1016 - Preparation - (39.19 SQM)	Not Applicable	Circulation or storage space.
B00C - R1018 - Preparation - (48.66 SQM)	Not Applicable	Circulation or storage space.
B00C - R1019 - Movement - (31.65 SQM)	Not Applicable	Circulation or storage space.
B00C - R2002 - Main Area - (322.47 SQM)	Not Applicable	Circulation or storage space.
B00C - R2004 - General Learning Space - (72.57 SQM) - Teaching Space: 1	Student Space (33)	
B00C - R2005 - Seminar - (14.03 SQM)	Office (3)	
B00C - R2006 - Seminar - (11.2 SQM)	Office (2)	
B00C - R2009 - Seminar - (11.17 SQM)	Office (2)	
B00C - R2010 - Seminar - (14.11 SQM)	Office (3)	
B00C - R2012 - Workroom - (17.78 SQM)	Office (4)	
B00C - R2022 - Movement - (6.35 SQM)	Not Applicable	Circulation or storage space.
B00C - R2023 - Movement - (28.37 SQM)	Not Applicable	Circulation or storage space.
B00D - R0005 - Gymnasium - (92.69 SQM)	Student Space (43)	
B00D - R1001 - Staff Study - (25.15 SQM)	Office (6)	
B00D - R1003 - General Learning Space - (53.58 SQM) - Teaching Space: 1	Student Space (24)	
B00D - R1005 - General Learning Space - (53.58 SQM) - Teaching Space: 1	Student Space (24)	
B00D - R1006 - General Learning Space - (53.58 SQM) - Teaching Space: 1	Student Space (24)	
B00D - R1007 - General Learning Space - (53.58 SQM) - Teaching Space: 1	Student Space (24)	
B00D - R1009 - Staff Study - (37.17 SQM)	Office (9)	
B00D - R1011 - Movement - (96.03 SQM)	Not Applicable	Circulation or storage space.
B00E - R0004 - Movement - (35.3 SQM)	Not Applicable	Circulation or storage space.

Entity Location	Audit Condition Classification (Capacity)	Comment
B00E - R0009 - Movement - (407.78 SQM)	Not Applicable	Circulation or storage space.
B00E - R1001 - General Learning Space - (53.13 SQM) - Teaching Space: 1	● Student Space (24)	
B00E - R1002 - General Learning Space - (52.91 SQM) - Teaching Space: 1	● Student Space (24)	
B00E - R1003 - General Learning Space - (52.99 SQM) - Teaching Space: 1	● Student Space (24)	
B00E - R1004 - Staff Study - (38.93 SQM)	● Office (9)	
B00E - R1006 - Computer Learning Space - (52.92 SQM) - Teaching Space: 1	● Student Space (24)	
B00E - R1009 - Computer Learning Space - (53.36 SQM) - Teaching Space: 1	● Student Space (24)	
B00E - R1010 - General Learning Space - (53.21 SQM) - Teaching Space: 1	● Student Space (24)	
B00E - R1013 - Preparation - (24.02 SQM)	Not Applicable	Circulation or storage space.
B00E - R1015 - Laboratory L.S. - (86.11 SQM) - Teaching Space: 1	● Student Space (39)	
B00E - R1016 - Music Learning Space - (52.77 SQM) - Teaching Space: 1	● Student Space (24)	
B00E - R1021 - Movement - (178.56 SQM)	Not Applicable	Circulation or storage space.
B00E - R1025 - Music Learning Space - (66.78 SQM) - Teaching Space: 1	● Student Space (30)	
B00F - R0004 - Movement - (373.46 SQM)	Not Applicable	Circulation or storage space.
B00F - R0005 - Movement - (298.12 SQM)	Not Applicable	Circulation or storage space.
B00F - R1007 - Materials Technology L.S. - (89.78 SQM) - Teaching Space: 1	● Student Space (41)	
B00F - R1010 - Materials Technology L.S. - (101.12 SQM) - Teaching Space: 1	● Student Space (46)	
B00F - R1012 - Movement - (126.15 SQM)	Not Applicable	Circulation or storage space.
B00F - R1013 - Design L.S. - (53.65 SQM) - Teaching Space: 1	● Student Space (24)	
B00F - R1016 - General Learning Space - (51.38 SQM) - Teaching Space: 1	● Student Space (23)	
B00F - R1018 - Movement - (59.56 SQM)	Not Applicable	Circulation or storage space.
B00F - R1019 - Design L.S. - (65.6 SQM) - Teaching Space: 1	● Student Space (30)	
B00F - R1024 - Metal Technology Bay - (75.76 SQM)	Not Applicable	Circulation or storage space.
B00F - R1025 - Metal Technology Bay - (22.25 SQM)	Not Applicable	Circulation or storage space.
B00F - R1027 - Wood Technology Bay - (81.94 SQM)	Not Applicable	Circulation or storage space.
B00F - R1029 - Wood Technology Bay - (11.35 SQM)	Not Applicable	Circulation or storage space.
B00F - R1030 - Welding/Hot Metals Area - (9.17 SQM)	Not Applicable	Circulation or storage space.
B00G - M1001 - Stage - (7.36 SQM)	Not Applicable	Circulation or storage space.
B00G - M1002 - Stage - (6.89 SQM)	Not Applicable	Circulation or storage space.
B00G - R0002 - Movement - (1203.28 SQM)	Not Applicable	Circulation or storage space.
B00G - R1003 - General Assistants - (12.66 SQM)	● Office (3)	
B00G - R1006 - Public Entry - (16.56 SQM)	Not Applicable	Circulation or storage space.
B00G - R1010 - Pupil Entry - (17.39 SQM)	Not Applicable	Circulation or storage space.
B00G - R1015 - Movement - (7.36 SQM)	Not Applicable	Circulation or storage space.
B00G - R1016 - Stage - (82.17 SQM)	Not Applicable	Circulation or storage space.
B00G - R1017 - Multi-Purpose Space - (425.42 SQM)	● Student Space (197)	
B00G - R1021 - Movement - (30.33 SQM)	Not Applicable	Circulation or storage space.
B00G - R1022 - Student Canteen - (54.28 SQM)	Not Applicable	Circulation or storage space.
B00G - R1024 - Movement - (6.89 SQM)	Not Applicable	Circulation or storage space.
B00G - R1030 - Movement - (12.4 SQM)	Not Applicable	Circulation or storage space.
B00G - R1031 - Movement - (114.09 SQM)	Not Applicable	Circulation or storage space.
B00G - R1032 - Movement - (76.2 SQM)	Not Applicable	Circulation or storage space.
B00G - R1033 - Movement - (23.61 SQM)	Not Applicable	Circulation or storage space.
OS 600 15882 - OS 600 15882 - Learning Unit - Small - (57 SQM)	● Student Space (26)	
OS 601 13814 - OS 601 13814 - Learning Unit - Standard/Withdrawal - (76 SQM)	● Student Space (35)	