

VENTILATION AUDIT REPORT

SCHOOL:	The Ponds School (5765)
AMU REGION:	Western Sydney
STATE ELECTORATE:	Riverstone
LOCAL GOVERNMENT AREA:	Blacktown

5765 - The Ponds School
Site Plan (14608)

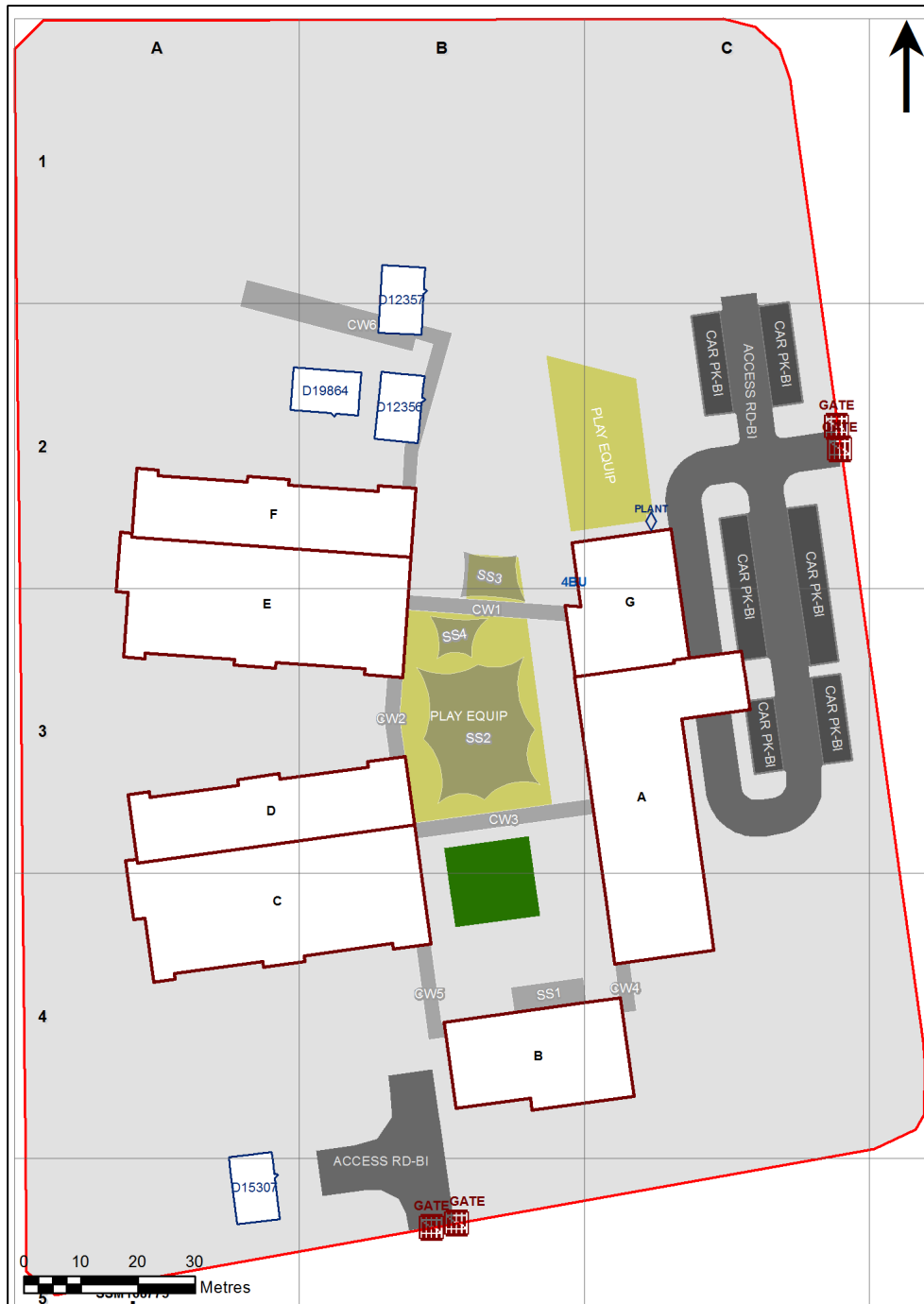

1:831

Printed: 28-Jun-2021

Ventilation Audit Key

Category	Description
	Category A Operate this space in line with COVID safe school operations . It has the required level of natural ventilation. NB. Circulation and storage areas should not be used for groups or gatherings.
	Category B This space should be occupied at 1 person per 4m ² to comply with COVID safe school operations and the guided use of spaces . The report details the number of people who can be accommodated safely in each of the identified spaces.

Entity Location	Audit Condition Classification (Capacity)	Comment
B00A - R0001 - Entry Vestibule - (25.53 SQM)	Not Applicable	Circulation or storage space.
B00A - R0002 - Clerical Office - (52.54 SQM)	Office (13)	
B00A - R0003 - Interview - (12.98 SQM)	Office (3)	
B00A - R0004 - Deputy Principal - Type 1 - (13.02 SQM)	Office (3)	
B00A - R0007 - Principal - (14.3 SQM)	Office (3)	
B00A - R0008 - Interview - (14.3 SQM)	Office (3)	
B00A - R0009 - Interview - (14.3 SQM)	Office (3)	
B00A - R0010 - Staff Room Annexe - (21.67 SQM)	Office (5)	
B00A - R0011 - Staff Room - (64.53 SQM)	Office (16)	
B00A - R0016 - Sick Bay - (9.19 SQM)	Student Space (4)	
B00A - R0024 - Movement - (59.81 SQM)	Not Applicable	Circulation or storage space.
B00B - R0001 - Communal Space - (119.25 SQM)	Student Space (55)	
B00B - R0002 - Staff Kitchen - (21.04 SQM)	Office (5)	
B00B - R0003 - Special Programs Room - (33.59 SQM)	Student Space (15)	
B00B - R0008 - Seminar/Study - (24.86 SQM)	Office (6)	
B00C - R0001 - Home Base/Practical Activities - M - (54.37 SQM) - Teaching Space: 1	Student Space (25)	
B00C - R0002 - Practical Activities - M - 1hb - (29.45 SQM)	Student Space (13)	
B00C - R0005 - Withdrawal - M - (9.2 SQM)	Student Space (4)	
B00C - R0006 - Breakout Area - (11.08 SQM)	Not Applicable	Circulation or storage space.
B00C - R0007 - Home Base/Practical Activities - M - (54.37 SQM) - Teaching Space: 1	Student Space (25)	
B00C - R0008 - Practical Activities - M - 1hb - (29.45 SQM)	Student Space (13)	
B00C - R0011 - Withdrawal - M - (9.2 SQM)	Student Space (4)	
B00C - R0012 - Breakout Area - (11.05 SQM)	Not Applicable	Circulation or storage space.
B00C - R0013 - Home Base - M - (54.37 SQM) - Teaching Space: 1	Student Space (25)	
B00C - R0014 - Practical Activities - M - 1hb - (29.38 SQM)	Student Space (13)	
B00C - R0017 - Withdrawal - M - (9.2 SQM)	Student Space (4)	
B00C - R0018 - Breakout Area - (11.05 SQM)	Not Applicable	Circulation or storage space.
B00C - R0019 - Home Base - M - (54.3 SQM) - Teaching Space: 1	Student Space (25)	
B00C - R0020 - Practical Activities - M - 1hb - (29.34 SQM)	Student Space (13)	
B00C - R0023 - Withdrawal - M - (9.2 SQM)	Student Space (4)	
B00C - R0024 - Breakout Area - (11.08 SQM)	Not Applicable	Circulation or storage space.
B00D - R0001 - Home Base - M - (54.51 SQM) - Teaching Space: 1	Student Space (25)	
B00D - R0002 - Practical Activities - M - 1hb - (29.34 SQM)	Student Space (13)	
B00D - R0005 - Withdrawal - M - (9.2 SQM)	Student Space (4)	
B00D - R0006 - Breakout Area - (11.08 SQM)	Not Applicable	Circulation or storage space.
B00D - R0007 - Home Base - M - (54.51 SQM) - Teaching Space: 1	Student Space (25)	
B00D - R0008 - Practical Activities - M - 1hb - (29.34 SQM)	Student Space (13)	
B00D - R0011 - Withdrawal - M - (9.23 SQM)	Student Space (4)	
B00D - R0012 - Breakout Area - (11.08 SQM)	Not Applicable	Circulation or storage space.
B00D - R0013 - Home Base - M - (54.51 SQM) - Teaching Space: 1	Student Space (25)	
B00D - R0014 - Practical Activities - M - 1hb - (29.33 SQM)	Student Space (13)	
B00D - R0017 - Withdrawal - M - (9.23 SQM)	Student Space (4)	
B00D - R0018 - Breakout Area - (11.08 SQM)	Not Applicable	Circulation or storage space.
B00D - R0019 - Home Base - M - (54.51 SQM) - Teaching Space: 1	Student Space (25)	
B00D - R0020 - Practical Activities - M - 1hb - (29.34 SQM)	Student Space (13)	
B00D - R0023 - Withdrawal - M - (9.23 SQM)	Student Space (4)	
B00D - R0024 - Breakout Area - (11.08 SQM)	Not Applicable	Circulation or storage space.
B00E - R0001 - Home Base - M - (54.88 SQM) - Teaching Space: 1	Student Space (25)	

Entity Location	Audit Condition Classification (Capacity)	Comment
B00E - R0002 - Practical Activities - M - 1hb - (28.75 SQM)	● Student Space (13)	
B00E - R0005 - Withdrawal - M - (9.22 SQM)	● Student Space (4)	
B00E - R0006 - Breakout Area - (11.12 SQM)	Not Applicable	Circulation or storage space.
B00E - R0007 - Home Base - M - (54.94 SQM) - Teaching Space: 1	● Student Space (25)	
B00E - R0008 - Practical Activities - M - 1hb - (28.79 SQM)	● Student Space (13)	
B00E - R0011 - Withdrawal - M - (9.26 SQM)	● Student Space (4)	
B00E - R0012 - Breakout Area - (11.15 SQM)	Not Applicable	Circulation or storage space.
B00E - R0013 - Home Base - M - (54.87 SQM) - Teaching Space: 1	● Student Space (25)	
B00E - R0014 - Practical Activities - M - 1hb - (28.75 SQM)	● Student Space (13)	
B00E - R0017 - Withdrawal - M - (9.26 SQM)	● Student Space (4)	
B00E - R0018 - Breakout Area - (11.19 SQM)	Not Applicable	Circulation or storage space.
B00E - R0019 - Home Base - M - (54.94 SQM) - Teaching Space: 1	● Student Space (25)	
B00E - R0020 - Practical Activities - M - 1hb - (28.79 SQM)	● Student Space (13)	
B00E - R0023 - Withdrawal - M - (9.26 SQM)	● Student Space (4)	
B00E - R0024 - Breakout Area - (11.12 SQM)	Not Applicable	Circulation or storage space.
B00F - R0001 - Home Base - M - (54.72 SQM) - Teaching Space: 1	● Student Space (25)	
B00F - R0002 - Practical Activities - M - 1hb - (28.75 SQM)	● Student Space (13)	
B00F - R0005 - Withdrawal - M - (9.26 SQM)	● Student Space (4)	
B00F - R0006 - Breakout Area - (11.15 SQM)	Not Applicable	Circulation or storage space.
B00F - R0007 - Home Base - M - (54.79 SQM) - Teaching Space: 1	● Student Space (25)	
B00F - R0008 - Practical Activities - M - 1hb - (28.79 SQM)	● Student Space (13)	
B00F - R0011 - Withdrawal - M - (9.22 SQM)	● Student Space (4)	
B00F - R0012 - Breakout Area - (11.15 SQM)	Not Applicable	Circulation or storage space.
B00F - R0013 - Home Base - M - (54.88 SQM) - Teaching Space: 1	● Student Space (25)	
B00F - R0014 - Practical Activities - M - 1hb - (28.64 SQM)	● Student Space (13)	
B00F - R0017 - Withdrawal - M - (9.22 SQM)	● Student Space (4)	
B00F - R0018 - Breakout Area - (11.12 SQM)	Not Applicable	Circulation or storage space.
B00F - R0019 - Home Base - M - (55.02 SQM) - Teaching Space: 1	● Student Space (25)	
B00F - R0020 - Practical Activities - M - 1hb - (28.71 SQM)	● Student Space (13)	
B00F - R0023 - Withdrawal - M - (9.26 SQM)	● Student Space (4)	
B00F - R0024 - Breakout Area - (11.15 SQM)	Not Applicable	Circulation or storage space.
B00G - R0011 - Hydrotherapy - Pool - (183.08 SQM)	Not Applicable	Circulation or storage space.
B00G - R0012 - Movement - (7.61 SQM)	Not Applicable	Circulation or storage space.
OS 621 12356 - OS 621 12356 - Learning Unit Single - PWD - (95 SQM)	● Student Space (44)	
OS 621 12357 - OS 621 12357 - Learning Unit Single - PWD - (95 SQM)	● Student Space (44)	
OS 621 15307 - OS 621 15307 - Learning Unit Single - PWD - (95 SQM)	● Student Space (44)	
OS 621 19864 - OS 621 19864 - Learning Unit Single - PWD - (95 SQM)	● Student Space (44)	