

VENTILATION AUDIT REPORT

| | |
|-------------------------------|--|
| SCHOOL: | Sutherland Hospital School (5546) |
| AMU REGION: | Sydney |
| STATE ELECTORATE: | Miranda |
| LOCAL GOVERNMENT AREA: | Sutherland |

5546 - Sutherland Hospital School
Site Plan (13053)

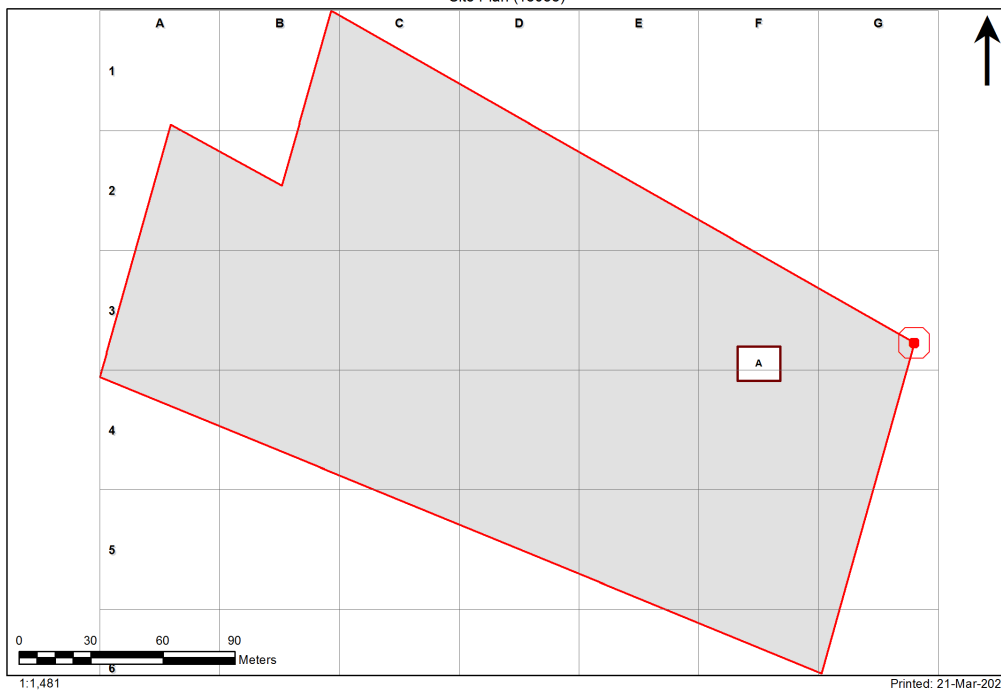

1:1,481

Printed: 21-Mar-2020

Ventilation Audit Key

| Category | Description |
|---|--|
|  | Category A Operate this space in line with COVID safe school operations . It has the required level of natural ventilation. NB. Circulation and storage areas should not be used for groups or gatherings. |
|  | Category B This space should be occupied at 1 person per 4m ² to comply with COVID safe school operations and the guided use of spaces . The report details the number of people who can be accommodated safely in each of the identified spaces. |

| Entity Location | Audit Condition Classification (Capacity) | Comment |
|--|--|---------|
| B00A - R3001 - Home Base - (33.87 SQM) - Teaching Space: 1 |  Student Space (15) | |
| B00A - R3002 - Clerical Office - (5.94 SQM) |  Office (1) | |