

VENTILATION AUDIT REPORT

SCHOOL:	St Marys North Public School (4205)
AMU REGION:	Western Sydney
STATE ELECTORATE:	Londonderry
LOCAL GOVERNMENT AREA:	Penrith

4205 - St Marys North Public School
Site Plan (10755)

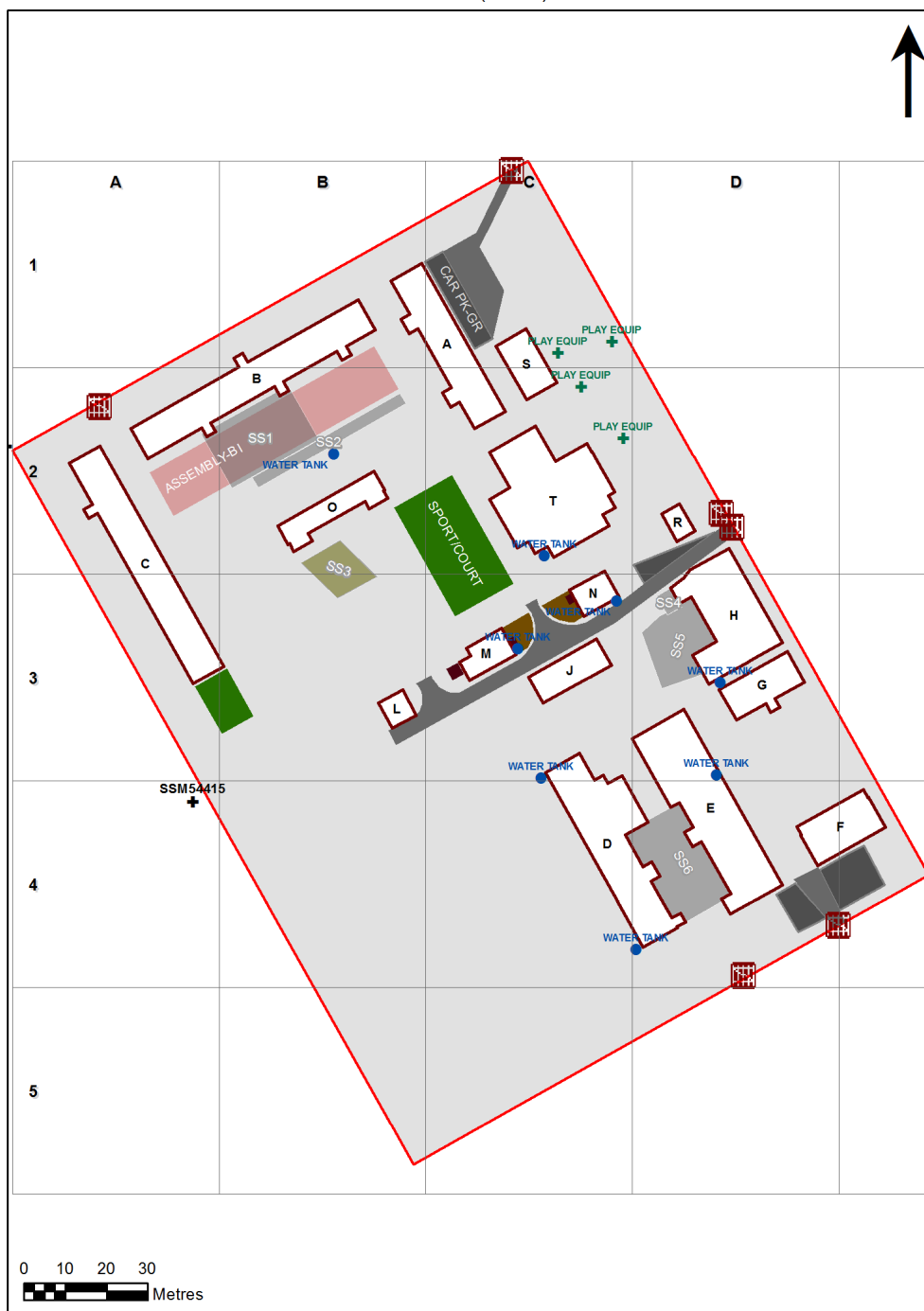

1:1,149

Printed: 19-Jun-2021

Ventilation Audit Key

Category	Description
	Category A Operate this space in line with COVID safe school operations . It has the required level of natural ventilation. NB. Circulation and storage areas should not be used for groups or gatherings.
	Category B This space should be occupied at 1 person per 4m ² to comply with COVID safe school operations and the guided use of spaces . The report details the number of people who can be accommodated safely in each of the identified spaces.

Entity Location	Audit Condition Classification (Capacity)	Comment
B00A - R0001 - Home Base - (57.08 SQM) - Teaching Space: 1	● Student Space (26)	
B00A - R0005 - Movement - (12.4 SQM)	Not Applicable	Circulation or storage space.
B00A - R0008 - Home Base - (57.23 SQM) - Teaching Space: 1	● Student Space (26)	
B00A - R0010 - Home Base - (57.2 SQM) - Teaching Space: 1	● Student Space (26)	
B00A - R0012 - Movement - (6.48 SQM)	Not Applicable	Circulation or storage space.
B00A - R0017 - Home Base - (54.69 SQM) - Teaching Space: 1	● Student Space (25)	
B00B - R0001 - Home Base - (59.67 SQM) - Teaching Space: 1	● Student Space (27)	
B00B - R0003 - Movement - (6.35 SQM)	Not Applicable	Circulation or storage space.
B00B - R0006 - Home Base - (56.3 SQM) - Teaching Space: 1	● Student Space (26)	
B00B - R0008 - Home Base - (56.45 SQM) - Teaching Space: 1	● Student Space (26)	
B00B - R0011 - Movement - (31.09 SQM)	Not Applicable	Circulation or storage space.
B00B - R0013 - Staff Room Annexe - (14.1 SQM)	● Office (3)	
B00B - R0016 - Movement - (7.03 SQM)	Not Applicable	Circulation or storage space.
B00B - R0021 - Withdrawal Space - 1hb - (16.44 SQM)	● Student Space (7)	
B00B - R0022 - Home Base - (57.11 SQM) - Teaching Space: 1	● Student Space (26)	
B00B - R0027 - Home Base - (92.22 SQM) - Teaching Space: 1	● Student Space (42)	
B00B - R0028 - Staff Room Annexe - (21.79 SQM)	● Office (5)	
B00C - R0001 - Staff Room - (38.19 SQM)	● Office (9)	
B00C - R0003 - Staff Kitchen - (5.95 SQM)	● Office (1)	
B00C - R0004 - Principal - (17.97 SQM)	● Office (4)	
B00C - R0008 - Sick Bay - (8.19 SQM)	● Student Space (3)	
B00C - R0009 - Clerical Office/Workroom - (47.65 SQM)	● Office (11)	
B00C - R0011 - Interview - (10.33 SQM)	● Office (2)	
B00C - R0013 - Interview - (10.33 SQM)	● Office (2)	
B00C - R0017 - Entry Vestibule - (14.7 SQM)	Not Applicable	Circulation or storage space.
B00C - R0019 - Reading Area - (94.23 SQM)	● Student Space (43)	
B00C - R0030 - Movement - (15.08 SQM)	Not Applicable	Circulation or storage space.
B00C - R0031 - Movement - (9.73 SQM)	Not Applicable	Circulation or storage space.
B00D - R0001 - Home Base - (65.63 SQM) - Teaching Space: 1	● Student Space (30)	
B00D - R0005 - Movement - (7.21 SQM)	Not Applicable	Circulation or storage space.
B00D - R0008 - Communal Space - (88.91 SQM)	● Student Space (41)	
B00D - R0011 - Communal Space - (61.35 SQM)	● Student Space (28)	
B00D - R0012 - Staff Kitchen - (14.46 SQM)	● Office (3)	
B00D - R0015 - Movement - (18.32 SQM)	Not Applicable	Circulation or storage space.
B00D - R0019 - Home Base - (64.3 SQM) - Teaching Space: 1	● Student Space (29)	
B00D - R0020 - Staff Room Annexe - (16.11 SQM)	● Office (4)	
B00D - R0021 - Movement - (11.47 SQM)	Not Applicable	Circulation or storage space.
B00E - R0004 - Home Base - (90.55 SQM) - Teaching Space: 1	● Student Space (42)	
B00E - R0007 - Movement - (8.92 SQM)	Not Applicable	Circulation or storage space.
B00E - R0008 - Home Base - (64.71 SQM) - Teaching Space: 1	● Student Space (30)	
B00E - R0011 - Movement - (15.66 SQM)	Not Applicable	Circulation or storage space.
B00E - R0016 - Home Base - (65.34 SQM) - Teaching Space: 1	● Student Space (30)	
B00E - R0017 - Home Base - (65.52 SQM) - Teaching Space: 1	● Student Space (30)	
B00F - R0003 - Home Base - (56.76 SQM) - Teaching Space: 1	● Student Space (26)	
B00F - R0006 - Movement - (6.37 SQM)	Not Applicable	Circulation or storage space.
B00F - R0009 - Home Base - (56.99 SQM) - Teaching Space: 1	● Student Space (26)	
B00G - R0001 - Home Base - (57.66 SQM) - Teaching Space: 1	● Student Space (26)	
B00G - R0004 - Movement - (5.75 SQM)	Not Applicable	Circulation or storage space.

Entity Location	Audit Condition Classification (Capacity)	Comment
B00G - R0006 - Home Base - (57.38 SQM) - Teaching Space: 1	● Student Space (26)	
B00H - R0001 - Clerical Office - (13.2 SQM)	● Office (3)	
B00H - R0002 - Clerical Office - (12.84 SQM)	● Office (3)	
B00H - R0004 - Home Base - Pre - (51.98 SQM) - Teaching Space: 1	● Student Space (24)	
B00H - R0005 - Practical Activities - Pre - (51.91 SQM)	● Student Space (24)	
B00H - R0010 - Staff Kitchen - (13.53 SQM)	● Office (3)	
B00H - R0011 - Movement - (6.49 SQM)	Not Applicable	Circulation or storage space.
B00H - R0016 - Home Base - E - (62.28 SQM) - Teaching Space: 1	● Student Space (28)	
B00H - R0018 - Movement - (5.43 SQM)	Not Applicable	Circulation or storage space.
B00H - R0019 - Movement - (9.64 SQM)	Not Applicable	Circulation or storage space.
B00L - R0001 - Movement - (13.33 SQM)	Not Applicable	Circulation or storage space.
B00L - R0002 - Canteen - (18.13 SQM)	Not Applicable	Circulation or storage space.
B00N - R0001 - Movement - (17.39 SQM)	Not Applicable	Circulation or storage space.
B00S - R0001 - Home Base - (47.13 SQM) - Teaching Space: 1	● Student Space (21)	
B00S - R0002 - Home Base - (47.06 SQM) - Teaching Space: 1	● Student Space (21)	
B00T - R0001 - Communal Space - (201.23 SQM)	● Student Space (93)	
B00T - R0002 - Raised Platform - (62.6 SQM)	Not Applicable	Circulation or storage space.
B00T - R0003 - Movement - (12.96 SQM)	Not Applicable	Circulation or storage space.
B00T - R0004 - Movement - (5.92 SQM)	Not Applicable	Circulation or storage space.