

# VENTILATION AUDIT REPORT

<b>SCHOOL:</b>	<b>St Ives High School (8400)</b>
<b>AMU REGION:</b>	<b>Northern Sydney</b>
<b>STATE ELECTORATE:</b>	<b>Davidson</b>
<b>LOCAL GOVERNMENT AREA:</b>	<b>Ku-Ring-Gai</b>

8400 - St Ives High School  
Site Plan (11266)

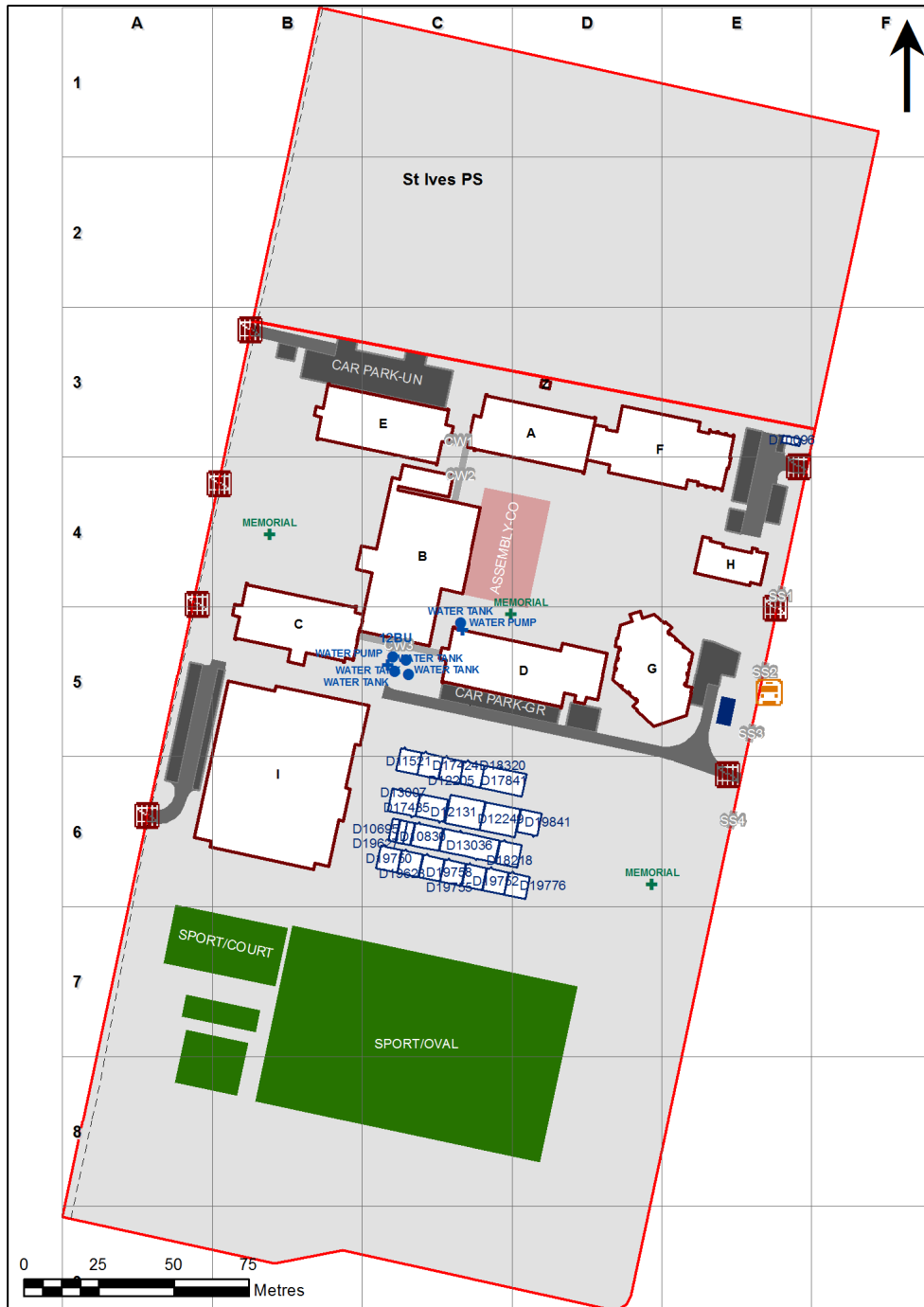

1:1,584

Printed: 07-Jul-2021

## Ventilation Audit Key

Category	Description
	Category A Operate this space in line with <a href="#">COVID safe school operations</a> . It has the required level of natural ventilation. NB. Circulation and storage areas should not be used for groups or gatherings.
	Category B This space should be occupied at 1 person per 4m <sup>2</sup> to comply with <a href="#">COVID safe school operations and the guided use of spaces</a> . The report details the number of people who can be accommodated safely in each of the identified spaces.

Entity Location	Audit Condition Classification (Capacity)	Comment
B00A - R0018 - Seminar - (25.78 SQM)	Office (6)	
B00A - R0019 - Movement - (116.34 SQM)	Not Applicable	Circulation or storage space.
B00A - R0025 - Food Technology L.S. - (65.73 SQM) - Teaching Space: 1	Student Space (30)	
B00A - R0026 - Food Technology L.S. - (84.74 SQM) - Teaching Space: 1	Student Space (39)	
B00A - R0029 - Preparation - Materials - (16.7 SQM)	Not Applicable	Circulation or storage space.
B00A - R0030 - Science Laboratory - (40.37 SQM)	Student Space (18)	
B00A - R0031 - Science Laboratory - (52.25 SQM)	Student Space (24)	
B00A - R0032 - Preparation - (25.67 SQM)	Not Applicable	Circulation or storage space.
B00A - R0033 - Science Laboratory - (53.28 SQM)	Student Space (24)	
B00A - R0034 - Science Laboratory - (39.62 SQM)	Student Space (18)	
B00A - R1003 - Design/Technology L.S. - (52.65 SQM) - Teaching Space: 1	Student Space (24)	
B00A - R1006 - Staff Study - (52.8 SQM)	Office (13)	
B00A - R1009 - Computer Learning Space - (52.65 SQM) - Teaching Space: 1	Student Space (24)	
B00A - R1011 - General Learning Space - (52.58 SQM) - Teaching Space: 1	Student Space (24)	
B00A - R1013 - Special Learning Space - (25.96 SQM) - Teaching Space: 1	Student Space (12)	
B00A - R1015 - Special Learning Space - (26.03 SQM) - Teaching Space: 1	Student Space (12)	
B00A - R1016 - Movement - (114.58 SQM)	Not Applicable	Circulation or storage space.
B00A - R1022 - Staff Study - (19 SQM)	Office (4)	
B00A - R1023 - General Learning Space - (52.37 SQM) - Teaching Space: 1	Student Space (24)	
B00A - R1024 - General Learning Space - (52 SQM) - Teaching Space: 1	Student Space (24)	
B00A - R1026 - Seminar - Type 1 - (12.46 SQM)	Office (3)	
B00A - R1028 - General Learning Space - (52.35 SQM) - Teaching Space: 1	Student Space (24)	
B00B - R0002 - General Assistants - (29.44 SQM)	Office (7)	
B00B - R0007 - Gymnasium - (310.3 SQM)	Student Space (143)	
B00B - R0013 - Movement - (6.29 SQM)	Not Applicable	Circulation or storage space.
B00B - R0022 - Student Canteen - (43.29 SQM)	Not Applicable	Circulation or storage space.
B00B - R0026 - Staff Room - (62.43 SQM)	Office (15)	
B00B - R0029 - Staff Study - (23.01 SQM)	Office (5)	
B00B - R0037 - Movement - (5.3 SQM)	Not Applicable	Circulation or storage space.
B00C - R0004 - Materials Technology L.S. - (66.06 SQM)	Student Space (30)	
B00C - R0011 - Staff Study - (25.03 SQM)	Office (6)	
B00C - R0018 - Movement - (111.64 SQM)	Not Applicable	Circulation or storage space.
B00C - R0025 - Wood Technology L.S. - (78.77 SQM)	Student Space (36)	
B00C - R0027 - Design L.S. - (65.48 SQM)	Student Space (30)	
B00C - R0029 - Wood Technology L.S. - (78.85 SQM) - Teaching Space: 1	Student Space (36)	
B00C - R0031 - Metal Technology L.S. - (86.83 SQM)	Student Space (40)	
B00C - R0033 - Welding Area - (5.3 SQM)	Not Applicable	Circulation or storage space.
B00C - R0034 - Wood Technology Bay - (92.91 SQM)	Not Applicable	Circulation or storage space.
B00C - R0035 - Workshop Area - (38.45 SQM)	Student Space (17)	
B00C - R0037 - General Learning Space - (72.63 SQM) - Teaching Space: 1	Student Space (33)	
B00C - R0038 - General Learning Space - (65.18 SQM) - Teaching Space: 1	Student Space (30)	
B00C - R0039 - Metal Technology Bay - (98.09 SQM)	Not Applicable	Circulation or storage space.
B00C - R1001 - Computer Learning Space - (52.65 SQM)	Student Space (24)	
B00C - R1003 - Music Learning Space - (39.2 SQM)	Student Space (18)	
B00C - R1004 - Music Learning Space - (64.94 SQM) - Teaching Space: 1	Student Space (30)	
B00C - R1006 - Music Learning Space - (66.11 SQM) - Teaching Space: 1	Student Space (30)	
B00C - R1011 - Art Learning Space - (52.73 SQM)	Student Space (24)	

Entity Location	Audit Condition Classification (Capacity)	Comment
B00C - R1014 - Art Learning Space - (52.87 SQM)	● Student Space (24)	
B00C - R1019 - Movement - (9.9 SQM)	Not Applicable	Circulation or storage space.
B00C - R1020 - Art Learning Space - (52.65 SQM) - Teaching Space: 1	● Student Space (24)	
B00C - R1025 - Movement - (79.88 SQM)	Not Applicable	Circulation or storage space.
B00C - R1026 - Movement - (16.16 SQM)	Not Applicable	Circulation or storage space.
B00C - R1028 - Movement - (11.63 SQM)	Not Applicable	Circulation or storage space.
B00C - R1029 - Staff Study - (22.9 SQM)	● Office (5)	
B00C - R1033 - Visual Arts Workshop - (58.29 SQM)	● Student Space (27)	
B00C - R1035 - Staff Study - (29.64 SQM)	● Office (7)	
B00C - R1037 - Practice/Seminar - (12.04 SQM)	Not Applicable	Circulation or storage space.
B00C - R1038 - Practice/Seminar - (13.24 SQM)	Not Applicable	Circulation or storage space.
B00C - R1039 - Computer Room - (65.71 SQM)	● Student Space (30)	
B00C - R1040 - Visual Arts Workshop - (51.85 SQM)	● Student Space (24)	
B00C - R9004 - Movement - (5.59 SQM)	Not Applicable	Circulation or storage space.
B00D - R0004 - Interview/Office - Type 1 - (12.89 SQM)	● Office (3)	
B00D - R0005 - Seminar - (19.61 SQM)	● Office (4)	
B00D - R0006 - Principal Office - (19.55 SQM)	● Office (4)	
B00D - R0010 - Ancillary Staff - (25.71 SQM)	● Office (6)	
B00D - R0016 - Art Learning Space - (52.8 SQM) - Teaching Space: 1	● Student Space (24)	
B00D - R0019 - Leading Teacher - (12.61 SQM)	● Office (3)	
B00D - R0031 - Public Reception - (76.53 SQM)	Not Applicable	Circulation or storage space.
B00D - R0033 - Isolation Space - (9.33 SQM)	● Office (2)	
B00D - R0034 - Deputy Principal Office - (16.28 SQM)	● Office (4)	
B00D - R0035 - Deputy Principal Office - (16.32 SQM)	● Office (4)	
B00D - R0045 - Student Waiting - (5.64 SQM)	Not Applicable	Circulation or storage space.
B00D - R0047 - Administration - Clerical - (47.08 SQM)	● Office (11)	
B00D - R0048 - Clinic - (9.97 SQM)	● Office (2)	
B00D - R0049 - Movement - (8.84 SQM)	Not Applicable	Circulation or storage space.
B00D - R0050 - Movement - (112.91 SQM)	Not Applicable	Circulation or storage space.
B00D - R0053 - Movement - (45.18 SQM)	Not Applicable	Circulation or storage space.
B00D - R0056 - Commonroom - (98.64 SQM)	● Office (24)	
B00D - R0057 - Staff Kitchen - (9.61 SQM)	● Office (2)	
B00D - R0058 - Staff Room - (50.15 SQM)	● Office (12)	
B00D - R0062 - Interview/Meeting - (19.11 SQM)	● Office (4)	
B00D - R0063 - Interview/Meeting - (19.11 SQM)	● Office (4)	
B00D - R0064 - Principal Office - (19.11 SQM)	● Office (4)	
B00D - R0066 - Movement - (84.4 SQM)	Not Applicable	Circulation or storage space.
B00D - R0067 - Administration - Clerical - (15.12 SQM)	● Office (3)	
B00D - R1002 - General Learning Space - (52.73 SQM) - Teaching Space: 1	● Student Space (24)	
B00D - R1004 - General Learning Space - (66.04 SQM) - Teaching Space: 1	● Student Space (30)	
B00D - R1006 - General Learning Space - (66.05 SQM) - Teaching Space: 1	● Student Space (30)	
B00D - R1011 - General Learning Space - (52.73 SQM) - Teaching Space: 1	● Student Space (24)	
B00D - R1012 - General Learning Space - (52.58 SQM) - Teaching Space: 1	● Student Space (24)	
B00D - R1013 - General Learning Space - (52.51 SQM) - Teaching Space: 1	● Student Space (24)	
B00D - R1014 - General Learning Space - (52.58 SQM) - Teaching Space: 1	● Student Space (24)	
B00D - R1016 - General Learning Space - (66.2 SQM) - Teaching Space: 1	● Student Space (30)	
B00D - R1021 - Staff Study - (38.45 SQM)	● Office (9)	
B00D - R1022 - Movement - (16.41 SQM)	Not Applicable	Circulation or storage space.
B00D - R1023 - Movement - (107.63 SQM)	Not Applicable	Circulation or storage space.

Entity Location	Audit Condition Classification (Capacity)	Comment
B00E - R0001 - Laboratory L.S. - (93 SQM) - Teaching Space: 1	● Student Space (43)	
B00E - R0003 - Preparation - Science - (28.9 SQM)	Not Applicable	Circulation or storage space.
B00E - R0004 - Laboratory L.S. - (92.76 SQM) - Teaching Space: 1	● Student Space (43)	
B00E - R0005 - Performance Workshop - (66.44 SQM)	● Student Space (30)	
B00E - R0007 - General Learning Space - (52.65 SQM) - Teaching Space: 1	● Student Space (24)	
B00E - R0009 - General Learning Space - (52.58 SQM) - Teaching Space: 1	● Student Space (24)	
B00E - R0010 - General Learning Space - (52.65 SQM) - Teaching Space: 1	● Student Space (24)	
B00E - R0011 - General Learning Space - (52.65 SQM) - Teaching Space: 1	● Student Space (24)	
B00E - R0015 - Movement - (123.69 SQM)	Not Applicable	Circulation or storage space.
B00E - R0020 - Movement - (8.16 SQM)	Not Applicable	Circulation or storage space.
B00E - R1001 - General Learning Space - (52.8 SQM) - Teaching Space: 1	● Student Space (24)	
B00E - R1003 - General Learning Space - (52.65 SQM) - Teaching Space: 1	● Student Space (24)	
B00E - R1008 - General Learning Space - (52.8 SQM) - Teaching Space: 1	● Student Space (24)	
B00E - R1010 - General Learning Space - (52.65 SQM) - Teaching Space: 1	● Student Space (24)	
B00E - R1011 - General Learning Space - (52.51 SQM) - Teaching Space: 1	● Student Space (24)	
B00E - R1012 - General Learning Space - (52.58 SQM) - Teaching Space: 1	● Student Space (24)	
B00E - R1013 - General Learning Space - (52.65 SQM) - Teaching Space: 1	● Student Space (24)	
B00E - R1017 - Movement - (122.21 SQM)	Not Applicable	Circulation or storage space.
B00E - R1021 - Movement - (8.32 SQM)	Not Applicable	Circulation or storage space.
B00E - R1026 - General Learning Space - (53.02 SQM) - Teaching Space: 1	● Student Space (24)	
B00E - R1027 - Staff Study - (35.11 SQM)	● Office (8)	
B00E - R1029 - Isolation Space - (12.54 SQM)	● Office (3)	
B00E - R9004 - Movement - (22.05 SQM)	Not Applicable	Circulation or storage space.
B00E - R9007 - Movement - (8.53 SQM)	Not Applicable	Circulation or storage space.
B00F - M1006 - Senior Study - (150.83 SQM)	● Office (37)	
B00F - R0001 - General Learning Space - (52.74 SQM) - Teaching Space: 1	● Student Space (24)	
B00F - R0004 - Laboratory L.S. - (91.11 SQM) - Teaching Space: 1	● Student Space (42)	
B00F - R0005 - Preparation - Science - (46.58 SQM)	Not Applicable	Circulation or storage space.
B00F - R0006 - Seminar - (50.65 SQM)	● Office (12)	
B00F - R0009 - Laboratory L.S. - (91.14 SQM) - Teaching Space: 1	● Student Space (42)	
B00F - R0010 - Preparation - Science - (46.71 SQM)	Not Applicable	Circulation or storage space.
B00F - R0012 - Laboratory L.S. - (91.32 SQM) - Teaching Space: 1	● Student Space (42)	
B00F - R0013 - General Learning Space - (52.61 SQM) - Teaching Space: 1	● Student Space (24)	
B00F - R0026 - Staff Study - (39.46 SQM)	● Office (9)	
B00F - R0028 - Movement - (168.05 SQM)	Not Applicable	Circulation or storage space.
B00F - R1001 - Staff Study - (53.03 SQM)	● Office (13)	
B00F - R1002 - General Learning Space - (52.96 SQM) - Teaching Space: 1	● Student Space (24)	
B00F - R1015 - Seminar - (12.49 SQM)	● Office (3)	
B00F - R1018 - Staff Study - (21.89 SQM)	● Office (5)	
B00F - R1021 - Seminar - (12.57 SQM)	● Office (3)	
B00F - R1024 - Reading Area - (48.55 SQM)	● Student Space (22)	
B00F - R1027 - Audio Visual Workroom - (12.92 SQM)	● Student Space (5)	
B00F - R1029 - Movement - (55.93 SQM)	Not Applicable	Circulation or storage space.
B00F - R1039 - Main Area - (373.44 SQM)	Not Applicable	Circulation or storage space.
B00F - R1042 - Movement - (14.91 SQM)	Not Applicable	Circulation or storage space.
B00F - R9005 - Design/Technology L.S. - (53.63 SQM) - Teaching Space: 1	● Student Space (24)	
B00F - R9006 - Movement - (19.54 SQM)	Not Applicable	Circulation or storage space.
B00G - R0004 - Movement - (20.69 SQM)	Not Applicable	Circulation or storage space.
B00G - R0008 - Stage - (114.12 SQM)	Not Applicable	Circulation or storage space.

Entity Location	Audit Condition Classification (Capacity)	Comment
B00G - R0022 - Multi-Purpose Space - (423.37 SQM)	Student Space (196)	
B00G - R9008 - Practice/Seminar - (71.14 SQM)	Not Applicable	Circulation or storage space.
B00H - R0001 - Food Technology L.S. - (107.79 SQM) - Teaching Space: 1	Student Space (50)	
B00H - R0003 - Preparation - Materials - (16.74 SQM)	Not Applicable	Circulation or storage space.
B00H - R0009 - Outdoor Learning Area - (44.81 SQM)	Not Applicable	Circulation or storage space.
B00I - R0001 - Gymnasium - (1508.92 SQM)	Student Space (700)	
B00I - R0012 - Movement - (136.92 SQM)	Not Applicable	Circulation or storage space.
B00I - R0015 - Staff Study - (31.23 SQM)	Office (7)	
B00I - R0025 - Student Canteen - (49.6 SQM)	Not Applicable	Circulation or storage space.
B00I - R0028 - Movement - (19.47 SQM)	Not Applicable	Circulation or storage space.
B00I - R1001 - Movement - (106.25 SQM)	Not Applicable	Circulation or storage space.
B00I - R1004 - Seminar - (20.22 SQM)	Office (5)	
B00I - R1006 - General Learning Space - Type 13 - (58.66 SQM) - Teaching Space: 1	Student Space (27)	
B00I - R1007 - General Learning Space - Type 13 - (59.72 SQM) - Teaching Space: 1	Student Space (27)	
B00I - R1013 - Fitness Laboratory - (99.55 SQM)	Student Space (46)	
NS 200 12131 - NS 200 12131 - Art Learning Space/Workshop/Bulk Store - (95 SQM)	Not Applicable	Circulation or storage space.
NS 200 12249 - NS 200 12249 - Art Learning Space/Workshop/Bulk Store - (95 SQM)	Not Applicable	Circulation or storage space.
OS 502 13036 - OS 502 13036 - Admin Staff/Principal/Clerk/Dup/Clinic - (152 SQM)	Office (38)	
OS 523 10830 - OS 523 10830 - Staff Study With Toilets - (76 SQM)	Office (19)	
OS 523 11476 - OS 523 11476 - Staff Study With Toilets - (76 SQM)	Office (19)	
OS 600 11521 - OS 600 11521 - Learning Unit - Small - (57 SQM)	Student Space (26)	
OS 600 12205 - OS 600 12205 - Learning Unit - Small - (57 SQM)	Student Space (26)	
OS 600 16246 - OS 600 16246 - Learning Unit - Small - (57 SQM)	Student Space (26)	
OS 600 17424 - OS 600 17424 - Learning Unit - Small - (57 SQM)	Student Space (26)	
OS 600 18144 - OS 600 18144 - Learning Unit - Small - (57 SQM)	Student Space (26)	
OS 600 18207 - OS 600 18207 - Learning Unit - Small - (57 SQM)	Student Space (26)	
OS 600 18218 - OS 600 18218 - Learning Unit - Small - (57 SQM)	Student Space (26)	
OS 600 18222 - OS 600 18222 - Learning Unit - Small - (57 SQM)	Student Space (26)	
OS 600 18320 - OS 600 18320 - Learning Unit - Small - (57 SQM)	Student Space (26)	
OS 600 19627 - OS 600 19627 - Learning Unit - Small - (57 SQM)	Student Space (26)	
OS 600 19628 - OS 600 19628 - Learning Unit - Small - (57 SQM)	Student Space (26)	
OS 600 19749 - OS 600 19749 - Learning Unit - Small - (57 SQM)	Student Space (26)	
OS 600 19750 - OS 600 19750 - Learning Unit - Small - (57 SQM)	Student Space (26)	
OS 600 19751 - OS 600 19751 - Learning Unit - Small - (57 SQM)	Student Space (26)	
OS 600 19752 - OS 600 19752 - Learning Unit - Small - (57 SQM)	Student Space (26)	
OS 600 19755 - OS 600 19755 - Learning Unit - Small - (57 SQM)	Student Space (26)	
OS 600 19758 - OS 600 19758 - Learning Unit - Small - (57 SQM)	Student Space (26)	
OS 600 19776 - OS 600 19776 - Learning Unit - Small - (57 SQM)	Student Space (26)	
OS 600 19840 - OS 600 19840 - Learning Unit - Small - (57 SQM)	Student Space (26)	
OS 600 19841 - OS 600 19841 - Learning Unit - Small - (57 SQM)	Student Space (26)	
OS 600 19842 - OS 600 19842 - Learning Unit - Small - (57 SQM)	Student Space (26)	
OS 600 19843 - OS 600 19843 - Learning Unit - Small - (57 SQM)	Student Space (26)	
OS 600 19845 - OS 600 19845 - Learning Unit - Small - (57 SQM)	Student Space (26)	
OS 600 19846 - OS 600 19846 - Learning Unit - Small - (57 SQM)	Student Space (26)	
OS 601 13007 - OS 601 13007 - Learning Unit - Standard/Withdrawal - (76 SQM)	Student Space (35)	
OS 602 17435 - OS 602 17435 - Learning Unit - Standard With P.A.A. - (76 SQM)	Student Space (35)	
OS 720 14160 - OS 720 14160 - Science Laboratory/Prep Room - (114 SQM)	Not Applicable	Circulation or storage space.
OS 720 17841 - OS 720 17841 - Science Laboratory/Prep Room - (114 SQM)	Not Applicable	Circulation or storage space.