

VENTILATION AUDIT REPORT

SCHOOL:	South Grafton Public School (2061)
AMU REGION:	North Coast
STATE ELECTORATE:	Clarence
LOCAL GOVERNMENT AREA:	Clarence Valley

2061 - South Grafton Public School
Site Plan (12986)

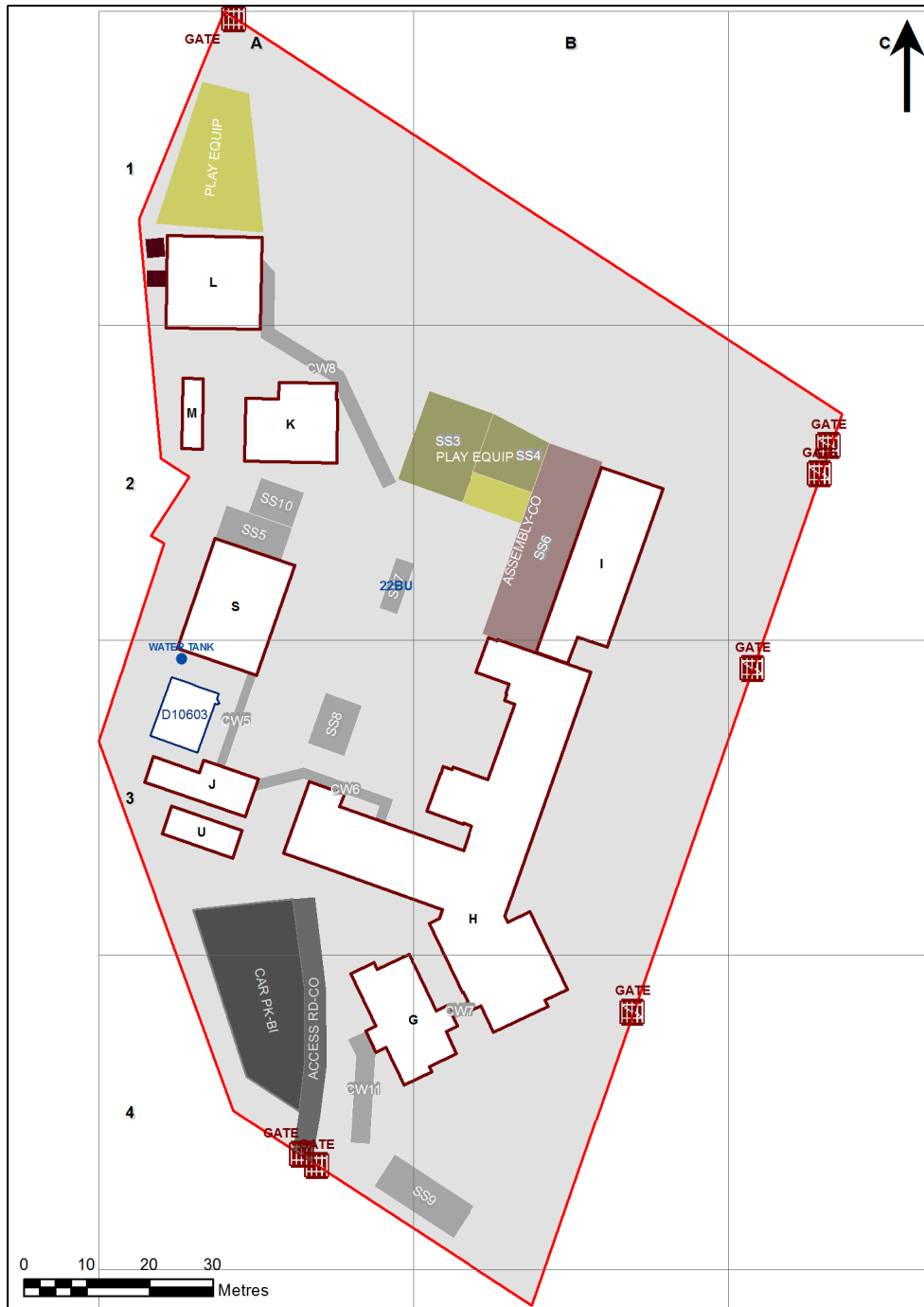

1:755

Printed: 10-Jul-2021

Ventilation Audit Key

Category	Description
	Category A Operate this space in line with COVID safe school operations . It has the required level of natural ventilation. NB. Circulation and storage areas should not be used for groups or gatherings.
	Category B This space should be occupied at 1 person per 4m ² to comply with COVID safe school operations and the guided use of spaces . The report details the number of people who can be accommodated safely in each of the identified spaces.

Entity Location	Audit Condition Classification (Capacity)	Comment
B00A - M0001 - Movement - (5.52 SQM)	Not Applicable	Circulation or storage space.
B00A - R0001 - Interview - (11.06 SQM)	Office (2)	
B00A - R0002 - Movement - (7.74 SQM)	Not Applicable	Circulation or storage space.
B00A - R0003 - Home Base - (48.03 SQM) - Teaching Space: 1	Student Space (22)	
B00A - R0004 - Movement - (96.38 SQM)	Not Applicable	Circulation or storage space.
B00A - R0005 - Home Base - (47.98 SQM) - Teaching Space: 1	Student Space (22)	
B00A - R0006 - Home Base - (48.04 SQM) - Teaching Space: 1	Student Space (22)	
B00A - R0007 - Home Base - (48.33 SQM) - Teaching Space: 1	Student Space (22)	
B00A - R0010 - Home Base - (47.02 SQM) - Teaching Space: 1	Student Space (21)	
B00A - R0012 - Movement - (5.14 SQM)	Not Applicable	Circulation or storage space.
B00A - R1001 - Movement - (113.58 SQM)	Not Applicable	Circulation or storage space.
B00A - R1003 - Home Base - (49.81 SQM) - Teaching Space: 1	Student Space (23)	
B00A - R1004 - Home Base - (50.29 SQM) - Teaching Space: 1	Student Space (23)	
B00A - R1005 - Home Base - (50.28 SQM) - Teaching Space: 1	Student Space (23)	
B00A - R1006 - Home Base - (50.7 SQM) - Teaching Space: 1	Student Space (23)	
B00A - R1009 - Home Base - M - (50.91 SQM) - Teaching Space: 1	Student Space (23)	
B00A - R1010 - Movement - (8.36 SQM)	Not Applicable	Circulation or storage space.
B00B - R0005 - Special Programs Room - (77.79 SQM)	Student Space (36)	
B00B - R1001 - Movement - (62.35 SQM)	Not Applicable	Circulation or storage space.
B00B - R1008 - Special Programs Room - (25.83 SQM)	Student Space (11)	
B00B - R1009 - Home Base - (52.39 SQM) - Teaching Space: 1	Student Space (24)	
B00B - R1011 - Special Programs Room - (16.88 SQM)	Student Space (7)	
B00B - R1013 - Home Base - (52.47 SQM) - Teaching Space: 1	Student Space (24)	
B00C - R0006 - Clerical Office - (27.03 SQM)	Office (6)	
B00C - R0008 - Deputy Principal - (8.67 SQM)	Office (2)	
B00C - R0009 - Deputy Principal - (8.6 SQM)	Office (2)	
B00C - R0010 - Interview - (13.97 SQM)	Office (3)	
B00C - R0011 - Principal - (17.97 SQM)	Office (4)	
B00C - R0017 - Movement - (6.21 SQM)	Not Applicable	Circulation or storage space.
B00C - R0018 - Movement - (23.95 SQM)	Not Applicable	Circulation or storage space.
B00C - R0019 - Entry Vestibule - (8.79 SQM)	Not Applicable	Circulation or storage space.
B00C - R0020 - Movement - (8.36 SQM)	Not Applicable	Circulation or storage space.
B00C - R0021 - Deputy Principal - Type 1 - (13.55 SQM)	Office (3)	
B00C - R0022 - Deputy Principal - Type 1 - (14.25 SQM)	Office (3)	
B00C - R0023 - Clerical Office - (14.27 SQM)	Office (3)	
B00C - R1007 - Movement - (47.93 SQM)	Not Applicable	Circulation or storage space.
B00C - R1009 - Movement - (6.26 SQM)	Not Applicable	Circulation or storage space.
B00C - R1011 - Staff Room - (37.87 SQM)	Office (9)	
B00C - R1012 - Staff Room - (82.36 SQM)	Office (20)	
B00D - R0002 - Canteen - (43.45 SQM)	Not Applicable	Circulation or storage space.
B00D - R0006 - Communal Space - (186.43 SQM)	Student Space (86)	
B00D - R0009 - Movement - (5.18 SQM)	Not Applicable	Circulation or storage space.
B00D - R0011 - Raised Platform - (52.84 SQM)	Not Applicable	Circulation or storage space.
B00E - R0002 - Practical Activities - 1hb - (13.97 SQM)	Student Space (6)	
B00E - R0003 - Home Base - (62.23 SQM) - Teaching Space: 1	Student Space (28)	
B00G - R0001 - Staff Room - (51.89 SQM)	Office (12)	
B00G - R0004 - Clerical Office - (10.59 SQM)	Office (2)	
B00G - R0007 - Deputy Principal - (12.66 SQM)	Office (3)	
B00G - R0009 - Clerical Office - (12.81 SQM)	Office (3)	

Entity Location	Audit Condition Classification (Capacity)	Comment
B00G - R0013 - Movement - (39 SQM)	Not Applicable	Circulation or storage space.
B00G - R0019 - Staff Room - (11.19 SQM)	Office (2)	
B00G - R0020 - Duplicating Workroom - (9.72 SQM)	Office (2)	
B00H - R0001 - Home Base - (66.05 SQM) - Teaching Space: 1	Student Space (30)	
B00H - R0003 - Movement - (139.7 SQM)	Not Applicable	Circulation or storage space.
B00H - R0004 - Practical Activities - 1hb - (6.57 SQM)	Student Space (3)	
B00H - R0005 - Home Base - (52.09 SQM) - Teaching Space: 1	Student Space (24)	
B00H - R0008 - Special Programs Room - (30.33 SQM)	Student Space (14)	
B00H - R0010 - Communal Space - (139.64 SQM)	Student Space (64)	
B00H - R0012 - Raised Platform - (22.49 SQM)	Not Applicable	Circulation or storage space.
B00H - R0015 - Home Base - (51.11 SQM) - Teaching Space: 1	Student Space (23)	
B00H - R0019 - Practical Activities - 1hb - (6.2 SQM)	Student Space (2)	
B00H - R0020 - Home Base - (51.03 SQM) - Teaching Space: 1	Student Space (23)	
B00H - R0025 - Home Base - (51.03 SQM) - Teaching Space: 1	Student Space (23)	
B00H - R0026 - Home Base - (51.02 SQM) - Teaching Space: 1	Student Space (23)	
B00H - R0027 - Practical Activities - 1hb - (6.26 SQM)	Student Space (2)	
B00H - R0033 - Movement - (52.65 SQM)	Not Applicable	Circulation or storage space.
B00I - R0003 - Movement - (5.74 SQM)	Not Applicable	Circulation or storage space.
B00I - R0007 - Home Base - (87.41 SQM) - Teaching Space: 1	Student Space (40)	
B00I - R0008 - Home Base - (82.69 SQM) - Teaching Space: 1	Student Space (38)	
B00I - R0013 - Movement - (5.74 SQM)	Not Applicable	Circulation or storage space.
B00J - R0002 - Canteen - (22.49 SQM)	Not Applicable	Circulation or storage space.
B00K - R0002 - Home Base - E - (105.06 SQM) - Teaching Space: 1	Student Space (48)	
B00K - R0004 - Withdrawal Space - 1hb - (11.78 SQM)	Student Space (5)	
B00K - R0005 - Practical Activities - 1hb - (16.89 SQM)	Student Space (7)	
B00L - R0002 - Home Base - E - (53.69 SQM) - Teaching Space: 1	Student Space (24)	
B00L - R0003 - Practical Activities - 1hb - (25.35 SQM)	Student Space (11)	
B00L - R0004 - Home Base - E - (53.56 SQM) - Teaching Space: 1	Student Space (24)	
B00S - R0002 - Practical Activities - 1hb - (19.22 SQM)	Student Space (8)	
B00S - R0004 - Home Base - (60.6 SQM) - Teaching Space: 1	Student Space (28)	
B00S - R0005 - Withdrawal Space - 2hb - (11.77 SQM)	Student Space (5)	
B00S - R0006 - Home Base - (61.02 SQM) - Teaching Space: 1	Student Space (28)	
B00S - R0008 - Practical Activities - 1hb - (19.31 SQM)	Student Space (8)	
B00T - R0002 - Reading Area - (230.97 SQM)	Student Space (107)	
OS 602 10493 - OS 602 10493 - Learning Unit - Standard With P.A.A. - (76 SQM)	Student Space (35)	
OS 602 10603 - OS 602 10603 - Learning Unit - Standard With P.A.A. - (76 SQM)	Student Space (35)	
OS 602 18262 - OS 602 18262 - Learning Unit - Standard With P.A.A. - (76 SQM)	Student Space (35)	
OS 602 92047 - OS 602 92047 - Learning Unit - Standard With P.A.A. - (76 SQM)	Student Space (35)	