

# VENTILATION AUDIT REPORT

<b>SCHOOL:</b>	<b>Shoal Bay Public School (4589)</b>
<b>AMU REGION:</b>	<b>Hunter/Central Coast</b>
<b>STATE ELECTORATE:</b>	<b>Port Stephens</b>
<b>LOCAL GOVERNMENT AREA:</b>	<b>Port Stephens</b>

4589 - Shoal Bay Public School  
Site Plan (11702)

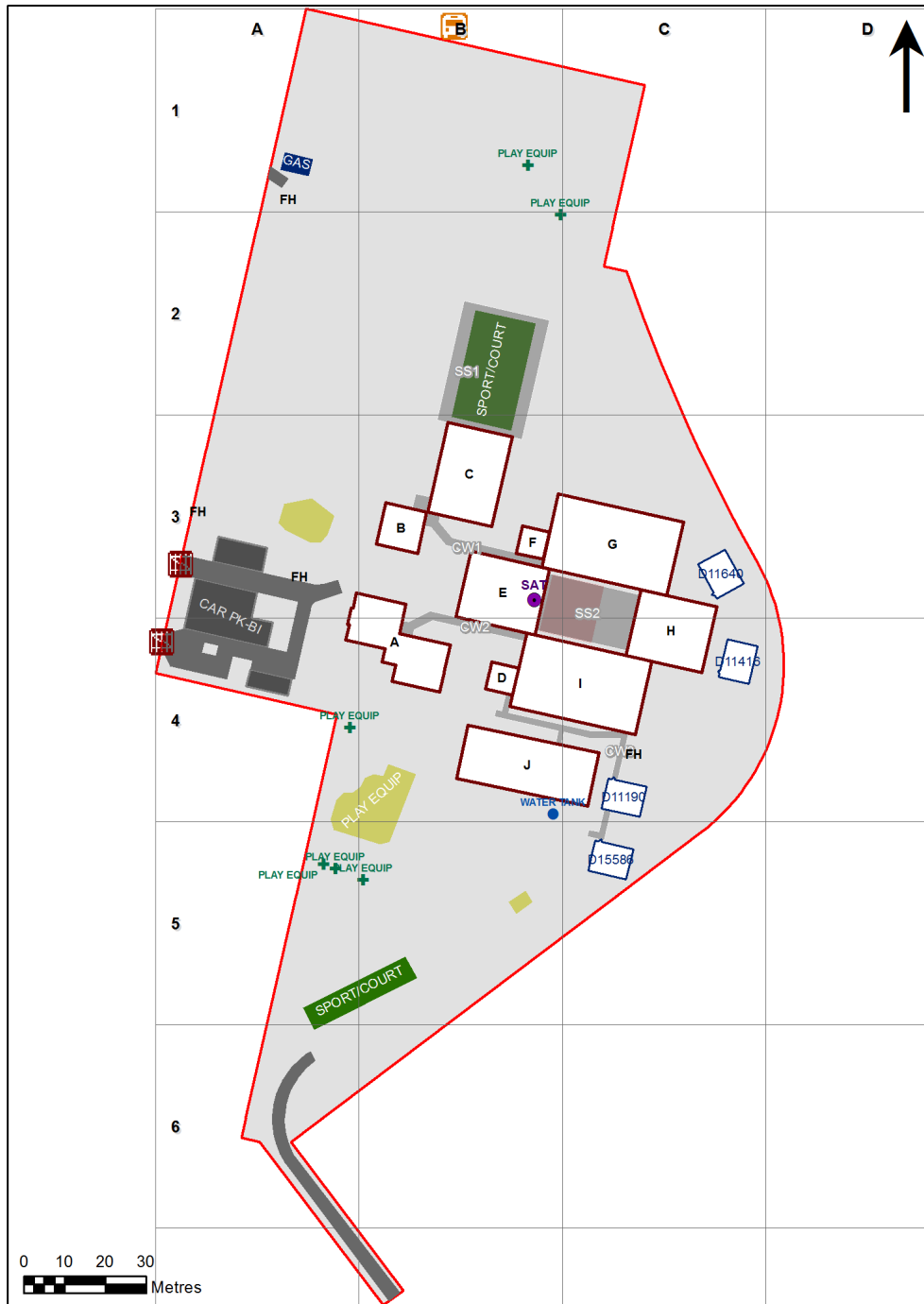

1:1,165

Printed: 17-Dec-2020

## Ventilation Audit Key

Category	Description
	Category A Operate this space in line with <a href="#">COVID safe school operations</a> . It has the required level of natural ventilation. NB. Circulation and storage areas should not be used for groups or gatherings.
	Category B This space should be occupied at 1 person per 4m <sup>2</sup> to comply with <a href="#">COVID safe school operations and the guided use of spaces</a> . The report details the number of people who can be accommodated safely in each of the identified spaces.

Entity Location	Audit Condition Classification (Capacity)	Comment
B00A - R0004 - Movement - (20.36 SQM)	Not Applicable	Circulation or storage space.
B00A - R0005 - Duplicating Workroom - (13.01 SQM)	Office (3)	
B00A - R0007 - Sick Bay - (9.13 SQM)	Student Space (4)	
B00A - R0008 - Clerical Office/Workroom - (21.24 SQM)	Office (5)	
B00A - R0009 - Clerical Office - (13.12 SQM)	Office (3)	
B00A - R0010 - Principal - (17.41 SQM)	Office (4)	
B00A - R0011 - Entry Vestibule - (16.92 SQM)	Not Applicable	Circulation or storage space.
B00A - R0012 - Movement - (11.25 SQM)	Not Applicable	Circulation or storage space.
B00A - R0013 - Staff Room Annexe - (13.08 SQM)	Office (3)	
B00A - R0014 - Staff Room Annexe - (13.45 SQM)	Office (3)	
B00A - R0015 - Movement - (14 SQM)	Not Applicable	Circulation or storage space.
B00A - R0019 - Staff Room - (48.97 SQM)	Office (12)	
B00A - R0020 - Staff Room Annexe - (19.35 SQM)	Office (4)	
B00B - R0002 - Movement - (37.92 SQM)	Not Applicable	Circulation or storage space.
B00B - R0006 - Canteen - (26.16 SQM)	Not Applicable	Circulation or storage space.
B00C - R0005 - Movement - (12.54 SQM)	Not Applicable	Circulation or storage space.
B00C - R0010 - Movement - (21.58 SQM)	Not Applicable	Circulation or storage space.
B00C - R0011 - Communal Space - (138.08 SQM)	Student Space (64)	
B00C - R0019 - Raised Platform - (49.57 SQM)	Not Applicable	Circulation or storage space.
B00E - R0002 - Reading Area - (163.25 SQM)	Student Space (75)	
B00E - R0004 - Special Programs Room - (32.38 SQM)	Student Space (15)	
B00E - R0007 - Movement - (32.86 SQM)	Not Applicable	Circulation or storage space.
B00E - R0008 - Movement - (35.71 SQM)	Not Applicable	Circulation or storage space.
B00G - R0001 - Movement - (20.11 SQM)	Not Applicable	Circulation or storage space.
B00G - R0002 - Withdrawal Space - 1hb - (12.03 SQM)	Student Space (5)	
B00G - R0003 - Home Base - (63.59 SQM) - Teaching Space: 1	Student Space (29)	
B00G - R0005 - Practical Activities - 1hb - (31.37 SQM)	Student Space (14)	
B00G - R0006 - Movement - (6.87 SQM)	Not Applicable	Circulation or storage space.
B00G - R0007 - Home Base - (63.13 SQM) - Teaching Space: 1	Student Space (29)	
B00G - R0011 - Movement - (6.86 SQM)	Not Applicable	Circulation or storage space.
B00G - R0012 - Staff Room Annexe - (17.04 SQM)	Office (4)	
B00G - R0013 - Practical Activities - 1hb - (33.13 SQM)	Student Space (15)	
B00G - R0015 - Home Base - (63.62 SQM) - Teaching Space: 1	Student Space (29)	
B00G - R0016 - Movement - (20.22 SQM)	Not Applicable	Circulation or storage space.
B00G - R0017 - Withdrawal Space - 1hb - (11.96 SQM)	Student Space (5)	
B00G - R0019 - Home Base - (63.04 SQM) - Teaching Space: 1	Student Space (29)	
B00G - R0023 - Movement - (94.86 SQM)	Not Applicable	Circulation or storage space.
B00H - R0001 - Movement - (11.6 SQM)	Not Applicable	Circulation or storage space.
B00H - R0003 - Movement - (6.63 SQM)	Not Applicable	Circulation or storage space.
B00H - R0007 - Home Base - (62.57 SQM) - Teaching Space: 1	Student Space (29)	
B00H - R0009 - Withdrawal Space - 1hb - (12.24 SQM)	Student Space (5)	
B00H - R0011 - Home Base - (62.57 SQM) - Teaching Space: 1	Student Space (29)	
B00H - R0012 - Movement - (11.6 SQM)	Not Applicable	Circulation or storage space.
B00H - R0014 - Practical Activities - 1hb - (40.82 SQM)	Student Space (18)	
B00H - R0016 - Movement - (6.64 SQM)	Not Applicable	Circulation or storage space.
B00H - R0018 - Movement - (34.42 SQM)	Not Applicable	Circulation or storage space.
B00I - R0001 - Home Base - (63.45 SQM) - Teaching Space: 1	Student Space (29)	
B00I - R0003 - Movement - (20.11 SQM)	Not Applicable	Circulation or storage space.
B00I - R0004 - Withdrawal Space - 1hb - (11.95 SQM)	Student Space (5)	
B00I - R0005 - Home Base - (63.2 SQM) - Teaching Space: 1	Student Space (29)	

Entity Location	Audit Condition Classification (Capacity)	Comment
B00I - R0009 - Practical Activities - 1hb - (31.37 SQM)	● Student Space (14)	
B00I - R0010 - Movement - (6.95 SQM)	Not Applicable	Circulation or storage space.
B00I - R0011 - Withdrawal Space - 1hb - (16.95 SQM)	● Student Space (7)	
B00I - R0012 - Movement - (6.96 SQM)	Not Applicable	Circulation or storage space.
B00I - R0013 - Practical Activities - 1hb - (29.11 SQM)	● Student Space (13)	
B00I - R0018 - Home Base - (63.2 SQM) - Teaching Space: 1	● Student Space (29)	
B00I - R0019 - Movement - (20.14 SQM)	Not Applicable	Circulation or storage space.
B00I - R0020 - Withdrawal Space - 1hb - (12.06 SQM)	● Student Space (5)	
B00I - R0021 - Home Base - (63.52 SQM) - Teaching Space: 1	● Student Space (29)	
B00I - R0024 - Movement - (94.83 SQM)	Not Applicable	Circulation or storage space.
B00J - R0005 - Practical Activities - 1hb - (20.72 SQM)	● Student Space (9)	
B00J - R0006 - Special Programs Room - (58.51 SQM)	● Student Space (27)	
B00J - R0008 - Withdrawal Space - 1hb - (9.25 SQM)	● Student Space (4)	
B00J - R0010 - Practical Activities - (19.38 SQM)	● Student Space (8)	
B00J - R0011 - Home Base - (61.42 SQM) - Teaching Space: 1	● Student Space (28)	
B00J - R0013 - Withdrawal Space - 2hb - (11.67 SQM)	● Student Space (5)	
B00J - R0015 - Practical Activities - (19.85 SQM)	● Student Space (9)	
B00J - R0016 - Home Base - (61.34 SQM) - Teaching Space: 1	● Student Space (28)	
OS 602 11190 - OS 602 11190 - Learning Unit - Standard With P.A.A. - (76 SQM)	● Student Space (35)	
OS 602 11416 - OS 602 11416 - Learning Unit - Standard With P.A.A. - (76 SQM)	● Student Space (35)	
OS 602 11640 - OS 602 11640 - Learning Unit - Standard With P.A.A. - (76 SQM)	● Student Space (35)	
OS 602 15586 - OS 602 15586 - Learning Unit - Standard With P.A.A. - (76 SQM)	● Student Space (35)	