

# VENTILATION AUDIT REPORT

<b>SCHOOL:</b>	<b>Seven Hills North Public School (3053)</b>
<b>AMU REGION:</b>	<b>Western Sydney</b>
<b>STATE ELECTORATE:</b>	<b>Seven Hills</b>
<b>LOCAL GOVERNMENT AREA:</b>	<b>Blacktown</b>

3053 - Seven Hills North Public School  
Site Plan (11287)

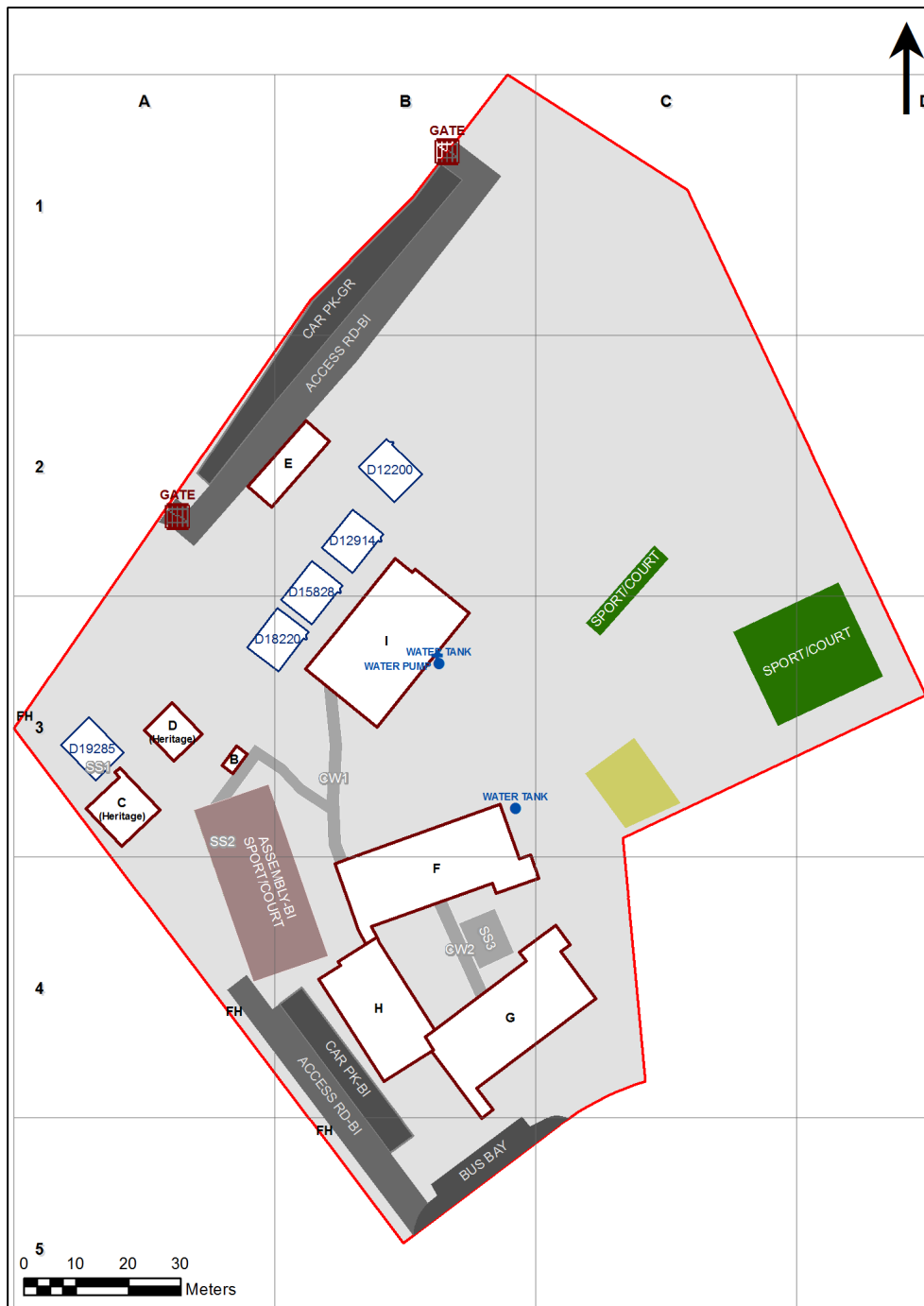

1:908

Printed: 02-May-2020

## Ventilation Audit Key

Category	Description
	Category A Operate this space in line with <a href="#">COVID safe school operations</a> . It has the required level of natural ventilation. NB. Circulation and storage areas should not be used for groups or gatherings.
	Category B This space should be occupied at 1 person per 4m <sup>2</sup> to comply with <a href="#">COVID safe school operations and the guided use of spaces</a> . The report details the number of people who can be accommodated safely in each of the identified spaces.

Entity Location	Audit Condition Classification (Capacity)	Comment
B00C - R0003 - Home Base - (52.34 SQM) - Teaching Space: 1	● Student Space (24)	
B00C - R0004 - Movement - (16.96 SQM)	Not Applicable	Circulation or storage space.
B00D - R0001 - Withdrawal Space - 1hb - (23.56 SQM)	● Student Space (10)	
B00D - R0003 - Movement - (11.33 SQM)	Not Applicable	Circulation or storage space.
B00F - R0001 - Home Base - (60.19 SQM) - Teaching Space: 1	● Student Space (27)	
B00F - R0003 - Practical Activities - 1hb - (19.1 SQM)	● Student Space (8)	
B00F - R0006 - Withdrawal Space - 2hb - (11.67 SQM)	● Student Space (5)	
B00F - R0007 - Practical Activities - 1hb - (19.12 SQM)	● Student Space (8)	
B00F - R0008 - Home Base - (60.1 SQM) - Teaching Space: 1	● Student Space (27)	
B00F - R0010 - Home Base - (60.37 SQM) - Teaching Space: 1	● Student Space (28)	
B00F - R0011 - Withdrawal Space - 1hb - (5.89 SQM)	● Student Space (2)	
B00F - R0012 - Practical Activities - 1hb - (18.73 SQM)	● Student Space (8)	
B00F - R9001 - Home Base - (59.57 SQM) - Teaching Space: 1	● Student Space (27)	
B00F - R9003 - Practical Activities - 1hb - (19.13 SQM)	● Student Space (8)	
B00F - R9004 - Movement - (93.17 SQM)	Not Applicable	Circulation or storage space.
B00F - R9006 - Withdrawal Space - 2hb - (11.49 SQM)	● Student Space (5)	
B00F - R9007 - Practical Activities - 1hb - (19.15 SQM)	● Student Space (8)	
B00F - R9008 - Home Base - (59.2 SQM) - Teaching Space: 1	● Student Space (27)	
B00G - R0002 - Staff Room Annexe - (20.85 SQM)	● Office (5)	
B00G - R0003 - Staff Room - (36.59 SQM)	● Office (9)	
B00G - R0004 - Staff Kitchen - (7.61 SQM)	● Office (1)	
B00G - R0006 - Deputy Principal - (13.87 SQM)	● Office (3)	
B00G - R0007 - Deputy Principal - (13.15 SQM)	● Office (3)	
B00G - R0008 - Interview - (13.19 SQM)	● Office (3)	
B00G - R0010 - Sick Bay - (9.78 SQM)	● Student Space (4)	
B00G - R0011 - Clerical Office - (17.97 SQM)	● Office (4)	
B00G - R0013 - Entry Vestibule - (20.62 SQM)	Not Applicable	Circulation or storage space.
B00G - R0014 - Duplicating Workroom - (17.32 SQM)	● Office (4)	
B00G - R0016 - Principal - (16.56 SQM)	● Office (4)	
B00G - R0022 - Movement - (41.61 SQM)	Not Applicable	Circulation or storage space.
B00G - R9002 - Movement - (51.82 SQM)	Not Applicable	Circulation or storage space.
B00G - R9003 - Practical Activities - 1hb - (19.15 SQM)	● Student Space (8)	
B00G - R9005 - Home Base - (59.85 SQM) - Teaching Space: 1	● Student Space (27)	
B00G - R9006 - Withdrawal Space - 2hb - (10.92 SQM)	● Student Space (5)	
B00G - R9007 - Home Base - (60.09 SQM) - Teaching Space: 1	● Student Space (27)	
B00G - R9009 - Practical Activities - 1hb - (19.14 SQM)	● Student Space (8)	
B00G - R9012 - Movement - (7.86 SQM)	Not Applicable	Circulation or storage space.
B00H - R0002 - Reading Area - (159.62 SQM)	● Student Space (74)	
B00I - R0003 - Communal Space - (143.68 SQM)	● Student Space (66)	
B00I - R0004 - Raised Platform - (58.61 SQM)	Not Applicable	Circulation or storage space.
B00I - R0015 - Movement - (5.96 SQM)	Not Applicable	Circulation or storage space.
B00I - R0016 - Movement - (12.98 SQM)	Not Applicable	Circulation or storage space.
B00I - R0017 - Movement - (16.27 SQM)	Not Applicable	Circulation or storage space.
OS 602 12914 - OS 602 12914 - Learning Unit - Standard With P.A.A. - (76 SQM)	● Student Space (35)	
OS 602 15828 - OS 602 15828 - Learning Unit - Standard With P.A.A. - (76 SQM)	● Student Space (35)	
OS 602 18220 - OS 602 18220 - Learning Unit - Standard With P.A.A. - (76 SQM)	● Student Space (35)	
OS 606 19285 - OS 606 19285 - Learning Unit - Standard With P.A.A A/C - (76 SQM)	● Student Space (35)	