

VENTILATION AUDIT REPORT

SCHOOL:	Sefton Infants School (5188)
AMU REGION:	South Western Sydney
STATE ELECTORATE:	Bankstown
LOCAL GOVERNMENT AREA:	Canterbury-Bankstown

5188 - Sefton Infants School
Site Plan (11285)

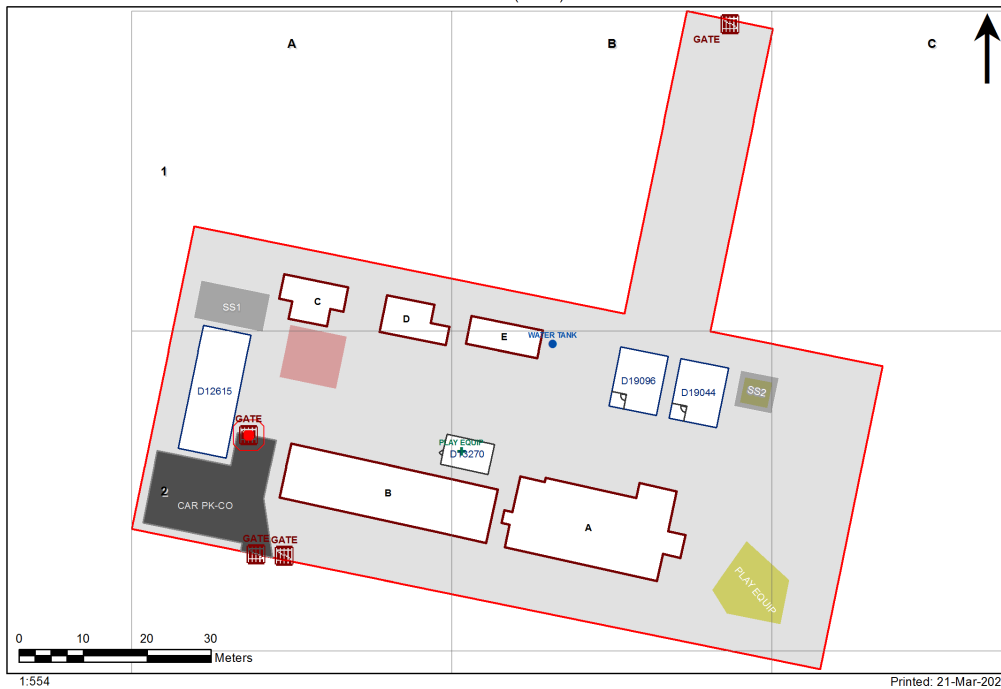

1:554

Printed: 21-Mar-2020

Ventilation Audit Key

Category	Description
	Category A Operate this space in line with COVID safe school operations . It has the required level of natural ventilation. NB. Circulation and storage areas should not be used for groups or gatherings.
	Category B This space should be occupied at 1 person per 4m ² to comply with COVID safe school operations and the guided use of spaces . The report details the number of people who can be accommodated safely in each of the identified spaces.

Entity Location	Audit Condition Classification (Capacity)	Comment
B00A - R0004 - Withdrawal - Pre - (12.31 SQM)	● Student Space (5)	
B00A - R0005 - Practical Activities - Pre - (12.6 SQM)	● Student Space (5)	
B00A - R0006 - Interview - (11.83 SQM)	● Office (2)	
B00A - R0009 - Practical Activities - Pre - (54.34 SQM)	● Student Space (25)	
B00A - R0010 - Home Base - Pre - (66.79 SQM) - Teaching Space: 1	● Student Space (30)	
B00A - R0016 - Movement - (60.14 SQM)	Not Applicable	Circulation or storage space.
B00B - R0004 - Home Base - (46.72 SQM) - Teaching Space: 1	● Student Space (21)	
B00B - R0005 - Home Base - (46.72 SQM) - Teaching Space: 1	● Student Space (21)	
B00B - R0006 - Practical Activities - 1hb - (9.28 SQM)	● Student Space (4)	
B00B - R0007 - Special Programs Room - (37.76 SQM)	● Student Space (17)	
B00B - R0008 - Home Base - (47.04 SQM) - Teaching Space: 1	● Student Space (21)	
B00B - R0010 - Movement - (44.57 SQM)	Not Applicable	Circulation or storage space.
B00C - R0002 - Clerical Office - (21.35 SQM)	● Office (5)	
B00C - R0004 - Movement - (16.41 SQM)	Not Applicable	Circulation or storage space.
OS 503 12615 - OS 503 12615 - Admin Lib Staff/Principal/Clerk/Store - (152 SQM)	● Office (38)	
OS 606 19044 - OS 606 19044 - Learning Unit - Standard With P.A.A A/C - (76 SQM)	● Student Space (35)	
OS 606 19096 - OS 606 19096 - Learning Unit - Standard With P.A.A A/C - (76 SQM)	● Student Space (35)	
OS 750 13270 - OS 750 13270 - Learning Unit - ESL - (38 SQM)	● Student Space (17)	