

VENTILATION AUDIT REPORT

SCHOOL:	Railway Town Public School (4233)
AMU REGION:	North Western NSW
STATE ELECTORATE:	Barwon
LOCAL GOVERNMENT AREA:	Broken Hill

4233 - Railway Town Public School
Site Plan (13311)

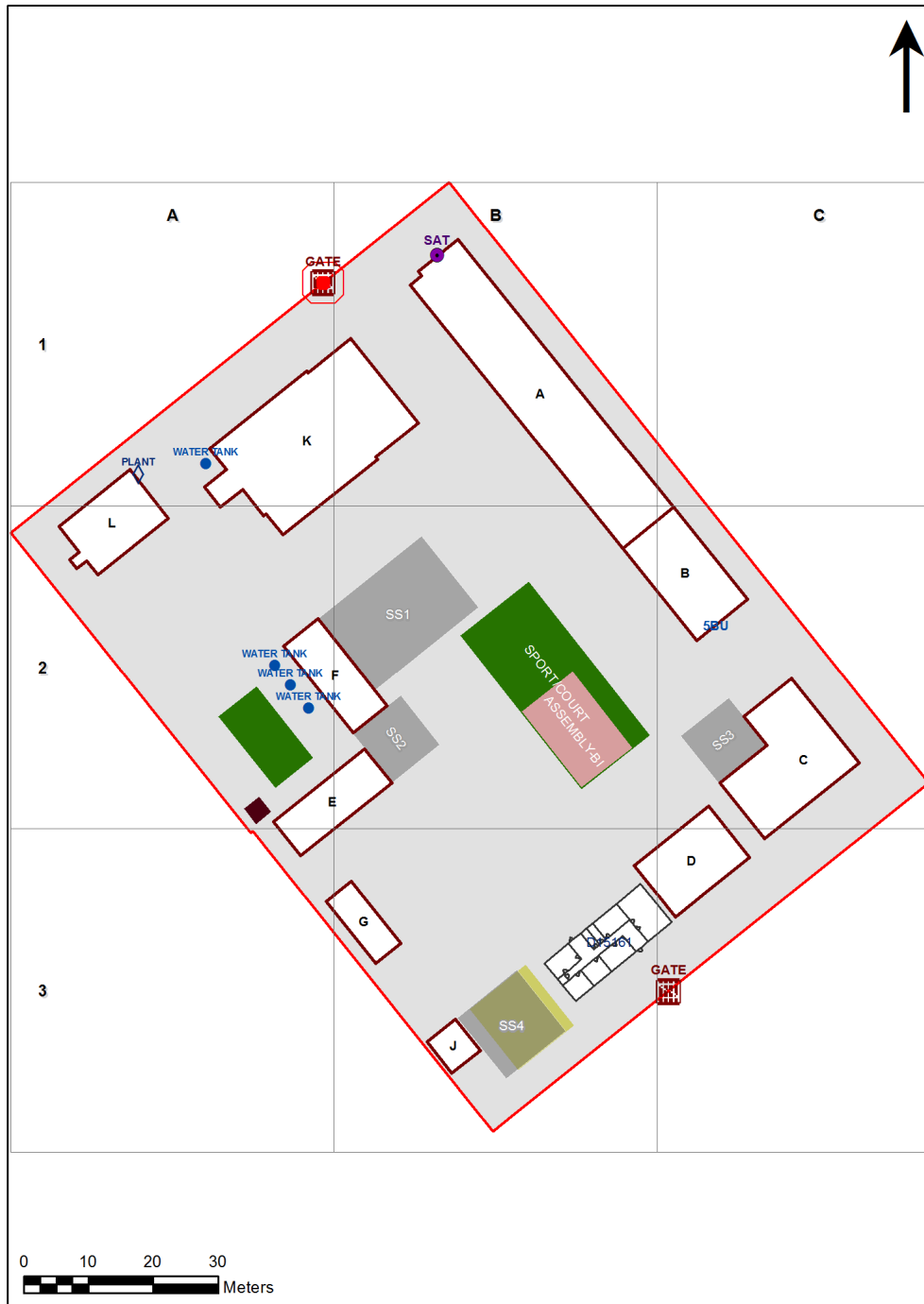

1:733

Printed: 21-Mar-2020

Ventilation Audit Key

Category	Description
	Category A Operate this space in line with COVID safe school operations . It has the required level of natural ventilation. NB. Circulation and storage areas should not be used for groups or gatherings.
	Category B This space should be occupied at 1 person per 4m ² to comply with COVID safe school operations and the guided use of spaces . The report details the number of people who can be accommodated safely in each of the identified spaces.

Entity Location	Audit Condition Classification (Capacity)	Comment
B00A - R0001 - Home Base - (53.8 SQM) - Teaching Space: 1	● Student Space (24)	
B00A - R0002 - Home Base - (53.8 SQM) - Teaching Space: 1	● Student Space (24)	
B00A - R0003 - Reading Area - (108.17 SQM)	● Student Space (50)	
B00A - R0004 - Staff Room Annexe - (22.38 SQM)	● Office (5)	
B00A - R0005 - Home Base - (53.65 SQM) - Teaching Space: 1	● Student Space (24)	
B00A - R0007 - Withdrawal Space - 1hb - (33.4 SQM)	● Student Space (15)	
B00A - R0008 - Movement - (9.49 SQM)	Not Applicable	Circulation or storage space.
B00A - R0011 - Duplicating Workroom - (14.96 SQM)	● Office (3)	
B00A - R0012 - Movement - (13.96 SQM)	Not Applicable	Circulation or storage space.
B00B - R0001 - Raised Platform - (20.18 SQM)	Not Applicable	Circulation or storage space.
B00B - R0008 - Canteen - (12.92 SQM)	Not Applicable	Circulation or storage space.
B00B - R0009 - Movement - (5.24 SQM)	Not Applicable	Circulation or storage space.
B00B - R1001 - Home Base - (53.81 SQM) - Teaching Space: 1	● Student Space (24)	
B00B - R1002 - Home Base - (53.8 SQM) - Teaching Space: 1	● Student Space (24)	
B00B - R1005 - Movement - (25.4 SQM)	Not Applicable	Circulation or storage space.
B00C - R0003 - Practical Activities - 1hb - (41.4 SQM)	● Student Space (19)	
B00C - R0004 - Home Base - (47.31 SQM) - Teaching Space: 1	● Student Space (21)	
B00C - R0005 - Withdrawal Space - 1hb - (8.96 SQM)	● Student Space (4)	
B00C - R0006 - Home Base - (42.39 SQM) - Teaching Space: 1	● Student Space (19)	
B00C - R0007 - Movement - (21.3 SQM)	Not Applicable	Circulation or storage space.
B00C - R0010 - Movement - (8.38 SQM)	Not Applicable	Circulation or storage space.
B00D - R0001 - Home Base - (52.77 SQM) - Teaching Space: 1	● Student Space (24)	
B00D - R0002 - Home Base - (52.69 SQM) - Teaching Space: 1	● Student Space (24)	
B00K - R0001 - Communal Space - (237.97 SQM)	● Student Space (110)	
B00L - R0002 - Movement - (5.14 SQM)	Not Applicable	Circulation or storage space.
B00L - R0003 - Movement - (11.8 SQM)	Not Applicable	Circulation or storage space.
B00L - R0006 - Clerical Office - (12.76 SQM)	● Office (3)	
B00L - R0009 - Clerical Office - (16.78 SQM)	● Office (4)	
OS 502 15161 - OS 502 15161 - Admin Staff/Principal/Clerk/Dup/Clinic - (152 SQM)	● Office (38)	