

VENTILATION AUDIT REPORT

SCHOOL:	Parramatta High School (8135)
AMU REGION:	Western Sydney
STATE ELECTORATE:	Parramatta
LOCAL GOVERNMENT AREA:	Parramatta

8135 - Parramatta High School
Site Plan (12035)

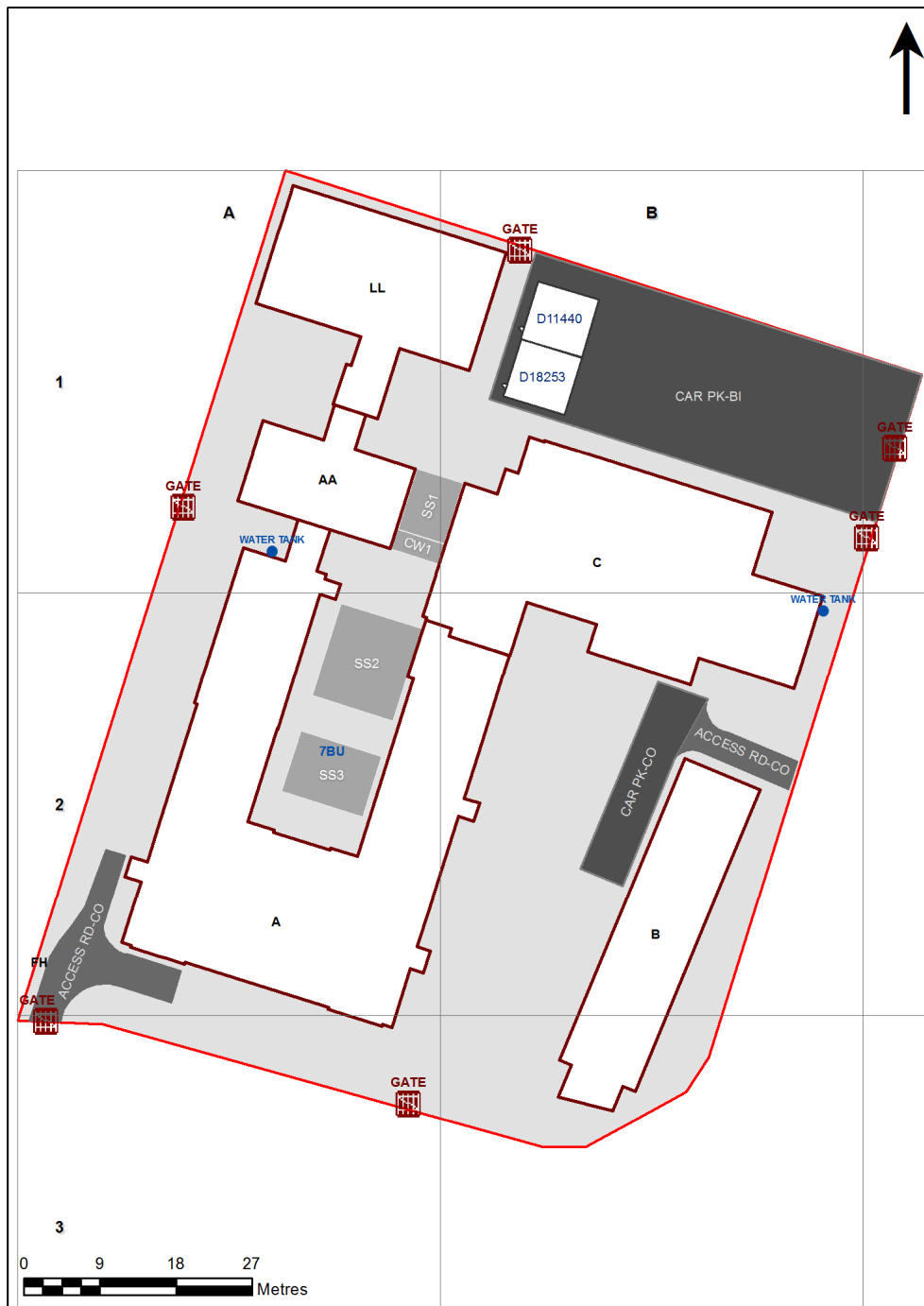

1:561

Printed: 31-Mar-2021

Ventilation Audit Key

Category	Description
	Category A Operate this space in line with COVID safe school operations . It has the required level of natural ventilation. NB. Circulation and storage areas should not be used for groups or gatherings.
	Category B This space should be occupied at 1 person per 4m ² to comply with COVID safe school operations and the guided use of spaces . The report details the number of people who can be accommodated safely in each of the identified spaces.

Entity Location	Audit Condition Classification (Capacity)	Comment
B00A - R0001 - General Learning Space - (79.72 SQM) - Teaching Space: 1	● Student Space (36)	
B00A - R0003 - Staff Study - (16.77 SQM)	● Office (4)	
B00A - R0004 - General Learning Space - (51.22 SQM) - Teaching Space: 1	● Student Space (23)	
B00A - R0005 - General Learning Space - (48.23 SQM) - Teaching Space: 1	● Student Space (22)	
B00A - R0006 - Movement - (74.76 SQM)	Not Applicable	Circulation or storage space.
B00A - R0007 - Interview/Office - Type 1 - (10.37 SQM)	● Office (2)	
B00A - R0012 - General Learning Space - (53.7 SQM)	● Student Space (24)	
B00A - R0013 - Movement - (22.23 SQM)	Not Applicable	Circulation or storage space.
B00A - R0015 - Commonroom - (74.34 SQM)	● Office (18)	
B00A - R0016 - Administration - Clerical - (26.33 SQM)	● Office (6)	
B00A - R0017 - Administration - Clerical - (27.04 SQM)	● Office (6)	
B00A - R0018 - Duplicating Workroom - (26.21 SQM)	● Office (6)	
B00A - R0019 - Movement - (80.57 SQM)	Not Applicable	Circulation or storage space.
B00A - R0022 - General Learning Space - (52.43 SQM) - Teaching Space: 1	● Student Space (24)	
B00A - R0023 - Food Technology L.S. - (52.93 SQM) - Teaching Space: 1	● Student Space (24)	
B00A - R0028 - Movement - (46.45 SQM)	Not Applicable	Circulation or storage space.
B00A - R0030 - Clinic - Boys - (11.45 SQM)	● Office (2)	
B00A - R0033 - Deputy Principal Office - (19.97 SQM)	● Office (4)	
B00A - R0034 - Principal Office - (19.55 SQM)	● Office (4)	
B00A - R0042 - Food Technology L.S. - (87.1 SQM) - Teaching Space: 1	● Student Space (40)	
B00A - R1002 - Movement - (6.33 SQM)	Not Applicable	Circulation or storage space.
B00A - R1003 - Movement - (5.76 SQM)	Not Applicable	Circulation or storage space.
B00A - R1004 - Staff Study - (24.39 SQM)	● Office (6)	
B00A - R1005 - Staff Study - (10.9 SQM)	● Office (2)	
B00A - R1006 - Staff Study - (10.9 SQM)	● Office (2)	
B00A - R1007 - Staff Study - (86.08 SQM)	● Office (21)	
B00A - R1008 - Movement - (44.01 SQM)	Not Applicable	Circulation or storage space.
B00A - R1009 - General Learning Space - (52.93 SQM) - Teaching Space: 1	● Student Space (24)	
B00A - R1010 - General Learning Space - (53.23 SQM) - Teaching Space: 1	● Student Space (24)	
B00A - R1015 - General Learning Space - (40.16 SQM) - Teaching Space: 1	● Student Space (18)	
B00A - R1016 - Seminar - Type 1 - (21.94 SQM)	● Office (5)	
B00A - R1017 - General Learning Space - (54.9 SQM) - Teaching Space: 1	● Student Space (25)	
B00A - R1018 - Seminar - Type 1 - (24.38 SQM)	● Office (6)	
B00A - R1020 - General Learning Space - (74.62 SQM) - Teaching Space: 1	● Student Space (34)	
B00A - R1021 - Design L.S. - (54 SQM) - Teaching Space: 1	● Student Space (25)	
B00A - R1024 - Movement - (69.25 SQM)	Not Applicable	Circulation or storage space.
B00A - R1026 - General Learning Space - (48.77 SQM) - Teaching Space: 1	● Student Space (22)	
B00A - R1027 - General Learning Space - (52.41 SQM) - Teaching Space: 1	● Student Space (24)	
B00A - R1028 - General Learning Space - (52.13 SQM) - Teaching Space: 1	● Student Space (24)	
B00A - R1029 - General Learning Space - (52.19 SQM) - Teaching Space: 1	● Student Space (24)	
B00A - R1030 - Movement - (68.84 SQM)	Not Applicable	Circulation or storage space.
B00A - R9004 - Seminar - (9.51 SQM)	● Office (2)	
B00A - R9008 - General Assistants - (52.42 SQM)	● Office (13)	
B00A - R9010 - Laboratory L.S. - (77.86 SQM) - Teaching Space: 1	● Student Space (36)	
B00A - R9011 - Preparation - (25.16 SQM)	Not Applicable	Circulation or storage space.
B00A - R9015 - Movement - (25.32 SQM)	Not Applicable	Circulation or storage space.
B00A - R9018 - Movement - (6.51 SQM)	Not Applicable	Circulation or storage space.
B00A - R9021 - Commonroom - (24.57 SQM)	● Office (6)	

Entity Location	Audit Condition Classification (Capacity)	Comment
B00B - R0002 - Materials Technology L.S. - (53.07 SQM) - Teaching Space: 1	● Student Space (24)	
B00B - R0005 - Materials Technology L.S. - (88.26 SQM) - Teaching Space: 1	● Student Space (40)	
B00B - R0007 - Staff Study - (17.74 SQM)	○ Office (4)	
B00B - R0008 - Movement - (31.64 SQM)	Not Applicable	Circulation or storage space.
B00B - R0009 - Materials Technology L.S. - (76.63 SQM) - Teaching Space: 1	● Student Space (35)	
B00B - R0011 - Welding Area - (10.98 SQM)	Not Applicable	Circulation or storage space.
B00B - R9001 - Art Learning Space - (52.2 SQM) - Teaching Space: 1	● Student Space (24)	
B00B - R9003 - Movement - (7.62 SQM)	Not Applicable	Circulation or storage space.
B00B - R9004 - Art Learning Space - (66.02 SQM) - Teaching Space: 1	● Student Space (30)	
B00C - R0001 - Music Learning Space - (64.99 SQM) - Teaching Space: 1	● Student Space (30)	
B00C - R0005 - Art Learning Space - (29.98 SQM)	● Student Space (13)	
B00C - R0007 - Darkroom Space - (9.24 SQM)	○ Office (2)	
B00C - R0011 - Movement - (14.15 SQM)	Not Applicable	Circulation or storage space.
B00C - R0012 - Movement - (9.84 SQM)	Not Applicable	Circulation or storage space.
B00C - R0014 - Music Learning Space - (65.9 SQM) - Teaching Space: 1	● Student Space (30)	
B00C - R1001 - Movement - (7.14 SQM)	Not Applicable	Circulation or storage space.
B00C - R1004 - Movement - (51.87 SQM)	Not Applicable	Circulation or storage space.
B00C - R1005 - General Learning Space - (51.47 SQM) - Teaching Space: 1	● Student Space (23)	
B00C - R1008 - Student Canteen - (63.38 SQM)	Not Applicable	Circulation or storage space.
B00C - R1019 - Movement - (10.97 SQM)	Not Applicable	Circulation or storage space.
B00C - R1020 - Movement - (9.74 SQM)	Not Applicable	Circulation or storage space.
B00C - R1022 - General Learning Space - (41.07 SQM) - Teaching Space: 1	● Student Space (19)	
B00C - R1032 - General Learning Space - (59.86 SQM) - Teaching Space: 1	● Student Space (27)	
B00C - R1033 - Movement - (11.95 SQM)	Not Applicable	Circulation or storage space.
B00C - R1038 - Movement - (233.47 SQM)	Not Applicable	Circulation or storage space.
B00C - R2001 - Movement - (12.56 SQM)	Not Applicable	Circulation or storage space.
B00C - R2002 - Stage - (121.13 SQM)	Not Applicable	Circulation or storage space.
B00C - R2003 - Multi-Purpose Space - (358.79 SQM)	● Student Space (166)	
B00C - R2004 - General Learning Space - (51.84 SQM) - Teaching Space: 1	● Student Space (24)	
B00C - R2005 - Movement - (7.9 SQM)	Not Applicable	Circulation or storage space.
B00C - R2007 - Movement - (31.89 SQM)	Not Applicable	Circulation or storage space.
B00C - R2008 - Interview/Office - Type 1 - (10.3 SQM)	○ Office (2)	
B00C - R2009 - Interview/Office - Type 1 - (8.56 SQM)	○ Office (2)	
B00C - R2011 - Movement - (14.2 SQM)	Not Applicable	Circulation or storage space.
B00C - R2021 - General Learning Space - (44.15 SQM) - Teaching Space: 1	● Student Space (20)	
B00C - R2022 - General Learning Space - (33.78 SQM) - Teaching Space: 1	● Student Space (15)	
B00C - R2023 - Movement - (9.51 SQM)	Not Applicable	Circulation or storage space.
B00C - R3002 - General Learning Space - (53.58 SQM) - Teaching Space: 1	● Student Space (24)	
B00C - R3003 - Movement - (9.88 SQM)	Not Applicable	Circulation or storage space.
B00C - R3004 - General Learning Space - (53.61 SQM) - Teaching Space: 1	● Student Space (24)	
B0AA - R0001 - General Learning Space - (52.85 SQM) - Teaching Space: 1	● Student Space (24)	
B0AA - R0003 - General Learning Space - (52.92 SQM) - Teaching Space: 1	● Student Space (24)	
B0AA - R0005 - Movement - (51.86 SQM)	Not Applicable	Circulation or storage space.
B0AA - R0006 - Movement - (14.55 SQM)	Not Applicable	Circulation or storage space.
B0AA - R1001 - Interview/Office - Type 1 - (19.82 SQM)	○ Office (4)	
B0AA - R1002 - Staff Study - (13.1 SQM)	○ Office (3)	
B0AA - R1003 - Staff Study - (79.53 SQM)	○ Office (19)	
B0AA - R1004 - Movement - (15.38 SQM)	Not Applicable	Circulation or storage space.
B0AA - R1005 - Staff Study - (24.08 SQM)	○ Office (6)	
B0AA - R1006 - Staff Study - (13.1 SQM)	○ Office (3)	
B0AA - R8001 - Movement - (13.41 SQM)	Not Applicable	Circulation or storage space.

Entity Location	Audit Condition Classification (Capacity)	Comment
B0AA - R8002 - General Learning Space - (43.18 SQM) - Teaching Space: 1	● Student Space (20)	
B0AA - R8003 - General Learning Space - (47.6 SQM) - Teaching Space: 1	● Student Space (22)	
B0AA - R9001 - General Learning Space - (53 SQM) - Teaching Space: 1	● Student Space (24)	
B0AA - R9002 - General Learning Space - (52.92 SQM) - Teaching Space: 1	● Student Space (24)	
B0AA - R9004 - Movement - (39.21 SQM)	Not Applicable	Circulation or storage space.
B0AA - R9006 - Movement - (14.55 SQM)	Not Applicable	Circulation or storage space.
B0LL - R0001 - Laboratory L.S. - (90.89 SQM) - Teaching Space: 1	● Student Space (42)	
B0LL - R0002 - Preparation - (47.51 SQM)	Not Applicable	Circulation or storage space.
B0LL - R0013 - Movement - (25.7 SQM)	Not Applicable	Circulation or storage space.
B0LL - R0014 - Movement - (17.44 SQM)	Not Applicable	Circulation or storage space.
B0LL - R0017 - Laboratory L.S. - (90.59 SQM) - Teaching Space: 1	● Student Space (42)	
B0LL - R1001 - Laboratory L.S. - (90.89 SQM) - Teaching Space: 1	● Student Space (42)	
B0LL - R1002 - Preparation - (46.81 SQM)	Not Applicable	Circulation or storage space.
B0LL - R1005 - Staff Study - (29.95 SQM)	● Office (7)	
B0LL - R1011 - Staff Study - (16.38 SQM)	● Office (4)	
B0LL - R1012 - Movement - (33.32 SQM)	Not Applicable	Circulation or storage space.
B0LL - R1013 - Movement - (17.44 SQM)	Not Applicable	Circulation or storage space.
B0LL - R1015 - Laboratory L.S. - (90.78 SQM) - Teaching Space: 1	● Student Space (42)	
B0LL - R2001 - Main Area - (246.71 SQM)	Not Applicable	Circulation or storage space.
B0LL - R2002 - Audio Visual Workroom - (17.64 SQM)	● Student Space (8)	
B0LL - R2004 - Workroom - (21.74 SQM)	● Office (5)	
B0LL - R2010 - Seminar - (13.11 SQM)	● Office (3)	
B0LL - R2011 - Seminar - (12.82 SQM)	● Office (3)	
B0LL - R2013 - Movement - (17.44 SQM)	Not Applicable	Circulation or storage space.
OS 600 11440 - OS 600 11440 - Learning Unit - Small - (57 SQM)	● Student Space (26)	
OS 600 18253 - OS 600 18253 - Learning Unit - Small - (57 SQM)	● Student Space (26)	