

VENTILATION AUDIT REPORT

SCHOOL:	Oxley Vale Public School (3690)
AMU REGION:	North Western NSW
STATE ELECTORATE:	Tamworth
LOCAL GOVERNMENT AREA:	Tamworth

3690 - Oxley Vale Public School
Site Plan (10528)

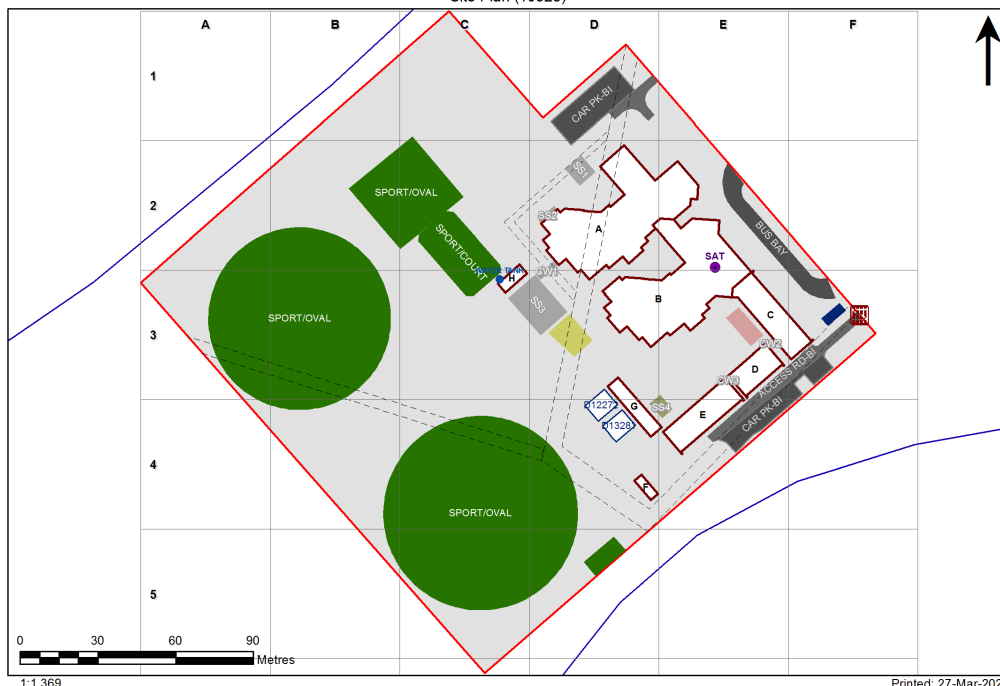

1:1,369

Printed: 27-Mar-2021

Ventilation Audit Key

Category	Description
	Category A Operate this space in line with COVID safe school operations . It has the required level of natural ventilation. NB. Circulation and storage areas should not be used for groups or gatherings.
	Category B This space should be occupied at 1 person per 4m ² to comply with COVID safe school operations and the guided use of spaces . The report details the number of people who can be accommodated safely in each of the identified spaces.

Entity Location	Audit Condition Classification (Capacity)	Comment
B00A - R0001 - Raised Platform - (55.89 SQM)	Not Applicable	Circulation or storage space.
B00A - R0002 - Communal Space - (218.32 SQM)	● Student Space (101)	
B00A - R0005 - Special Programs Room - (57.86 SQM)	● Student Space (26)	
B00A - R0006 - Movement - (7.21 SQM)	Not Applicable	Circulation or storage space.
B00A - R0008 - Withdrawal Space - 1hb - (12.18 SQM)	● Student Space (5)	
B00A - R0009 - Movement - (10.9 SQM)	Not Applicable	Circulation or storage space.
B00A - R0010 - Home Base - (65.9 SQM) - Teaching Space: 1	● Student Space (30)	
B00A - R0013 - Movement - (10.69 SQM)	Not Applicable	Circulation or storage space.
B00A - R0014 - Home Base - (58.84 SQM) - Teaching Space: 1	● Student Space (27)	
B00A - R0016 - Withdrawal Space - 1hb - (16.41 SQM)	● Student Space (7)	
B00A - R0017 - Home Base - (58.76 SQM) - Teaching Space: 1	● Student Space (27)	
B00A - R0018 - Movement - (10.62 SQM)	Not Applicable	Circulation or storage space.
B00A - R0021 - Home Base - (58.85 SQM) - Teaching Space: 1	● Student Space (27)	
B00A - R0022 - Movement - (10.92 SQM)	Not Applicable	Circulation or storage space.
B00A - R0024 - Withdrawal Space - 1hb - (12.18 SQM)	● Student Space (5)	
B00A - R0025 - Home Base - (58.85 SQM) - Teaching Space: 1	● Student Space (27)	
B00A - R0026 - Movement - (12.78 SQM)	Not Applicable	Circulation or storage space.
B00A - R0028 - Movement - (14.33 SQM)	Not Applicable	Circulation or storage space.
B00A - R0029 - Practical Activities - 1hb - (66.91 SQM)	● Student Space (31)	
B00A - R0032 - Withdrawal Space - 1hb - (15.63 SQM)	● Student Space (7)	
B00A - R0033 - Movement - (15.66 SQM)	Not Applicable	Circulation or storage space.
B00A - R0034 - Practical Activities - 1hb - (71.24 SQM)	● Student Space (33)	
B00A - R0040 - Canteen - (40.49 SQM)	Not Applicable	Circulation or storage space.
B00A - R0044 - Movement - (50.83 SQM)	Not Applicable	Circulation or storage space.
B00A - R0046 - Movement - (125.56 SQM)	Not Applicable	Circulation or storage space.
B00B - R0001 - Movement - (20.32 SQM)	Not Applicable	Circulation or storage space.
B00B - R0003 - Special Programs Room - (35.82 SQM)	● Student Space (16)	
B00B - R0006 - Reading Area - (226.94 SQM)	● Student Space (105)	
B00B - R0007 - Seminar/Study - (14.24 SQM)	● Office (3)	
B00B - R0008 - Seminar/Study - (14.24 SQM)	● Office (3)	
B00B - R0010 - Home Base - (58.06 SQM) - Teaching Space: 1	● Student Space (26)	
B00B - R0011 - Movement - (7.08 SQM)	Not Applicable	Circulation or storage space.
B00B - R0013 - Withdrawal Space - 1hb - (12.11 SQM)	● Student Space (5)	
B00B - R0014 - Movement - (10.92 SQM)	Not Applicable	Circulation or storage space.
B00B - R0015 - Home Base - (65.7 SQM) - Teaching Space: 1	● Student Space (30)	
B00B - R0018 - Movement - (10.69 SQM)	Not Applicable	Circulation or storage space.
B00B - R0019 - Home Base - (58.85 SQM) - Teaching Space: 1	● Student Space (27)	
B00B - R0021 - Withdrawal Space - 1hb - (16.62 SQM)	● Student Space (7)	
B00B - R0022 - Home Base - (58.85 SQM) - Teaching Space: 1	● Student Space (27)	
B00B - R0025 - Movement - (10.7 SQM)	Not Applicable	Circulation or storage space.
B00B - R0026 - Home Base - (58.85 SQM) - Teaching Space: 1	● Student Space (27)	
B00B - R0027 - Movement - (10.7 SQM)	Not Applicable	Circulation or storage space.
B00B - R0029 - Withdrawal Space - 1hb - (12.18 SQM)	● Student Space (5)	
B00B - R0030 - Home Base - (58.85 SQM) - Teaching Space: 1	● Student Space (27)	
B00B - R0031 - Movement - (12.78 SQM)	Not Applicable	Circulation or storage space.
B00B - R0033 - Movement - (14.12 SQM)	Not Applicable	Circulation or storage space.
B00B - R0034 - Practical Activities - 1hb - (64.5 SQM)	● Student Space (29)	
B00B - R0037 - Staff Room Annexe - (15.7 SQM)	● Office (3)	
B00B - R0038 - Movement - (15.63 SQM)	Not Applicable	Circulation or storage space.
B00B - R0039 - Practical Activities - 1hb - (69.58 SQM)	● Student Space (32)	

Entity Location	Audit Condition Classification (Capacity)	Comment
B00B - R0043 - Movement - (151.24 SQM)	Not Applicable	Circulation or storage space.
B00B - R0044 - Movement - (17.37 SQM)	Not Applicable	Circulation or storage space.
B00C - R0006 - Sick Bay - (12.28 SQM)	● Student Space (5)	
B00C - R0011 - Interview - (19.37 SQM)	● Office (4)	
B00C - R0014 - Staff Room Annexe - (15.81 SQM)	● Office (3)	
B00C - R0015 - Interview - (13.32 SQM)	● Office (3)	
B00C - R0016 - Principal - (21.86 SQM)	● Office (5)	
B00C - R0019 - Movement - (67.49 SQM)	Not Applicable	Circulation or storage space.
B00C - R0020 - Clerical Office - (35.95 SQM)	● Office (8)	
B00C - R0021 - Clerical Office/Workroom - (11.4 SQM)	● Office (2)	
B00C - R0022 - Interview - (6.39 SQM)	● Office (1)	
B00C - R0023 - Entry Vestibule - (40.32 SQM)	Not Applicable	Circulation or storage space.
B00C - R0024 - Movement - (9.82 SQM)	Not Applicable	Circulation or storage space.
B00C - R0025 - Movement - (21.26 SQM)	Not Applicable	Circulation or storage space.
B00D - R0001 - Movement - (32.36 SQM)	Not Applicable	Circulation or storage space.
B00D - R0002 - Staff Room - (79.87 SQM)	● Office (19)	
B00D - R0006 - Movement - (9.41 SQM)	Not Applicable	Circulation or storage space.
B00E - R0001 - Movement - (48.28 SQM)	Not Applicable	Circulation or storage space.
B00E - R0005 - Home Base - (84.06 SQM) - Teaching Space: 1	● Student Space (39)	
B00E - R0006 - Home Base - (56.09 SQM) - Teaching Space: 1	● Student Space (26)	
B00E - R0009 - Movement - (6.9 SQM)	Not Applicable	Circulation or storage space.
B00E - R0010 - Home Base - M - (57.04 SQM) - Teaching Space: 1	● Student Space (26)	
OS 602 13281 - OS 602 13281 - Learning Unit - Standard With P.A.A. - (76 SQM)	● Student Space (35)	
OS 603 12272 - OS 603 12272 - Learning Unit - Standard With P.A.A. A/C - (76 SQM)	● Student Space (35)	