

# VENTILATION AUDIT REPORT

<b>SCHOOL:</b>	<b>Orange High School (8134)</b>
<b>AMU REGION:</b>	<b>North Western NSW</b>
<b>STATE ELECTORATE:</b>	<b>Orange</b>
<b>LOCAL GOVERNMENT AREA:</b>	<b>Orange</b>

8134 - Orange High School  
Site Plan (12741)

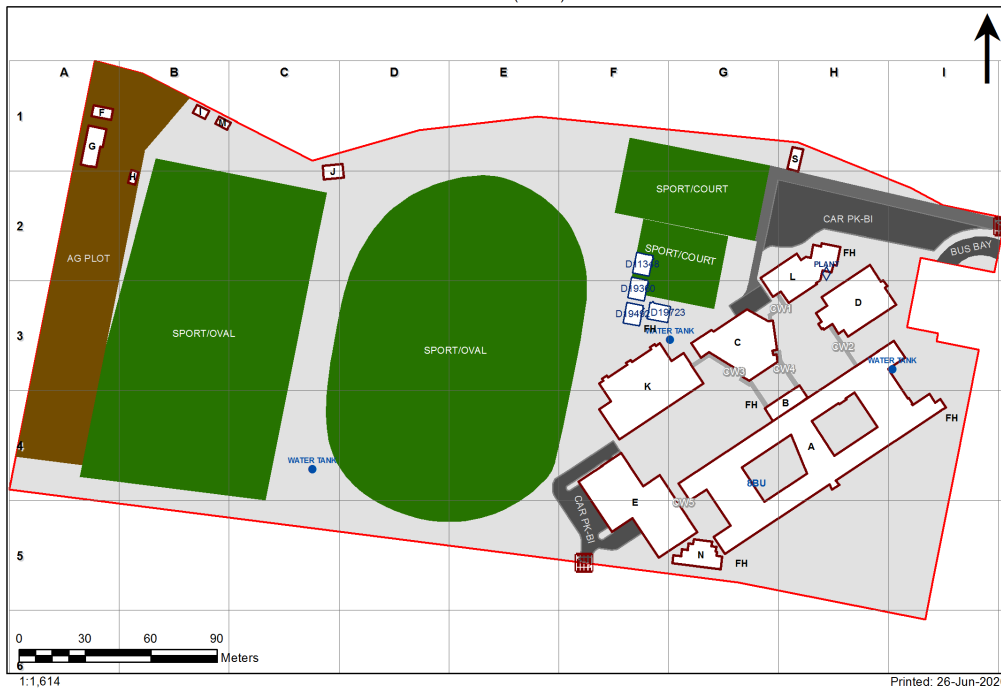

1:1,614

Printed: 26-Jun-2020

## Ventilation Audit Key

Category	Description
	Category A Operate this space in line with <a href="#">COVID safe school operations</a> . It has the required level of natural ventilation. NB. Circulation and storage areas should not be used for groups or gatherings.
	Category B This space should be occupied at 1 person per 4m <sup>2</sup> to comply with <a href="#">COVID safe school operations and the guided use of spaces</a> . The report details the number of people who can be accommodated safely in each of the identified spaces.

Entity Location	Audit Condition Classification (Capacity)	Comment
B00A - R0001 - Public Entry - (13.34 SQM)	Not Applicable	Circulation or storage space.
B00A - R0002 - Interview/Office - Type 1 - (13.2 SQM)	Office (3)	
B00A - R0003 - Principal Office - (23.77 SQM)	Office (5)	
B00A - R0004 - Staff Study - (13.39 SQM)	Office (3)	
B00A - R0005 - Clinic - Boys - (9.45 SQM)	Office (2)	
B00A - R0008 - Clinic - Girls - (9.45 SQM)	Office (2)	
B00A - R0011 - Seminar - (16.25 SQM)	Office (4)	
B00A - R0012 - Seminar - (15.72 SQM)	Office (3)	
B00A - R0013 - Staff Study - (15.01 SQM)	Office (3)	
B00A - R0016 - Staff Study - (12.54 SQM)	Office (3)	
B00A - R0017 - Staff Study - (12.54 SQM)	Office (3)	
B00A - R0020 - Leading Teacher - (19.11 SQM)	Office (4)	
B00A - R0021 - Movement - (24.11 SQM)	Not Applicable	Circulation or storage space.
B00A - R0022 - Commonroom - (104.18 SQM)	Office (26)	
B00A - R0025 - Senior Study - (64.84 SQM)	Office (16)	
B00A - R0026 - Senior Seminar - (12.33 SQM)	Office (3)	
B00A - R0029 - Movement - (25.11 SQM)	Not Applicable	Circulation or storage space.
B00A - R0049 - Staff Study - (26.18 SQM)	Office (6)	
B00A - R0056 - Movement - (161.56 SQM)	Not Applicable	Circulation or storage space.
B00A - R0071 - Duplicating Workroom - (25.15 SQM)	Office (6)	
B00A - R0072 - Administration - Clerical - (63.78 SQM)	Office (15)	
B00A - R0073 - Movement - (18.79 SQM)	Not Applicable	Circulation or storage space.
B00A - R0074 - Deputy Principal Office - (15.82 SQM)	Office (3)	
B00A - R0075 - Interview/Office - Type 1 - (6.83 SQM)	Office (1)	
B00A - R0082 - Staff Study - (12.26 SQM)	Office (3)	
B00A - R0083 - Movement - (21.63 SQM)	Not Applicable	Circulation or storage space.
B00A - R0085 - Darkroom Space - (31.12 SQM)	Office (7)	
B00A - R0088 - Art Learning Space - (64.57 SQM) - Teaching Space: 1	Student Space (29)	
B00A - R0089 - Art Learning Space - (64.86 SQM) - Teaching Space: 1	Student Space (30)	
B00A - R0091 - Art Learning Space - (64.17 SQM) - Teaching Space: 1	Student Space (29)	
B00A - R0097 - Workshop - (47.05 SQM)	Student Space (21)	
B00A - R0098 - Art Learning Space - (59.66 SQM) - Teaching Space: 1	Student Space (27)	
B00A - R0099 - Design/Technology L.S. - (77.73 SQM) - Teaching Space: 1	Student Space (36)	
B00A - R0100 - Staff Study - (52.15 SQM)	Office (13)	
B00A - R0103 - Design L.S. - (78.42 SQM) - Teaching Space: 1	Student Space (36)	
B00A - R0104 - Movement - (232.19 SQM)	Not Applicable	Circulation or storage space.
B00A - R0105 - Staff Study - (25.61 SQM)	Office (6)	
B00A - R0106 - Laboratory L.S. - (78.34 SQM) - Teaching Space: 1	Student Space (36)	
B00A - R0107 - Movement - (34.79 SQM)	Not Applicable	Circulation or storage space.
B00A - R0108 - Movement - (16.64 SQM)	Not Applicable	Circulation or storage space.
B00A - R0109 - Movement - (18.86 SQM)	Not Applicable	Circulation or storage space.
B00A - R0110 - General Learning Space - (51.94 SQM) - Teaching Space: 1	Student Space (24)	
B00A - R0111 - General Learning Space - (60.22 SQM) - Teaching Space: 1	Student Space (27)	
B00A - R0113 - Staff Study - (43.71 SQM)	Office (10)	
B00A - R0114 - General Learning Space - (56.18 SQM) - Teaching Space: 1	Student Space (26)	
B00A - R0115 - Laboratory L.S. - (91.67 SQM) - Teaching Space: 1	Student Space (42)	
B00A - R0116 - Preparation - (30.55 SQM)	Not Applicable	Circulation or storage space.
B00A - R0117 - Laboratory L.S. - (79.75 SQM) - Teaching Space: 1	Student Space (37)	
B00A - R0118 - Movement - (79.76 SQM)	Not Applicable	Circulation or storage space.

Entity Location	Audit Condition Classification (Capacity)	Comment
B00A - R0119 - Movement - (79.23 SQM)	Not Applicable	Circulation or storage space.
B00A - R0121 - Movement - (92 SQM)	Not Applicable	Circulation or storage space.
B00A - R0124 - Movement - (193.54 SQM)	Not Applicable	Circulation or storage space.
B00A - R0127 - Movement - (32.19 SQM)	Not Applicable	Circulation or storage space.
B00A - R1001 - General Learning Space - (82.85 SQM) - Teaching Space: 1	● Student Space (38)	
B00A - R1006 - Staff Study - (51.51 SQM)	● Office (12)	
B00A - R1007 - General Learning Space - (57.85 SQM) - Teaching Space: 1	● Student Space (26)	
B00A - R1008 - Movement - (81.38 SQM)	Not Applicable	Circulation or storage space.
B00A - R1010 - Computer Learning Space - (66.24 SQM) - Teaching Space: 1	● Student Space (30)	
B00A - R1011 - General Learning Space - (65.48 SQM) - Teaching Space: 1	● Student Space (30)	
B00A - R1012 - General Learning Space - (65.48 SQM) - Teaching Space: 1	● Student Space (30)	
B00A - R1013 - General Learning Space - (65.48 SQM) - Teaching Space: 1	● Student Space (30)	
B00A - R1014 - Movement - (49.12 SQM)	Not Applicable	Circulation or storage space.
B00A - R1016 - General Learning Space - (65.51 SQM) - Teaching Space: 1	● Student Space (30)	
B00A - R1017 - General Learning Space - (65.66 SQM) - Teaching Space: 1	● Student Space (30)	
B00A - R1018 - General Learning Space - (65.2 SQM) - Teaching Space: 1	● Student Space (30)	
B00A - R1019 - General Learning Space - (65.05 SQM) - Teaching Space: 1	● Student Space (30)	
B00A - R1020 - Movement - (62.74 SQM)	Not Applicable	Circulation or storage space.
B00A - R1021 - Movement - (13.08 SQM)	Not Applicable	Circulation or storage space.
B00A - R1022 - General Learning Space - (65.66 SQM) - Teaching Space: 1	● Student Space (30)	
B00A - R1023 - General Learning Space - (65.65 SQM) - Teaching Space: 1	● Student Space (30)	
B00A - R1024 - General Learning Space - (52.22 SQM) - Teaching Space: 1	● Student Space (24)	
B00A - R1025 - General Learning Space - (66.38 SQM) - Teaching Space: 1	● Student Space (30)	
B00A - R1027 - Movement - (48.72 SQM)	Not Applicable	Circulation or storage space.
B00A - R1032 - Staff Study - (6.04 SQM)	● Office (1)	
B00A - R1036 - Movement - (76.72 SQM)	Not Applicable	Circulation or storage space.
B00A - R1037 - Staff Study - (32 SQM)	● Office (8)	
B00A - R1038 - Staff Study - (22.74 SQM)	● Office (5)	
B00A - R1040 - Movement - (13.78 SQM)	Not Applicable	Circulation or storage space.
B00A - R1041 - Interview/Office - Type 1 - (9.47 SQM)	● Office (2)	
B00A - R1044 - General Learning Space - (58.87 SQM) - Teaching Space: 1	● Student Space (27)	
B00A - R1045 - General Learning Space - (65.16 SQM) - Teaching Space: 1	● Student Space (30)	
B00A - R1048 - General Learning Space - (52.38 SQM) - Teaching Space: 1	● Student Space (24)	
B00A - R1049 - General Learning Space - (52.38 SQM) - Teaching Space: 1	● Student Space (24)	
B00A - R1050 - General Learning Space - (52.08 SQM) - Teaching Space: 1	● Student Space (24)	
B00A - R1051 - General Learning Space - (52.09 SQM) - Teaching Space: 1	● Student Space (24)	
B00A - R1052 - General Learning Space - (52.09 SQM) - Teaching Space: 1	● Student Space (24)	
B00A - R1056 - General Learning Space - (52.16 SQM) - Teaching Space: 1	● Student Space (24)	
B00A - R1058 - General Learning Space - (51.87 SQM) - Teaching Space: 1	● Student Space (24)	
B00A - R1063 - Staff Study - (25.68 SQM)	● Office (6)	
B00A - R1064 - Staff Study - (38.62 SQM)	● Office (9)	
B00A - R1066 - Interview/Office - Type 1 - (19.45 SQM)	● Office (4)	
B00A - R1067 - General Learning Space - (57.79 SQM) - Teaching Space: 1	● Student Space (26)	
B00A - R1068 - General Learning Space - (52.45 SQM) - Teaching Space: 1	● Student Space (24)	
B00A - R1069 - Movement - (35.71 SQM)	Not Applicable	Circulation or storage space.
B00A - R1070 - Movement - (51.94 SQM)	Not Applicable	Circulation or storage space.
B00A - R1071 - General Learning Space - (55.75 SQM) - Teaching Space: 1	● Student Space (25)	
B00A - R1072 - Computer Learning Space - (64.86 SQM) - Teaching Space: 1	● Student Space (30)	

Entity Location	Audit Condition Classification (Capacity)	Comment
B00A - R1075 - Movement - (86.96 SQM)	Not Applicable	Circulation or storage space.
B00A - R1076 - General Learning Space - (51.8 SQM) - Teaching Space: 1	● Student Space (24)	
B00A - R1077 - General Learning Space - (52.09 SQM) - Teaching Space: 1	● Student Space (24)	
B00A - R1079 - Movement - (25.61 SQM)	Not Applicable	Circulation or storage space.
B00A - R1081 - Interview/Office - Type 1 - (23.08 SQM)	○ Office (5)	
B00A - R1082 - Staff Study - (50.42 SQM)	○ Office (12)	
B00A - R1083 - Staff Study - (25.65 SQM)	○ Office (6)	
B00A - R1085 - Movement - (86.27 SQM)	Not Applicable	Circulation or storage space.
B00A - R1087 - Movement - (24.29 SQM)	Not Applicable	Circulation or storage space.
B00B - R0001 - Student Canteen - (64.73 SQM)	Not Applicable	Circulation or storage space.
B00C - M0006 - Audio Visual Workroom - (7.32 SQM)	● Student Space (3)	
B00C - M0007 - Movement - (7.34 SQM)	Not Applicable	Circulation or storage space.
B00C - R0001 - Staff Kitchen - (22.26 SQM)	○ Office (5)	
B00C - R0008 - Stage - (103.11 SQM)	Not Applicable	Circulation or storage space.
B00C - R0009 - Movement - (10.82 SQM)	Not Applicable	Circulation or storage space.
B00D - M1001 - Seminar - (19.07 SQM)	○ Office (4)	
B00D - M1002 - Seminar - (17.89 SQM)	○ Office (4)	
B00D - M1003 - Main Area - (140.57 SQM)	Not Applicable	Circulation or storage space.
B00D - R0007 - Preparation - (48.63 SQM)	Not Applicable	Circulation or storage space.
B00D - R0009 - Movement - (39.82 SQM)	Not Applicable	Circulation or storage space.
B00D - R0017 - General Learning Space - Type 3 - (35.02 SQM) - Teaching Space: 1	● Student Space (16)	
B00D - R0018 - Science Laboratory - (55.2 SQM)	● Student Space (25)	
B00D - R0019 - General Learning Space - Type 10 - (34.9 SQM) - Teaching Space: 0.5	● Student Space (16)	
B00D - R0020 - Science Laboratory - (55.5 SQM)	● Student Space (25)	
B00D - R0021 - Preparation - (48.62 SQM)	Not Applicable	Circulation or storage space.
B00D - R0022 - General Learning Space - Type 10 - (34.99 SQM) - Teaching Space: 0.5	● Student Space (16)	
B00D - R0023 - Science Laboratory - (55.41 SQM)	● Student Space (25)	
B00D - R0024 - General Learning Space - Type 10 - (35.16 SQM) - Teaching Space: 0.5	● Student Space (16)	
B00D - R0025 - Science Laboratory - (55.24 SQM)	● Student Space (25)	
B00D - R1001 - Seminar - (13.39 SQM)	○ Office (3)	
B00D - R1002 - Seminar - (11.88 SQM)	○ Office (2)	
B00D - R1006 - Seminar - (11.55 SQM)	○ Office (2)	
B00D - R1007 - Seminar - (9.77 SQM)	○ Office (2)	
B00D - R1008 - Seminar - (13.74 SQM)	○ Office (3)	
B00D - R1010 - Audio Visual Workroom - (29.73 SQM)	● Student Space (13)	
B00D - R1012 - Workroom - (19.33 SQM)	○ Office (4)	
B00D - R1015 - Main Area - (391.86 SQM)	Not Applicable	Circulation or storage space.
B00D - R1016 - Movement - (26.86 SQM)	Not Applicable	Circulation or storage space.
B00E - R0001 - Food Technology L.S. - (74.61 SQM) - Teaching Space: 1	● Student Space (34)	
B00E - R0002 - Food/Research Space - (39.28 SQM)	Not Applicable	Circulation or storage space.
B00E - R0004 - Food Technology L.S. - (74.52 SQM) - Teaching Space: 1	● Student Space (34)	
B00E - R0005 - Food/Research Space - (39.04 SQM)	Not Applicable	Circulation or storage space.
B00E - R0006 - Movement - (16.93 SQM)	Not Applicable	Circulation or storage space.
B00E - R0007 - Movement - (68.53 SQM)	Not Applicable	Circulation or storage space.
B00E - R0008 - Study Space - (14.53 SQM)	Not Applicable	Circulation or storage space.
B00E - R0012 - Design/Technology L.S. - (99.54 SQM) - Teaching Space: 1	● Student Space (46)	
B00E - R0017 - Materials Technology L.S. - (99.75 SQM) - Teaching Space: 1	● Student Space (46)	
B00E - R0018 - Wood Technology Bay - (36.11 SQM)	Not Applicable	Circulation or storage space.
B00E - R0019 - Materials Technology L.S. - (99.45 SQM) - Teaching Space: 1	● Student Space (46)	
B00E - R0020 - Materials Technology L.S. - (60.86 SQM) - Teaching Space: 1	● Student Space (28)	

Entity Location	Audit Condition Classification (Capacity)	Comment
B00E - R0021 - Welding Area - (13.44 SQM)	Not Applicable	Circulation or storage space.
B00E - R0024 - Metal Technology Bay - (35.5 SQM)	Not Applicable	Circulation or storage space.
B00E - R0025 - Materials Technology L.S. - (90.37 SQM) - Teaching Space: 1	● Student Space (41)	
B00E - R0026 - Welding Area - (8.67 SQM)	Not Applicable	Circulation or storage space.
B00E - R0028 - Movement - (6.67 SQM)	Not Applicable	Circulation or storage space.
B00E - R0031 - General Assistants - (12.65 SQM)	● Office (3)	
B00K - R0002 - Multi-Purpose Space - (618.54 SQM)	● Student Space (286)	
B00K - R0014 - Staff Study - (30.54 SQM)	● Office (7)	
B00L - R0001 - Practice/Seminar - (25.15 SQM)	Not Applicable	Circulation or storage space.
B00L - R0002 - Music Learning Space - (60.2 SQM) - Teaching Space: 1	● Student Space (27)	
B00L - R0005 - Staff Study - (16.01 SQM)	● Office (4)	
B00L - R0008 - Movement - (33.69 SQM)	Not Applicable	Circulation or storage space.
B00L - R0011 - Music Learning Space - (79.04 SQM) - Teaching Space: 1	● Student Space (36)	
B00L - R0015 - Movement - (6.42 SQM)	Not Applicable	Circulation or storage space.
B00L - R0016 - Seminar - (23.36 SQM)	● Office (5)	
B00L - R0017 - Movement - (13.38 SQM)	Not Applicable	Circulation or storage space.
B00L - R0020 - Performance Workshop - (86.56 SQM)	● Student Space (40)	
B00N - R0001 - Food Technology L.S. - (112.56 SQM) - Teaching Space: 1	● Student Space (52)	
OS 601 11348 - OS 601 11348 - Learning Unit - Standard/Withdrawal - (76 SQM)	● Student Space (35)	
OS 601 19492 - OS 601 19492 - Learning Unit - Standard/Withdrawal - (76 SQM)	● Student Space (35)	
OS 601 19723 - OS 601 19723 - Learning Unit - Standard/Withdrawal - (76 SQM)	● Student Space (35)	
OS 602 19360 - OS 602 19360 - Learning Unit - Standard With P.A.A. - (76 SQM)	● Student Space (35)	