

VENTILATION AUDIT REPORT

SCHOOL:	Northlakes High School (8547)
AMU REGION:	Hunter/Central Coast
STATE ELECTORATE:	Swansea
LOCAL GOVERNMENT AREA:	Central Coast

8547 - Northlakes High School
Site Plan (10972)

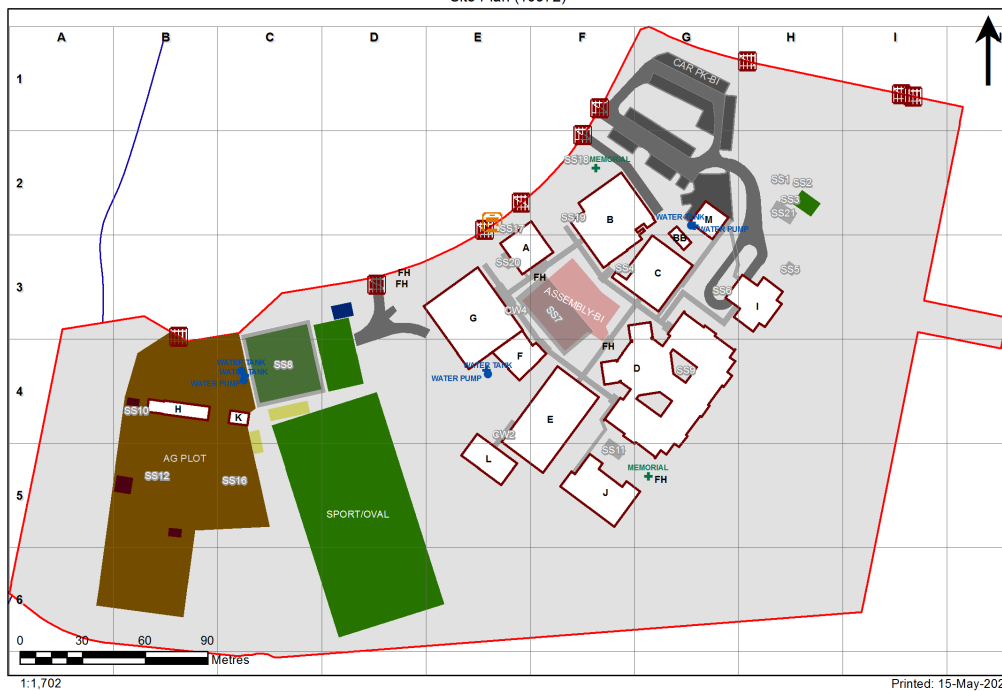

1:1,702

Printed: 15-May-2021







Ventilation Audit Key

Category	Description
	Category A Operate this space in line with COVID safe school operations . It has the required level of natural ventilation. NB. Circulation and storage areas should not be used for groups or gatherings.
	Category B This space should be occupied at 1 person per 4m ² to comply with COVID safe school operations and the guided use of spaces . The report details the number of people who can be accommodated safely in each of the identified spaces.

Entity Location	Audit Condition Classification (Capacity)	Comment
B00A - R0002 - Leading Teacher - (9.65 SQM)	Office (2)	
B00A - R0003 - Deputy Principal Office - (13.81 SQM)	Office (3)	
B00A - R0006 - Clinic - (15.22 SQM)	Office (3)	
B00A - R0007 - Deputy Principal Office - (16.08 SQM)	Office (4)	
B00A - R0014 - Principal Office - (20.05 SQM)	Office (5)	
B00A - R0022 - Public Reception - (14.87 SQM)	Not Applicable	Circulation or storage space.
B00A - R0023 - Movement - (27.27 SQM)	Not Applicable	Circulation or storage space.
B00A - R0024 - Student Reception - (21.26 SQM)	Not Applicable	Circulation or storage space.
B00A - R0026 - Administration - Clerical - (8.55 SQM)	Office (2)	
B00A - R0027 - Ancillary Staff - (15.52 SQM)	Office (3)	
B00A - R0031 - Administration - Clerical - (67.88 SQM)	Office (16)	
B00A - R0032 - Administration - Clerical - (16.96 SQM)	Office (4)	
B00B - R0002 - Metal Technology Bay - (29.59 SQM)	Not Applicable	Circulation or storage space.
B00B - R0007 - Wood Technology Bay - (29.52 SQM)	Not Applicable	Circulation or storage space.
B00B - R0015 - Movement - (99.98 SQM)	Not Applicable	Circulation or storage space.
B00B - R0021 - Metal Technology L.S. - (54.4 SQM) - Teaching Space: 1	Student Space (25)	
B00B - R0025 - Wood Technology L.S. - (89.72 SQM) - Teaching Space: 1	Student Space (41)	
B00B - R0027 - Wood Technology L.S. - (89.9 SQM) - Teaching Space: 1	Student Space (41)	
B00B - R0029 - Metal Technology L.S. - (89.41 SQM) - Teaching Space: 1	Student Space (41)	
B00B - R0033 - Metal Technology L.S. - (91.45 SQM) - Teaching Space: 1	Student Space (42)	
B00B - R1005 - Movement - (16.04 SQM)	Not Applicable	Circulation or storage space.
B00B - R1007 - Design/Technology L.S. - (61.19 SQM) - Teaching Space: 1	Student Space (28)	
B00B - R1009 - Staff Study - (26.72 SQM)	Office (6)	
B00B - R1011 - Design/Technology L.S. - (54.77 SQM) - Teaching Space: 1	Student Space (25)	
B00C - R0001 - Music Learning Space - (80.34 SQM) - Teaching Space: 1	Student Space (37)	
B00C - R0003 - Multi Media Studio - (31.77 SQM)	Not Applicable	Circulation or storage space.
B00C - R0007 - Art Learning Space - (56.16 SQM) - Teaching Space: 1	Student Space (26)	
B00C - R0008 - Art Learning Space - (61.6 SQM) - Teaching Space: 1	Student Space (28)	
B00C - R0009 - Art Learning Space - (58.82 SQM) - Teaching Space: 1	Student Space (27)	
B00C - R0010 - Art Learning Space - (60.02 SQM) - Teaching Space: 1	Student Space (27)	
B00C - R0011 - Practice/Seminar - (27.98 SQM)	Not Applicable	Circulation or storage space.
B00C - R0023 - Movement - (79.76 SQM)	Not Applicable	Circulation or storage space.
B00C - R1003 - Practice/Seminar - (14.15 SQM)	Not Applicable	Circulation or storage space.
B00C - R1007 - Art Learning Space - (63.94 SQM) - Teaching Space: 1	Student Space (29)	
B00C - R1009 - Practice/Seminar - (25.99 SQM)	Not Applicable	Circulation or storage space.
B00C - R1010 - Music Learning Space - (62.06 SQM) - Teaching Space: 1	Student Space (28)	
B00C - R1012 - Performance Workshop - (82.56 SQM)	Student Space (38)	
B00C - R1016 - Staff Study - (28.37 SQM)	Office (7)	
B00C - R1018 - Movement - (40.3 SQM)	Not Applicable	Circulation or storage space.
B00D - R0001 - General Learning Space - (48.92 SQM) - Teaching Space: 1	Student Space (22)	
B00D - R0003 - General Learning Space - (49.47 SQM) - Teaching Space: 1	Student Space (22)	
B00D - R0008 - General Learning Space - (47.81 SQM) - Teaching Space: 1	Student Space (22)	
B00D - R0009 - General Learning Space - (49.68 SQM) - Teaching Space: 1	Student Space (23)	
B00D - R0011 - General Learning Space - (49.12 SQM) - Teaching Space: 1	Student Space (22)	
B00D - R0012 - General Learning Space - (48.77 SQM) - Teaching Space: 1	Student Space (22)	
B00D - R0014 - General Learning Space - (48.13 SQM) - Teaching Space: 1	Student Space (22)	
B00D - R0015 - General Learning Space - (48.13 SQM) - Teaching Space: 1	Student Space (22)	
B00D - R0016 - General Learning Space - (42.34 SQM) - Teaching Space: 1	Student Space (19)	

Entity Location	Audit Condition Classification (Capacity)	Comment
B00D - R0017 - Interview/Office - Type 1 - (16.74 SQM)	Office (4)	
B00D - R0022 - Interview/Office - Type 1 - (13.83 SQM)	Office (3)	
B00D - R0023 - Interview/Office - Type 1 - (12.66 SQM)	Office (3)	
B00D - R0027 - Interview/Office - Type 1 - (12.44 SQM)	Office (3)	
B00D - R0030 - Staff Study - (17.8 SQM)	Office (4)	
B00D - R0033 - General Learning Space - (42.49 SQM) - Teaching Space: 1	Student Space (19)	
B00D - R0034 - General Learning Space - (47.95 SQM)	Student Space (22)	
B00D - R0035 - General Learning Space - (48.34 SQM) - Teaching Space: 1	Student Space (22)	
B00D - R0037 - General Learning Space - (48.67 SQM) - Teaching Space: 1	Student Space (22)	
B00D - R0038 - Movement - (480.82 SQM)	Not Applicable	Circulation or storage space.
B00D - R0040 - Audio Visual Workroom - (33.54 SQM)	Student Space (15)	
B00D - R0041 - Computer Learning Space - (46.07 SQM) - Teaching Space: 1	Student Space (21)	
B00D - R0051 - Main Entry - (22.05 SQM)	Not Applicable	Circulation or storage space.
B00D - R0052 - Senior Study - (79.73 SQM)	Office (19)	
B00D - R0053 - Senior Study - (33.61 SQM)	Office (8)	
B00D - R0054 - Seminar - (13.99 SQM)	Office (3)	
B00D - R0055 - Seminar - (13.99 SQM)	Office (3)	
B00D - R0056 - Seminar - (14.2 SQM)	Office (3)	
B00D - R0058 - Main Area - (336.97 SQM)	Not Applicable	Circulation or storage space.
B00D - R0062 - Tiered Learning Area - (22.2 SQM)	Student Space (10)	
B00D - R0064 - Staff Lounge - (75.13 SQM)	Office (18)	
B00D - R0065 - Staff Kitchen - (10.99 SQM)	Office (2)	
B00D - R0066 - Staff Study - (33.6 SQM)	Office (8)	
B00D - R1001 - General Learning Space - (49.68 SQM) - Teaching Space: 1	Student Space (23)	
B00D - R1002 - General Learning Space - (47.89 SQM) - Teaching Space: 1	Student Space (22)	
B00D - R1003 - General Learning Space - (40.77 SQM) - Teaching Space: 1	Student Space (18)	
B00D - R1004 - Staff Study - (40.24 SQM)	Office (10)	
B00D - R1005 - General Learning Space - (40.67 SQM) - Teaching Space: 1	Student Space (18)	
B00D - R1006 - General Learning Space - (47.94 SQM) - Teaching Space: 1	Student Space (22)	
B00D - R1007 - General Learning Space - (49.65 SQM) - Teaching Space: 1	Student Space (23)	
B00D - R1009 - General Learning Space - (49.47 SQM) - Teaching Space: 1	Student Space (22)	
B00D - R1010 - General Learning Space - (48.74 SQM) - Teaching Space: 1	Student Space (22)	
B00D - R1012 - General Learning Space - (48.38 SQM) - Teaching Space: 1	Student Space (22)	
B00D - R1013 - Computer Learning Space - (47.83 SQM) - Teaching Space: 1	Student Space (22)	
B00D - R1014 - Computer Learning Space - (42.15 SQM) - Teaching Space: 1	Student Space (19)	
B00D - R1016 - Shared Study Space - (15.86 SQM)	Office (3)	
B00D - R1021 - Shared Study Space - (12.83 SQM)	Office (3)	
B00D - R1022 - Tiered Learning Area - (45.7 SQM)	Student Space (21)	
B00D - R1023 - Leading Teacher - (12.86 SQM)	Office (3)	
B00D - R1024 - Interview/Office - Type 1 - (15.22 SQM)	Office (3)	
B00D - R1031 - General Learning Space - (42.45 SQM) - Teaching Space: 1	Student Space (19)	
B00D - R1032 - General Learning Space - (48.1 SQM) - Teaching Space: 1	Student Space (22)	
B00D - R1033 - Computer Learning Space - (48.32 SQM) - Teaching Space: 1	Student Space (22)	
B00D - R1035 - General Learning Space - (48.8 SQM) - Teaching Space: 1	Student Space (22)	
B00D - R1036 - General Learning Space - (49.23 SQM) - Teaching Space: 1	Student Space (22)	
B00D - R1040 - Special Learning Space - (29.93 SQM) - Teaching Space: 1	Student Space (13)	

Entity Location	Audit Condition Classification (Capacity)	Comment
B00D - R1044 - Movement - (350.35 SQM)	Not Applicable	Circulation or storage space.
B00D - R1045 - Staff Study - (32.59 SQM)	Office (8)	
B00D - R1047 - Staff Study - (38.1 SQM)	Office (9)	
B00E - R0001 - Laboratory L.S. - (80.06 SQM) - Teaching Space: 1	Student Space (37)	
B00E - R0002 - Preparation - Science - (31.56 SQM)	Not Applicable	Circulation or storage space.
B00E - R0003 - Laboratory L.S. - (79.71 SQM) - Teaching Space: 1	Student Space (36)	
B00E - R0006 - Laboratory L.S. - (80.43 SQM) - Teaching Space: 1	Student Space (37)	
B00E - R0007 - Preparation - Science - (31.83 SQM)	Not Applicable	Circulation or storage space.
B00E - R0008 - Laboratory L.S. - (81.23 SQM) - Teaching Space: 1	Student Space (37)	
B00E - R0014 - Laboratory L.S. - (79.98 SQM) - Teaching Space: 1	Student Space (37)	
B00E - R0016 - Laboratory L.S. - (80.34 SQM) - Teaching Space: 1	Student Space (37)	
B00E - R0018 - Tea Room - (12.9 SQM)	Not Applicable	Circulation or storage space.
B00E - R0019 - Movement - (211.55 SQM)	Not Applicable	Circulation or storage space.
B00E - R0027 - Dark Room - (28.57 SQM)	Office (7)	
B00E - R0029 - Staff Study - (39.09 SQM)	Office (9)	
B00E - R1001 - Food Technology L.S. - (105.84 SQM) - Teaching Space: 1	Student Space (49)	
B00E - R1004 - Food Technology L.S. - (106.22 SQM) - Teaching Space: 1	Student Space (49)	
B00E - R1007 - Computer Learning Space - (71.44 SQM) - Teaching Space: 1	Student Space (33)	
B00E - R1009 - Design L.S. - (70.84 SQM) - Teaching Space: 1	Student Space (32)	
B00E - R1010 - Movement - (90.53 SQM)	Not Applicable	Circulation or storage space.
B00E - R1018 - Preparation - Materials - (32.87 SQM)	Not Applicable	Circulation or storage space.
B00F - R0001 - Student Canteen - (64.72 SQM)	Not Applicable	Circulation or storage space.
B00G - R0002 - Interview/Meeting - (8.37 SQM)	Office (2)	
B00G - R0011 - General Assistants - (12.05 SQM)	Office (3)	
B00G - R0015 - Movement - (5.79 SQM)	Not Applicable	Circulation or storage space.
B00G - R0016 - Movement - (9.97 SQM)	Not Applicable	Circulation or storage space.
B00G - R0017 - Stage - (101.57 SQM)	Not Applicable	Circulation or storage space.
B00G - R0018 - Movement - (10.07 SQM)	Not Applicable	Circulation or storage space.
B00G - R0019 - Movement - (5.58 SQM)	Not Applicable	Circulation or storage space.
B00G - R0021 - Multi-Purpose Space - (472.94 SQM)	Student Space (219)	
B00G - R0025 - Interview/Office - Type 1 - (22.18 SQM)	Office (5)	
B00G - R9003 - Movement - (16.96 SQM)	Not Applicable	Circulation or storage space.
B00G - R9008 - Movement - (16.77 SQM)	Not Applicable	Circulation or storage space.
B00H - R0001 - Growing/Breeding - (10.82 SQM)	Not Applicable	Circulation or storage space.
B00H - R0006 - Growing/Breeding - (24.68 SQM)	Not Applicable	Circulation or storage space.
B00H - R0010 - Growing/Breeding - (26.29 SQM)	Not Applicable	Circulation or storage space.
B00H - R0012 - Growing/Breeding - (15.97 SQM)	Not Applicable	Circulation or storage space.
B00H - R0013 - Growing/Breeding - (27.35 SQM)	Not Applicable	Circulation or storage space.
B00I - R0001 - Seminar - Type 1 - (20.69 SQM)	Office (5)	
B00I - R0009 - Interview/Meeting - (12.51 SQM)	Office (3)	
B00I - R0016 - Special Learning Space - (53.1 SQM) - Teaching Space: 1	Student Space (24)	
B00I - R0018 - Special Learning Space - (52 SQM) - Teaching Space: 1	Student Space (24)	
B00I - R0020 - Staff Study - (52.4 SQM)	Office (13)	
B00J - R0001 - Computer Learning Space - (64.64 SQM) - Teaching Space: 1	Student Space (29)	
B00J - R0003 - General Learning Space - (59.69 SQM) - Teaching Space: 1	Student Space (27)	
B00J - R0004 - General Learning Space - (59.54 SQM) - Teaching Space: 1	Student Space (27)	
B00J - R0005 - Staff Study - (24.23 SQM)	Office (6)	
B00J - R0006 - General Learning Space - (59.61 SQM) - Teaching Space: 1	Student Space (27)	
B00J - R0007 - General Learning Space - (59.68 SQM) - Teaching Space: 1	Student Space (27)	
B00J - R0009 - General Learning Space - (59.6 SQM) - Teaching Space: 1	Student Space (27)	

Entity Location	Audit Condition Classification (Capacity)	Comment
B00J - R0010 - Seminar/Study - (123.5 SQM)	 Office (30)	
B00K - R0001 - Fitness Laboratory - (51.25 SQM)	 Student Space (23)	
B00L - R0001 - Preparation - Materials - (23.61 SQM)	Not Applicable	Circulation or storage space.
B00L - R0003 - Food Technology L.S. - (122.46 SQM) - Teaching Space: 1	 Student Space (56)	
B00L - R0004 - Food/Research Space - (40.96 SQM)	Not Applicable	Circulation or storage space.
B00L - R0006 - Food/Research Space - (15.19 SQM)	Not Applicable	Circulation or storage space.
B00M - R0001 - General Learning Space - (91.84 SQM) - Teaching Space: 1	 Student Space (42)	
B00M - R0002 - Staff Study - (18.7 SQM)	 Office (4)	
B00M - R0004 - Staff Kitchen - (9.04 SQM)	 Office (2)	