

# VENTILATION AUDIT REPORT

<b>SCHOOL:</b>	<b>Northbridge Public School (2761)</b>
<b>AMU REGION:</b>	<b>Northern Sydney</b>
<b>STATE ELECTORATE:</b>	<b>Willoughby</b>
<b>LOCAL GOVERNMENT AREA:</b>	<b>Willoughby</b>

2761 - Northbridge Public School  
Site Plan (10545)

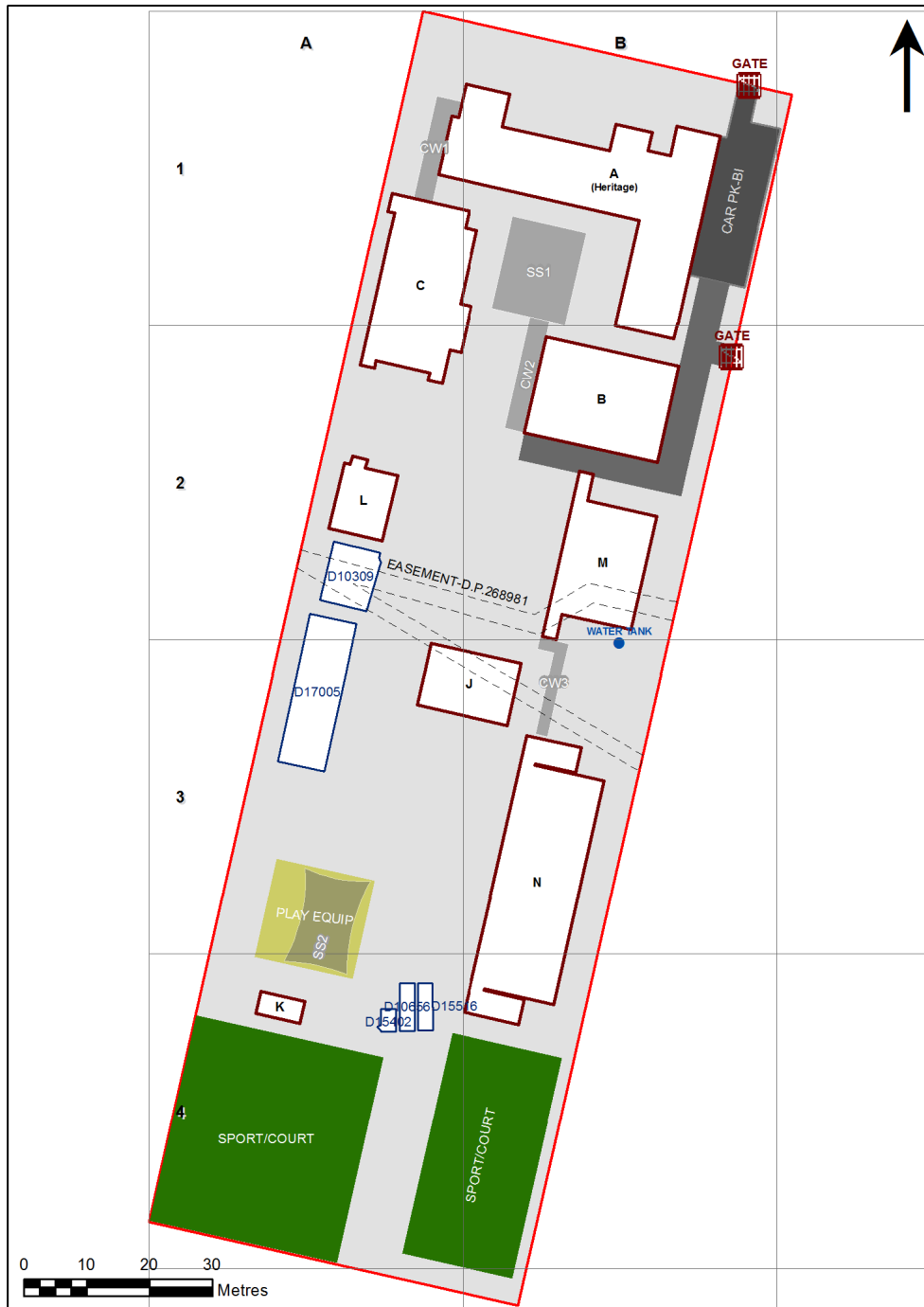

1:755

Printed: 20-Aug-2021

## Ventilation Audit Key

Category	Description
	Category A Operate this space in line with <a href="#">COVID safe school operations</a> . It has the required level of natural ventilation. NB. Circulation and storage areas should not be used for groups or gatherings.
	Category B This space should be occupied at 1 person per 4m <sup>2</sup> to comply with <a href="#">COVID safe school operations and the guided use of spaces</a> . The report details the number of people who can be accommodated safely in each of the identified spaces.

Entity Location	Audit Condition Classification (Capacity)	Comment
B00A - R0001 - Staff Room Annexe - (23.39 SQM)	Office (5)	
B00A - R0002 - Home Base - (47.34 SQM) - Teaching Space: 1	Student Space (21)	
B00A - R0003 - Home Base - (47.14 SQM) - Teaching Space: 1	Student Space (21)	
B00A - R0004 - Home Base - (47.08 SQM) - Teaching Space: 1	Student Space (21)	
B00A - R0005 - Movement - (51.22 SQM)	Not Applicable	Circulation or storage space.
B00A - R0006 - Interview - (12.59 SQM)	Office (3)	
B00A - R0007 - Principal - (17.33 SQM)	Office (4)	
B00A - R0009 - Movement - (10.08 SQM)	Not Applicable	Circulation or storage space.
B00A - R0013 - Sick Bay - (13.58 SQM)	Student Space (6)	
B00A - R0016 - Entry Vestibule - (23.73 SQM)	Not Applicable	Circulation or storage space.
B00A - R0017 - Clerical Office - (21.25 SQM)	Office (5)	
B00A - R0018 - Duplicating Workroom - (21.64 SQM)	Office (5)	
B00A - R0019 - Special Programs Room - (45.28 SQM)	Student Space (21)	
B00A - R0020 - Home Base - (44.15 SQM) - Teaching Space: 1	Student Space (20)	
B00A - R0022 - Staff Room - (47.22 SQM)	Office (11)	
B00A - R0023 - Staff Room Annexe - (19.82 SQM)	Office (4)	
B00A - R0026 - Staff Room Annexe - (12.46 SQM)	Office (3)	
B00A - R0029 - Movement - (14.38 SQM)	Not Applicable	Circulation or storage space.
B00B - R0003 - Reading Area - (153.49 SQM)	Student Space (71)	
B00B - R0005 - Movement - (120.08 SQM)	Not Applicable	Circulation or storage space.
B00C - R0001 - Movement - (25.48 SQM)	Not Applicable	Circulation or storage space.
B00C - R0002 - Staff Kitchen - (7.73 SQM)	Office (1)	
B00C - R0003 - Communal Space - (245.41 SQM)	Student Space (113)	
B00C - R0004 - Raised Platform - (63.87 SQM)	Not Applicable	Circulation or storage space.
B00C - R9001 - Special Programs Room - (21.16 SQM)	Student Space (9)	
B00C - R9003 - Movement - (5.44 SQM)	Not Applicable	Circulation or storage space.
B00J - R0001 - Movement - (28.07 SQM)	Not Applicable	Circulation or storage space.
B00J - R0002 - Home Base - (52.34 SQM) - Teaching Space: 1	Student Space (24)	
B00J - R0003 - Home Base - (52.27 SQM) - Teaching Space: 1	Student Space (24)	
B00K - R0001 - Communal Space - (17.99 SQM)	Student Space (8)	
B00L - R0005 - Movement - (20.14 SQM)	Not Applicable	Circulation or storage space.
B00M - R0001 - Home Base - (60.73 SQM) - Teaching Space: 1	Student Space (28)	
B00M - R0003 - Practical Activities - 1hb - (19.57 SQM)	Student Space (9)	
B00M - R0004 - Withdrawal Space - 2hb - (11.58 SQM)	Student Space (5)	
B00M - R0005 - Home Base - (60.86 SQM) - Teaching Space: 1	Student Space (28)	
B00M - R0007 - Practical Activities - 1hb - (19.17 SQM)	Student Space (8)	
B00M - R0008 - Movement - (64.36 SQM)	Not Applicable	Circulation or storage space.
B00M - R1001 - Home Base - (59.46 SQM) - Teaching Space: 1	Student Space (27)	
B00M - R1003 - Practical Activities - 1hb - (18.68 SQM)	Student Space (8)	
B00M - R1004 - Withdrawal Space - 2hb - (11.61 SQM)	Student Space (5)	
B00M - R1005 - Home Base - (59.87 SQM) - Teaching Space: 1	Student Space (27)	
B00M - R1007 - Practical Activities - 1hb - (18.69 SQM)	Student Space (8)	
B00M - R1008 - Movement - (45.54 SQM)	Not Applicable	Circulation or storage space.
B00N - R0001 - Home Base/Practical Activities - (60.17 SQM) - Teaching Space: 1	Student Space (27)	
B00N - R0002 - Home Base/Practical Activities - (60.34 SQM) - Teaching Space: 1	Student Space (27)	
B00N - R0003 - Home Base/Practical Activities - (60.43 SQM) - Teaching Space: 1	Student Space (28)	
B00N - R0004 - Home Base/Practical Activities - (60.12 SQM) - Teaching Space: 1	Student Space (27)	
B00N - R0006 - Practical Activities/Movement - 1hb - (18.9 SQM)	Student Space (8)	
B00N - R0007 - Withdrawal Space - 2hb - (11.51 SQM)	Student Space (5)	

Entity Location	Audit Condition Classification (Capacity)	Comment
B00N - R0008 - Practical Activities/Movement - 1hb - (18.3 SQM)	● Student Space (8)	
B00N - R0009 - Practical Activities/Movement - 1hb - (18.27 SQM)	● Student Space (8)	
B00N - R0010 - Withdrawal Space - 2hb - (11.48 SQM)	● Student Space (5)	
B00N - R0011 - Practical Activities/Movement - 1hb - (18.87 SQM)	● Student Space (8)	
B00N - R1001 - Home Base/Practical Activities - (60.29 SQM) - Teaching Space: 1	● Student Space (27)	
B00N - R1002 - Home Base/Practical Activities - (60.29 SQM) - Teaching Space: 1	● Student Space (27)	
B00N - R1003 - Home Base/Practical Activities - (60.36 SQM) - Teaching Space: 1	● Student Space (28)	
B00N - R1004 - Home Base/Practical Activities - (60.34 SQM) - Teaching Space: 1	● Student Space (27)	
B00N - R1006 - Practical Activities/Movement - 1hb - (18.88 SQM)	● Student Space (8)	
B00N - R1007 - Withdrawal Space - 2hb - (11.48 SQM)	● Student Space (5)	
B00N - R1008 - Practical Activities/Movement - 1hb - (18.91 SQM)	● Student Space (8)	
B00N - R1009 - Practical Activities/Movement - 1hb - (18.89 SQM)	● Student Space (8)	
B00N - R1010 - Withdrawal Space - 2hb - (11.48 SQM)	● Student Space (5)	
B00N - R1011 - Practical Activities/Movement - 1hb - (18.97 SQM)	● Student Space (8)	
OH 045 17005 - OH 045 17005 - OSHC Hub 45 - ( SQM)	● Student Space ( )	
OS 602 10309 - OS 602 10309 - Learning Unit - Standard With P.A.A. - (76 SQM)	● Student Space (35)	
OS 603 11331 - OS 603 11331 - Learning Unit - Standard With P.A.A. A/C - (76 SQM)	● Student Space (35)	
OS 603 13703 - OS 603 13703 - Learning Unit - Standard With P.A.A. A/C - (76 SQM)	● Student Space (35)	
OS 801 12072 - OS 801 12072 - FSU - (57 SQM)	Not Applicable	Circulation or storage space.