

VENTILATION AUDIT REPORT

SCHOOL:	North Ryde Public School (3022)
AMU REGION:	Northern Sydney
STATE ELECTORATE:	Ryde
LOCAL GOVERNMENT AREA:	Ryde

3022 - North Ryde Public School
Site Plan (11544)

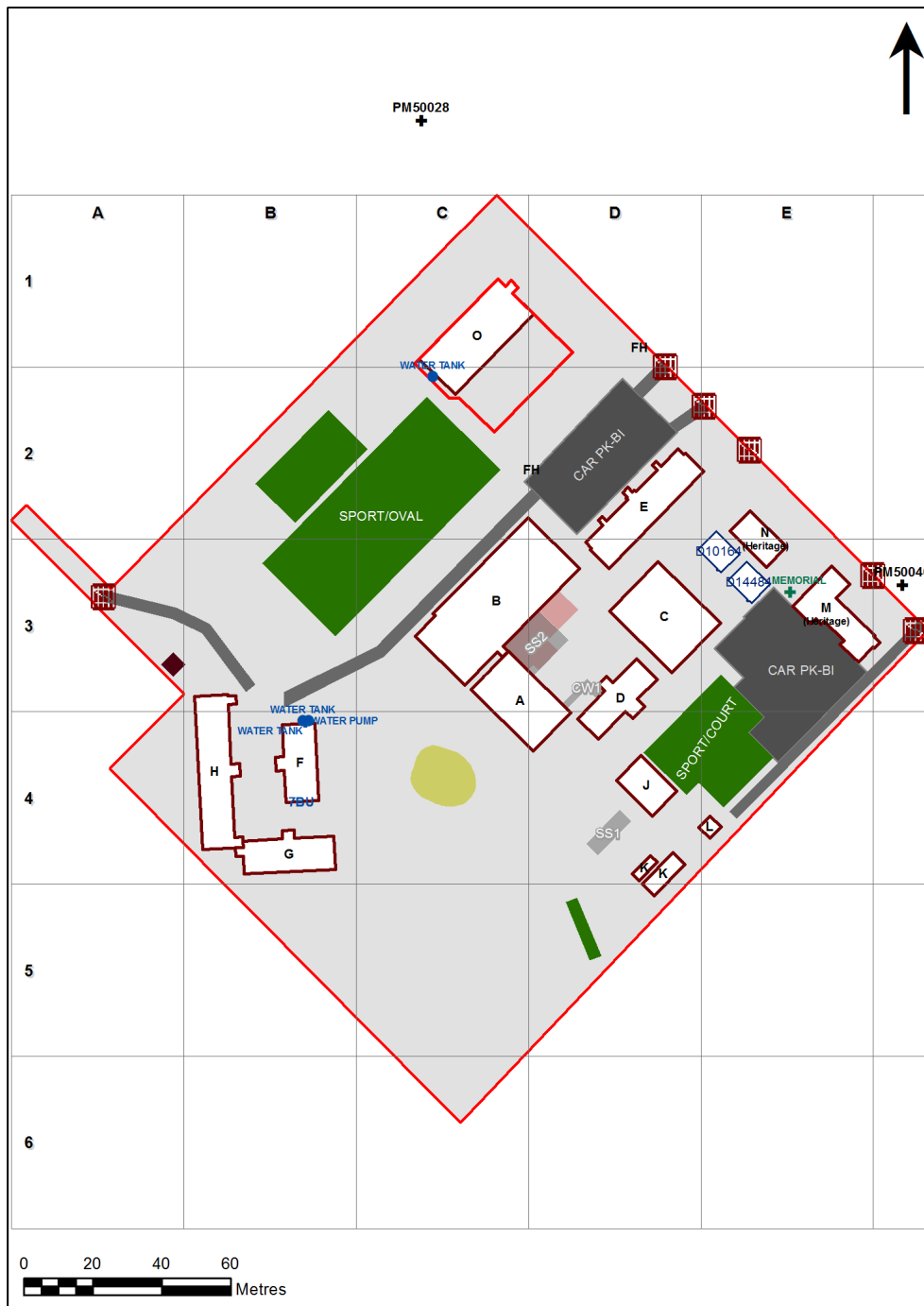



1:1,375

Printed: 20-Apr-2021

Ventilation Audit Key

Category	Description
	Category A Operate this space in line with COVID safe school operations . It has the required level of natural ventilation. NB. Circulation and storage areas should not be used for groups or gatherings.
	Category B This space should be occupied at 1 person per 4m ² to comply with COVID safe school operations and the guided use of spaces . The report details the number of people who can be accommodated safely in each of the identified spaces.

Entity Location	Audit Condition Classification (Capacity)	Comment
B00A - R0001 - Interview - (10.16 SQM)	Office (2)	
B00A - R0004 - Principal - (17.5 SQM)	Office (4)	
B00A - R0005 - Clerical Office - (13.11 SQM)	Office (3)	
B00A - R0006 - Sick Bay - (13.11 SQM)	Student Space (6)	
B00A - R0007 - Staff Room - (80.94 SQM)	Office (20)	
B00A - R0009 - Duplicating Workroom - (15.44 SQM)	Office (3)	
B00A - R0010 - Entry Vestibule - (44.16 SQM)	Not Applicable	Circulation or storage space.
B00B - R0016 - Movement - (18.94 SQM)	Not Applicable	Circulation or storage space.
B00B - R0018 - Canteen - (26.74 SQM)	Not Applicable	Circulation or storage space.
B00B - R0024 - Communal Space - (283.18 SQM)	Student Space (131)	
B00C - R0001 - Home Base - (51.17 SQM) - Teaching Space: 1	Student Space (23)	
B00C - R0002 - Practical Activities - 1hb - (15.85 SQM)	Student Space (7)	
B00C - R0003 - Home Base - (51.17 SQM) - Teaching Space: 1	Student Space (23)	
B00C - R0004 - Practical Activities - 1hb - (15.84 SQM)	Student Space (7)	
B00C - R0009 - Home Base - (51.1 SQM) - Teaching Space: 1	Student Space (23)	
B00C - R0010 - Practical Activities - 1hb - (16 SQM)	Student Space (7)	
B00C - R0011 - Home Base - (51.1 SQM) - Teaching Space: 1	Student Space (23)	
B00C - R0012 - Practical Activities - 1hb - (16 SQM)	Student Space (7)	
B00D - R0005 - Reading Area - (153.47 SQM)	Student Space (71)	
B00D - R0006 - Movement - (9.4 SQM)	Not Applicable	Circulation or storage space.
B00D - R0009 - Movement - (8.17 SQM)	Not Applicable	Circulation or storage space.
B00E - R0004 - Home Base - (53.31 SQM) - Teaching Space: 1	Student Space (24)	
B00E - R0005 - Home Base - (53.46 SQM) - Teaching Space: 1	Student Space (24)	
B00E - R0009 - Movement - (8.82 SQM)	Not Applicable	Circulation or storage space.
B00E - R0011 - Interview - (12.73 SQM)	Office (3)	
B00E - R0012 - Home Base - (53.53 SQM) - Teaching Space: 1	Student Space (24)	
B00E - R0013 - Home Base - (53.53 SQM) - Teaching Space: 1	Student Space (24)	
B00E - R0014 - Interview - (12.64 SQM)	Office (3)	
B00F - R0001 - Movement - (8.34 SQM)	Not Applicable	Circulation or storage space.
B00F - R0003 - Practical Activities - 1hb - (12.78 SQM)	Student Space (5)	
B00F - R0004 - Home Base - (82.2 SQM) - Teaching Space: 1	Student Space (38)	
B00F - R0005 - Home Base - (81.57 SQM) - Teaching Space: 1	Student Space (37)	
B00F - R0006 - Practical Activities - 1hb - (12.78 SQM)	Student Space (5)	
B00G - R0002 - Home Base - (65.51 SQM) - Teaching Space: 1	Student Space (30)	
B00G - R0014 - Movement - (7.04 SQM)	Not Applicable	Circulation or storage space.
B00G - R0017 - Special Programs Room - (77.3 SQM)	Student Space (35)	
B00H - R0001 - Deputy Principal - (16.53 SQM)	Office (4)	
B00H - R0005 - Movement - (15.56 SQM)	Not Applicable	Circulation or storage space.
B00H - R0007 - Home Base - (64.07 SQM) - Teaching Space: 1	Student Space (29)	
B00H - R0008 - Home Base - (64.53 SQM) - Teaching Space: 1	Student Space (29)	
B00H - R0011 - Movement - (7.5 SQM)	Not Applicable	Circulation or storage space.
B00H - R0013 - Movement - (7.66 SQM)	Not Applicable	Circulation or storage space.
B00H - R0014 - Home Base - (64.97 SQM) - Teaching Space: 1	Student Space (30)	
B00H - R0016 - Home Base - (65.06 SQM) - Teaching Space: 1	Student Space (30)	
B00H - R0019 - Staff Room - (18.51 SQM)	Office (4)	
B00H - R0021 - Movement - (14.32 SQM)	Not Applicable	Circulation or storage space.
B00H - R0022 - Movement - (5.86 SQM)	Not Applicable	Circulation or storage space.
B00J - R0002 - Special Programs Room - (51.64 SQM)	Student Space (23)	
B00J - R0004 - Movement - (27.89 SQM)	Not Applicable	Circulation or storage space.

Entity Location	Audit Condition Classification (Capacity)	Comment
B000 - R0011 - Movement - (35.86 SQM)	Not Applicable	Circulation or storage space.
B000 - R0012 - Staff Room - (22.64 SQM)	 Office (5)	
B000 - R0018 - Entry Vestibule - (6.85 SQM)	Not Applicable	Circulation or storage space.
OS 602 10164 - OS 602 10164 - Learning Unit - Standard With P.A.A. - (76 SQM)	 Student Space (35)	
OS 602 14484 - OS 602 14484 - Learning Unit - Standard With P.A.A. - (76 SQM)	 Student Space (35)	