

VENTILATION AUDIT REPORT

SCHOOL:	North Haven Public School (4149)
AMU REGION:	North Coast
STATE ELECTORATE:	Port Macquarie
LOCAL GOVERNMENT AREA:	Port Macquarie-Hastings

4149 - North Haven Public School
Site Plan (10558)

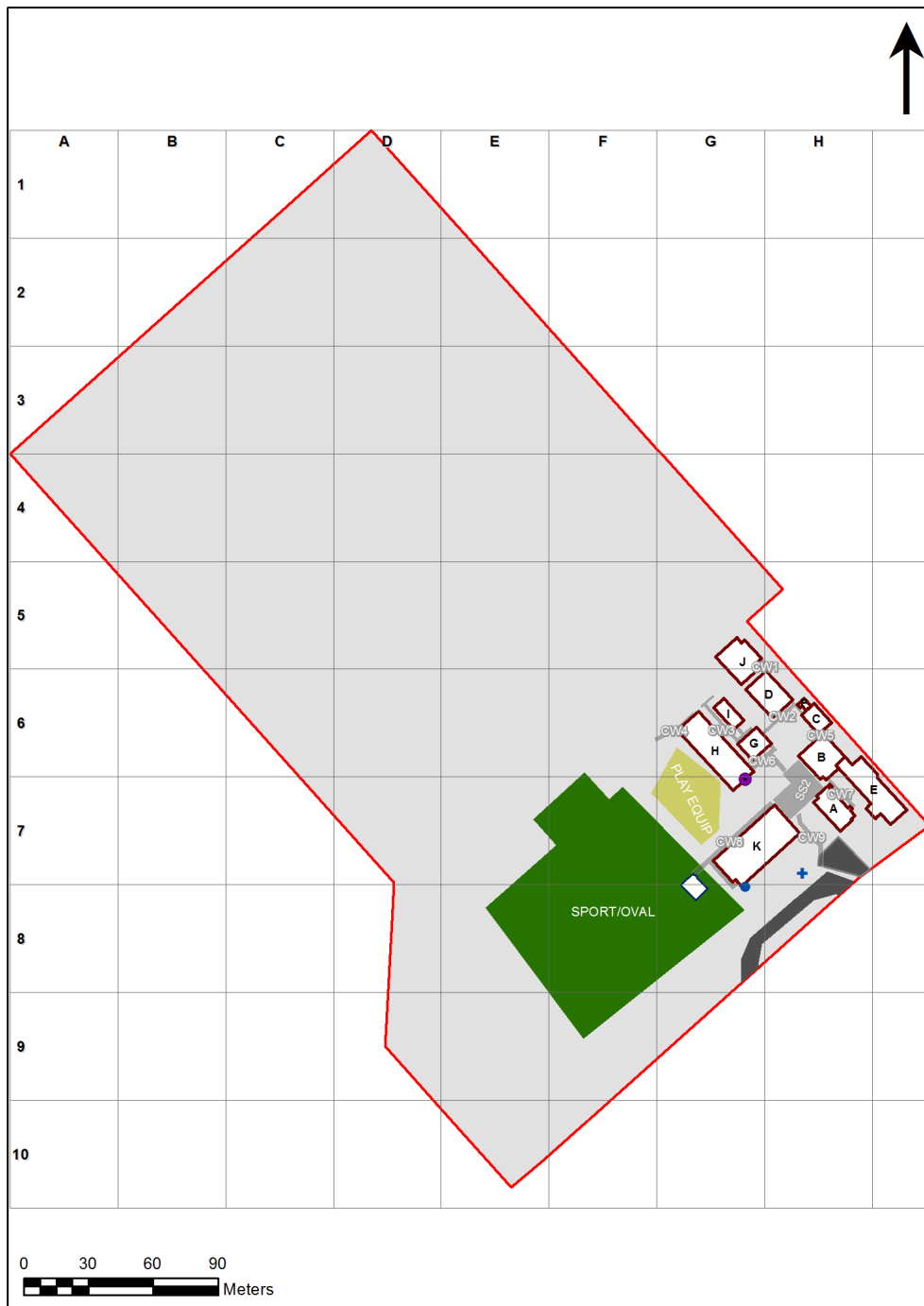

1:2,199

Printed: 30-May-2020

Ventilation Audit Key

Category	Description
	Category A Operate this space in line with COVID safe school operations . It has the required level of natural ventilation. NB. Circulation and storage areas should not be used for groups or gatherings.
	Category B This space should be occupied at 1 person per 4m ² to comply with COVID safe school operations and the guided use of spaces . The report details the number of people who can be accommodated safely in each of the identified spaces.

Entity Location	Audit Condition Classification (Capacity)	Comment
B00A - R0001 - Practical Activities - 1hb - (14.9 SQM)	● Student Space (6)	
B00A - R0002 - Home Base - (53.87 SQM) - Teaching Space: 1	● Student Space (24)	
B00A - R0003 - Home Base - (53.88 SQM) - Teaching Space: 1	● Student Space (24)	
B00A - R0005 - Practical Activities - 1hb - (16.33 SQM)	● Student Space (7)	
B00A - R0006 - Canteen - (17.34 SQM)	Not Applicable	Circulation or storage space.
B00B - R0002 - Home Base - (56.09 SQM) - Teaching Space: 1	● Student Space (26)	
B00B - R0003 - Withdrawal Space - 1hb - (8.89 SQM)	● Student Space (4)	
B00B - R0005 - Practical Activities - 1hb - (47.44 SQM)	● Student Space (22)	
B00B - R0008 - Home Base - (55.95 SQM) - Teaching Space: 1	● Student Space (25)	
B00D - R0004 - Withdrawal Space - 1hb - (5.78 SQM)	● Student Space (2)	
B00D - R0005 - Home Base - (76.61 SQM) - Teaching Space: 1	● Student Space (35)	
B00D - R0006 - Home Base - (77.52 SQM) - Teaching Space: 1	● Student Space (35)	
B00D - R0007 - Withdrawal Space - 1hb - (5.82 SQM)	● Student Space (2)	
B00E - R0002 - Entry Vestibule - (30.08 SQM)	Not Applicable	Circulation or storage space.
B00E - R0003 - Principal - (11.51 SQM)	● Office (2)	
B00E - R0004 - Deputy Principal - (11.85 SQM)	● Office (2)	
B00E - R0005 - Deputy Principal - (11.85 SQM)	● Office (2)	
B00E - R0006 - Interview - (23.87 SQM)	● Office (5)	
B00E - R0010 - Duplicating Workroom - (19.09 SQM)	● Office (4)	
B00E - R0011 - Clerical Office - (13.75 SQM)	● Office (3)	
B00E - R0012 - Sick Bay - (10.66 SQM)	● Student Space (4)	
B00E - R0016 - Clerical Office/Workroom - (52.93 SQM)	● Office (13)	
B00E - R0017 - Staff Room Annexe - (18.15 SQM)	● Office (4)	
B00E - R0018 - Staff Room - (39.96 SQM)	● Office (9)	
B00E - R0019 - Staff Kitchen - (6.59 SQM)	● Office (1)	
B00E - R0021 - Movement - (9.96 SQM)	Not Applicable	Circulation or storage space.
B00E - R0022 - Entry Vestibule - (20.91 SQM)	Not Applicable	Circulation or storage space.
B00E - R0024 - Movement - (7 SQM)	Not Applicable	Circulation or storage space.
B00H - R0001 - Reading Area - (162.38 SQM)	● Student Space (75)	
B00H - R0006 - Practical Activities - 1hb - (18.98 SQM)	● Student Space (8)	
B00H - R0007 - Home Base - (59.28 SQM) - Teaching Space: 1	● Student Space (27)	
B00H - R0009 - Withdrawal Space - 1hb - (9.72 SQM)	● Student Space (4)	
B00H - R0010 - Home Base - (59.2 SQM) - Teaching Space: 1	● Student Space (27)	
B00H - R0012 - Practical Activities - 1hb - (17.24 SQM)	● Student Space (7)	
B00I - R0001 - Special Programs Room - (69.56 SQM)	● Student Space (32)	
B00J - R0002 - Practical Activities - 1hb - (19.43 SQM)	● Student Space (9)	
B00J - R0004 - Home Base - (59.29 SQM) - Teaching Space: 1	● Student Space (27)	
B00J - R0005 - Withdrawal Space - 2hb - (11.37 SQM)	● Student Space (5)	
B00J - R0006 - Home Base - (59.27 SQM) - Teaching Space: 1	● Student Space (27)	
B00J - R0008 - Practical Activities - 1hb - (19.43 SQM)	● Student Space (9)	
B00K - R0001 - Communal Space - (198.78 SQM)	● Student Space (92)	
B00K - R0002 - Raised Platform - (56.8 SQM)	Not Applicable	Circulation or storage space.
B00K - R0016 - Movement - (6.69 SQM)	Not Applicable	Circulation or storage space.
B00K - R0018 - Canteen - (24.58 SQM)	Not Applicable	Circulation or storage space.
B00K - R0020 - Movement - (16.97 SQM)	Not Applicable	Circulation or storage space.