

VENTILATION AUDIT REPORT

SCHOOL:	Newtown High School of Performing Arts (8530)
AMU REGION:	Sydney
STATE ELECTORATE:	Newtown
LOCAL GOVERNMENT AREA:	Sydney

8530 - Newtown High School of Performing Arts
Site Plan (13186)

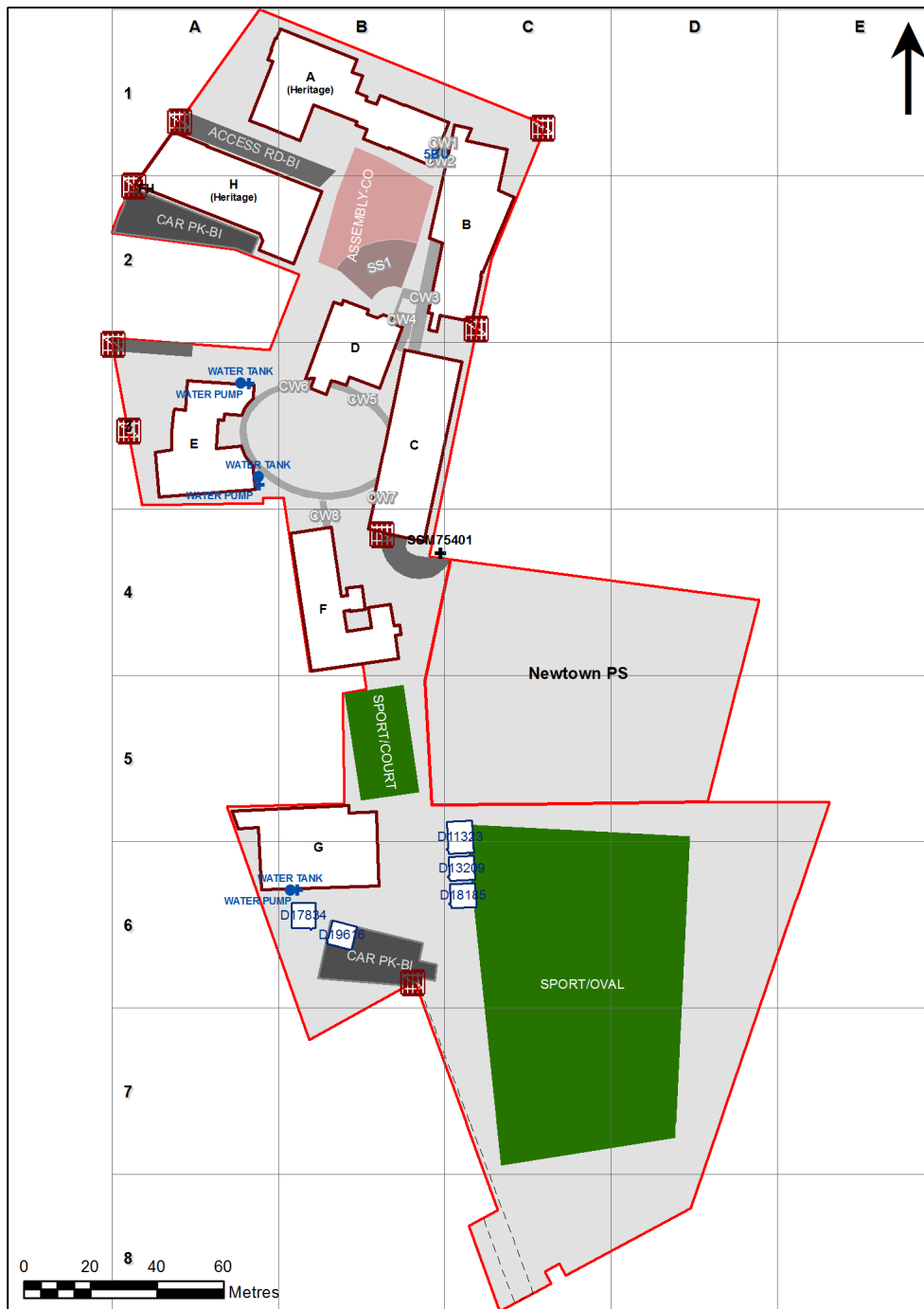

1:1,427

Printed: 13-Jan-2021

Ventilation Audit Key

Category	Description
	Category A Operate this space in line with COVID safe school operations . It has the required level of natural ventilation. NB. Circulation and storage areas should not be used for groups or gatherings.
	Category B This space should be occupied at 1 person per 4m ² to comply with COVID safe school operations and the guided use of spaces . The report details the number of people who can be accommodated safely in each of the identified spaces.

Entity Location	Audit Condition Classification (Capacity)	Comment
B00A - R0005 - Practice/Seminar - (11.36 SQM)	Not Applicable	Circulation or storage space.
B00A - R0006 - Practice/Seminar - (10.85 SQM)	Not Applicable	Circulation or storage space.
B00A - R0007 - Practice/Seminar - (12.39 SQM)	Not Applicable	Circulation or storage space.
B00A - R0011 - Movement - (15.4 SQM)	Not Applicable	Circulation or storage space.
B00A - R0013 - Art Learning Space - (64.18 SQM) - Teaching Space: 1	● Student Space (29)	
B00A - R0015 - Art Learning Space - (68.36 SQM) - Teaching Space: 1	● Student Space (31)	
B00A - R0016 - Art Learning Space - (66.32 SQM) - Teaching Space: 1	● Student Space (30)	
B00A - R0018 - Performance Workspace - (118.97 SQM) - Teaching Space: 1	● Student Space (55)	
B00A - R0019 - Movement - (25.45 SQM)	Not Applicable	Circulation or storage space.
B00A - R0024 - Movement - (24.43 SQM)	Not Applicable	Circulation or storage space.
B00A - R0025 - Movement - (32.22 SQM)	Not Applicable	Circulation or storage space.
B00A - R0026 - Movement - (42.83 SQM)	Not Applicable	Circulation or storage space.
B00A - R0027 - Music Learning Space - (83.68 SQM) - Teaching Space: 1	● Student Space (38)	
B00A - R0028 - Commonroom - (53.92 SQM)	● Office (13)	
B00A - R0030 - Movement - (6.47 SQM)	Not Applicable	Circulation or storage space.
B00A - R0031 - Movement - (24.15 SQM)	Not Applicable	Circulation or storage space.
B00A - R0034 - Commonroom - (27.82 SQM)	● Office (6)	
B00A - R1001 - Music Learning Space - (51.21 SQM) - Teaching Space: 1	● Student Space (23)	
B00A - R1005 - Practice/Seminar - (10.61 SQM)	Not Applicable	Circulation or storage space.
B00A - R1006 - Practice/Seminar - (10.48 SQM)	Not Applicable	Circulation or storage space.
B00A - R1007 - Practice/Seminar - (10.65 SQM)	Not Applicable	Circulation or storage space.
B00A - R1008 - Practice/Seminar - (10.28 SQM)	Not Applicable	Circulation or storage space.
B00A - R1009 - Practice/Seminar - (6.64 SQM)	Not Applicable	Circulation or storage space.
B00A - R1011 - Movement - (35.36 SQM)	Not Applicable	Circulation or storage space.
B00A - R1012 - Music Learning Space - (47.67 SQM) - Teaching Space: 1	● Student Space (22)	
B00A - R1013 - General Learning Space - (47.97 SQM) - Teaching Space: 1	● Student Space (22)	
B00A - R1014 - Movement - (5.57 SQM)	Not Applicable	Circulation or storage space.
B00A - R1015 - Movement - (33.93 SQM)	Not Applicable	Circulation or storage space.
B00A - R1018 - Staff Study - (20.91 SQM)	● Office (5)	
B00A - R1024 - Movement - (24.61 SQM)	Not Applicable	Circulation or storage space.
B00A - R1026 - Performance Workspace - (202.14 SQM) - Teaching Space: 1	● Student Space (93)	
B00A - R1028 - Performance Workspace - (119.97 SQM) - Teaching Space: 1	● Student Space (55)	
B00A - R9004 - Movement - (8.35 SQM)	Not Applicable	Circulation or storage space.
B00A - R9006 - Darkroom Space - (24.11 SQM)	● Office (6)	
B00A - R9007 - Darkroom Space - (28 SQM)	● Office (7)	
B00A - R9011 - Movement - (40.88 SQM)	Not Applicable	Circulation or storage space.
B00B - R0001 - Stage - (296.35 SQM)	Not Applicable	Circulation or storage space.
B00B - R0007 - Public Entry - (69.03 SQM)	Not Applicable	Circulation or storage space.
B00B - R0011 - Movement - (65.55 SQM)	Not Applicable	Circulation or storage space.
B00B - R0012 - Movement - (33.97 SQM)	Not Applicable	Circulation or storage space.
B00B - R0013 - Movement - (78.7 SQM)	Not Applicable	Circulation or storage space.
B00B - R0016 - Movement - (39.48 SQM)	Not Applicable	Circulation or storage space.
B00B - R0022 - Multi Media Studio - (12.67 SQM)	Not Applicable	Circulation or storage space.
B00B - R0024 - Performance Workshop - (138.19 SQM)	● Student Space (64)	
B00B - R1001 - Music Learning Space - (68.62 SQM) - Teaching Space: 1	● Student Space (31)	
B00B - R1002 - Practice/Seminar - (11.73 SQM)	Not Applicable	Circulation or storage space.
B00B - R1003 - Practice/Seminar - (11.22 SQM)	Not Applicable	Circulation or storage space.
B00B - R1004 - Movement - (12.89 SQM)	Not Applicable	Circulation or storage space.
B00B - R1006 - Staff Study - (12.9 SQM)	● Office (3)	
B00B - R1009 - Movement - (78.88 SQM)	Not Applicable	Circulation or storage space.
B00B - R1011 - Movement - (118.94 SQM)	Not Applicable	Circulation or storage space.
B00B - R1012 - Movement - (26.22 SQM)	Not Applicable	Circulation or storage space.

Entity Location	Audit Condition Classification (Capacity)	Comment
B00B - R1014 - General Learning Space - Type 1 - (58.05 SQM) - Teaching Space: 1	Student Space (26)	
B00B - R1016 - Performance Workshop - (106.55 SQM)	Student Space (49)	
B00C - R0001 - General Learning Space - (47.39 SQM) - Teaching Space: 1	Student Space (21)	
B00C - R0002 - General Learning Space - (47.88 SQM) - Teaching Space: 1	Student Space (22)	
B00C - R0003 - General Learning Space - (47.63 SQM) - Teaching Space: 1	Student Space (22)	
B00C - R0004 - General Learning Space - (47.51 SQM) - Teaching Space: 1	Student Space (22)	
B00C - R0005 - General Learning Space - (47.63 SQM) - Teaching Space: 1	Student Space (22)	
B00C - R0006 - General Learning Space - (47.63 SQM) - Teaching Space: 1	Student Space (22)	
B00C - R0007 - General Learning Space - (44.75 SQM) - Teaching Space: 1	Student Space (20)	
B00C - R0008 - General Learning Space - (39.25 SQM) - Teaching Space: 1	Student Space (18)	
B00C - R0009 - Study Space - (15.01 SQM)	Not Applicable	Circulation or storage space.
B00C - R0014 - Staff Study - (38.06 SQM)	Office (9)	
B00C - R0015 - Study Space - (15.98 SQM)	Not Applicable	Circulation or storage space.
B00C - R0016 - General Learning Space - (47.03 SQM) - Teaching Space: 1	Student Space (21)	
B00C - R0017 - Movement - (147.54 SQM)	Not Applicable	Circulation or storage space.
B00C - R0019 - Movement - (125.34 SQM)	Not Applicable	Circulation or storage space.
B00C - R1001 - Computer Learning Space - (59.51 SQM) - Teaching Space: 1	Student Space (27)	
B00C - R1004 - Staff Study - (52.51 SQM)	Office (13)	
B00C - R1007 - Main Area - (403.49 SQM)	Not Applicable	Circulation or storage space.
B00C - R1008 - Seminar - (13.57 SQM)	Office (3)	
B00C - R1009 - Seminar - (13.29 SQM)	Office (3)	
B00C - R1010 - Seminar - (13.3 SQM)	Office (3)	
B00C - R1011 - Workroom - (37.16 SQM)	Office (9)	
B00C - R1014 - Study Space - (34.92 SQM)	Not Applicable	Circulation or storage space.
B00C - R1015 - Movement - (5.24 SQM)	Not Applicable	Circulation or storage space.
B00C - R1019 - Movement - (121.32 SQM)	Not Applicable	Circulation or storage space.
B00C - R9003 - Movement - (920.65 SQM)	Not Applicable	Circulation or storage space.
B00D - R0004 - Student Canteen - (49.84 SQM)	Not Applicable	Circulation or storage space.
B00D - R0008 - Movement - (388.03 SQM)	Not Applicable	Circulation or storage space.
B00D - R1001 - Laboratory L.S. - (96.97 SQM) - Teaching Space: 1	Student Space (44)	
B00D - R1002 - Laboratory L.S. - (96.97 SQM) - Teaching Space: 1	Student Space (44)	
B00D - R1006 - Movement - (5.72 SQM)	Not Applicable	Circulation or storage space.
B00D - R1008 - Preparation - (48.9 SQM)	Not Applicable	Circulation or storage space.
B00D - R1010 - Staff Study - (54.61 SQM)	Office (13)	
B00D - R1011 - Movement - (72.39 SQM)	Not Applicable	Circulation or storage space.
B00D - R2001 - Laboratory L.S. - (102.89 SQM) - Teaching Space: 1	Student Space (47)	
B00D - R2002 - Laboratory L.S. - (97.96 SQM) - Teaching Space: 1	Student Space (45)	
B00D - R2005 - Preparation - (42.96 SQM)	Not Applicable	Circulation or storage space.
B00D - R2007 - Movement - (7.21 SQM)	Not Applicable	Circulation or storage space.
B00D - R2012 - Serviced Learning Space - (71.56 SQM) - Teaching Space: 1	Student Space (33)	
B00D - R2013 - Movement - (56.39 SQM)	Not Applicable	Circulation or storage space.
B00E - R0001 - Ancillary Staff - (22.75 SQM)	Office (5)	
B00E - R0004 - Staff Study - (9.18 SQM)	Office (2)	
B00E - R0005 - Commonroom - (97.58 SQM)	Office (24)	
B00E - R0006 - Public Entry - (66.09 SQM)	Not Applicable	Circulation or storage space.
B00E - R0007 - Movement - (80.75 SQM)	Not Applicable	Circulation or storage space.
B00E - R0008 - Principal Office - (30.97 SQM)	Office (7)	
B00E - R0009 - Interview/Meeting - (35.04 SQM)	Office (8)	
B00E - R0010 - Duplicating Workroom - (57.95 SQM)	Office (14)	
B00E - R0011 - Teachers Aides - (13.21 SQM)	Office (3)	

Entity Location	Audit Condition Classification (Capacity)	Comment
B00E - R0013 - Administration - Clerical - (56.82 SQM)	Office (14)	
B00E - R0015 - Clinic - Boys - (13.51 SQM)	Office (3)	
B00E - R0018 - Clinic - Girls - (13.51 SQM)	Office (3)	
B00E - R0019 - Interview/Office - Type 1 - (12.95 SQM)	Office (3)	
B00E - R0021 - Deputy Principal Office - (19.49 SQM)	Office (4)	
B00E - R0022 - Leading Teacher - (15.4 SQM)	Office (3)	
B00E - R0023 - Movement - (59.78 SQM)	Not Applicable	Circulation or storage space.
B00E - R9002 - Staff Study - (22.17 SQM)	Office (5)	
B00E - R9005 - Movement - (8.38 SQM)	Not Applicable	Circulation or storage space.
B00F - R0004 - Welding/Hot Metals Area - (7.41 SQM)	Not Applicable	Circulation or storage space.
B00F - R0005 - Metal Technology L.S. - (110.66 SQM) - Teaching Space: 1	Student Space (51)	
B00F - R0006 - Materials Technology L.S. - (83.21 SQM) - Teaching Space: 1	Student Space (38)	
B00F - R0007 - Welding Area - (15.94 SQM)	Not Applicable	Circulation or storage space.
B00F - R0009 - Movement - (59.29 SQM)	Not Applicable	Circulation or storage space.
B00F - R0010 - Movement - (81.17 SQM)	Not Applicable	Circulation or storage space.
B00F - R0011 - General Learning Space - (54.83 SQM) - Teaching Space: 1	Student Space (25)	
B00F - R0012 - General Learning Space - (55.81 SQM) - Teaching Space: 1	Student Space (25)	
B00F - R0013 - General Learning Space - (54.63 SQM) - Teaching Space: 1	Student Space (25)	
B00F - R0016 - Movement - (5.1 SQM)	Not Applicable	Circulation or storage space.
B00F - R1002 - Wood Technology L.S. - (90.14 SQM) - Teaching Space: 1	Student Space (41)	
B00F - R1003 - Wood Technology Bay - (35.3 SQM)	Not Applicable	Circulation or storage space.
B00F - R1006 - Wood Technology L.S. - (82.93 SQM) - Teaching Space: 1	Student Space (38)	
B00F - R1008 - Movement - (54.64 SQM)	Not Applicable	Circulation or storage space.
B00F - R1009 - Movement - (57.27 SQM)	Not Applicable	Circulation or storage space.
B00F - R1010 - Interview/Office - Type 1 - (19.86 SQM)	Office (4)	
B00F - R1011 - General Learning Space - (55.08 SQM) - Teaching Space: 1	Student Space (25)	
B00F - R1012 - Staff Study - (55.82 SQM)	Office (13)	
B00F - R1013 - General Learning Space - (54.68 SQM) - Teaching Space: 1	Student Space (25)	
B00F - R2002 - Food Technology L.S. - (117.85 SQM) - Teaching Space: 1	Student Space (54)	
B00F - R2003 - Food/Research Space - (19.99 SQM)	Not Applicable	Circulation or storage space.
B00F - R2005 - Food Technology L.S. - (115.28 SQM) - Teaching Space: 1	Student Space (53)	
B00F - R2006 - Movement - (54.61 SQM)	Not Applicable	Circulation or storage space.
B00F - R2007 - Movement - (57.9 SQM)	Not Applicable	Circulation or storage space.
B00F - R2010 - Computer Learning Space - (57.63 SQM) - Teaching Space: 1	Student Space (26)	
B00F - R2011 - Textiles Technology L.S. - (77.02 SQM) - Teaching Space: 1	Student Space (35)	
B00F - R2012 - Staff Study - (39.38 SQM)	Office (9)	
B00F - R9002 - Workshop - (39.22 SQM)	Student Space (18)	
B00G - R0001 - General Learning Space - (47.14 SQM) - Teaching Space: 1	Student Space (21)	
B00G - R0002 - General Learning Space - (45.24 SQM) - Teaching Space: 1	Student Space (20)	
B00G - R0003 - Movement - (18.43 SQM)	Not Applicable	Circulation or storage space.
B00G - R0008 - Staff Study - (19.88 SQM)	Office (4)	
B00G - R0013 - Movement - (45.61 SQM)	Not Applicable	Circulation or storage space.
B00G - R0014 - Gymnasium - (447.89 SQM)	Student Space (207)	
B00G - R0015 - Movement - (26.56 SQM)	Not Applicable	Circulation or storage space.
B00G - R0018 - Movement - (15.41 SQM)	Not Applicable	Circulation or storage space.
B00H - R0002 - Movement - (21.48 SQM)	Not Applicable	Circulation or storage space.
B00H - R0009 - Movement - (7.58 SQM)	Not Applicable	Circulation or storage space.
B00H - R0015 - Movement - (29.98 SQM)	Not Applicable	Circulation or storage space.
B00H - R0016 - Seminar - (29.18 SQM)	Office (7)	
B00H - R0017 - Staff Study - (28.19 SQM)	Office (7)	

Entity Location	Audit Condition Classification (Capacity)	Comment
B00H - R0021 - Performance Workspace - (134.26 SQM) - Teaching Space: 1	● Student Space (62)	
B00H - R0022 - Performance Workspace - (151.45 SQM) - Teaching Space: 1	● Student Space (70)	
B00H - R0025 - Movement - (5.84 SQM)	Not Applicable	Circulation or storage space.
B00H - R0030 - Movement - (12.18 SQM)	Not Applicable	Circulation or storage space.
B00H - R0032 - Movement - (7.73 SQM)	Not Applicable	Circulation or storage space.
B00H - R1001 - Movement - (5.1 SQM)	Not Applicable	Circulation or storage space.
B00H - R1002 - Public Entry - (27.14 SQM)	Not Applicable	Circulation or storage space.
B00H - R1006 - Multi-Purpose Space - (383.39 SQM)	● Student Space (177)	
B00H - R1008 - Stage - (61.45 SQM)	Not Applicable	Circulation or storage space.
B00H - R1010 - Movement - (6.61 SQM)	Not Applicable	Circulation or storage space.
B00H - R1019 - Stage - (63.5 SQM)	Not Applicable	Circulation or storage space.
B00H - R2001 - Staff Kitchen - (8.42 SQM)	● Office (2)	
B00H - R2002 - Public Entry - (79.64 SQM)	Not Applicable	Circulation or storage space.
B00H - R3001 - Practice/Seminar - (58.62 SQM)	Not Applicable	Circulation or storage space.
B00H - R3002 - Movement - (19.65 SQM)	Not Applicable	Circulation or storage space.
B00H - R3006 - Practice/Seminar - (122.27 SQM)	Not Applicable	Circulation or storage space.
OS 600 13209 - OS 600 13209 - Learning Unit - Small - (57 SQM)	● Student Space (26)	
OS 600 13941 - OS 600 13941 - Learning Unit - Small - (57 SQM)	● Student Space (26)	
OS 600 17834 - OS 600 17834 - Learning Unit - Small - (57 SQM)	● Student Space (26)	
OS 600 18185 - OS 600 18185 - Learning Unit - Small - (57 SQM)	● Student Space (26)	
OS 600 19616 - OS 600 19616 - Learning Unit - Small - (57 SQM)	● Student Space (26)	
OS 601 11323 - OS 601 11323 - Learning Unit - Standard/Withdrawal - (76 SQM)	● Student Space (35)	