

VENTILATION AUDIT REPORT

SCHOOL:	Newport Public School (2740)
AMU REGION:	Northern Sydney
STATE ELECTORATE:	Pittwater
LOCAL GOVERNMENT AREA:	Northern Beaches

2740 - Newport Public School
Site Plan (11299)

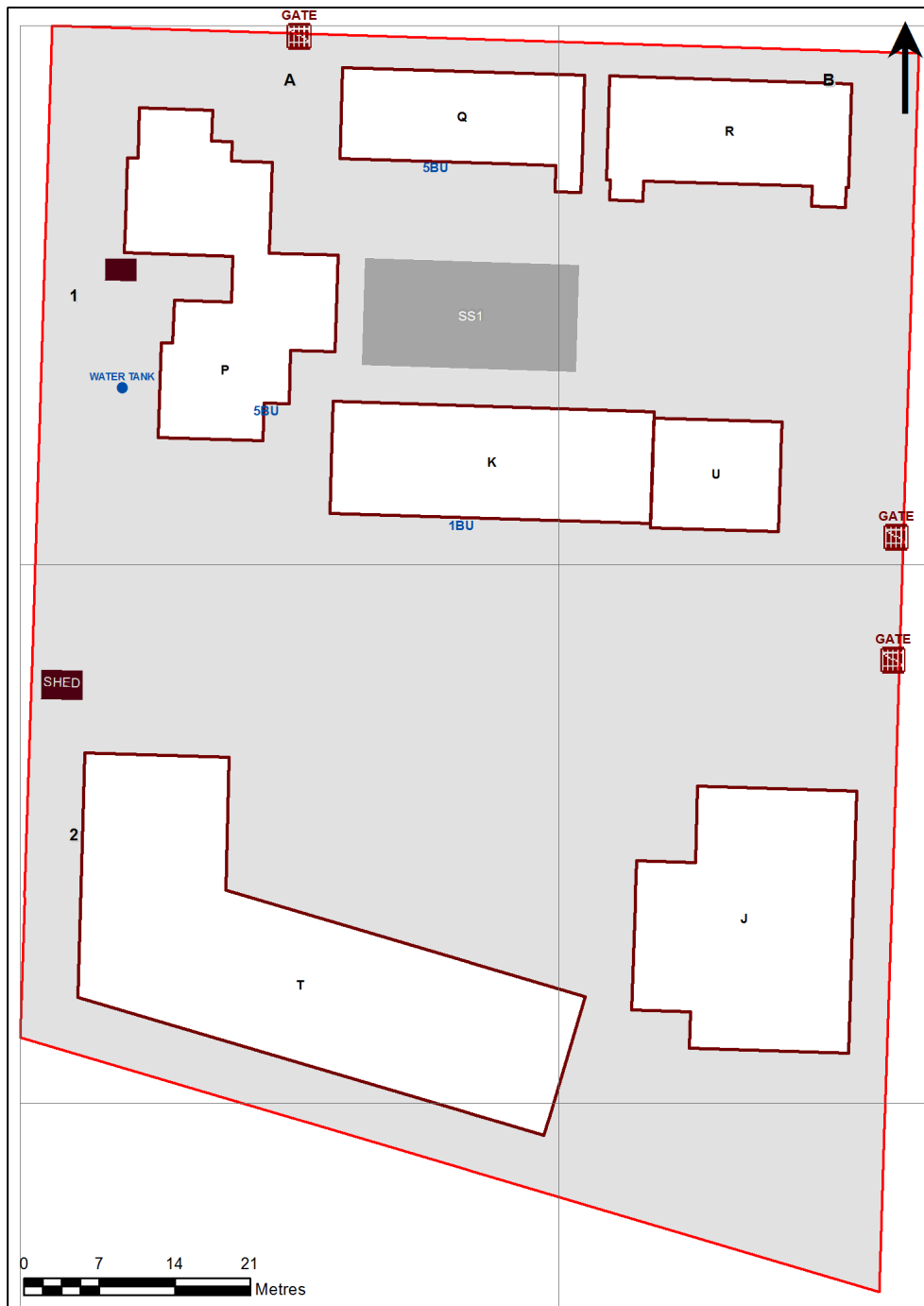







1:440

Printed: 09-Sep-2021

Ventilation Audit Key

Category	Description
	Category A Operate this space in line with COVID safe school operations . It has the required level of natural ventilation. NB. Circulation and storage areas should not be used for groups or gatherings.
	Category B This space should be occupied at 1 person per 4m ² to comply with COVID safe school operations and the guided use of spaces . The report details the number of people who can be accommodated safely in each of the identified spaces.

Entity Location	Audit Condition Classification (Capacity)	Comment
B00A - R0001 - Home Base - (57 SQM) - Teaching Space: 1	● Student Space (26)	
B00A - R0004 - Practical Activities - 1hb - (11.55 SQM)	● Student Space (5)	
B00A - R0005 - Movement - (6.12 SQM)	Not Applicable	Circulation or storage space.
B00B - R0006 - Movement - (8.28 SQM)	Not Applicable	Circulation or storage space.
B00B - R0012 - Home Base - (56.56 SQM) - Teaching Space: 1	● Student Space (26)	
B00B - R0014 - Home Base - (57.08 SQM) - Teaching Space: 1	● Student Space (26)	
B00D - R0004 - Staff Room Annexe - (9.4 SQM)	● Office (2)	
B00D - R0008 - Clerical Office - (12.64 SQM)	● Office (3)	
B00D - R0009 - Duplicating Workroom - (15.6 SQM)	● Office (3)	
B00D - R0010 - Principal - (15.89 SQM)	● Office (3)	
B00D - R0013 - Deputy Principal - (10.68 SQM)	● Office (2)	
B00D - R0017 - Sick Bay - (8.1 SQM)	● Student Space (3)	
B00D - R0021 - Staff Room Annexe - (26.22 SQM)	● Office (6)	
B00D - R0023 - Staff Room - (39.86 SQM)	● Office (9)	
B00D - R0024 - Staff Kitchen - (24.53 SQM)	● Office (6)	
B00D - R0028 - Movement - (13.86 SQM)	Not Applicable	Circulation or storage space.
B00D - R0031 - Entry Vestibule - (19.67 SQM)	Not Applicable	Circulation or storage space.
B00D - R0032 - Clerical Office - (8.15 SQM)	● Office (2)	
B00D - R0033 - Deputy Principal - Type 1 - (10.1 SQM)	● Office (2)	
B00E - R0004 - Home Base - (56.97 SQM) - Teaching Space: 1	● Student Space (26)	
B00E - R0007 - Movement - (6.99 SQM)	Not Applicable	Circulation or storage space.
B00E - R0010 - Home Base - (57.52 SQM) - Teaching Space: 1	● Student Space (26)	
B00E - R0011 - Home Base - (57.52 SQM) - Teaching Space: 1	● Student Space (26)	
B00E - R0014 - Movement - (6.82 SQM)	Not Applicable	Circulation or storage space.
B00E - R0018 - Home Base - (56.97 SQM) - Teaching Space: 1	● Student Space (26)	
B00F - R0001 - Special Programs Room - (69.9 SQM)	● Student Space (32)	
B00F - R0004 - Withdrawal Space - 1hb - (42.58 SQM)	● Student Space (19)	
B00H - R0002 - Practical Activities - 1hb - (19.4 SQM)	● Student Space (9)	
B00H - R0004 - Home Base - (59.2 SQM) - Teaching Space: 1	● Student Space (27)	
B00H - R0005 - Withdrawal Space - 2hb - (11.35 SQM)	● Student Space (5)	
B00H - R0006 - Home Base - (59.19 SQM) - Teaching Space: 1	● Student Space (27)	
B00H - R0008 - Practical Activities - 1hb - (19.4 SQM)	● Student Space (9)	
B00I - R0001 - Reading Area - (220.06 SQM)	● Student Space (102)	
B00I - R0003 - Movement - (10.82 SQM)	Not Applicable	Circulation or storage space.
B00I - R0006 - Special Programs Room - (36.12 SQM)	● Student Space (16)	
B00I - R1001 - Home Base - (58.51 SQM) - Teaching Space: 1	● Student Space (27)	
B00I - R1002 - Home Base - (60.44 SQM) - Teaching Space: 1	● Student Space (28)	
B00I - R1003 - Home Base - (60.21 SQM) - Teaching Space: 1	● Student Space (27)	
B00I - R1004 - Practical Activities - 1hb - (15.44 SQM)	● Student Space (7)	
B00I - R1005 - Withdrawal Space - 1hb - (9.2 SQM)	● Student Space (4)	
B00I - R1008 - Practical Activities - 1hb - (14.25 SQM)	● Student Space (6)	
B00I - R1009 - Withdrawal Space - 2hb - (11.63 SQM)	● Student Space (5)	
B00I - R1010 - Practical Activities - 1hb - (14.22 SQM)	● Student Space (6)	
B00J - R0002 - Staff Kitchen - (21.97 SQM)	● Office (5)	
B00J - R0008 - Raised Platform - (35.7 SQM)	Not Applicable	Circulation or storage space.
B00J - R0011 - Communal Space - (227.65 SQM)	● Student Space (105)	
B00K - R0003 - Home Base - (56.81 SQM) - Teaching Space: 1	● Student Space (26)	
B00K - R0004 - Home Base - (56.81 SQM) - Teaching Space: 1	● Student Space (26)	

Entity Location	Audit Condition Classification (Capacity)	Comment
B00K - R0008 - Entry Vestibule - (17.72 SQM)	Not Applicable	Circulation or storage space.
B00K - R0009 - Clerical Office - (15.01 SQM)	 Office (3)	
B00K - R0012 - Duplicating Workroom - (21.54 SQM)	 Office (5)	
B00K - R0013 - Staff Room - (28.37 SQM)	 Office (7)	
B00P - R0001 - Home Base - (82.15 SQM) - Teaching Space: 1	 Student Space (38)	
B00P - R0004 - Practical Activities - 1hb - (18.91 SQM)	 Student Space (8)	
B00P - R0008 - Home Base - (62.54 SQM) - Teaching Space: 1	 Student Space (29)	
B00P - R0009 - Practical Activities - 1hb - (12.34 SQM)	 Student Space (5)	
B00P - R0011 - Movement - (11.02 SQM)	Not Applicable	Circulation or storage space.
B00Q - R0004 - Home Base - (56.96 SQM) - Teaching Space: 1	 Student Space (26)	
B00Q - R0005 - Home Base - (85.72 SQM) - Teaching Space: 1	 Student Space (39)	
B00R - R0002 - Movement - (7.01 SQM)	Not Applicable	Circulation or storage space.
B00R - R0004 - Home Base - (98.36 SQM) - Teaching Space: 1	 Student Space (45)	
B00R - R0005 - Home Base - (67.54 SQM) - Teaching Space: 1	 Student Space (31)	
B00T - R0001 - Home Base - (61.33 SQM) - Teaching Space: 1	 Student Space (28)	
B00T - R0003 - Practical Activities - 1hb - (19.12 SQM)	 Student Space (8)	
B00T - R0004 - Withdrawal Space - 2hb - (11.73 SQM)	 Student Space (5)	
B00T - R0005 - Practical Activities - 1hb - (18.6 SQM)	 Student Space (8)	
B00T - R0006 - Home Base - (61.25 SQM) - Teaching Space: 1	 Student Space (28)	
B00T - R0009 - Home Base - (61.33 SQM) - Teaching Space: 1	 Student Space (28)	
B00T - R0010 - Practical Activities - 1hb - (18.64 SQM)	 Student Space (8)	
B00T - R0011 - Withdrawal Space - 2hb - (11.74 SQM)	 Student Space (5)	
B00T - R0012 - Practical Activities - 1hb - (19.09 SQM)	 Student Space (8)	
B00T - R0014 - Home Base - (61.25 SQM) - Teaching Space: 1	 Student Space (28)	
B00T - R0015 - Practical Activities - 1hb - (22.58 SQM)	 Student Space (10)	
B00T - R0016 - Home Base - (55.82 SQM) - Teaching Space: 1	 Student Space (25)	
B00T - R0017 - Withdrawal Space - 1hb - (9.51 SQM)	 Student Space (4)	
B00T - R0022 - Practical Activities - 1hb - (25.18 SQM)	 Student Space (11)	
B00T - R0023 - Withdrawal Space - 1hb - (9.07 SQM)	 Student Space (4)	
B00T - R0024 - Home Base - (59.62 SQM) - Teaching Space: 1	 Student Space (27)	
B00U - R0001 - Canteen - (45.67 SQM)	Not Applicable	Circulation or storage space.
OS 520 16631 - OS 520 16631 - Staff Study - (57 SQM)	 Office (14)	
OS 601 11036 - OS 601 11036 - Learning Unit - Standard/Withdrawal - (76 SQM)	 Student Space (35)	
OS 602 12880 - OS 602 12880 - Learning Unit - Standard With P.A.A. - (76 SQM)	 Student Space (35)	
OS 602 14192 - OS 602 14192 - Learning Unit - Standard With P.A.A. - (76 SQM)	 Student Space (35)	
OS 603 12053 - OS 603 12053 - Learning Unit - Standard With P.A.A. A/C - (76 SQM)	 Student Space (35)	
OS 603 14768 - OS 603 14768 - Learning Unit - Standard With P.A.A. A/C - (76 SQM)	 Student Space (35)	
OS 603 15612 - OS 603 15612 - Learning Unit - Standard With P.A.A. A/C - (76 SQM)	 Student Space (35)	