

# VENTILATION AUDIT REPORT

<b>SCHOOL:</b>	<b>Narara Public School (2703)</b>
<b>AMU REGION:</b>	<b>Hunter/Central Coast</b>
<b>STATE ELECTORATE:</b>	<b>The Entrance</b>
<b>LOCAL GOVERNMENT AREA:</b>	<b>Central Coast</b>

2703 - Narara Public School  
Site Plan (10499)

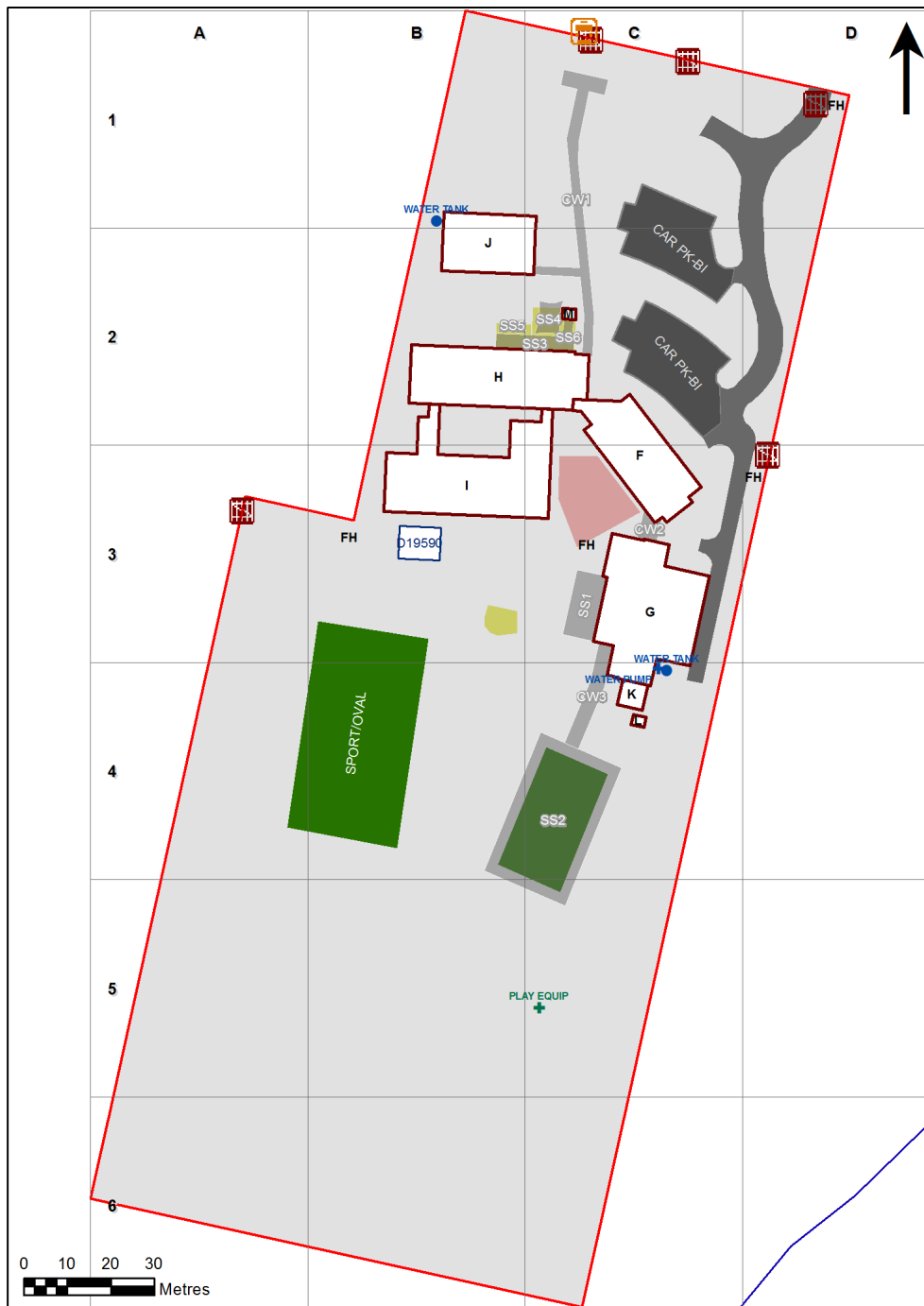

1:1,090

Printed: 12-Dec-2020

## Ventilation Audit Key

Category	Description
	Category A Operate this space in line with <a href="#">COVID safe school operations</a> . It has the required level of natural ventilation. NB. Circulation and storage areas should not be used for groups or gatherings.
	Category B This space should be occupied at 1 person per 4m <sup>2</sup> to comply with <a href="#">COVID safe school operations and the guided use of spaces</a> . The report details the number of people who can be accommodated safely in each of the identified spaces.

Entity Location	Audit Condition Classification (Capacity)	Comment
B00F - R0001 - Entry Vestibule - (13.63 SQM)	Not Applicable	Circulation or storage space.
B00F - R0002 - Clerical Office - (21.96 SQM)	Office (5)	
B00F - R0003 - Duplicating Workroom - (19.38 SQM)	Office (4)	
B00F - R0005 - Sick Bay - (8.79 SQM)	Student Space (4)	
B00F - R0007 - Principal - (16.94 SQM)	Office (4)	
B00F - R0009 - Staff Room - (46.75 SQM)	Office (11)	
B00F - R0010 - Staff Room Annexe - (20.04 SQM)	Office (5)	
B00F - R0014 - Deputy Principal - (13.26 SQM)	Office (3)	
B00F - R0015 - Deputy Principal - (13.45 SQM)	Office (3)	
B00F - R0016 - Interview - (13.41 SQM)	Office (3)	
B00F - R0017 - Movement - (33.99 SQM)	Not Applicable	Circulation or storage space.
B00F - R0019 - Movement - (91.17 SQM)	Not Applicable	Circulation or storage space.
B00F - R1001 - Movement - (51.62 SQM)	Not Applicable	Circulation or storage space.
B00F - R1007 - Special Programs Room - (34.26 SQM)	Student Space (15)	
B00F - R1008 - Reading Area - (160.78 SQM)	Student Space (74)	
B00F - R1011 - Movement - (5.5 SQM)	Not Applicable	Circulation or storage space.
B00G - R0002 - Canteen - (26.41 SQM)	Not Applicable	Circulation or storage space.
B00G - R0006 - Movement - (6.31 SQM)	Not Applicable	Circulation or storage space.
B00G - R0007 - Movement - (10.44 SQM)	Not Applicable	Circulation or storage space.
B00G - R0008 - Raised Platform - (54.53 SQM)	Not Applicable	Circulation or storage space.
B00G - R0010 - Movement - (10.6 SQM)	Not Applicable	Circulation or storage space.
B00G - R0012 - Movement - (6.61 SQM)	Not Applicable	Circulation or storage space.
B00G - R0016 - Communal Space - (130.69 SQM)	Student Space (60)	
B00G - R9004 - Movement - (6.93 SQM)	Not Applicable	Circulation or storage space.
B00H - R0002 - Home Base - (55.74 SQM) - Teaching Space: 1	Student Space (25)	
B00H - R0004 - Practical Activities - 1hb - (20.97 SQM)	Student Space (9)	
B00H - R0005 - Withdrawal Space - 1hb - (11.47 SQM)	Student Space (5)	
B00H - R0006 - Home Base - (55.95 SQM) - Teaching Space: 1	Student Space (25)	
B00H - R0007 - Practical Activities - 1hb - (19.78 SQM)	Student Space (9)	
B00H - R0012 - Home Base - (55.77 SQM) - Teaching Space: 1	Student Space (25)	
B00H - R0013 - Withdrawal Space - 1hb - (5.57 SQM)	Student Space (2)	
B00H - R0015 - Practical Activities - 1hb - (19.79 SQM)	Student Space (9)	
B00H - R0019 - Practical Activities - E - (24.94 SQM)	Student Space (11)	
B00H - R0020 - Movement - (79.47 SQM)	Not Applicable	Circulation or storage space.
B00H - R0022 - Outdoor Learning Area - (96.1 SQM)	Not Applicable	Circulation or storage space.
B00H - R0023 - Outdoor Learning Area - (38.1 SQM)	Not Applicable	Circulation or storage space.
B00H - R0024 - Movement - (32.68 SQM)	Not Applicable	Circulation or storage space.
B00H - R0025 - Home Base - (52.73 SQM) - Teaching Space: 1	Student Space (24)	
B00H - R1002 - Home Base - (56.18 SQM) - Teaching Space: 1	Student Space (26)	
B00H - R1004 - Practical Activities - 1hb - (21.04 SQM)	Student Space (9)	
B00H - R1005 - Withdrawal Space - 1hb - (11.41 SQM)	Student Space (5)	
B00H - R1006 - Home Base - (55.97 SQM) - Teaching Space: 1	Student Space (25)	
B00H - R1008 - Practical Activities - 1hb - (20.39 SQM)	Student Space (9)	
B00H - R1011 - Practical Activities - 1hb - (20.46 SQM)	Student Space (9)	
B00H - R1013 - Home Base - (56.02 SQM) - Teaching Space: 1	Student Space (25)	
B00H - R1015 - Withdrawal Space - 1hb - (11.47 SQM)	Student Space (5)	
B00H - R1016 - Home Base - (56.14 SQM) - Teaching Space: 1	Student Space (26)	
B00H - R1018 - Practical Activities - 1hb - (21.08 SQM)	Student Space (9)	
B00H - R1020 - Movement - (88.04 SQM)	Not Applicable	Circulation or storage space.

Entity Location	Audit Condition Classification (Capacity)	Comment
B00I - R0001 - Practical Activities - 1hb - (21.05 SQM)	● Student Space (9)	
B00I - R0003 - Home Base - (55.81 SQM) - Teaching Space: 1	● Student Space (25)	
B00I - R0005 - Withdrawal Space - 1hb - (11.4 SQM)	● Student Space (5)	
B00I - R0006 - Home Base - (55.79 SQM) - Teaching Space: 1	● Student Space (25)	
B00I - R0008 - Practical Activities - 1hb - (20.34 SQM)	● Student Space (9)	
B00I - R0011 - Practical Activities - 1hb - (20.34 SQM)	● Student Space (9)	
B00I - R0013 - Home Base - (55.75 SQM) - Teaching Space: 1	● Student Space (25)	
B00I - R0015 - Withdrawal Space - 1hb - (5.56 SQM)	● Student Space (2)	
B00I - R0021 - Movement - (162.61 SQM)	Not Applicable	Circulation or storage space.
B00I - R0027 - Movement - (15.99 SQM)	Not Applicable	Circulation or storage space.
B00I - R0028 - Movement - (26.07 SQM)	Not Applicable	Circulation or storage space.
B00I - R1001 - Practical Activities - 1hb - (21 SQM)	● Student Space (9)	
B00I - R1003 - Home Base - (56.13 SQM) - Teaching Space: 1	● Student Space (26)	
B00I - R1005 - Withdrawal Space - 1hb - (11.44 SQM)	● Student Space (5)	
B00I - R1006 - Home Base - (56.5 SQM) - Teaching Space: 1	● Student Space (26)	
B00I - R1008 - Practical Activities - 1hb - (20.68 SQM)	● Student Space (9)	
B00I - R1011 - Practical Activities - 1hb - (20.3 SQM)	● Student Space (9)	
B00I - R1013 - Home Base - (56.1 SQM) - Teaching Space: 1	● Student Space (26)	
B00I - R1015 - Withdrawal Space - 1hb - (11.4 SQM)	● Student Space (5)	
B00I - R1016 - Home Base - (56.01 SQM) - Teaching Space: 1	● Student Space (25)	
B00I - R1018 - Practical Activities - 1hb - (21.11 SQM)	● Student Space (9)	
B00I - R1020 - Movement - (130.47 SQM)	Not Applicable	Circulation or storage space.
B00I - R1022 - Movement - (15.86 SQM)	Not Applicable	Circulation or storage space.
B00I - R1023 - Movement - (27.85 SQM)	Not Applicable	Circulation or storage space.
B00J - R0001 - Practical Activities - 1hb - (18.88 SQM)	● Student Space (8)	
B00J - R0003 - Home Base - (61.17 SQM) - Teaching Space: 1	● Student Space (28)	
B00J - R0004 - Withdrawal Space - 2hb - (11.61 SQM)	● Student Space (5)	
B00J - R0005 - Home Base - (61.17 SQM) - Teaching Space: 1	● Student Space (28)	
B00J - R0007 - Practical Activities - 1hb - (19.06 SQM)	● Student Space (8)	
OS 606 19590 - OS 606 19590 - Learning Unit - Standard With P.A.A A/C - (76 SQM)	● Student Space (35)	