

VENTILATION AUDIT REPORT

SCHOOL:	Mount Terry Public School (4610)
AMU REGION:	Southern NSW
STATE ELECTORATE:	Kiama
LOCAL GOVERNMENT AREA:	Shellharbour

4610 - Mount Terry Public School
Site Plan (13604)

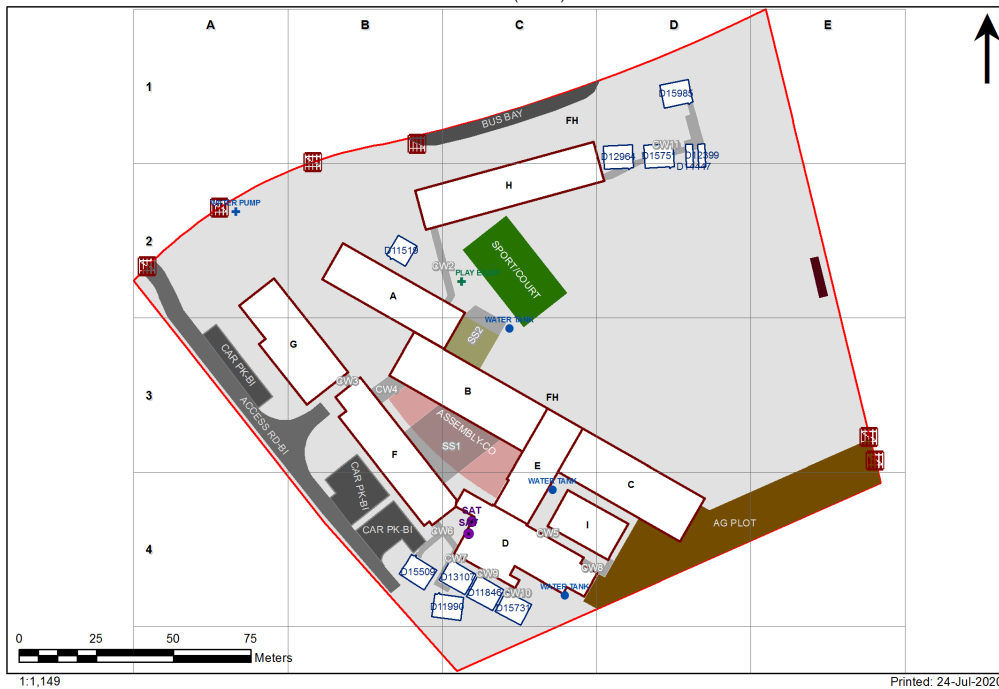

1:1,149







Printed: 24-Jul-2020

Ventilation Audit Key

Category	Description
	Category A Operate this space in line with COVID safe school operations . It has the required level of natural ventilation. NB. Circulation and storage areas should not be used for groups or gatherings.
	Category B This space should be occupied at 1 person per 4m ² to comply with COVID safe school operations and the guided use of spaces . The report details the number of people who can be accommodated safely in each of the identified spaces.

Entity Location	Audit Condition Classification (Capacity)	Comment
B00A - R0001 - Movement - (182.5 SQM)	Not Applicable	Circulation or storage space.
B00A - R0007 - Staff Room Annexe - (24.89 SQM)	Office (6)	
B00A - R0009 - Movement - (36.05 SQM)	Not Applicable	Circulation or storage space.
B00A - R0010 - Deputy Principal - (12.74 SQM)	Office (3)	
B00A - R0011 - Interview - (13.12 SQM)	Office (3)	
B00A - R0012 - Interview - (13.08 SQM)	Office (3)	
B00A - R0014 - Sick Bay - (8.57 SQM)	Student Space (3)	
B00A - R0015 - Clerical Office/Workroom - (17.57 SQM)	Office (4)	
B00A - R0016 - Entry Vestibule - (17.61 SQM)	Not Applicable	Circulation or storage space.
B00A - R0017 - Duplicating Workroom - (32.35 SQM)	Office (8)	
B00A - R0018 - Principal - (16.71 SQM)	Office (4)	
B00A - R0025 - Interview - (10.02 SQM)	Office (2)	
B00A - R0026 - Interview - (9.02 SQM)	Office (2)	
B00A - R0027 - Staff Room - (51.14 SQM)	Office (12)	
B00A - R0028 - Staff Kitchen - (7.46 SQM)	Office (1)	
B00B - R0001 - Withdrawal Space - 1hb - (5.78 SQM)	Student Space (2)	
B00B - R0003 - Practical Activities - 1hb - (26.97 SQM)	Student Space (12)	
B00B - R0004 - Home Base - (50.27 SQM) - Teaching Space: 1	Student Space (23)	
B00B - R0005 - Movement - (231.79 SQM)	Not Applicable	Circulation or storage space.
B00B - R0006 - Practical Activities - 1hb - (27.17 SQM)	Student Space (12)	
B00B - R0007 - Home Base - (50.34 SQM) - Teaching Space: 1	Student Space (23)	
B00B - R0009 - Withdrawal Space - 1hb - (5.81 SQM)	Student Space (2)	
B00B - R0010 - Practical Activities - 1hb - (27.29 SQM)	Student Space (12)	
B00B - R0012 - Withdrawal Space - 1hb - (5.76 SQM)	Student Space (2)	
B00B - R0013 - Home Base - (51.06 SQM) - Teaching Space: 1	Student Space (23)	
B00B - R0014 - Practical Activities - 1hb - (25.74 SQM)	Student Space (11)	
B00B - R0015 - Home Base - (50.42 SQM) - Teaching Space: 1	Student Space (23)	
B00B - R0016 - Withdrawal Space - 1hb - (5.6 SQM)	Student Space (2)	
B00C - R0001 - Withdrawal Space - 1hb - (5.79 SQM)	Student Space (2)	
B00C - R0003 - Practical Activities - 1hb - (27.3 SQM)	Student Space (12)	
B00C - R0004 - Home Base - (50.41 SQM) - Teaching Space: 1	Student Space (23)	
B00C - R0005 - Movement - (125.98 SQM)	Not Applicable	Circulation or storage space.
B00C - R0006 - Practical Activities - 1hb - (27.21 SQM)	Student Space (12)	
B00C - R0007 - Home Base - (50.62 SQM) - Teaching Space: 1	Student Space (23)	
B00C - R0009 - Withdrawal Space - 1hb - (5.76 SQM)	Student Space (2)	
B00C - R0010 - Practical Activities - 1hb - (27.08 SQM)	Student Space (12)	
B00C - R0012 - Withdrawal Space - 1hb - (5.78 SQM)	Student Space (2)	
B00C - R0013 - Home Base - (50.83 SQM) - Teaching Space: 1	Student Space (23)	
B00C - R0014 - Practical Activities - 1hb - (26 SQM)	Student Space (12)	
B00C - R0015 - Home Base - (50.7 SQM) - Teaching Space: 1	Student Space (23)	
B00C - R0016 - Withdrawal Space - 1hb - (5.6 SQM)	Student Space (2)	
B00D - R0002 - Practical Activities - 1hb - (26.86 SQM)	Student Space (12)	
B00D - R0004 - Withdrawal Space - 1hb - (5.95 SQM)	Student Space (2)	
B00D - R0005 - Home Base - (50.41 SQM) - Teaching Space: 1	Student Space (23)	
B00D - R0007 - Home Base - (50.69 SQM) - Teaching Space: 1	Student Space (23)	
B00D - R0008 - Withdrawal Space - 1hb - (5.95 SQM)	Student Space (2)	
B00D - R0009 - Practical Activities - 1hb - (26.93 SQM)	Student Space (12)	

Entity Location	Audit Condition Classification (Capacity)	Comment
B00D - R0010 - Reading Area - (224.24 SQM)	● Student Space (104)	
B00D - R0015 - Special Programs Room - (52.3 SQM)	● Student Space (24)	
B00E - R0004 - Special Programs Room - (41.32 SQM)	● Student Space (19)	
B00E - R0005 - Movement - (20.11 SQM)	Not Applicable	Circulation or storage space.
B00E - R0006 - Movement - (20.3 SQM)	Not Applicable	Circulation or storage space.
B00E - R0007 - Movement - (347.4 SQM)	Not Applicable	Circulation or storage space.
B00F - R0002 - Practical Activities - 1hb - (27.22 SQM)	● Student Space (12)	
B00F - R0004 - Withdrawal Space - 1hb - (5.81 SQM)	● Student Space (2)	
B00F - R0005 - Home Base - (50.76 SQM) - Teaching Space: 1	● Student Space (23)	
B00F - R0006 - Practical Activities - 1hb - (27.05 SQM)	● Student Space (12)	
B00F - R0007 - Home Base - (50.55 SQM) - Teaching Space: 1	● Student Space (23)	
B00F - R0008 - Withdrawal Space - 1hb - (5.76 SQM)	● Student Space (2)	
B00F - R0010 - Practical Activities - 1hb - (27.36 SQM)	● Student Space (12)	
B00F - R0012 - Withdrawal Space - 1hb - (5.78 SQM)	● Student Space (2)	
B00F - R0013 - Home Base - (50.91 SQM) - Teaching Space: 1	● Student Space (23)	
B00F - R0014 - Practical Activities - 1hb - (25.87 SQM)	● Student Space (12)	
B00F - R0015 - Home Base - (50.77 SQM) - Teaching Space: 1	● Student Space (23)	
B00F - R0016 - Withdrawal Space - 1hb - (5.78 SQM)	● Student Space (2)	
B00F - R0019 - Canteen - (46.52 SQM)	Not Applicable	Circulation or storage space.
B00F - R0021 - Movement - (207.98 SQM)	Not Applicable	Circulation or storage space.
B00G - R0001 - Movement - (118.27 SQM)	Not Applicable	Circulation or storage space.
B00G - R0009 - Communal Space - (36.16 SQM)	● Student Space (16)	
B00G - R0012 - Communal Space - (220.98 SQM)	● Student Space (102)	
B00G - R0017 - Movement - (27.87 SQM)	Not Applicable	Circulation or storage space.
B00H - R0001 - Home Base - (60.74 SQM) - Teaching Space: 1	● Student Space (28)	
B00H - R0003 - Practical Activities - 1hb - (19.24 SQM)	● Student Space (8)	
B00H - R0005 - Withdrawal Space - 2hb - (11.64 SQM)	● Student Space (5)	
B00H - R0006 - Practical Activities - 1hb - (18.74 SQM)	● Student Space (8)	
B00H - R0008 - Home Base - (58.78 SQM) - Teaching Space: 1	● Student Space (27)	
B00H - R0010 - Home Base - (59.66 SQM) - Teaching Space: 1	● Student Space (27)	
B00H - R0012 - Practical Activities - 1hb - (18.64 SQM)	● Student Space (8)	
B00H - R0013 - Withdrawal Space - 2hb - (11.68 SQM)	● Student Space (5)	
B00H - R0014 - Practical Activities - 1hb - (19.22 SQM)	● Student Space (8)	
B00H - R0016 - Home Base - (60.58 SQM) - Teaching Space: 1	● Student Space (28)	
B00H - R0017 - Home Base - (60.33 SQM) - Teaching Space: 1	● Student Space (27)	
B00H - R0019 - Practical Activities - 1hb - (18.59 SQM)	● Student Space (8)	
B00H - R0020 - Withdrawal Space - 2hb - (11.74 SQM)	● Student Space (5)	
B00H - R0021 - Home Base - (60.84 SQM) - Teaching Space: 1	● Student Space (28)	
B00H - R0023 - Practical Activities - 1hb - (18.91 SQM)	● Student Space (8)	
B00H - R0024 - Movement - (5.59 SQM)	Not Applicable	Circulation or storage space.
B00H - R0025 - Special Programs Room - (33.77 SQM)	● Student Space (15)	
B00I - R0001 - Home Base - (61.31 SQM) - Teaching Space: 1	● Student Space (28)	
B00I - R0003 - Practical Activities - 1hb - (19.16 SQM)	● Student Space (8)	
B00I - R0004 - Withdrawal Space - 2hb - (11.64 SQM)	● Student Space (5)	
B00I - R0005 - Home Base - (61.31 SQM) - Teaching Space: 1	● Student Space (28)	
B00I - R0007 - Practical Activities - 1hb - (19.16 SQM)	● Student Space (8)	
OS 520 11519 - OS 520 11519 - Staff Study - (57 SQM)	● Office (14)	
OS 601 13107 - OS 601 13107 - Learning Unit - Standard/Withdrawal - (76 SQM)	● Student Space (35)	

Entity Location	Audit Condition Classification (Capacity)	Comment
OS 602 11846 - OS 602 11846 - Learning Unit - Standard With P.A.A. - (76 SQM)	 Student Space (35)	
OS 602 11990 - OS 602 11990 - Learning Unit - Standard With P.A.A. - (76 SQM)	 Student Space (35)	
OS 602 15751 - OS 602 15751 - Learning Unit - Standard With P.A.A. - (76 SQM)	 Student Space (35)	
OS 602 15985 - OS 602 15985 - Learning Unit - Standard With P.A.A. - (76 SQM)	 Student Space (35)	
OS 603 12964 - OS 603 12964 - Learning Unit - Standard With P.A.A. A/C - (76 SQM)	 Student Space (35)	
OS 603 15509 - OS 603 15509 - Learning Unit - Standard With P.A.A. A/C - (76 SQM)	 Student Space (35)	
OS 603 15731 - OS 603 15731 - Learning Unit - Standard With P.A.A. A/C - (76 SQM)	 Student Space (35)	