

VENTILATION AUDIT REPORT

SCHOOL:	Mount Austin High School (8407)
AMU REGION:	Southern NSW
STATE ELECTORATE:	Wagga Wagga
LOCAL GOVERNMENT AREA:	Wagga Wagga

8407 - Mount Austin High School
Site Plan (11208)

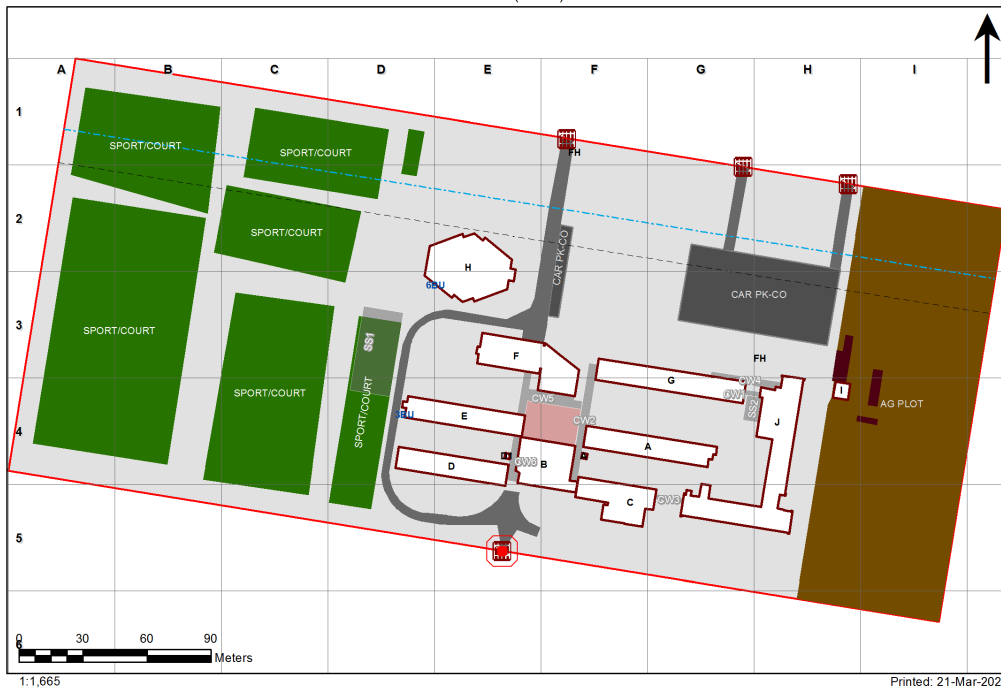

Ventilation Audit Key

Category	Description
	Category A Operate this space in line with COVID safe school operations . It has the required level of natural ventilation. NB. Circulation and storage areas should not be used for groups or gatherings.
	Category B This space should be occupied at 1 person per 4m ² to comply with COVID safe school operations and the guided use of spaces . The report details the number of people who can be accommodated safely in each of the identified spaces.

Entity Location	Audit Condition Classification (Capacity)	Comment
B00A - R0001 - Movement - (5.56 SQM)	Not Applicable	Circulation or storage space.
B00A - R0002 - Movement - (131.89 SQM)	Not Applicable	Circulation or storage space.
B00A - R0009 - Laboratory L.S. - (86.03 SQM) - Teaching Space: 1	● Student Space (39)	
B00A - R0010 - Staff Study - (25.8 SQM)	● Office (6)	
B00A - R0020 - Food Technology L.S. - (96.15 SQM) - Teaching Space: 1	● Student Space (44)	
B00A - R0026 - Preparation - Science - (36.69 SQM)	Not Applicable	Circulation or storage space.
B00A - R1001 - Movement - (130.65 SQM)	Not Applicable	Circulation or storage space.
B00A - R1004 - Music Learning Space - (66.29 SQM) - Teaching Space: 1	● Student Space (30)	
B00A - R1007 - Music Learning Space - (51.86 SQM) - Teaching Space: 1	● Student Space (24)	
B00A - R1008 - Music Learning Space - (52.48 SQM) - Teaching Space: 1	● Student Space (24)	
B00A - R1011 - General Learning Space - (51.82 SQM) - Teaching Space: 1	● Student Space (24)	
B00A - R1012 - General Learning Space - (58.48 SQM) - Teaching Space: 1	● Student Space (27)	
B00A - R1014 - Staff Study - (25.84 SQM)	● Office (6)	
B00A - R1018 - Practical Activities - (20.49 SQM)	● Student Space (9)	
B00A - R9005 - Movement - (24.57 SQM)	Not Applicable	Circulation or storage space.
B00B - R0001 - Movement - (334.14 SQM)	Not Applicable	Circulation or storage space.
B00B - R0006 - Student Canteen - (44.93 SQM)	Not Applicable	Circulation or storage space.
B00C - R0011 - Movement - (108.54 SQM)	Not Applicable	Circulation or storage space.
B00C - R0012 - Wood Technology Bay - (107.73 SQM)	Not Applicable	Circulation or storage space.
B00C - R0014 - Welding Area - (106.19 SQM)	Not Applicable	Circulation or storage space.
B00C - R0018 - Outdoor Workshop - (85.55 SQM)	Not Applicable	Circulation or storage space.
B00C - R1003 - General Learning Space - (39.29 SQM) - Teaching Space: 1	● Student Space (18)	
B00C - R1006 - Art Learning Space - (52.99 SQM) - Teaching Space: 1	● Student Space (24)	
B00C - R1007 - Art Learning Space - (53.13 SQM) - Teaching Space: 1	● Student Space (24)	
B00C - R1010 - Darkroom Space - (26.13 SQM)	● Office (6)	
B00C - R1013 - Movement - (80.89 SQM)	Not Applicable	Circulation or storage space.
B00C - R9004 - Movement - (26.87 SQM)	Not Applicable	Circulation or storage space.
B00D - R0006 - Laboratory L.S. - (91.01 SQM) - Teaching Space: 1	● Student Space (42)	
B00D - R0007 - Preparation - (27.6 SQM)	Not Applicable	Circulation or storage space.
B00D - R0008 - Staff Study - (9.35 SQM)	● Office (2)	
B00D - R0009 - Laboratory L.S. - (93.78 SQM) - Teaching Space: 1	● Student Space (43)	
B00D - R0010 - Staff Study - (25.75 SQM)	● Office (6)	
B00D - R0013 - Movement - (95.12 SQM)	Not Applicable	Circulation or storage space.
B00D - R0015 - Staff Study - (67.17 SQM)	● Office (16)	
B00D - R1001 - Movement - (111.43 SQM)	Not Applicable	Circulation or storage space.
B00D - R1004 - Performance Workspace - (67.01 SQM) - Teaching Space: 1	● Student Space (31)	
B00D - R1007 - General Learning Space - (52.41 SQM) - Teaching Space: 1	● Student Space (24)	
B00D - R1008 - General Learning Space - (52.49 SQM) - Teaching Space: 1	● Student Space (24)	
B00D - R1009 - Staff Study - (12.67 SQM)	● Office (3)	
B00D - R1012 - Staff Study - (12.53 SQM)	● Office (3)	
B00D - R1014 - General Learning Space - (52.33 SQM) - Teaching Space: 1	● Student Space (24)	
B00D - R1015 - Staff Study - (26.06 SQM)	● Office (6)	
B00D - R9006 - General Learning Space - (52.55 SQM) - Teaching Space: 1	● Student Space (24)	
B00D - R9009 - Movement - (34.7 SQM)	Not Applicable	Circulation or storage space.
B00E - R0001 - Movement - (135.36 SQM)	Not Applicable	Circulation or storage space.
B00E - R0005 - General Learning Space - (52.47 SQM) - Teaching Space: 1	● Student Space (24)	
B00E - R0006 - General Learning Space - (52.55 SQM) - Teaching Space: 1	● Student Space (24)	
B00E - R0007 - General Learning Space - (52.03 SQM) - Teaching Space: 1	● Student Space (24)	
B00E - R0008 - Staff Study - (52.48 SQM)	● Office (13)	
B00E - R0013 - Movement - (37.78 SQM)	Not Applicable	Circulation or storage space.

Entity Location	Audit Condition Classification (Capacity)	Comment
B00E - R0014 - Science Laboratory - (79.48 SQM)	● Student Space (36)	
B00E - R1001 - Movement - (123.5 SQM)	Not Applicable	Circulation or storage space.
B00E - R1004 - General Learning Space - (52.41 SQM) - Teaching Space: 1	● Student Space (24)	
B00E - R1005 - General Learning Space - (52.33 SQM) - Teaching Space: 1	● Student Space (24)	
B00E - R1006 - Computer Learning Space - (65.63 SQM) - Teaching Space: 1	● Student Space (30)	
B00E - R1010 - Design L.S. - (65.1 SQM) - Teaching Space: 1	● Student Space (30)	
B00E - R1011 - General Learning Space - (52.48 SQM) - Teaching Space: 1	● Student Space (24)	
B00E - R9005 - Pupil Entry - (9.67 SQM)	Not Applicable	Circulation or storage space.
B00E - R9006 - Staff Study - (6.49 SQM)	● Office (1)	
B00E - R9010 - Movement - (5.27 SQM)	Not Applicable	Circulation or storage space.
B00F - R0004 - Administration - Clerical - (19.13 SQM)	● Office (4)	
B00F - R0006 - Duplicating Workroom - (23.88 SQM)	● Office (5)	
B00F - R0007 - Interview/Office - Type 1 - (13.2 SQM)	● Office (3)	
B00F - R0008 - Clinic - Boys - (13.35 SQM)	● Office (3)	
B00F - R0009 - Commonroom - (19.15 SQM)	● Office (4)	
B00F - R0012 - Principal Office - (18.94 SQM)	● Office (4)	
B00F - R0017 - Leading Teacher - (19.15 SQM)	● Office (4)	
B00F - R0023 - Deputy Principal Office - (16.65 SQM)	● Office (4)	
B00F - R0024 - Deputy Principal Office - (14.93 SQM)	● Office (3)	
B00F - R0025 - Interview/Meeting - (9.27 SQM)	● Office (2)	
B00F - R0027 - Administration - Clerical - (27.28 SQM)	● Office (6)	
B00F - R0028 - Movement - (44.95 SQM)	Not Applicable	Circulation or storage space.
B00F - R0030 - Movement - (22.56 SQM)	Not Applicable	Circulation or storage space.
B00F - R0031 - Administration - Clerical - (21.63 SQM)	● Office (5)	
B00G - R0002 - Movement - (85.42 SQM)	Not Applicable	Circulation or storage space.
B00G - R0003 - Staff Study - (24.78 SQM)	● Office (6)	
B00G - R0004 - Food Technology L.S. - (79 SQM) - Teaching Space: 1	● Student Space (36)	
B00G - R0005 - Food/Research Space - (15.26 SQM)	Not Applicable	Circulation or storage space.
B00G - R0006 - Food Technology L.S. - (62.88 SQM) - Teaching Space: 1	● Student Space (29)	
B00G - R1001 - Movement - (142.79 SQM)	Not Applicable	Circulation or storage space.
B00G - R1006 - Materials Technology L.S. - (85.91 SQM) - Teaching Space: 1	● Student Space (39)	
B00G - R1007 - Wood Technology Bay - (79.05 SQM)	Not Applicable	Circulation or storage space.
B00G - R1011 - Staff Study - (13.3 SQM)	● Office (3)	
B00G - R1012 - Staff Study - (5.27 SQM)	● Office (1)	
B00G - R1014 - Staff Study - (25.76 SQM)	● Office (6)	
B00G - R1015 - General Learning Space - (52.69 SQM) - Teaching Space: 1	● Student Space (24)	
B00G - R1018 - Materials Technology L.S. - (69.53 SQM) - Teaching Space: 1	● Student Space (32)	
B00G - R1021 - Metal Technology Bay - (12.88 SQM)	Not Applicable	Circulation or storage space.
B00G - R2001 - Movement - (148.84 SQM)	Not Applicable	Circulation or storage space.
B00G - R2004 - Computer Learning Space - (66.01 SQM) - Teaching Space: 1	● Student Space (30)	
B00G - R2007 - General Learning Space - (52.7 SQM) - Teaching Space: 1	● Student Space (24)	
B00G - R2008 - General Learning Space - (52.48 SQM) - Teaching Space: 1	● Student Space (24)	
B00G - R2009 - General Learning Space - (52.71 SQM) - Teaching Space: 1	● Student Space (24)	
B00G - R2012 - General Learning Space - (52.55 SQM) - Teaching Space: 1	● Student Space (24)	
B00G - R2013 - General Learning Space - (52.63 SQM) - Teaching Space: 1	● Student Space (24)	
B00G - R2015 - General Learning Space - (52.69 SQM) - Teaching Space: 1	● Student Space (24)	
B00H - R0005 - Public Entry - (70.77 SQM)	Not Applicable	Circulation or storage space.
B00H - R0006 - Multi-Purpose Space - (17.95 SQM)	● Student Space (8)	

Entity Location	Audit Condition Classification (Capacity)	Comment
B00H - R0009 - Multi-Purpose Space - (452.95 SQM)	● Student Space (210)	
B00H - R0016 - Public Entry - (34.3 SQM)	Not Applicable	Circulation or storage space.
B00H - R0017 - Public Entry - (34.67 SQM)	Not Applicable	Circulation or storage space.
B00H - R0019 - Public Entry - (15.9 SQM)	Not Applicable	Circulation or storage space.
B00H - R1006 - Stage - (129.21 SQM)	Not Applicable	Circulation or storage space.
B00I - R0001 - Workshop - (20.87 SQM)	● Student Space (9)	
B00I - R0003 - Movement - (15.93 SQM)	Not Applicable	Circulation or storage space.
B00J - R0001 - Audio Visual Workroom - (35.06 SQM)	● Student Space (16)	
B00J - R0002 - Workroom - (26.71 SQM)	● Office (6)	
B00J - R0004 - Seminar - (12.7 SQM)	● Office (3)	
B00J - R0005 - Seminar - (13.17 SQM)	● Office (3)	
B00J - R0006 - Seminar - (13.17 SQM)	● Office (3)	
B00J - R0009 - Main Area - (377.88 SQM)	Not Applicable	Circulation or storage space.
B00J - R0010 - Pupil Entry - (14.32 SQM)	Not Applicable	Circulation or storage space.
B00J - R0012 - Movement - (19.17 SQM)	Not Applicable	Circulation or storage space.
B00J - R0016 - Staff Study - (25.95 SQM)	● Office (6)	
B00J - R0017 - Laboratory L.S. - (92.53 SQM) - Teaching Space: 1	● Student Space (42)	
B00J - R0019 - Preparation - (29.05 SQM)	Not Applicable	Circulation or storage space.
B00J - R0020 - Laboratory L.S. - (92.95 SQM) - Teaching Space: 1	● Student Space (43)	
B00J - R0022 - Seminar - (15.87 SQM)	● Office (3)	
B00J - R0025 - Commonroom - (26.12 SQM)	● Office (6)	
B00J - R0030 - Movement - (5.08 SQM)	Not Applicable	Circulation or storage space.
B00J - R0033 - Movement - (122.88 SQM)	Not Applicable	Circulation or storage space.
B00J - R1001 - General Learning Space - (94.16 SQM) - Teaching Space: 1	● Student Space (43)	
B00J - R1002 - Seminar/Technology Space - (25.84 SQM)	● Office (6)	
B00J - R1003 - General Learning Space - (52.48 SQM) - Teaching Space: 1	● Student Space (24)	
B00J - R1004 - Staff Study - (12.05 SQM)	● Office (3)	
B00J - R1008 - General Learning Space - (52.7 SQM) - Teaching Space: 1	● Student Space (24)	
B00J - R1009 - General Learning Space - (52.55 SQM) - Teaching Space: 1	● Student Space (24)	
B00J - R1010 - General Learning Space - (52.55 SQM) - Teaching Space: 1	● Student Space (24)	
B00J - R1012 - Staff Study - (26.06 SQM)	● Office (6)	
B00J - R1014 - General Learning Space - (68.47 SQM) - Teaching Space: 1	● Student Space (31)	
B00J - R1018 - General Learning Space - (52.84 SQM) - Teaching Space: 1	● Student Space (24)	
B00J - R1019 - General Learning Space - (52.7 SQM) - Teaching Space: 1	● Student Space (24)	
B00J - R1022 - General Learning Space - (52.85 SQM) - Teaching Space: 1	● Student Space (24)	
B00J - R1023 - Art Learning Space - (53.14 SQM) - Teaching Space: 1	● Student Space (24)	
B00J - R1024 - Art Learning Space - (53.14 SQM) - Teaching Space: 1	● Student Space (24)	
B00J - R1027 - Movement - (235.52 SQM)	Not Applicable	Circulation or storage space.
B00J - R9007 - Computer Learning Space - (66.09 SQM) - Teaching Space: 1	● Student Space (30)	
B00J - R9012 - Movement - (53.96 SQM)	Not Applicable	Circulation or storage space.