

# VENTILATION AUDIT REPORT

<b>SCHOOL:</b>	<b>Moss Vale High School (8388)</b>
<b>AMU REGION:</b>	<b>Southern NSW</b>
<b>STATE ELECTORATE:</b>	<b>Goulburn</b>
<b>LOCAL GOVERNMENT AREA:</b>	<b>Wingecarribee</b>

8388 - Moss Vale High School  
Site Plan (12940)

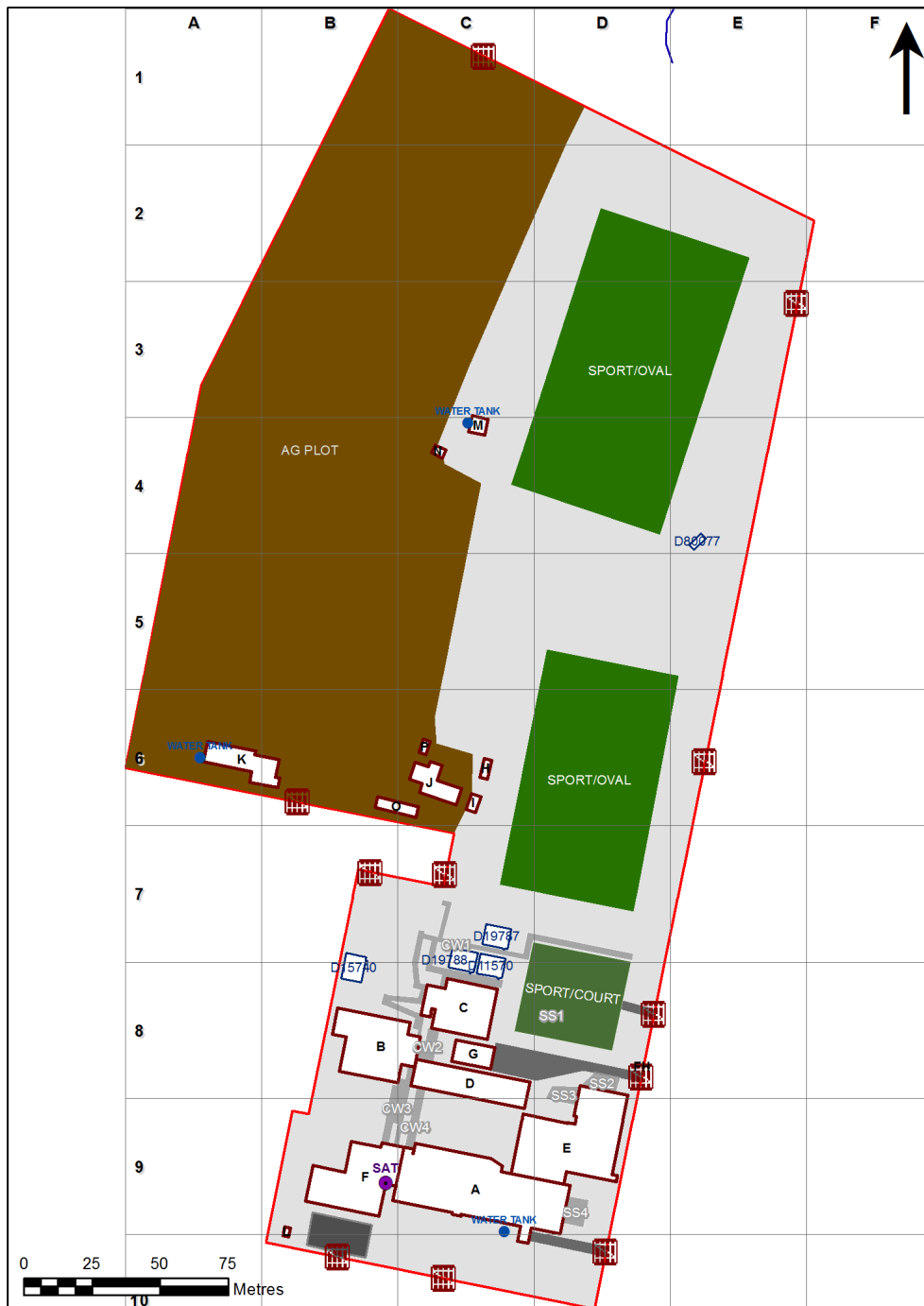

1:1,740







Printed: 31-Oct-2020

## Ventilation Audit Key

Category	Description
	Category A Operate this space in line with <a href="#">COVID safe school operations</a> . It has the required level of natural ventilation. NB. Circulation and storage areas should not be used for groups or gatherings.
	Category B This space should be occupied at 1 person per 4m <sup>2</sup> to comply with <a href="#">COVID safe school operations and the guided use of spaces</a> . The report details the number of people who can be accommodated safely in each of the identified spaces.

Entity Location	Audit Condition Classification (Capacity)	Comment
B00A - R0010 - General Learning Space - (52.41 SQM) - Teaching Space: 1	Student Space (24)	
B00A - R0011 - General Learning Space - (52.56 SQM) - Teaching Space: 1	Student Space (24)	
B00A - R0012 - General Learning Space - (52.08 SQM) - Teaching Space: 1	Student Space (24)	
B00A - R0015 - General Learning Space - (52.56 SQM) - Teaching Space: 1	Student Space (24)	
B00A - R0016 - General Learning Space - (52.56 SQM) - Teaching Space: 1	Student Space (24)	
B00A - R0017 - General Learning Space - (52.49 SQM) - Teaching Space: 1	Student Space (24)	
B00A - R0024 - Staff Study - (25.77 SQM)	Office (6)	
B00A - R0025 - Senior Seminar - (25.85 SQM)	Office (6)	
B00A - R0026 - General Learning Space - (52.42 SQM) - Teaching Space: 1	Student Space (24)	
B00A - R0027 - Staff Study - (39.13 SQM)	Office (9)	
B00A - R0032 - Staff Study - (39 SQM)	Office (9)	
B00A - R0034 - Staff Study - (21.56 SQM)	Office (5)	
B00A - R0036 - Movement - (17.89 SQM)	Not Applicable	Circulation or storage space.
B00A - R0050 - Movement - (156.29 SQM)	Not Applicable	Circulation or storage space.
B00A - R0051 - Staff Study - (39.61 SQM)	Office (9)	
B00A - R0055 - Movement - (24.58 SQM)	Not Applicable	Circulation or storage space.
B00A - R0056 - General Learning Space - (90.09 SQM) - Teaching Space: 1	Student Space (41)	
B00A - R0062 - General Learning Space - (89.67 SQM) - Teaching Space: 1	Student Space (41)	
B00A - R0065 - Movement - (5.36 SQM)	Not Applicable	Circulation or storage space.
B00A - R1001 - Performance Workspace - (80.68 SQM) - Teaching Space: 1	Student Space (37)	
B00A - R1005 - General Learning Space - (38.95 SQM) - Teaching Space: 1	Student Space (18)	
B00A - R1006 - General Learning Space - (52.26 SQM) - Teaching Space: 1	Student Space (24)	
B00A - R1007 - General Learning Space - (52.27 SQM) - Teaching Space: 1	Student Space (24)	
B00A - R1008 - General Learning Space - (51.98 SQM) - Teaching Space: 1	Student Space (24)	
B00A - R1010 - Computer Learning Space - (65.75 SQM) - Teaching Space: 1	Student Space (30)	
B00A - R1013 - Computer Learning Space - (65.68 SQM) - Teaching Space: 1	Student Space (30)	
B00A - R1016 - Movement - (128.57 SQM)	Not Applicable	Circulation or storage space.
B00A - R1019 - General Learning Space - (65.59 SQM) - Teaching Space: 1	Student Space (30)	
B00A - R1020 - General Learning Space - (50.67 SQM) - Teaching Space: 1	Student Space (23)	
B00A - R1021 - General Learning Space - (52.26 SQM) - Teaching Space: 1	Student Space (24)	
B00A - R1022 - General Learning Space - (52.27 SQM) - Teaching Space: 1	Student Space (24)	
B00A - R1023 - General Learning Space - (52.42 SQM) - Teaching Space: 1	Student Space (24)	
B00A - R1024 - Movement - (15.32 SQM)	Not Applicable	Circulation or storage space.
B00A - R1025 - General Learning Space - (51.9 SQM) - Teaching Space: 1	Student Space (24)	
B00A - R1026 - Movement - (19.56 SQM)	Not Applicable	Circulation or storage space.
B00A - R1030 - Staff Study - (48.19 SQM)	Office (12)	
B00A - R9007 - General Assistants - (11.27 SQM)	Office (2)	
B00A - R9023 - Student Canteen - (62.86 SQM)	Not Applicable	Circulation or storage space.
B00A - R9024 - Movement - (89.98 SQM)	Not Applicable	Circulation or storage space.
B00B - R0005 - Laboratory L.S. - (91.88 SQM) - Teaching Space: 1	Student Space (42)	
B00B - R0007 - Laboratory L.S. - (98.64 SQM) - Teaching Space: 1	Student Space (45)	
B00B - R0009 - Laboratory L.S. - (97.77 SQM) - Teaching Space: 1	Student Space (45)	
B00B - R0010 - Preparation - (81.46 SQM)	Not Applicable	Circulation or storage space.
B00B - R0014 - Darkroom Space - (29.3 SQM)	Office (7)	
B00B - R1003 - Movement - (67.72 SQM)	Not Applicable	Circulation or storage space.
B00B - R1005 - Design L.S. - (77.19 SQM) - Teaching Space: 1	Student Space (35)	
B00B - R1006 - Staff Study - (30.87 SQM)	Office (7)	
B00B - R1007 - Design L.S. - (77.18 SQM) - Teaching Space: 1	Student Space (35)	

Entity Location	Audit Condition Classification (Capacity)	Comment
B00B - R1009 - Food Technology L.S. - (107.92 SQM) - Teaching Space: 1	● Student Space (50)	
B00B - R1010 - Food/Research Space - (17.58 SQM)	Not Applicable	Circulation or storage space.
B00B - R1011 - Food/Research Space - (7.59 SQM)	Not Applicable	Circulation or storage space.
B00B - R1012 - Food/Research Space - (105.98 SQM) - Teaching Space: 1	Not Applicable	Circulation or storage space.
B00C - R0004 - General Learning Space - (51.09 SQM) - Teaching Space: 1	● Student Space (23)	
B00C - R0005 - Laboratory L.S. - (92.89 SQM) - Teaching Space: 1	● Student Space (43)	
B00C - R0006 - General Learning Space - (58.27 SQM) - Teaching Space: 1	● Student Space (27)	
B00C - R0007 - Movement - (12.88 SQM)	Not Applicable	Circulation or storage space.
B00C - R0008 - Laboratory L.S. - (92.79 SQM) - Teaching Space: 1	● Student Space (43)	
B00C - R1001 - Practice/Seminar - (12.96 SQM)	Not Applicable	Circulation or storage space.
B00C - R1009 - Practice/Seminar - (12.38 SQM)	Not Applicable	Circulation or storage space.
B00C - R1010 - Practice/Seminar - (12.81 SQM)	Not Applicable	Circulation or storage space.
B00C - R1011 - Practice/Seminar - (12.96 SQM)	Not Applicable	Circulation or storage space.
B00C - R1021 - Practice/Seminar - (9.42 SQM)	Not Applicable	Circulation or storage space.
B00C - R1022 - Performance Workshop - (80.3 SQM)	● Student Space (37)	
B00C - R1023 - Performance Workspace - (80.3 SQM) - Teaching Space: 1	● Student Space (37)	
B00C - R1024 - Performance Workshop - (77.8 SQM)	● Student Space (36)	
B00D - R0007 - Materials Technology L.S. - (97.39 SQM) - Teaching Space: 1	● Student Space (45)	
B00D - R0008 - Welding Area - (8.4 SQM)	Not Applicable	Circulation or storage space.
B00D - R0012 - Staff Study - (26.17 SQM)	● Office (6)	
B00D - R0015 - Materials Technology L.S. - (110.1 SQM) - Teaching Space: 1	● Student Space (51)	
B00D - R9005 - Computer Learning Space - (77.08 SQM) - Teaching Space: 1	● Student Space (35)	
B00E - R0004 - Stage - (91.37 SQM)	Not Applicable	Circulation or storage space.
B00E - R0005 - Multi-Purpose Space - (273.78 SQM)	● Student Space (127)	
B00E - R0006 - Movement - (11.64 SQM)	Not Applicable	Circulation or storage space.
B00E - R0007 - Staff Kitchen - (7.89 SQM)	● Office (1)	
B00E - R0011 - Movement - (32.16 SQM)	Not Applicable	Circulation or storage space.
B00E - R9001 - Movement - (9.38 SQM)	Not Applicable	Circulation or storage space.
B00E - R9007 - Movement - (9.37 SQM)	Not Applicable	Circulation or storage space.
B00F - R0003 - Pupil Entry - (15.32 SQM)	Not Applicable	Circulation or storage space.
B00F - R0004 - Administration - Clerical - (35.01 SQM)	● Office (8)	
B00F - R0006 - Interview/Office - Type 1 - (12.92 SQM)	● Office (3)	
B00F - R0007 - Movement - (90.99 SQM)	Not Applicable	Circulation or storage space.
B00F - R0008 - Principal Office - (19.62 SQM)	● Office (4)	
B00F - R0009 - Ancillary Staff - (21.95 SQM)	● Office (5)	
B00F - R0010 - Interview/Office - Type 1 - (13.64 SQM)	● Office (3)	
B00F - R0012 - Commonroom - (90.02 SQM)	● Office (22)	
B00F - R0013 - Duplicating Workroom - (18.63 SQM)	● Office (4)	
B00F - R0016 - Clinic - Boys - (14.32 SQM)	● Office (3)	
B00F - R0019 - Teachers Aides - (14.3 SQM)	● Office (3)	
B00F - R0020 - Deputy Principal - (15.78 SQM)	● Office (3)	
B00F - R0021 - Administration - Clerical - (12.25 SQM)	● Office (3)	
B00F - R1003 - Movement - (44.76 SQM)	Not Applicable	Circulation or storage space.
B00F - R1005 - Main Area - (343.12 SQM)	Not Applicable	Circulation or storage space.
B00F - R1006 - Seminar - (12.51 SQM)	● Office (3)	
B00F - R1007 - Seminar - (12.8 SQM)	● Office (3)	
B00F - R1008 - Seminar - (12.77 SQM)	● Office (3)	
B00F - R1009 - Seminar - (12.77 SQM)	● Office (3)	
B00F - R1010 - Workroom - (36.09 SQM)	● Office (9)	
B00F - R1011 - Audio Visual Workroom - (31.15 SQM)	● Student Space (14)	

Entity Location	Audit Condition Classification (Capacity)	Comment
B00I - R0001 - General Assistants - (20.97 SQM)	 Office (5)	
B00K - R0003 - Staff Study - (11.02 SQM)	 Office (2)	
OS 601 11570 - OS 601 11570 - Learning Unit - Standard/Withdrawal - (76 SQM)	 Student Space (35)	
OS 601 15740 - OS 601 15740 - Learning Unit - Standard/Withdrawal - (76 SQM)	 Student Space (35)	
OS 601 19787 - OS 601 19787 - Learning Unit - Standard/Withdrawal - (76 SQM)	 Student Space (35)	
OS 601 19788 - OS 601 19788 - Learning Unit - Standard/Withdrawal - (76 SQM)	 Student Space (35)	