

VENTILATION AUDIT REPORT

SCHOOL:	Moree Secondary College Carol Avenue Campus (8471)
AMU REGION:	North Western NSW
STATE ELECTORATE:	Northern Tablelands
LOCAL GOVERNMENT AREA:	Moree Plains

8471 - Moree Secondary College Carol Avenue Campus
Site Plan (13031)

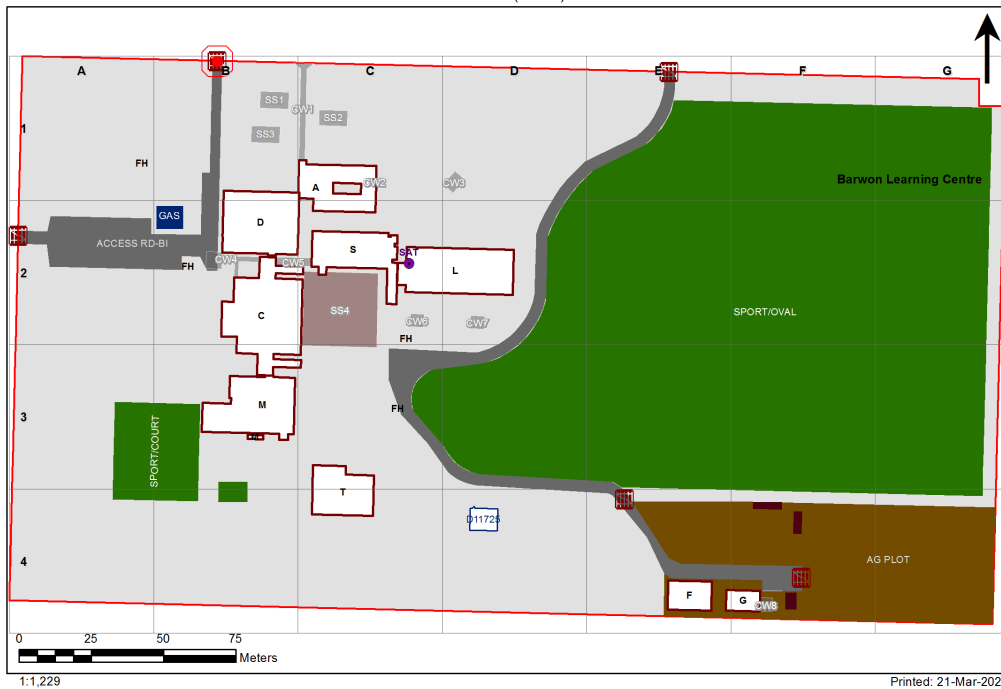

Ventilation Audit Key

Category	Description
	Category A Operate this space in line with COVID safe school operations . It has the required level of natural ventilation. NB. Circulation and storage areas should not be used for groups or gatherings.
	Category B This space should be occupied at 1 person per 4m ² to comply with COVID safe school operations and the guided use of spaces . The report details the number of people who can be accommodated safely in each of the identified spaces.

Entity Location	Audit Condition Classification (Capacity)	Comment
B00A - R0001 - Interview/Office - Type 1 - (12.92 SQM)	Office (3)	
B00A - R0002 - Administration - Clerical - (11.91 SQM)	Office (2)	
B00A - R0003 - Deputy Principal Office - (16.52 SQM)	Office (4)	
B00A - R0007 - Staff Kitchen - (13.71 SQM)	Office (3)	
B00A - R0008 - Clinic - Boys - (13.74 SQM)	Office (3)	
B00A - R0009 - Staff Study - (13.74 SQM)	Office (3)	
B00A - R0012 - Administration - Clerical - (28.1 SQM)	Office (7)	
B00A - R0013 - Administration - Clerical - (13.72 SQM)	Office (3)	
B00A - R0014 - Principal Office - (16.13 SQM)	Office (4)	
B00A - R0019 - Main Entry - (21.41 SQM)	Not Applicable	Circulation or storage space.
B00A - R0020 - Movement - (63.49 SQM)	Not Applicable	Circulation or storage space.
B00A - R0021 - Movement - (66.96 SQM)	Not Applicable	Circulation or storage space.
B00C - R0002 - Multi-Purpose Space - (309.86 SQM)	Student Space (143)	
B00C - R0004 - Movement - (36.85 SQM)	Not Applicable	Circulation or storage space.
B00C - R0012 - Student Canteen - (51.61 SQM)	Not Applicable	Circulation or storage space.
B00C - R0017 - Movement - (76.81 SQM)	Not Applicable	Circulation or storage space.
B00C - R0018 - Movement - (39.02 SQM)	Not Applicable	Circulation or storage space.
B00C - R0019 - Movement - (72.6 SQM)	Not Applicable	Circulation or storage space.
B00C - R1001 - Movement - (35 SQM)	Not Applicable	Circulation or storage space.
B00C - R1003 - Staff Study - (8.72 SQM)	Office (2)	
B00C - R1004 - Movement - (68.99 SQM)	Not Applicable	Circulation or storage space.
B00C - R1009 - Staff Study - (8.69 SQM)	Office (2)	
B00C - R1011 - Movement - (36.28 SQM)	Not Applicable	Circulation or storage space.
B00D - R0001 - Food Technology L.S. - (82.33 SQM) - Teaching Space: 1	Student Space (38)	
B00D - R0004 - Staff Study - (23.88 SQM)	Office (5)	
B00D - R0005 - Staff Study - (32.85 SQM)	Office (8)	
B00D - R0008 - Materials Technology L.S. - (65.71 SQM) - Teaching Space: 1	Student Space (30)	
B00D - R0012 - Food Technology L.S. - (97.73 SQM) - Teaching Space: 1	Student Space (45)	
B00D - R0013 - Food/Research Space - (15.77 SQM)	Not Applicable	Circulation or storage space.
B00D - R0016 - Movement - (72.73 SQM)	Not Applicable	Circulation or storage space.
B00D - R1001 - Commonroom - (65.53 SQM)	Office (16)	
B00D - R1004 - Computer Learning Space - (65.99 SQM) - Teaching Space: 1	Student Space (30)	
B00D - R1009 - General Learning Space - (65.28 SQM) - Teaching Space: 1	Student Space (30)	
B00D - R1010 - General Learning Space - (66.16 SQM) - Teaching Space: 1	Student Space (30)	
B00D - R1012 - General Learning Space - (65.69 SQM) - Teaching Space: 1	Student Space (30)	
B00D - R1013 - General Learning Space - (65.68 SQM) - Teaching Space: 1	Student Space (30)	
B00D - R1014 - Staff Study - (32.15 SQM)	Office (8)	
B00D - R1015 - Movement - (61.21 SQM)	Not Applicable	Circulation or storage space.
B00F - R0002 - General Learning Space - (53.96 SQM) - Teaching Space: 1	Student Space (25)	
B00F - R0003 - General Learning Space - (53.88 SQM) - Teaching Space: 1	Student Space (24)	
B00F - R0004 - Movement - (27.99 SQM)	Not Applicable	Circulation or storage space.
B00G - R0006 - Movement - (26.12 SQM)	Not Applicable	Circulation or storage space.
B00L - R0001 - Senior Study - (13.06 SQM)	Office (3)	
B00L - R0002 - Workroom - (27.01 SQM)	Office (6)	
B00L - R0003 - Workroom - (53.8 SQM)	Office (13)	
B00L - R0006 - Interview/Office - Type 1 - (7.1 SQM)	Office (1)	
B00L - R0011 - Movement - (24.68 SQM)	Not Applicable	Circulation or storage space.
B00L - R0013 - Audio Visual Workroom - (17.42 SQM)	Student Space (8)	
B00L - R0020 - Movement - (69.6 SQM)	Not Applicable	Circulation or storage space.
B00L - R0021 - Senior Study - (13.5 SQM)	Office (3)	

Entity Location	Audit Condition Classification (Capacity)	Comment
B00L - R0023 - Main Area - (239.62 SQM)	Not Applicable	Circulation or storage space.
B00L - R1001 - General Learning Space - (54.09 SQM) - Teaching Space: 1	● Student Space (25)	
B00L - R1002 - General Learning Space - (54.17 SQM) - Teaching Space: 1	● Student Space (25)	
B00L - R1003 - General Learning Space - (52.93 SQM) - Teaching Space: 1	● Student Space (24)	
B00L - R1004 - General Learning Space - (53.14 SQM) - Teaching Space: 1	● Student Space (24)	
B00L - R1005 - Staff Study - (17.49 SQM)	○ Office (4)	
B00L - R1008 - Staff Study - (39.04 SQM)	○ Office (9)	
B00L - R1009 - Movement - (18.66 SQM)	Not Applicable	Circulation or storage space.
B00L - R1012 - General Learning Space - (38.92 SQM) - Teaching Space: 1	● Student Space (18)	
B00L - R1013 - General Learning Space - (59.73 SQM) - Teaching Space: 1	● Student Space (27)	
B00L - R1014 - General Learning Space - (59.74 SQM) - Teaching Space: 1	● Student Space (27)	
B00L - R1017 - Staff Study - (19.19 SQM)	○ Office (4)	
B00L - R1018 - Movement - (17.64 SQM)	Not Applicable	Circulation or storage space.
B00L - R1019 - Movement - (14.69 SQM)	Not Applicable	Circulation or storage space.
B00M - R0008 - Materials Technology L.S. - (82.53 SQM) - Teaching Space: 1	● Student Space (38)	
B00M - R0009 - Welding Area - (17.12 SQM)	Not Applicable	Circulation or storage space.
B00M - R0012 - Movement - (38.92 SQM)	Not Applicable	Circulation or storage space.
B00M - R0013 - Special Learning Space - (57.68 SQM) - Teaching Space: 1	● Student Space (26)	
B00M - R0014 - Staff Study - (27.25 SQM)	○ Office (6)	
B00M - R0015 - Outdoor Workshop - (85.89 SQM)	Not Applicable	Circulation or storage space.
B00M - R1001 - Design L.S. - (52.36 SQM) - Teaching Space: 1	● Student Space (24)	
B00M - R1004 - Materials Technology L.S. - (82.26 SQM) - Teaching Space: 1	● Student Space (38)	
B00M - R1007 - Materials Technology L.S. - (82.81 SQM) - Teaching Space: 1	● Student Space (38)	
B00M - R1012 - Movement - (54.29 SQM)	Not Applicable	Circulation or storage space.
B00M - R1014 - Music Learning Space - (71.27 SQM) - Teaching Space: 1	● Student Space (33)	
B00S - R0003 - Laboratory L.S. - (91.48 SQM) - Teaching Space: 1	● Student Space (42)	
B00S - R0004 - Preparation - (31.23 SQM)	Not Applicable	Circulation or storage space.
B00S - R0009 - Laboratory L.S. - (91.64 SQM) - Teaching Space: 1	● Student Space (42)	
B00S - R0010 - Movement - (64.65 SQM)	Not Applicable	Circulation or storage space.
B00S - R1003 - Laboratory L.S. - (91.87 SQM) - Teaching Space: 1	● Student Space (42)	
B00S - R1004 - Staff Study - (31.47 SQM)	○ Office (7)	
B00S - R1006 - Staff Study - (12.86 SQM)	○ Office (3)	
B00S - R1008 - Laboratory L.S. - (91.67 SQM) - Teaching Space: 1	● Student Space (42)	
B00S - R1009 - Movement - (63.4 SQM)	Not Applicable	Circulation or storage space.
B00T - R0001 - General Learning Space - (59.85 SQM) - Teaching Space: 1	● Student Space (27)	
B00T - R0002 - Science Laboratory - (59.85 SQM)	● Student Space (27)	
B00T - R0003 - Preparation - (31 SQM)	Not Applicable	Circulation or storage space.
B00T - R0006 - Staff Study - (21 SQM)	○ Office (5)	
B00T - R0007 - Seminar - Type 2 - (21.1 SQM)	○ Office (5)	
B00T - R0008 - Movement - (6.33 SQM)	Not Applicable	Circulation or storage space.
B00T - R0011 - Outdoor Learning Space - Type 4 - (42.12 SQM)	Not Applicable	Circulation or storage space.
OS 601 11725 - OS 601 11725 - Learning Unit - Standard/Withdrawal - (76 SQM)	● Student Space (35)	