

# VENTILATION AUDIT REPORT

<b>SCHOOL:</b>	<b>Miller Public School (4338)</b>
<b>AMU REGION:</b>	<b>South Western Sydney</b>
<b>STATE ELECTORATE:</b>	<b>Liverpool</b>
<b>LOCAL GOVERNMENT AREA:</b>	<b>Liverpool</b>

4338 - Miller Public School  
Site Plan (10565)

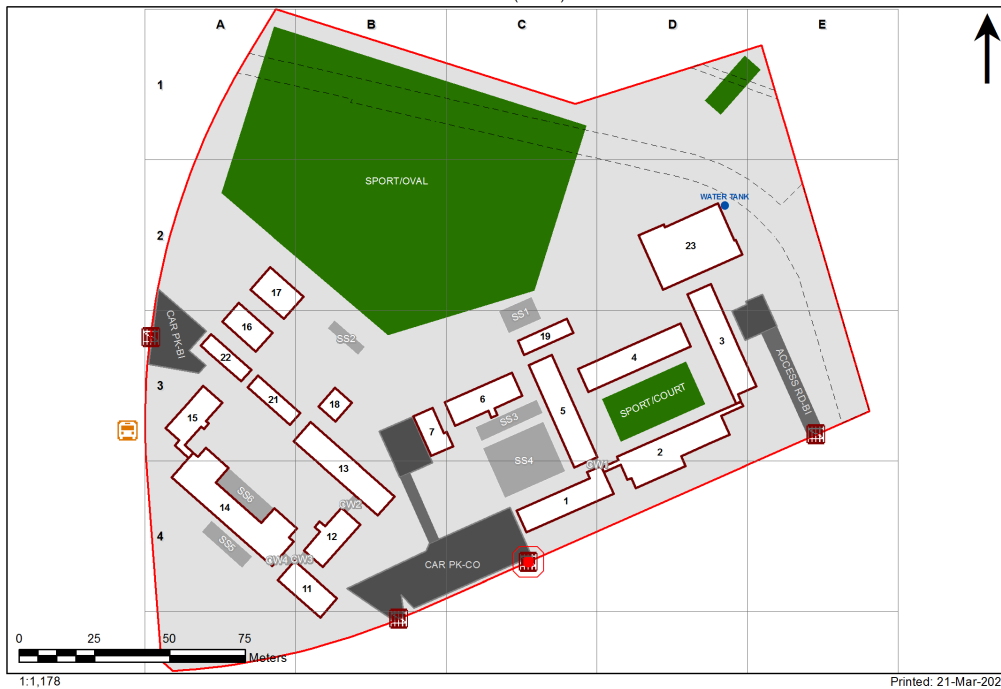

## Ventilation Audit Key

Category	Description
	Category A Operate this space in line with <a href="#">COVID safe school operations</a> . It has the required level of natural ventilation. NB. Circulation and storage areas should not be used for groups or gatherings.
	Category B This space should be occupied at 1 person per 4m <sup>2</sup> to comply with <a href="#">COVID safe school operations and the guided use of spaces</a> . The report details the number of people who can be accommodated safely in each of the identified spaces.

Entity Location	Audit Condition Classification (Capacity)	Comment
B001 - R0003 - Clerical Office - (18.79 SQM)	Office (4)	
B001 - R0004 - Clerical Office - (18.35 SQM)	Office (4)	
B001 - R0009 - Deputy Principal - (14.88 SQM)	Office (3)	
B001 - R0012 - Principal - (15.7 SQM)	Office (3)	
B001 - R0022 - Movement - (9.75 SQM)	Not Applicable	Circulation or storage space.
B001 - R0025 - Movement - (37.36 SQM)	Not Applicable	Circulation or storage space.
B001 - R0026 - Staff Kitchen - (9.72 SQM)	Office (2)	
B001 - R0027 - Staff Room - (54.92 SQM)	Office (13)	
B002 - R0001 - Movement - (7.89 SQM)	Not Applicable	Circulation or storage space.
B002 - R0002 - Home Base - (57.09 SQM) - Teaching Space: 1	Student Space (26)	
B002 - R0005 - Movement - (6.34 SQM)	Not Applicable	Circulation or storage space.
B002 - R0009 - Home Base - (56.62 SQM) - Teaching Space: 1	Student Space (26)	
B002 - R0010 - Home Base - (56.63 SQM) - Teaching Space: 1	Student Space (26)	
B002 - R0015 - Movement - (6.34 SQM)	Not Applicable	Circulation or storage space.
B002 - R0019 - Home Base - (57.1 SQM) - Teaching Space: 1	Student Space (26)	
B002 - R0020 - Movement - (10.05 SQM)	Not Applicable	Circulation or storage space.
B002 - R0021 - Movement - (63.7 SQM)	Not Applicable	Circulation or storage space.
B003 - R0002 - Home Base - (56.92 SQM) - Teaching Space: 1	Student Space (26)	
B003 - R0006 - Movement - (6.34 SQM)	Not Applicable	Circulation or storage space.
B003 - R0010 - Home Base - (56.69 SQM) - Teaching Space: 1	Student Space (26)	
B003 - R0011 - Home Base - (56.7 SQM) - Teaching Space: 1	Student Space (26)	
B003 - R0014 - Home Base - (57.17 SQM) - Teaching Space: 1	Student Space (26)	
B003 - R0016 - Movement - (6.34 SQM)	Not Applicable	Circulation or storage space.
B004 - R0001 - Home Base - (56.94 SQM) - Teaching Space: 1	Student Space (26)	
B004 - R0007 - Movement - (5.8 SQM)	Not Applicable	Circulation or storage space.
B004 - R0009 - Communal Space - (114.11 SQM)	Student Space (52)	
B004 - R0016 - Home Base - (56.94 SQM) - Teaching Space: 1	Student Space (26)	
B004 - R0020 - Movement - (7.61 SQM)	Not Applicable	Circulation or storage space.
B005 - R0001 - Deputy Principal - (14.88 SQM)	Office (3)	
B005 - R0003 - Interview - (16.61 SQM)	Office (4)	
B005 - R0004 - Movement - (8.77 SQM)	Not Applicable	Circulation or storage space.
B005 - R0012 - Special Programs Room - (27.96 SQM)	Student Space (12)	
B005 - R0013 - Staff Room Annexe - (11.18 SQM)	Office (2)	
B005 - R0016 - Home Base - (56.39 SQM) - Teaching Space: 1	Student Space (26)	
B005 - R0017 - Special Programs Room - (20.05 SQM)	Student Space (9)	
B005 - R0022 - Home Base - (57.18 SQM) - Teaching Space: 1	Student Space (26)	
B006 - R0005 - Special Programs Room - (39.12 SQM)	Student Space (18)	
B006 - R0011 - Reading Area - (113.81 SQM)	Student Space (52)	
B007 - R0001 - Canteen - (31.2 SQM)	Not Applicable	Circulation or storage space.
B007 - R0004 - Movement - (14.33 SQM)	Not Applicable	Circulation or storage space.
B007 - R0005 - Movement - (40.69 SQM)	Not Applicable	Circulation or storage space.
B013 - R0011 - Home Base - (56.34 SQM) - Teaching Space: 1	Student Space (26)	
B013 - R0012 - Home Base - (56.35 SQM) - Teaching Space: 1	Student Space (26)	
B013 - R0018 - Home Base - (56.81 SQM) - Teaching Space: 1	Student Space (26)	
B014 - R0006 - Home Base - (84.87 SQM) - Teaching Space: 1	Student Space (39)	
B014 - R0007 - Home Base - (56.32 SQM) - Teaching Space: 1	Student Space (26)	
B014 - R0016 - Home Base - (56.32 SQM) - Teaching Space: 1	Student Space (26)	
B014 - R0017 - Home Base - (84.87 SQM) - Teaching Space: 1	Student Space (39)	

Entity Location	Audit Condition Classification (Capacity)	Comment
B014 - R0023 - Outdoor Learning Area - (55.59 SQM)	Not Applicable	Circulation or storage space.
B014 - R0024 - Outdoor Learning Area - (55.83 SQM)	Not Applicable	Circulation or storage space.
B017 - R0002 - Practical Activities - 1hb - (50.79 SQM)	● Student Space (23)	
B017 - R0004 - Movement - (27.98 SQM)	Not Applicable	Circulation or storage space.
B018 - R0001 - Movement - (12.08 SQM)	Not Applicable	Circulation or storage space.
B018 - R0002 - Movement - (7.5 SQM)	Not Applicable	Circulation or storage space.
B023 - R0001 - Communal Space - (145.83 SQM)	● Student Space (67)	
B023 - R0002 - Movement - (7.09 SQM)	Not Applicable	Circulation or storage space.
B023 - R0003 - Raised Platform - (60.48 SQM)	Not Applicable	Circulation or storage space.
B023 - R0004 - Movement - (11.45 SQM)	Not Applicable	Circulation or storage space.
B023 - R0005 - Movement - (12.36 SQM)	Not Applicable	Circulation or storage space.