

VENTILATION AUDIT REPORT

SCHOOL:	Lindfield Public School (2403)
AMU REGION:	Northern Sydney
STATE ELECTORATE:	Davidson
LOCAL GOVERNMENT AREA:	Ku-Ring-Gai

2403 - Lindfield Public School
Site Plan (12767)

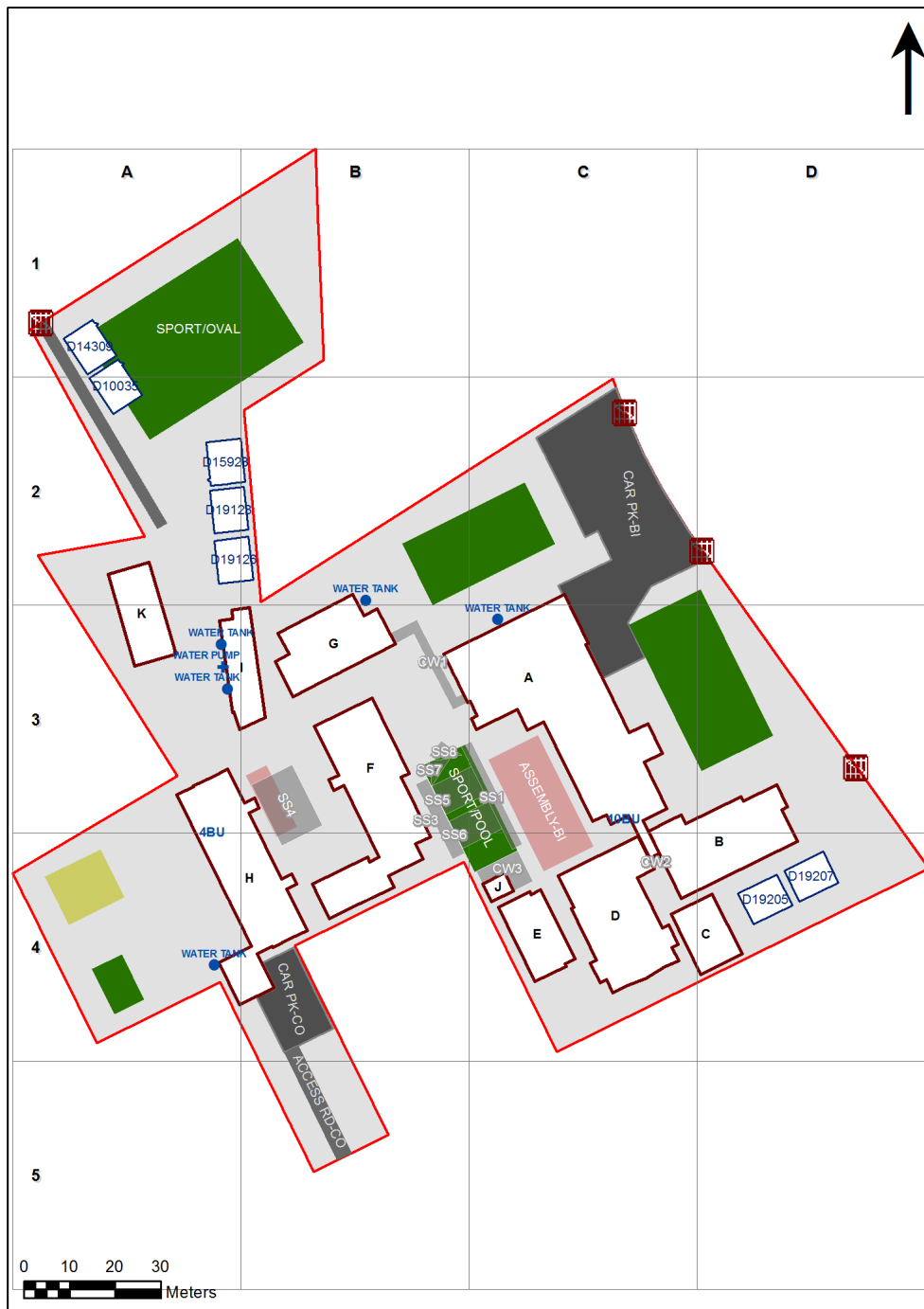

1:1,041

Printed: 22-Jun-2020

Ventilation Audit Key

Category	Description
	Category A Operate this space in line with COVID safe school operations . It has the required level of natural ventilation. NB. Circulation and storage areas should not be used for groups or gatherings.
	Category B This space should be occupied at 1 person per 4m ² to comply with COVID safe school operations and the guided use of spaces . The report details the number of people who can be accommodated safely in each of the identified spaces.

Entity Location	Audit Condition Classification (Capacity)	Comment
B00A - R0001 - Staff Room - (81.01 SQM)	Office (20)	
B00A - R0004 - Duplicating Workroom - (18.8 SQM)	Office (4)	
B00A - R0005 - Principal - (20.08 SQM)	Office (5)	
B00A - R0007 - Sick Bay - (7.53 SQM)	Student Space (3)	
B00A - R0008 - Clerical Office - (14.13 SQM)	Office (3)	
B00A - R0009 - Entry Vestibule - (20.54 SQM)	Not Applicable	Circulation or storage space.
B00A - R0011 - Movement - (58.5 SQM)	Not Applicable	Circulation or storage space.
B00A - R0013 - Clerical Office - (12.22 SQM)	Office (3)	
B00A - R0014 - Staff Room Annexe - (12.33 SQM)	Office (3)	
B00A - R0017 - Deputy Principal - (12.25 SQM)	Office (3)	
B00A - R0018 - Movement - (42 SQM)	Not Applicable	Circulation or storage space.
B00A - R0021 - Canteen - (42.14 SQM)	Not Applicable	Circulation or storage space.
B00A - R0026 - Movement - (128.54 SQM)	Not Applicable	Circulation or storage space.
B00A - R0031 - Movement - (5.5 SQM)	Not Applicable	Circulation or storage space.
B00A - R0035 - Movement - (82.3 SQM)	Not Applicable	Circulation or storage space.
B00A - R0036 - Movement - (64.63 SQM)	Not Applicable	Circulation or storage space.
B00A - R0037 - Movement - (141.41 SQM)	Not Applicable	Circulation or storage space.
B00A - R1001 - Reading Area - (263.2 SQM)	Student Space (122)	
B00A - R1006 - Movement - (11.69 SQM)	Not Applicable	Circulation or storage space.
B00A - R1013 - Seminar/Study - (18.87 SQM)	Office (4)	
B00A - R1019 - Home Base - (56.29 SQM) - Teaching Space: 1	Student Space (26)	
B00A - R1020 - Practical Activities - 1hb - (20.51 SQM)	Student Space (9)	
B00A - R1021 - Movement - (81.15 SQM)	Not Applicable	Circulation or storage space.
B00A - R1022 - Home Base - (49.9 SQM) - Teaching Space: 1	Student Space (23)	
B00A - R1024 - Practical Activities - 1hb - (16.97 SQM)	Student Space (7)	
B00A - R1026 - Practical Activities - 1hb - (16.97 SQM)	Student Space (7)	
B00A - R1027 - Home Base - (49.9 SQM) - Teaching Space: 1	Student Space (23)	
B00A - R1029 - Movement - (171.41 SQM)	Not Applicable	Circulation or storage space.
B00A - R1031 - Home Base - (69.33 SQM) - Teaching Space: 1	Student Space (32)	
B00B - R0001 - Home Base - (50.49 SQM) - Teaching Space: 1	Student Space (23)	
B00B - R0002 - Home Base - (51.48 SQM) - Teaching Space: 1	Student Space (23)	
B00B - R0004 - Practical Activities - 1hb - (14.69 SQM)	Student Space (6)	
B00B - R0005 - Home Base - (79.46 SQM) - Teaching Space: 1	Student Space (36)	
B00B - R0008 - Staff Room Annexe - (12.27 SQM)	Office (3)	
B00B - R0012 - Movement - (12.89 SQM)	Not Applicable	Circulation or storage space.
B00B - R0013 - Movement - (66.69 SQM)	Not Applicable	Circulation or storage space.
B00B - R1001 - Home Base - (50.98 SQM) - Teaching Space: 1	Student Space (23)	
B00B - R1002 - Home Base - (52.01 SQM) - Teaching Space: 1	Student Space (24)	
B00B - R1008 - Movement - (70.31 SQM)	Not Applicable	Circulation or storage space.
B00B - R1011 - Home Base - (93.3 SQM) - Teaching Space: 1	Student Space (43)	
B00C - R0001 - Home Base - (52.79 SQM) - Teaching Space: 1	Student Space (24)	
B00C - R0002 - Home Base - (52.87 SQM) - Teaching Space: 1	Student Space (24)	
B00C - R0004 - Movement - (28.98 SQM)	Not Applicable	Circulation or storage space.
B00D - R0007 - Raised Platform - (48.81 SQM)	Not Applicable	Circulation or storage space.
B00D - R0013 - Movement - (6.27 SQM)	Not Applicable	Circulation or storage space.
B00D - R0014 - Movement - (6.27 SQM)	Not Applicable	Circulation or storage space.
B00D - R0015 - Communal Space - (212.73 SQM)	Student Space (98)	
B00D - R9004 - Special Programs Room - (46.76 SQM)	Student Space (21)	
B00E - R0001 - Home Base - (53.91 SQM) - Teaching Space: 1	Student Space (25)	

Entity Location	Audit Condition Classification (Capacity)	Comment
B00E - R0004 - Movement - (26.6 SQM)	Not Applicable	Circulation or storage space.
B00E - R0005 - Special Programs Room - (53.9 SQM)	● Student Space (25)	
B00F - R0001 - Home Base - (56.94 SQM) - Teaching Space: 1	● Student Space (26)	
B00F - R0005 - Staff Room Annexe - (13.81 SQM)	● Office (3)	
B00F - R0007 - Movement - (29.54 SQM)	Not Applicable	Circulation or storage space.
B00F - R0010 - Home Base - (57.49 SQM) - Teaching Space: 1	● Student Space (26)	
B00F - R0011 - Home Base - (71.85 SQM) - Teaching Space: 1	● Student Space (33)	
B00F - R0015 - Movement - (5.52 SQM)	Not Applicable	Circulation or storage space.
B00F - R0016 - Movement - (16.29 SQM)	Not Applicable	Circulation or storage space.
B00F - R0018 - Home Base - (86.67 SQM) - Teaching Space: 1	● Student Space (40)	
B00F - R0019 - Movement - (52.12 SQM)	Not Applicable	Circulation or storage space.
B00F - R0021 - Movement - (102.35 SQM)	Not Applicable	Circulation or storage space.
B00G - R0001 - Home Base - (60.91 SQM) - Teaching Space: 1	● Student Space (28)	
B00G - R0002 - Home Base - (60.9 SQM) - Teaching Space: 1	● Student Space (28)	
B00G - R0004 - Practical Activities - 1hb - (18.81 SQM)	● Student Space (8)	
B00G - R0005 - Withdrawal Space - 2hb - (11.51 SQM)	● Student Space (5)	
B00G - R0006 - Practical Activities - 1hb - (18.91 SQM)	● Student Space (8)	
B00G - R1001 - Home Base - (60.9 SQM) - Teaching Space: 1	● Student Space (28)	
B00G - R1002 - Home Base - (60.8 SQM) - Teaching Space: 1	● Student Space (28)	
B00G - R1004 - Practical Activities - 1hb - (18.65 SQM)	● Student Space (8)	
B00G - R1005 - Withdrawal Space - 2hb - (11.51 SQM)	● Student Space (5)	
B00G - R1006 - Practical Activities - 1hb - (18.7 SQM)	● Student Space (8)	
B00G - R9001 - Home Base - (58.61 SQM) - Teaching Space: 1	● Student Space (27)	
B00G - R9002 - Practical Activities - 1hb - (18.65 SQM)	● Student Space (8)	
B00G - R9004 - Withdrawal Space - 1hb - (8.81 SQM)	● Student Space (4)	
B00H - R0001 - Home Base - (57.69 SQM) - Teaching Space: 1	● Student Space (26)	
B00H - R0005 - Movement - (5.64 SQM)	Not Applicable	Circulation or storage space.
B00H - R0008 - Home Base - (57.3 SQM) - Teaching Space: 1	● Student Space (26)	
B00H - R0009 - Home Base - (57.3 SQM) - Teaching Space: 1	● Student Space (26)	
B00H - R0012 - Movement - (5.64 SQM)	Not Applicable	Circulation or storage space.
B00H - R0015 - Home Base - (57.06 SQM) - Teaching Space: 1	● Student Space (26)	
B00H - R0017 - Movement - (22.66 SQM)	Not Applicable	Circulation or storage space.
B00H - R0018 - Home Base - (57.53 SQM) - Teaching Space: 1	● Student Space (26)	
B00H - R9003 - Special Programs Room - (21.13 SQM)	● Student Space (9)	
B00H - R9008 - Movement - (13.29 SQM)	Not Applicable	Circulation or storage space.
OS 602 10035 - OS 602 10035 - Learning Unit - Standard With P.A.A. - (76 SQM)	● Student Space (35)	
OS 602 14309 - OS 602 14309 - Learning Unit - Standard With P.A.A. - (76 SQM)	● Student Space (35)	
OS 603 15928 - OS 603 15928 - Learning Unit - Standard With P.A.A. A/C - (76 SQM)	● Student Space (35)	
OS 606 19123 - OS 606 19123 - Learning Unit - Standard With P.A.A A/C - (76 SQM)	● Student Space (35)	
OS 606 19126 - OS 606 19126 - Learning Unit - Standard With P.A.A A/C - (76 SQM)	● Student Space (35)	
OS 606 19205 - OS 606 19205 - Learning Unit - Standard With P.A.A A/C - (76 SQM)	● Student Space (35)	
OS 606 19207 - OS 606 19207 - Learning Unit - Standard With P.A.A A/C - (76 SQM)	● Student Space (35)	