

VENTILATION AUDIT REPORT

SCHOOL:	Lidcombe Public School (2394)
AMU REGION:	South Western Sydney
STATE ELECTORATE:	Auburn
LOCAL GOVERNMENT AREA:	Cumberland

2394 - Lidcombe Public School
Site Plan (12765)

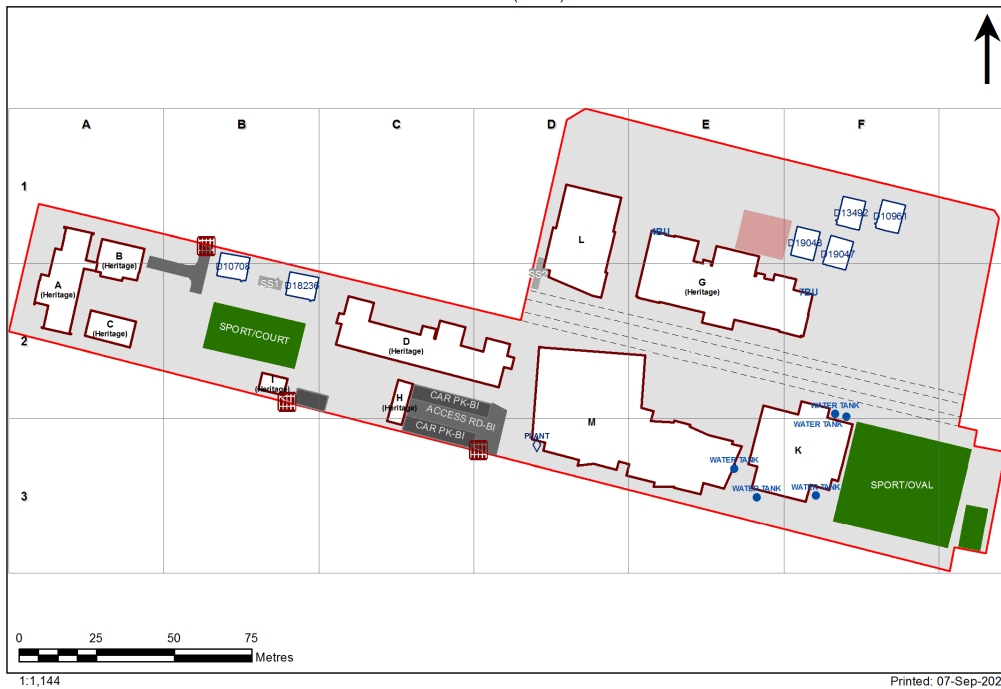

1:1,144

Printed: 07-Sep-2021

Ventilation Audit Key

Category	Description
	Category A Operate this space in line with COVID safe school operations . It has the required level of natural ventilation. NB. Circulation and storage areas should not be used for groups or gatherings.
	Category B This space should be occupied at 1 person per 4m ² to comply with COVID safe school operations and the guided use of spaces . The report details the number of people who can be accommodated safely in each of the identified spaces.

Entity Location	Audit Condition Classification (Capacity)	Comment
B00A - R0001 - Home Base - M - (56.44 SQM) - Teaching Space: 1	● Student Space (26)	
B00A - R0003 - Movement - (22.23 SQM)	Not Applicable	Circulation or storage space.
B00A - R0004 - Home Base - M - (56.39 SQM) - Teaching Space: 1	● Student Space (26)	
B00A - R0007 - Entry Vestibule - (9.3 SQM)	Not Applicable	Circulation or storage space.
B00A - R0008 - Movement - (6.2 SQM)	Not Applicable	Circulation or storage space.
B00A - R0012 - Movement - (11.94 SQM)	Not Applicable	Circulation or storage space.
B00A - R0017 - Home Base - M - (56.59 SQM) - Teaching Space: 1	● Student Space (26)	
B00A - R0018 - Special Programs Room - (27.28 SQM)	● Student Space (12)	
B00A - R0019 - Movement - (10.65 SQM)	Not Applicable	Circulation or storage space.
B00B - R0001 - Special Programs Room - (72.29 SQM)	● Student Space (33)	
B00B - R0003 - Movement - (8.31 SQM)	Not Applicable	Circulation or storage space.
B00B - R0004 - Movement - (7.64 SQM)	Not Applicable	Circulation or storage space.
B00B - R0005 - Special Programs Room - (20.86 SQM)	● Student Space (9)	
B00B - R0006 - Raised Platform - (21.09 SQM)	Not Applicable	Circulation or storage space.
B00C - R0001 - Movement - (25.63 SQM)	Not Applicable	Circulation or storage space.
B00C - R0002 - Home Base - (47.28 SQM) - Teaching Space: 1	● Student Space (21)	
B00C - R0003 - Home Base - (47.16 SQM) - Teaching Space: 1	● Student Space (21)	
B00D - R0001 - Movement - (5.74 SQM)	Not Applicable	Circulation or storage space.
B00D - R0002 - Movement - (8.61 SQM)	Not Applicable	Circulation or storage space.
B00D - R0005 - Home Base - (46.85 SQM) - Teaching Space: 1	● Student Space (21)	
B00D - R0006 - Home Base - (47.77 SQM) - Teaching Space: 1	● Student Space (22)	
B00D - R0007 - Home Base - (48.41 SQM) - Teaching Space: 1	● Student Space (22)	
B00D - R0008 - Home Base - (49.4 SQM) - Teaching Space: 1	● Student Space (22)	
B00D - R0009 - Home Base - (50.24 SQM) - Teaching Space: 1	● Student Space (23)	
B00D - R0010 - Home Base - (49.04 SQM) - Teaching Space: 1	● Student Space (22)	
B00D - R0012 - Withdrawal Space - 2hb - (12.7 SQM)	● Student Space (5)	
B00D - R0013 - Movement - (12.93 SQM)	Not Applicable	Circulation or storage space.
B00D - R0016 - Movement - (123.89 SQM)	Not Applicable	Circulation or storage space.
B00D - R0017 - Special Programs Room - (10.23 SQM)	● Student Space (4)	
B00D - R0018 - Movement - (12.81 SQM)	Not Applicable	Circulation or storage space.
B00D - R0021 - Withdrawal Space - 2hb - (12.62 SQM)	● Student Space (5)	
B00D - R0025 - Interview - (15.43 SQM)	● Office (3)	
B00D - R0028 - Home Base - (46.92 SQM) - Teaching Space: 1	● Student Space (21)	
B00D - R1002 - Movement - (41.03 SQM)	Not Applicable	Circulation or storage space.
B00D - R1003 - Home Base - (47.99 SQM) - Teaching Space: 1	● Student Space (22)	
B00D - R1004 - Home Base - (48.01 SQM) - Teaching Space: 1	● Student Space (22)	
B00D - R1006 - Reading Area - (107.53 SQM)	● Student Space (49)	
B00D - R1007 - Reading Area - (48.15 SQM)	● Student Space (22)	
B00D - R1008 - Reading Area - (50.38 SQM)	● Student Space (23)	
B00D - R1009 - Home Base - (48.82 SQM) - Teaching Space: 1	● Student Space (22)	
B00D - R1011 - Movement - (50.07 SQM)	Not Applicable	Circulation or storage space.
B00D - R1013 - Movement - (13.15 SQM)	Not Applicable	Circulation or storage space.
B00D - R1014 - Special Programs Room - (10.31 SQM)	● Student Space (4)	
B00E - R0002 - Interview - (10.97 SQM)	● Office (2)	
B00F - R0002 - Home Base - (54.41 SQM)	● Student Space (25)	
B00F - R0003 - Home Base - (54.27 SQM)	● Student Space (25)	
B00F - R0004 - Movement - (29.05 SQM)	Not Applicable	Circulation or storage space.
B00G - R0004 - Home Base - (49.53 SQM) - Teaching Space: 1	● Student Space (22)	
B00G - R0005 - Home Base - (47.66 SQM) - Teaching Space: 1	● Student Space (22)	

Entity Location	Audit Condition Classification (Capacity)	Comment
B00G - R0006 - Home Base - (48.1 SQM) - Teaching Space: 1	● Student Space (22)	
B00G - R0007 - Interview - (13.36 SQM)	● Office (3)	
B00G - R0009 - Entry Vestibule - (16.33 SQM)	Not Applicable	Circulation or storage space.
B00G - R0010 - Movement - (33.12 SQM)	Not Applicable	Circulation or storage space.
B00G - R0011 - Interview - (19.26 SQM)	● Office (4)	
B00G - R0012 - Home Base - (48.16 SQM) - Teaching Space: 1	● Student Space (22)	
B00G - R0013 - Home Base - (47.82 SQM) - Teaching Space: 1	● Student Space (22)	
B00G - R0021 - Movement - (6.79 SQM)	Not Applicable	Circulation or storage space.
B00G - R0025 - Home Base - (65.91 SQM) - Teaching Space: 1	● Student Space (30)	
B00G - R0027 - Movement - (26.53 SQM)	Not Applicable	Circulation or storage space.
B00G - R0032 - Movement - (90.09 SQM)	Not Applicable	Circulation or storage space.
B00G - R0037 - Home Base - (47.31 SQM) - Teaching Space: 1	● Student Space (21)	
B00G - R0038 - Movement - (28.19 SQM)	Not Applicable	Circulation or storage space.
B00G - R0039 - Movement - (7.12 SQM)	Not Applicable	Circulation or storage space.
B00G - R0042 - Practical Activities - (10.64 SQM)	● Student Space (4)	
B00G - R0043 - Special Programs Room - (17.07 SQM)	● Student Space (7)	
B00G - R0044 - Communal Space - (171.25 SQM)	● Student Space (79)	
B00G - R0045 - Movement - (11.62 SQM)	Not Applicable	Circulation or storage space.
B00G - R0046 - Home Base - (49.65 SQM) - Teaching Space: 1	● Student Space (23)	
B00K - R0008 - Communal Space - (208.45 SQM)	● Student Space (96)	
B00K - R0009 - Raised Platform - (51.78 SQM)	Not Applicable	Circulation or storage space.
B00K - R0010 - Movement - (13.08 SQM)	Not Applicable	Circulation or storage space.
B00K - R0012 - Movement - (14.84 SQM)	Not Applicable	Circulation or storage space.
B00K - R0020 - Canteen - (44.78 SQM)	Not Applicable	Circulation or storage space.
B00L - R0002 - Entry Vestibule - (25.31 SQM)	Not Applicable	Circulation or storage space.
B00L - R0003 - Movement - (26.82 SQM)	Not Applicable	Circulation or storage space.
B00L - R0004 - Clerical Office - (62.84 SQM)	● Office (15)	
B00L - R0005 - Interview - (17.93 SQM)	● Office (4)	
B00L - R0006 - Entry Vestibule - (12.56 SQM)	Not Applicable	Circulation or storage space.
B00L - R0008 - Movement - (27.55 SQM)	Not Applicable	Circulation or storage space.
B00L - R0010 - Deputy Principal - (25.15 SQM)	● Office (6)	
B00L - R0011 - Deputy Principal - (14.16 SQM)	● Office (3)	
B00L - R0013 - Staff Room - (88 SQM)	● Office (22)	
B00L - R0018 - Sick Bay - (8.98 SQM)	● Student Space (4)	
B00L - R0019 - Clerical Office/Workroom - (14.72 SQM)	● Office (3)	
B00L - R0023 - Staff Room Annexe - (44.17 SQM)	● Office (11)	
B00L - R0025 - Deputy Principal - (14.1 SQM)	● Office (3)	
B00L - R0026 - Principal - (15.97 SQM)	● Office (3)	
B00L - R0027 - Interview - (13.68 SQM)	● Office (3)	
B00L - R0028 - Interview - (12.09 SQM)	● Office (3)	
B00L - R0029 - Staff Kitchen - (11.49 SQM)	● Office (2)	
B00M - R0001 - Movement - (230.33 SQM)	Not Applicable	Circulation or storage space.
B00M - R0002 - Practical Activities - 2hb - (25.09 SQM)	● Student Space (11)	
B00M - R0009 - Home Base - (62.54 SQM) - Teaching Space: 1	● Student Space (29)	
B00M - R0010 - Withdrawal Space - 2hb - (13.66 SQM)	● Student Space (6)	
B00M - R0011 - Home Base - (63.22 SQM) - Teaching Space: 1	● Student Space (29)	
B00M - R0012 - Withdrawal Space - 1hb - (21.04 SQM)	● Student Space (9)	
B00M - R0013 - Home Base - (65.75 SQM) - Teaching Space: 1	● Student Space (30)	
B00M - R0014 - Practical Activities - 2hb - (28.57 SQM)	● Student Space (13)	
B00M - R0016 - Home Base - (65.83 SQM) - Teaching Space: 1	● Student Space (30)	

Entity Location	Audit Condition Classification (Capacity)	Comment
B00M - R0017 - Withdrawal Space - 1hb - (12.56 SQM)	Student Space (5)	
B00M - R0021 - Home Base - (64.84 SQM) - Teaching Space: 1	Student Space (30)	
B00M - R0022 - Withdrawal Space - 2hb - (13.05 SQM)	Student Space (6)	
B00M - R0023 - Home Base - (63.61 SQM) - Teaching Space: 1	Student Space (29)	
B00M - R0024 - Practical Activities - 2hb - (19.55 SQM)	Student Space (9)	
B00M - R0025 - Home Base - (65.89 SQM) - Teaching Space: 1	Student Space (30)	
B00M - R0028 - Reading Area - (208.02 SQM)	Student Space (96)	
B00M - R0037 - Tiered Learning Space - (16.61 SQM)	Student Space (7)	
B00M - R1001 - Movement - (231.88 SQM)	Not Applicable	Circulation or storage space.
B00M - R1002 - Practical Activities - 2hb - (22.84 SQM)	Student Space (10)	
B00M - R1008 - Home Base - (63.11 SQM) - Teaching Space: 1	Student Space (29)	
B00M - R1009 - Withdrawal Space - 2hb - (13.25 SQM)	Student Space (6)	
B00M - R1010 - Home Base - (63.55 SQM) - Teaching Space: 1	Student Space (29)	
B00M - R1011 - Withdrawal Space - 2hb - (21.14 SQM)	Student Space (9)	
B00M - R1012 - Home Base - (66.69 SQM) - Teaching Space: 1	Student Space (30)	
B00M - R1013 - Practical Activities - 2hb - (28.54 SQM)	Student Space (13)	
B00M - R1015 - Home Base - (65.82 SQM) - Teaching Space: 1	Student Space (30)	
B00M - R1016 - Withdrawal Space - 1hb - (14 SQM)	Student Space (6)	
B00M - R1021 - Home Base - (64.02 SQM) - Teaching Space: 1	Student Space (29)	
B00M - R1022 - Withdrawal Space - 2hb - (13.54 SQM)	Student Space (6)	
B00M - R1023 - Home Base - (63.4 SQM) - Teaching Space: 1	Student Space (29)	
B00M - R1024 - Practical Activities - 2hb - (20.29 SQM)	Student Space (9)	
B00M - R1026 - Home Base - (65.95 SQM) - Teaching Space: 1	Student Space (30)	
B00M - R1029 - Special Programs Room - (28.75 SQM)	Student Space (13)	
B00M - R1030 - Reading Area - (65.61 SQM)	Student Space (30)	
B00M - R1031 - Tiered Learning Space - (16.56 SQM)	Student Space (7)	
OS 601 11733 - OS 601 11733 - Learning Unit - Standard/Withdrawal - (76 SQM)	Student Space (35)	
OS 601 14054 - OS 601 14054 - Learning Unit - Standard/Withdrawal - (76 SQM)	Student Space (35)	
OS 602 10180 - OS 602 10180 - Learning Unit - Standard With P.A.A. - (76 SQM)	Student Space (35)	
OS 602 10708 - OS 602 10708 - Learning Unit - Standard With P.A.A. - (76 SQM)	Student Space (35)	
OS 602 10961 - OS 602 10961 - Learning Unit - Standard With P.A.A. - (76 SQM)	Student Space (35)	
OS 602 12443 - OS 602 12443 - Learning Unit - Standard With P.A.A. - (76 SQM)	Student Space (35)	
OS 602 12736 - OS 602 12736 - Learning Unit - Standard With P.A.A. - (76 SQM)	Student Space (35)	
OS 602 13492 - OS 602 13492 - Learning Unit - Standard With P.A.A. - (76 SQM)	Student Space (35)	
OS 602 18236 - OS 602 18236 - Learning Unit - Standard With P.A.A. - (76 SQM)	Student Space (35)	
OS 603 16834 - OS 603 16834 - Learning Unit - Standard With P.A.A. A/C - (76 SQM)	Student Space (35)	
OS 606 19047 - OS 606 19047 - Learning Unit - Standard With P.A.A A/C - (76 SQM)	Student Space (35)	
OS 606 19048 - OS 606 19048 - Learning Unit - Standard With P.A.A A/C - (76 SQM)	Student Space (35)	
OS 606 19164 - OS 606 19164 - Learning Unit - Standard With P.A.A A/C - (76 SQM)	Student Space (35)	
OS 606 19174 - OS 606 19174 - Learning Unit - Standard With P.A.A A/C - (76 SQM)	Student Space (35)	
OS 606 19176 - OS 606 19176 - Learning Unit - Standard With P.A.A A/C - (76 SQM)	Student Space (35)	
OS 606 19179 - OS 606 19179 - Learning Unit - Standard With P.A.A A/C - (76 SQM)	Student Space (35)	
OS 751 14367 - OS 751 14367 - Learning Unit - ESL - (76 SQM)	Student Space (35)	