

VENTILATION AUDIT REPORT

SCHOOL:	Lewisham Public School (4369)
AMU REGION:	Sydney
STATE ELECTORATE:	Summer Hill
LOCAL GOVERNMENT AREA:	Inner West

4369 - Lewisham Public School
Site Plan (12764)

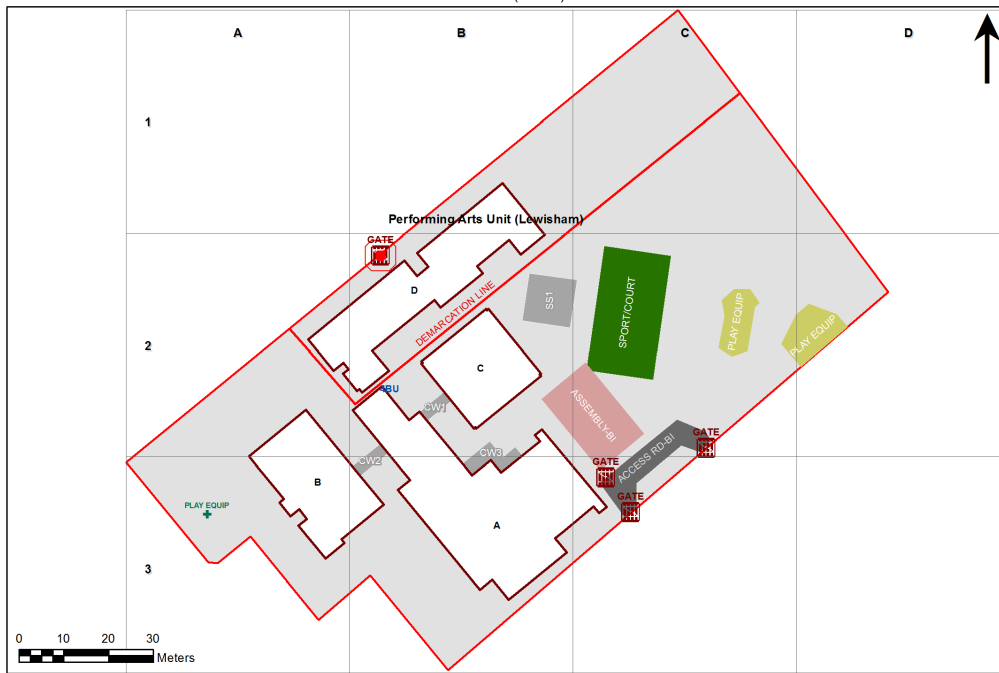







1:793

Printed: 21-Mar-2020

Ventilation Audit Key

Category	Description
	Category A Operate this space in line with COVID safe school operations . It has the required level of natural ventilation. NB. Circulation and storage areas should not be used for groups or gatherings.
	Category B This space should be occupied at 1 person per 4m ² to comply with COVID safe school operations and the guided use of spaces . The report details the number of people who can be accommodated safely in each of the identified spaces.

Entity Location	Audit Condition Classification (Capacity)	Comment
B00A - R0006 - Movement - (10.79 SQM)	Not Applicable	Circulation or storage space.
B00A - R0013 - Teachers Aide Special Ed - (16.06 SQM)	Office (4)	
B00A - R0014 - Home Base - M - (51.63 SQM) - Teaching Space: 1	Student Space (23)	
B00A - R0015 - Practical Activities - M - 1hb - (18.83 SQM)	Student Space (8)	
B00A - R0018 - Movement - (9.44 SQM)	Not Applicable	Circulation or storage space.
B00A - R0025 - Canteen - (45.06 SQM)	Not Applicable	Circulation or storage space.
B00A - R0031 - Communal Space - (256.63 SQM)	Student Space (119)	
B00A - R0032 - Raised Platform - (105.55 SQM)	Not Applicable	Circulation or storage space.
B00A - R0034 - Movement - (8.35 SQM)	Not Applicable	Circulation or storage space.
B00A - R1001 - Movement - (14.24 SQM)	Not Applicable	Circulation or storage space.
B00A - R1002 - Movement - (44.84 SQM)	Not Applicable	Circulation or storage space.
B00A - R1004 - Practical Activities - 1hb - (18.8 SQM)	Student Space (8)	
B00A - R1005 - Home Base - (51.94 SQM) - Teaching Space: 1	Student Space (24)	
B00A - R1006 - Home Base - (51.87 SQM) - Teaching Space: 1	Student Space (24)	
B00A - R1007 - Practical Activities - 1hb - (18.64 SQM)	Student Space (8)	
B00A - R1008 - Withdrawal Space - 1hb - (9.07 SQM)	Student Space (4)	
B00A - R1010 - Home Base - (51.71 SQM) - Teaching Space: 1	Student Space (23)	
B00A - R1011 - Practical Activities - 1hb - (18.4 SQM)	Student Space (8)	
B00A - R1015 - Withdrawal Space - 1hb - (15.46 SQM)	Student Space (7)	
B00A - R1016 - Home Base - (51.64 SQM) - Teaching Space: 1	Student Space (23)	
B00A - R1017 - Practical Activities - 1hb - (18.56 SQM)	Student Space (8)	
B00A - R1018 - Movement - (72.49 SQM)	Not Applicable	Circulation or storage space.
B00A - R1019 - Movement - (7.37 SQM)	Not Applicable	Circulation or storage space.
B00A - R1021 - Practical Activities - 1hb - (18.56 SQM)	Student Space (8)	
B00A - R1022 - Home Base - (51.87 SQM) - Teaching Space: 1	Student Space (24)	
B00A - R1023 - Home Base - (51.79 SQM) - Teaching Space: 1	Student Space (24)	
B00A - R1024 - Practical Activities - 1hb - (18.49 SQM)	Student Space (8)	
B00B - R0001 - Home Base - (66.69 SQM) - Teaching Space: 1	Student Space (30)	
B00B - R0002 - Practical Activities - 1hb - (22.98 SQM)	Student Space (10)	
B00B - R0007 - Movement - (61.05 SQM)	Not Applicable	Circulation or storage space.
B00B - R0008 - Home Base - (73.71 SQM) - Teaching Space: 1	Student Space (34)	
B00B - R0010 - Practical Activities - 1hb - (16.71 SQM)	Student Space (7)	
B00B - R0011 - Practical Activities - 1hb - (16.71 SQM)	Student Space (7)	
B00B - R0013 - Home Base - (73.71 SQM) - Teaching Space: 1	Student Space (34)	
B00C - R0001 - Deputy Principal - (11.36 SQM)	Office (2)	
B00C - R0002 - Movement - (22.82 SQM)	Not Applicable	Circulation or storage space.
B00C - R0003 - Staff Kitchen - (11.49 SQM)	Office (2)	
B00C - R0004 - Staff Room - (109 SQM)	Office (27)	
B00C - R0008 - Deputy Principal - (11.33 SQM)	Office (2)	
B00C - R0009 - Movement - (17.31 SQM)	Not Applicable	Circulation or storage space.
B00C - R0011 - Principal - (15.46 SQM)	Office (3)	
B00C - R0013 - Entry Vestibule - (21.47 SQM)	Not Applicable	Circulation or storage space.
B00C - R0014 - Clerical Office/Workroom - (8.36 SQM)	Office (2)	
B00C - R0015 - Clerical Office - (12.39 SQM)	Office (3)	
B00C - R0016 - Duplicating Workroom - (21.82 SQM)	Office (5)	
B00C - R0020 - Sick Bay - (12.21 SQM)	Student Space (5)	
B00C - R1001 - Seminar/Study - (19.59 SQM)	Office (4)	
B00C - R1002 - Seminar/Study - (16.15 SQM)	Office (4)	
B00C - R1003 - Reading Area - (236.14 SQM)	Student Space (109)	

Entity Location	Audit Condition Classification (Capacity)	Comment
B00C - R1005 - Movement - (12.01 SQM)	Not Applicable	Circulation or storage space.
B00D - M0001 - Movement - (10.01 SQM)	Not Applicable	Circulation or storage space.
B00D - M1001 - Movement - (10.47 SQM)	Not Applicable	Circulation or storage space.
B00D - R0015 - Special Programs Room - (29.75 SQM)	 Student Space (13)	
B00D - R0016 - Home Base - (41.41 SQM) - Teaching Space: 1	 Student Space (19)	
B00D - R0017 - Practical Activities - 1hb - (32.18 SQM)	 Student Space (14)	
B00D - R0018 - Home Base - (38.29 SQM) - Teaching Space: 1	 Student Space (17)	
B00D - R0020 - Staff Kitchen - (18.43 SQM)	 Office (4)	
B00D - R0022 - Movement - (5.12 SQM)	Not Applicable	Circulation or storage space.
B00D - R1001 - Movement - (47.36 SQM)	Not Applicable	Circulation or storage space.
B00D - R1005 - Home Base - (62.81 SQM) - Teaching Space: 1	 Student Space (29)	
B00D - R1008 - Movement - (74.25 SQM)	Not Applicable	Circulation or storage space.
B00D - R1028 - Movement - (5.14 SQM)	Not Applicable	Circulation or storage space.
B00D - R2001 - Movement - (45.47 SQM)	Not Applicable	Circulation or storage space.
B00D - R2005 - Home Base - (62.8 SQM) - Teaching Space: 1	 Student Space (29)	
B00D - R2008 - Movement - (60.32 SQM)	Not Applicable	Circulation or storage space.