

VENTILATION AUDIT REPORT

SCHOOL:	Lawson Public School (2381)
AMU REGION:	Western Sydney
STATE ELECTORATE:	Blue Mountains
LOCAL GOVERNMENT AREA:	Blue Mountains

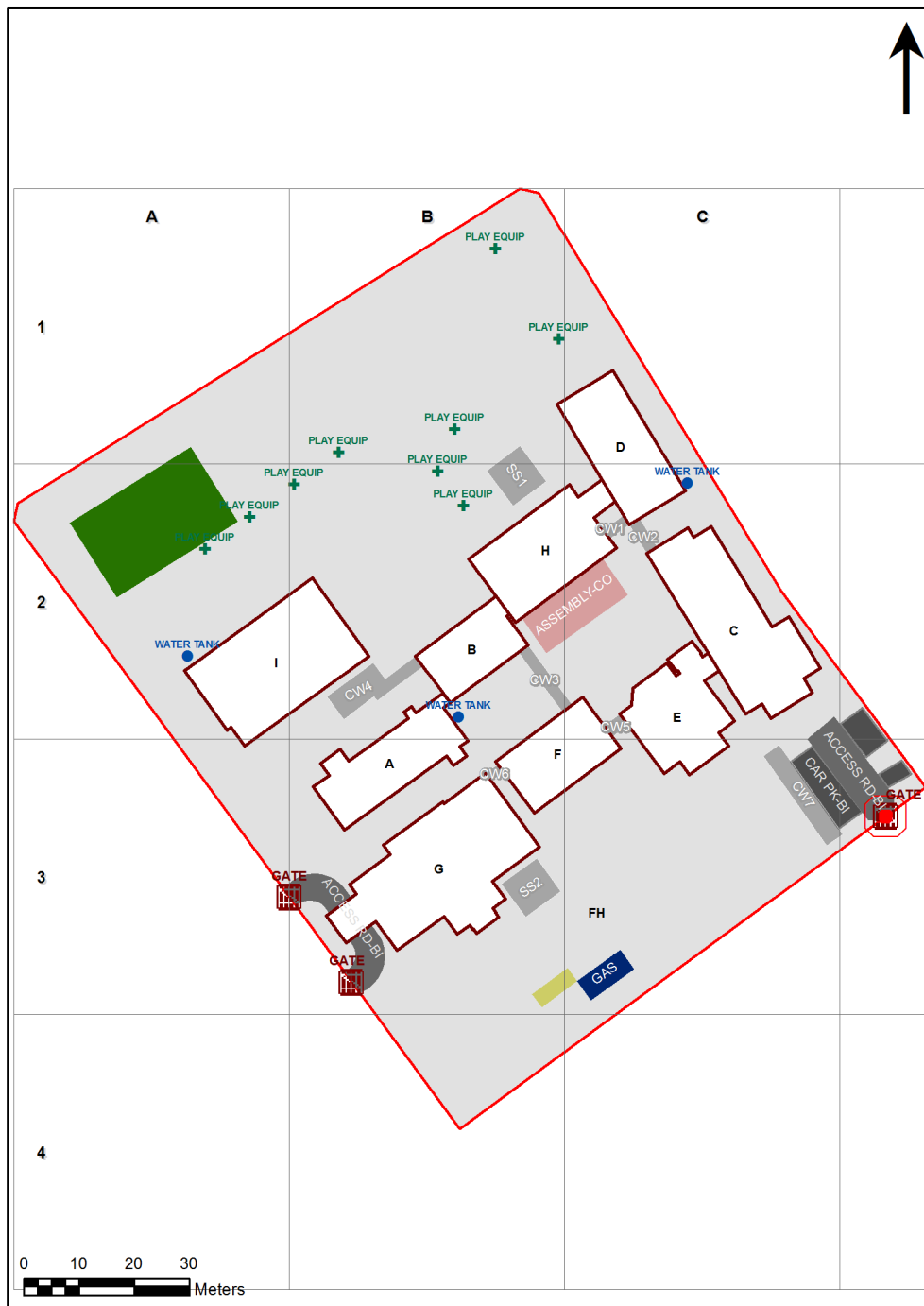

2381 - Lawson Public School
Site Plan (12759)



1:861

Printed: 21-Mar-2020

Ventilation Audit Key

Category	Description
	Category A Operate this space in line with COVID safe school operations . It has the required level of natural ventilation. NB. Circulation and storage areas should not be used for groups or gatherings.
	Category B This space should be occupied at 1 person per 4m ² to comply with COVID safe school operations and the guided use of spaces . The report details the number of people who can be accommodated safely in each of the identified spaces.

Entity Location	Audit Condition Classification (Capacity)	Comment
B00A - R0001 - Movement - (26.07 SQM)	Not Applicable	Circulation or storage space.
B00A - R0004 - Home Base - (69.68 SQM) - Teaching Space: 1	● Student Space (32)	
B00A - R0005 - Movement - (40.58 SQM)	Not Applicable	Circulation or storage space.
B00A - R0006 - Home Base - (71.63 SQM) - Teaching Space: 1	● Student Space (33)	
B00A - R0008 - Staff Room Annexe - (12.42 SQM)	● Office (3)	
B00A - R0009 - Practical Activities - 1hb - (6.58 SQM)	● Student Space (3)	
B00B - R0001 - Movement - (109.55 SQM)	Not Applicable	Circulation or storage space.
B00B - R0005 - Special Programs Room - (32.85 SQM)	● Student Space (15)	
B00C - R0001 - Movement - (85.1 SQM)	Not Applicable	Circulation or storage space.
B00C - R0002 - Staff Room - (49.14 SQM)	● Office (12)	
B00C - R0008 - Interview - (13.15 SQM)	● Office (3)	
B00C - R0009 - Entry Vestibule - (27.55 SQM)	Not Applicable	Circulation or storage space.
B00C - R0010 - Sick Bay - (8.71 SQM)	● Student Space (4)	
B00C - R0012 - Duplicating Workroom - (20.92 SQM)	● Office (5)	
B00C - R0013 - Principal - (17.03 SQM)	● Office (4)	
B00C - R0014 - Clerical Office - (17.77 SQM)	● Office (4)	
B00C - R0015 - Movement - (7.51 SQM)	Not Applicable	Circulation or storage space.
B00C - R0018 - Movement - (16.55 SQM)	Not Applicable	Circulation or storage space.
B00C - R0019 - Staff Room Annexe - (13.45 SQM)	● Office (3)	
B00C - R0020 - Staff Room Annexe - (13.36 SQM)	● Office (3)	
B00C - R0021 - Staff Room Annexe - (19.12 SQM)	● Office (4)	
B00C - R1001 - Movement - (41.82 SQM)	Not Applicable	Circulation or storage space.
B00C - R1004 - Practical Activities - 1hb - (20.35 SQM)	● Student Space (9)	
B00C - R1005 - Home Base - (58.52 SQM) - Teaching Space: 1	● Student Space (27)	
B00C - R1007 - Withdrawal Space - 1hb - (11.82 SQM)	● Student Space (5)	
B00C - R1009 - Home Base - (58.52 SQM) - Teaching Space: 1	● Student Space (27)	
B00C - R1010 - Practical Activities - 1hb - (20.27 SQM)	● Student Space (9)	
B00D - R0002 - Movement - (85.72 SQM)	Not Applicable	Circulation or storage space.
B00D - R0013 - Canteen - (26.17 SQM)	Not Applicable	Circulation or storage space.
B00E - R0002 - Practical Activities - 1hb - (20.27 SQM)	● Student Space (9)	
B00E - R0003 - Home Base - (58.14 SQM) - Teaching Space: 1	● Student Space (26)	
B00E - R0005 - Withdrawal Space - 1hb - (11.67 SQM)	● Student Space (5)	
B00E - R0007 - Home Base - (58.52 SQM) - Teaching Space: 1	● Student Space (27)	
B00E - R0008 - Practical Activities - 1hb - (20.27 SQM)	● Student Space (9)	
B00E - R0009 - Movement - (47.06 SQM)	Not Applicable	Circulation or storage space.
B00E - R0010 - Movement - (10.7 SQM)	Not Applicable	Circulation or storage space.
B00E - R0011 - Movement - (13.44 SQM)	Not Applicable	Circulation or storage space.
B00E - R1002 - Practical Activities - 1hb - (20.28 SQM)	● Student Space (9)	
B00E - R1003 - Home Base - (58.52 SQM) - Teaching Space: 1	● Student Space (27)	
B00E - R1005 - Withdrawal Space - 1hb - (11.82 SQM)	● Student Space (5)	
B00E - R1007 - Home Base - (58.52 SQM) - Teaching Space: 1	● Student Space (27)	
B00E - R1008 - Practical Activities - 1hb - (20.28 SQM)	● Student Space (9)	
B00E - R1009 - Movement - (58.86 SQM)	Not Applicable	Circulation or storage space.
B00F - R0001 - Movement - (76.5 SQM)	Not Applicable	Circulation or storage space.
B00F - R0002 - Reading Area - (88.41 SQM)	● Student Space (41)	
B00G - R0001 - Movement - (15.07 SQM)	Not Applicable	Circulation or storage space.
B00G - R0002 - Withdrawal - S - (8.61 SQM)	● Student Space (3)	
B00G - R0004 - Home Base - S - (49.84 SQM) - Teaching Space: 1	● Student Space (23)	

Entity Location	Audit Condition Classification (Capacity)	Comment
B00G - R0005 - Practical Activities - S - 1hb - (13.07 SQM)	● Student Space (6)	
B00G - R0007 - Staff Room Annexe - (9.31 SQM)	● Office (2)	
B00G - R0008 - Home Base - S - (49.7 SQM) - Teaching Space: 1	● Student Space (23)	
B00G - R0009 - Practical Activities - S - 1hb - (13.04 SQM)	● Student Space (6)	
B00G - R0015 - Practical Activities - S - 1hb - (63.79 SQM)	● Student Space (29)	
B00G - R0016 - Practical Activities - S - 1hb - (12.98 SQM)	● Student Space (6)	
B00G - R0017 - Home Base - S - (48.71 SQM) - Teaching Space: 1	● Student Space (22)	
B00G - R0018 - Staff Room Annexe - (9.31 SQM)	● Office (2)	
B00G - R0023 - Movement - (30.31 SQM)	Not Applicable	Circulation or storage space.
B00G - R0024 - Outdoor Learning Area - (52.68 SQM)	Not Applicable	Circulation or storage space.
B00H - R0001 - Home Base - (57.92 SQM) - Teaching Space: 1	● Student Space (26)	
B00H - R0004 - Movement - (6.51 SQM)	Not Applicable	Circulation or storage space.
B00H - R0008 - Home Base - (56.88 SQM) - Teaching Space: 1	● Student Space (26)	
B00H - R0014 - Movement - (64.25 SQM)	Not Applicable	Circulation or storage space.
B00I - R0001 - Communal Space - (146.33 SQM)	● Student Space (67)	
B00I - R0002 - Raised Platform - (56.92 SQM)	Not Applicable	Circulation or storage space.
B00I - R0003 - Movement - (7.79 SQM)	Not Applicable	Circulation or storage space.
B00I - R0004 - Movement - (11.53 SQM)	Not Applicable	Circulation or storage space.
B00I - R0005 - Movement - (13.9 SQM)	Not Applicable	Circulation or storage space.