

VENTILATION AUDIT REPORT

SCHOOL:	Kurrajong Public School (2342)
AMU REGION:	Western Sydney
STATE ELECTORATE:	Hawkesbury
LOCAL GOVERNMENT AREA:	Hawkesbury

2342 - Kurrajong Public School
Site Plan (12601)

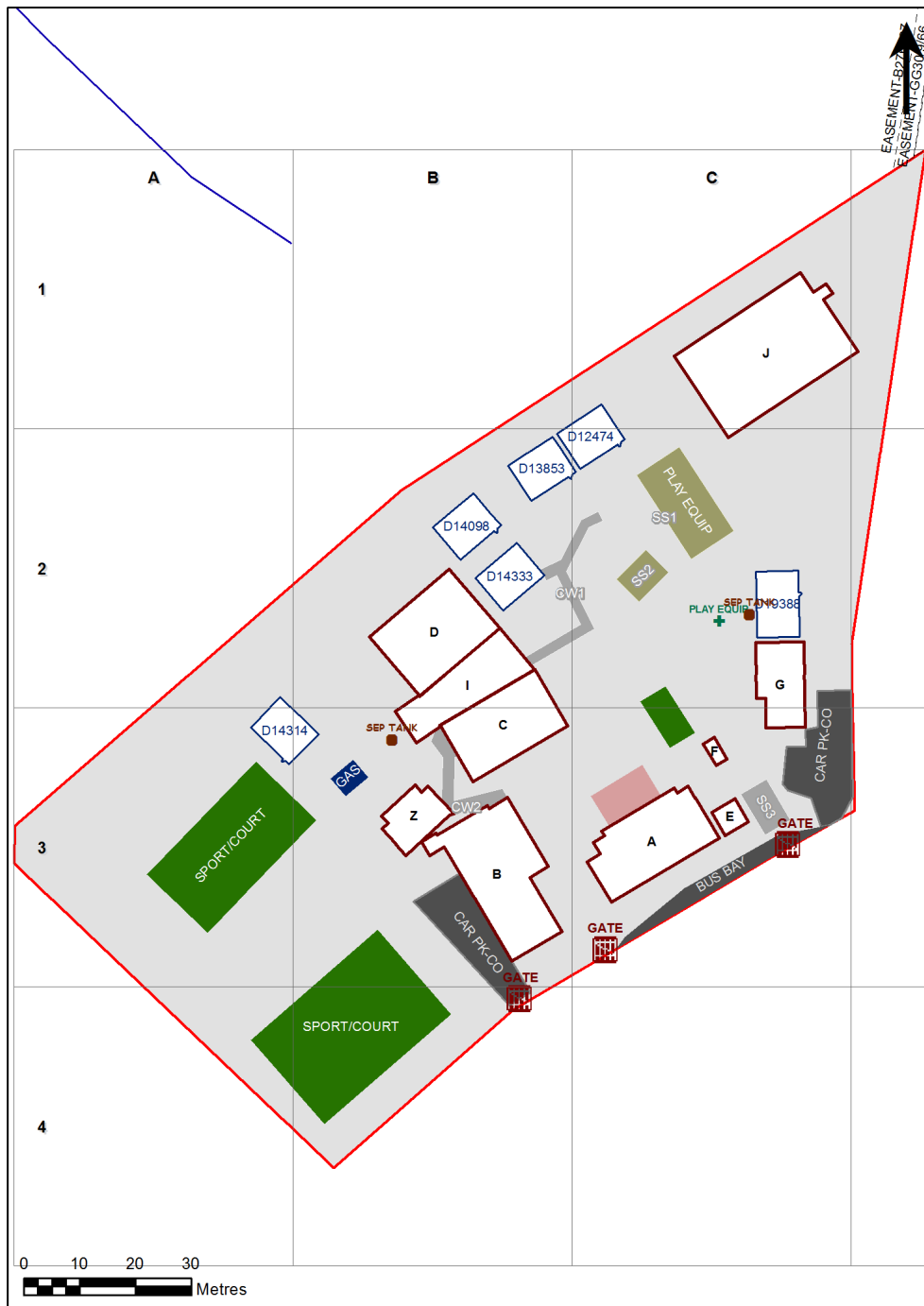

1:849

Printed: 24-Dec-2020

Ventilation Audit Key

Category	Description
	Category A Operate this space in line with COVID safe school operations . It has the required level of natural ventilation. NB. Circulation and storage areas should not be used for groups or gatherings.
	Category B This space should be occupied at 1 person per 4m ² to comply with COVID safe school operations and the guided use of spaces . The report details the number of people who can be accommodated safely in each of the identified spaces.

Entity Location	Audit Condition Classification (Capacity)	Comment
B00A - R0005 - Home Base - (56.22 SQM) - Teaching Space: 1	● Student Space (26)	
B00A - R0006 - Home Base - (56.38 SQM) - Teaching Space: 1	● Student Space (26)	
B00A - R0009 - Movement - (7.62 SQM)	Not Applicable	Circulation or storage space.
B00A - R0010 - Principal - (14.33 SQM)	● Office (3)	
B00A - R0011 - Clerical Office - (7.73 SQM)	● Office (1)	
B00B - R0003 - Special Programs Room - (28.21 SQM)	● Student Space (13)	
B00B - R0006 - Home Base - (56.42 SQM) - Teaching Space: 1	● Student Space (26)	
B00B - R0007 - Home Base - (83.66 SQM) - Teaching Space: 1	● Student Space (38)	
B00B - R9002 - Canteen - (34.38 SQM)	Not Applicable	Circulation or storage space.
B00B - R9003 - Special Programs Room - (13.95 SQM)	● Student Space (6)	
B00C - R0001 - Movement - (89.32 SQM)	Not Applicable	Circulation or storage space.
B00C - R0005 - Reading Area - (89.08 SQM)	● Student Space (41)	
B00D - R0002 - Home Base - (59.22 SQM) - Teaching Space: 1	● Student Space (27)	
B00D - R0003 - Practical Activities - 1hb - (18.11 SQM)	● Student Space (8)	
B00D - R0004 - Movement - (34.29 SQM)	Not Applicable	Circulation or storage space.
B00D - R0005 - Practical Activities - 1hb - (18.06 SQM)	● Student Space (8)	
B00D - R0006 - Home Base - (59.29 SQM) - Teaching Space: 1	● Student Space (27)	
B00D - R0008 - Movement - (13.97 SQM)	Not Applicable	Circulation or storage space.
B00D - R0009 - Withdrawal Space - 1hb - (11.85 SQM)	● Student Space (5)	
B00D - R0010 - Movement - (13.98 SQM)	Not Applicable	Circulation or storage space.
B00G - R0001 - Entry Vestibule - (10.82 SQM)	Not Applicable	Circulation or storage space.
B00G - R0002 - Clerical Office - (10.65 SQM)	● Office (2)	
B00G - R0005 - Sick Bay - (9 SQM)	● Student Space (4)	
B00G - R0008 - Principal - (14.53 SQM)	● Office (3)	
B00G - R0009 - Staff Room - (29.11 SQM)	● Office (7)	
B00G - R0010 - Staff Kitchen - (10.49 SQM)	● Office (2)	
B00I - R0001 - Raised Platform - (31.93 SQM)	Not Applicable	Circulation or storage space.
B00J - R0001 - Communal Space - (146.63 SQM)	● Student Space (68)	
B00J - R0002 - Raised Platform - (59.63 SQM)	Not Applicable	Circulation or storage space.
B00J - R0016 - Movement - (11.96 SQM)	Not Applicable	Circulation or storage space.
B00J - R0017 - Movement - (6.6 SQM)	Not Applicable	Circulation or storage space.
OS 601 14098 - OS 601 14098 - Learning Unit - Standard/Withdrawal - (76 SQM)	● Student Space (35)	
OS 601 14314 - OS 601 14314 - Learning Unit - Standard/Withdrawal - (76 SQM)	● Student Space (35)	
OS 601 14333 - OS 601 14333 - Learning Unit - Standard/Withdrawal - (76 SQM)	● Student Space (35)	
OS 602 12474 - OS 602 12474 - Learning Unit - Standard With P.A.A. - (76 SQM)	● Student Space (35)	
OS 602 13853 - OS 602 13853 - Learning Unit - Standard With P.A.A. - (76 SQM)	● Student Space (35)	
OS 621 19388 - OS 621 19388 - Learning Unit Single - PWD - (95 SQM)	● Student Space (44)	