

# VENTILATION AUDIT REPORT

<b>SCHOOL:</b>	<b>Kingsgrove North High School (8221)</b>
<b>AMU REGION:</b>	<b>Sydney</b>
<b>STATE ELECTORATE:</b>	<b>Canterbury</b>
<b>LOCAL GOVERNMENT AREA:</b>	<b>Canterbury-Bankstown</b>

8221 - Kingsgrove North High School  
Site Plan (12584)

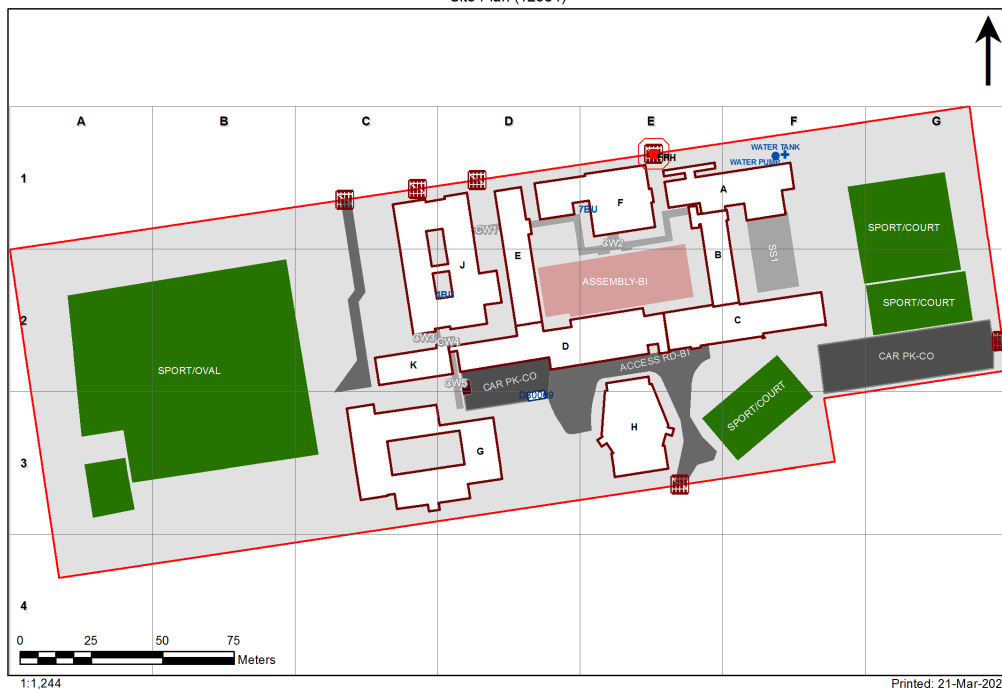

1:1,244

Printed: 21-Mar-2020

## Ventilation Audit Key

Category	Description
	Category A Operate this space in line with <a href="#">COVID safe school operations</a> . It has the required level of natural ventilation. NB. Circulation and storage areas should not be used for groups or gatherings.
	Category B This space should be occupied at 1 person per 4m <sup>2</sup> to comply with <a href="#">COVID safe school operations and the guided use of spaces</a> . The report details the number of people who can be accommodated safely in each of the identified spaces.

Entity Location	Audit Condition Classification (Capacity)	Comment
B00A - R0001 - General Learning Space - (54.9 SQM) - Teaching Space: 1	Student Space (25)	
B00A - R0003 - General Learning Space - (64.94 SQM) - Teaching Space: 1	Student Space (30)	
B00A - R0004 - General Learning Space - (48.74 SQM) - Teaching Space: 1	Student Space (22)	
B00A - R0012 - Administration - Clerical - (15.16 SQM)	Office (3)	
B00A - R0015 - Movement - (17.59 SQM)	Not Applicable	Circulation or storage space.
B00A - R0020 - Interview/Office - Type 1 - (10.34 SQM)	Office (2)	
B00A - R0021 - Interview/Office - Type 1 - (14.03 SQM)	Office (3)	
B00A - R0024 - Staff Kitchen - (5.72 SQM)	Office (1)	
B00A - R0025 - Deputy Principal Office - (17.14 SQM)	Office (4)	
B00A - R0026 - Principal Office - (24.73 SQM)	Office (6)	
B00A - R0027 - Deputy Principal Office - (13.51 SQM)	Office (3)	
B00A - R0032 - Movement - (30.81 SQM)	Not Applicable	Circulation or storage space.
B00A - R0033 - Public Reception - (21.36 SQM)	Not Applicable	Circulation or storage space.
B00A - R0034 - Administration - Clerical - (49.62 SQM)	Office (12)	
B00A - R1001 - Design L.S. - (65.67 SQM) - Teaching Space: 1	Student Space (30)	
B00A - R1004 - Design L.S. - (64.65 SQM) - Teaching Space: 1	Student Space (29)	
B00A - R1006 - General Learning Space - (65.01 SQM) - Teaching Space: 1	Student Space (30)	
B00A - R1007 - General Learning Space - (51.65 SQM) - Teaching Space: 1	Student Space (23)	
B00A - R1008 - General Learning Space - (65.09 SQM) - Teaching Space: 1	Student Space (30)	
B00A - R1009 - Movement - (55.4 SQM)	Not Applicable	Circulation or storage space.
B00B - R0001 - Movement - (72.13 SQM)	Not Applicable	Circulation or storage space.
B00B - R0002 - Clinic - Boys - (11.78 SQM)	Office (2)	
B00B - R0004 - Staff Study - (45.91 SQM)	Office (11)	
B00B - R0005 - Clinic - Girls - (16.54 SQM)	Office (4)	
B00B - R0006 - Staff Study - (22.49 SQM)	Office (5)	
B00B - R0007 - Staff Kitchen - (10.37 SQM)	Office (2)	
B00B - R0008 - Staff Study - (27.68 SQM)	Office (6)	
B00B - R0010 - Staff Study - (18.57 SQM)	Office (4)	
B00B - R0012 - Duplicating Workroom - (25.41 SQM)	Office (6)	
B00B - R1001 - Movement - (65.64 SQM)	Not Applicable	Circulation or storage space.
B00B - R1002 - Computer Learning Space - (52.15 SQM) - Teaching Space: 1	Student Space (24)	
B00B - R1003 - Computer Learning Space - (65.3 SQM) - Teaching Space: 1	Student Space (30)	
B00B - R1004 - Computer Learning Space - (65.37 SQM) - Teaching Space: 1	Student Space (30)	
B00B - R1006 - Staff Study - (19.27 SQM)	Office (4)	
B00C - R0004 - General Learning Space - (56.51 SQM) - Teaching Space: 1	Student Space (26)	
B00C - R0007 - Special Learning Space - (56.65 SQM) - Teaching Space: 1	Student Space (26)	
B00C - R0008 - Movement - (34.62 SQM)	Not Applicable	Circulation or storage space.
B00C - R0009 - Staff Study - (22.44 SQM)	Office (5)	
B00C - R0010 - Food Technology L.S. - (64.3 SQM) - Teaching Space: 1	Student Space (29)	
B00C - R0011 - Food/Research Space - (24.28 SQM)	Not Applicable	Circulation or storage space.
B00C - R0013 - Movement - (12.47 SQM)	Not Applicable	Circulation or storage space.
B00C - R0014 - Food Technology L.S. - (98.64 SQM) - Teaching Space: 1	Student Space (45)	
B00C - R0018 - Movement - (5.92 SQM)	Not Applicable	Circulation or storage space.
B00C - R0020 - Movement - (18.52 SQM)	Not Applicable	Circulation or storage space.
B00C - R0023 - Movement - (12.7 SQM)	Not Applicable	Circulation or storage space.
B00C - R0024 - Staff Kitchen - (13.16 SQM)	Office (3)	
B00C - R1002 - General Learning Space - (51.93 SQM) - Teaching Space: 1	Student Space (24)	
B00C - R1003 - General Learning Space - (52.08 SQM) - Teaching Space: 1	Student Space (24)	
B00C - R1004 - General Learning Space - (65.21 SQM) - Teaching Space: 1	Student Space (30)	

Entity Location	Audit Condition Classification (Capacity)	Comment
B00C - R1005 - General Learning Space - (65.28 SQM) - Teaching Space: 1	● Student Space (30)	
B00C - R1007 - Movement - (50.33 SQM)	Not Applicable	Circulation or storage space.
B00D - R0001 - Movement - (57.56 SQM)	Not Applicable	Circulation or storage space.
B00D - R0004 - Senior Study - (69.02 SQM)	● Office (17)	
B00D - R0006 - Movement - (61.69 SQM)	Not Applicable	Circulation or storage space.
B00D - R0012 - Laboratory L.S. - (42.19 SQM) - Teaching Space: 1	● Student Space (19)	
B00D - R0013 - Laboratory L.S. - (93.85 SQM) - Teaching Space: 1	● Student Space (43)	
B00D - R0014 - Preparation - (23.78 SQM)	Not Applicable	Circulation or storage space.
B00D - R0016 - Student Canteen - (51.03 SQM)	Not Applicable	Circulation or storage space.
B00D - R0024 - Movement - (30.74 SQM)	Not Applicable	Circulation or storage space.
B00D - R1002 - Interview/Office - Type 1 - (12.04 SQM)	● Office (3)	
B00D - R1003 - General Learning Space - (52.07 SQM) - Teaching Space: 1	● Student Space (24)	
B00D - R1004 - General Learning Space - (51.86 SQM) - Teaching Space: 1	● Student Space (24)	
B00D - R1007 - Study Space - (15.93 SQM)	Not Applicable	Circulation or storage space.
B00D - R1008 - General Learning Space - (51.92 SQM) - Teaching Space: 1	● Student Space (24)	
B00D - R1009 - General Learning Space - (51.78 SQM) - Teaching Space: 1	● Student Space (24)	
B00D - R1013 - General Learning Space - (65.58 SQM) - Teaching Space: 1	● Student Space (30)	
B00D - R1016 - General Learning Space - (51.86 SQM) - Teaching Space: 1	● Student Space (24)	
B00D - R1019 - Movement - (173 SQM)	Not Applicable	Circulation or storage space.
B00E - R0001 - Music Learning Space - (81.2 SQM) - Teaching Space: 1	● Student Space (37)	
B00E - R0004 - Movement - (5.21 SQM)	Not Applicable	Circulation or storage space.
B00E - R0005 - Laboratory L.S. - (87.4 SQM) - Teaching Space: 1	● Student Space (40)	
B00E - R0006 - Preparation - (24.59 SQM)	Not Applicable	Circulation or storage space.
B00E - R0009 - Movement - (10.31 SQM)	Not Applicable	Circulation or storage space.
B00E - R0018 - Laboratory L.S. - (93.9 SQM) - Teaching Space: 1	● Student Space (43)	
B00E - R0019 - Movement - (39.66 SQM)	Not Applicable	Circulation or storage space.
B00E - R0020 - Movement - (40.97 SQM)	Not Applicable	Circulation or storage space.
B00E - R1001 - Music Learning Space - (65.58 SQM) - Teaching Space: 1	● Student Space (30)	
B00E - R1002 - Music Learning Space - (52.28 SQM) - Teaching Space: 1	● Student Space (24)	
B00E - R1006 - Staff Study - (8.91 SQM)	● Office (2)	
B00E - R1007 - Staff Study - (19.11 SQM)	● Office (4)	
B00E - R1008 - General Learning Space - (38.96 SQM) - Teaching Space: 1	● Student Space (18)	
B00E - R1009 - General Learning Space - (52.21 SQM) - Teaching Space: 1	● Student Space (24)	
B00E - R1010 - General Learning Space - (52.22 SQM) - Teaching Space: 1	● Student Space (24)	
B00E - R1011 - Staff Study - (20.96 SQM)	● Office (5)	
B00E - R1013 - Movement - (76.2 SQM)	Not Applicable	Circulation or storage space.
B00F - R0001 - Main Area - (206.49 SQM)	Not Applicable	Circulation or storage space.
B00F - R0005 - Workroom - (50.11 SQM)	● Office (12)	
B00F - R0009 - Audio Visual Workroom - (47.59 SQM)	● Student Space (22)	
B00F - R0011 - Commonroom - (142.42 SQM)	● Office (35)	
B00F - R0017 - Movement - (59.63 SQM)	Not Applicable	Circulation or storage space.
B00F - R0018 - Movement - (12.72 SQM)	Not Applicable	Circulation or storage space.
B00F - R1001 - Seminar - (16.33 SQM)	● Office (4)	
B00F - R1002 - Seminar - (16.69 SQM)	● Office (4)	
B00F - R1003 - Staff Study - (16.61 SQM)	● Office (4)	
B00F - R1004 - Seminar - (16.73 SQM)	● Office (4)	
B00F - R1005 - Seminar - (16.33 SQM)	● Office (4)	
B00F - R1006 - Main Area - (204.37 SQM)	Not Applicable	Circulation or storage space.

Entity Location	Audit Condition Classification (Capacity)	Comment
B00F - R1009 - Seminar - (12.57 SQM)	Office (3)	
B00F - R1010 - Seminar - (12.06 SQM)	Office (3)	
B00G - R0001 - Design L.S. - (56.27 SQM) - Teaching Space: 1	Student Space (26)	
B00G - R0002 - Staff Study - (28.42 SQM)	Office (7)	
B00G - R0006 - Design L.S. - (56.36 SQM) - Teaching Space: 1	Student Space (26)	
B00G - R0007 - Materials Technology L.S. - (91.02 SQM) - Teaching Space: 1	Student Space (42)	
B00G - R0008 - Wood Technology Bay - (33.81 SQM)	Not Applicable	Circulation or storage space.
B00G - R0009 - Materials Technology L.S. - (91.03 SQM) - Teaching Space: 1	Student Space (42)	
B00G - R0014 - Materials Technology L.S. - (91.02 SQM) - Teaching Space: 1	Student Space (42)	
B00G - R0015 - Metal Technology Bay - (37.34 SQM)	Not Applicable	Circulation or storage space.
B00G - R0016 - Materials Technology L.S. - (91.02 SQM) - Teaching Space: 1	Student Space (42)	
B00G - R0019 - Materials Technology L.S. - (70.62 SQM) - Teaching Space: 1	Student Space (32)	
B00G - R0020 - Movement - (6.09 SQM)	Not Applicable	Circulation or storage space.
B00G - R0023 - Materials Technology L.S. - (49.5 SQM) - Teaching Space: 1	Student Space (22)	
B00G - R0028 - Movement - (279.95 SQM)	Not Applicable	Circulation or storage space.
B00H - R0002 - Multi-Purpose Space - (429.71 SQM)	Student Space (199)	
B00H - R0003 - Staff Kitchen - (8.93 SQM)	Office (2)	
B00H - R0006 - Pupil Entry - (18.16 SQM)	Not Applicable	Circulation or storage space.
B00H - R0013 - Stage - (108.2 SQM)	Not Applicable	Circulation or storage space.
B00J - R0001 - Art Learning Space - (59.63 SQM) - Teaching Space: 1	Student Space (27)	
B00J - R0003 - Staff Study - (25.71 SQM)	Office (6)	
B00J - R0005 - Laboratory L.S. - (85.94 SQM) - Teaching Space: 1	Student Space (39)	
B00J - R0008 - Laboratory L.S. - (91.96 SQM) - Teaching Space: 1	Student Space (42)	
B00J - R0010 - General Learning Space - (52.22 SQM) - Teaching Space: 1	Student Space (24)	
B00J - R0011 - Staff Study - (27.56 SQM)	Office (6)	
B00J - R0015 - Staff Study - (25.9 SQM)	Office (6)	
B00J - R0017 - Art Learning Space - (66.39 SQM) - Teaching Space: 1	Student Space (30)	
B00J - R0021 - Art Learning Space - (58.91 SQM) - Teaching Space: 1	Student Space (27)	
B00J - R0024 - Art Learning Space - (52.14 SQM) - Teaching Space: 1	Student Space (24)	
B00J - R0025 - Darkroom Space - (25.5 SQM)	Office (6)	
B00J - R0031 - Preparation - Science - (38.95 SQM)	Not Applicable	Circulation or storage space.
B00J - R0033 - Movement - (262.35 SQM)	Not Applicable	Circulation or storage space.
B00J - R1001 - General Learning Space - (59.39 SQM) - Teaching Space: 1	Student Space (27)	
B00J - R1002 - Staff Study - (18.45 SQM)	Office (4)	
B00J - R1003 - General Learning Space - (52.14 SQM) - Teaching Space: 1	Student Space (24)	
B00J - R1004 - General Learning Space - (52.14 SQM) - Teaching Space: 1	Student Space (24)	
B00J - R1005 - Staff Study - (19.19 SQM)	Office (4)	
B00J - R1006 - General Learning Space - (52 SQM) - Teaching Space: 1	Student Space (24)	
B00J - R1007 - General Learning Space - (52.87 SQM) - Teaching Space: 1	Student Space (24)	
B00J - R1008 - Staff Study - (25.71 SQM)	Office (6)	
B00J - R1013 - Staff Study - (16.73 SQM)	Office (4)	
B00J - R1015 - General Learning Space - (52 SQM) - Teaching Space: 1	Student Space (24)	
B00J - R1018 - General Learning Space - (52.29 SQM) - Teaching Space: 1	Student Space (24)	
B00J - R1019 - General Learning Space - (52.29 SQM) - Teaching Space: 1	Student Space (24)	
B00J - R1020 - General Learning Space - (52.44 SQM) - Teaching Space: 1	Student Space (24)	
B00J - R1021 - General Learning Space - (59.46 SQM) - Teaching Space: 1	Student Space (27)	
B00J - R1022 - Staff Study - (25.81 SQM)	Office (6)	

Entity Location	Audit Condition Classification (Capacity)	Comment
B00J - R1026 - Movement - (241.26 SQM)	Not Applicable	Circulation or storage space.
B00K - R0002 - Movement - (46.73 SQM)	Not Applicable	Circulation or storage space.
B00K - R0006 - Staff Study - (34.64 SQM)	Office (8)	
B00K - R0011 - Laboratory L.S. - (98.55 SQM) - Teaching Space: 1	Student Space (45)	
B00K - R0012 - Preparation - (32.64 SQM)	Not Applicable	Circulation or storage space.
B00K - R1002 - Movement - (46.71 SQM)	Not Applicable	Circulation or storage space.
B00K - R1003 - General Learning Space - (52.14 SQM) - Teaching Space: 1	Student Space (24)	
B00K - R1004 - General Learning Space - (52.14 SQM) - Teaching Space: 1	Student Space (24)	
B00K - R1005 - General Learning Space - (52.22 SQM) - Teaching Space: 1	Student Space (24)	
B00K - R9003 - Movement - (79.16 SQM)	Not Applicable	Circulation or storage space.
B00K - R9008 - General Assistants - (8.95 SQM)	Office (2)	
B00K - R9012 - Movement - (21.8 SQM)	Not Applicable	Circulation or storage space.