

VENTILATION AUDIT REPORT

SCHOOL:	Kempsey West Public School (2279)
AMU REGION:	North Coast
STATE ELECTORATE:	Oxley
LOCAL GOVERNMENT AREA:	Kempsey

2279 - Kempsey West Public School
Site Plan (10993)

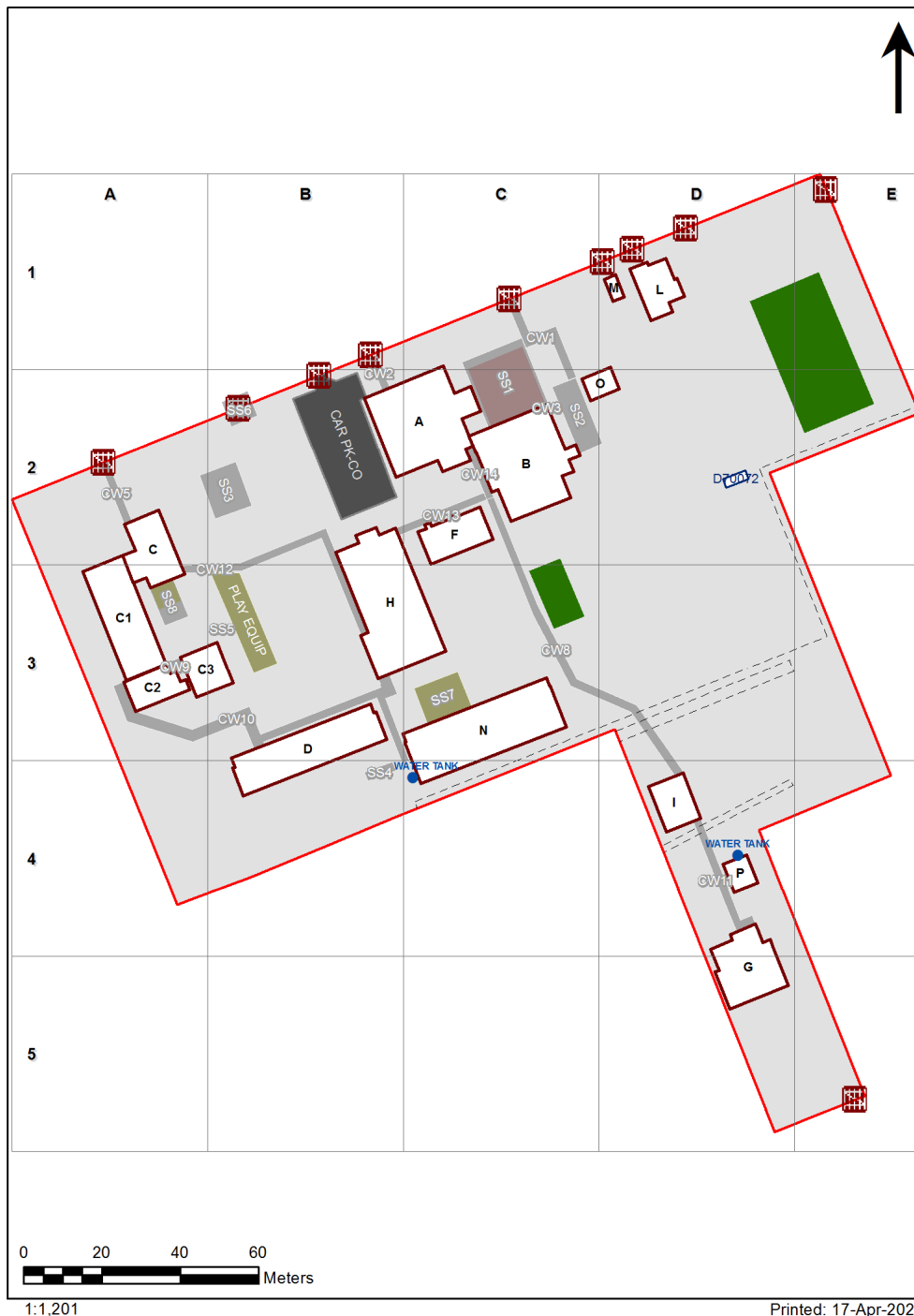

1:1,201

Printed: 17-Apr-2020

Ventilation Audit Key

Category	Description
	Category A Operate this space in line with COVID safe school operations . It has the required level of natural ventilation. NB. Circulation and storage areas should not be used for groups or gatherings.
	Category B This space should be occupied at 1 person per 4m ² to comply with COVID safe school operations and the guided use of spaces . The report details the number of people who can be accommodated safely in each of the identified spaces.

Entity Location	Audit Condition Classification (Capacity)	Comment
B00A - R0005 - Principal - (19 SQM)	Office (4)	
B00A - R0008 - Sick Bay - (7.82 SQM)	Student Space (3)	
B00A - R0009 - Clerical Office - (13.02 SQM)	Office (3)	
B00A - R0010 - Entry Vestibule - (14.43 SQM)	Not Applicable	Circulation or storage space.
B00A - R0011 - Clerical Office - (13.84 SQM)	Office (3)	
B00A - R0012 - Interview - (14 SQM)	Office (3)	
B00A - R0017 - Staff Room - (56.88 SQM)	Office (14)	
B00A - R0019 - Duplicating Workroom - (16.16 SQM)	Office (4)	
B00A - R0022 - Staff Room Annexe - (13.33 SQM)	Office (3)	
B00A - R0023 - Movement - (30.03 SQM)	Not Applicable	Circulation or storage space.
B00A - R1001 - Reading Area - (185.74 SQM)	Student Space (86)	
B00A - R1002 - Reading Area - (52.65 SQM)	Student Space (24)	
B00A - R1005 - Movement - (26.09 SQM)	Not Applicable	Circulation or storage space.
B00A - R1013 - Movement - (18.38 SQM)	Not Applicable	Circulation or storage space.
B00B - R0006 - Movement - (33.98 SQM)	Not Applicable	Circulation or storage space.
B00B - R0007 - Home Base - (66.02 SQM) - Teaching Space: 1	Student Space (30)	
B00B - R0008 - Special Programs Room - (66.03 SQM)	Student Space (30)	
B00B - R0016 - Movement - (7.01 SQM)	Not Applicable	Circulation or storage space.
B00B - R0018 - Home Base - M - (64.29 SQM) - Teaching Space: 1	Student Space (29)	
B00B - R1001 - Home Base - (65.84 SQM) - Teaching Space: 1	Student Space (30)	
B00B - R1002 - Home Base - (65.84 SQM) - Teaching Space: 1	Student Space (30)	
B00B - R1003 - Movement - (49.86 SQM)	Not Applicable	Circulation or storage space.
B00B - R1006 - Home Base - (65.84 SQM) - Teaching Space: 1	Student Space (30)	
B00B - R1007 - Home Base - (65.85 SQM) - Teaching Space: 1	Student Space (30)	
B00B - R1008 - Movement - (18.73 SQM)	Not Applicable	Circulation or storage space.
B00C - R0002 - Staff Room - (19.93 SQM)	Office (4)	
B00C - R0003 - Interview - (19.08 SQM)	Office (4)	
B00C - R0006 - Movement - (17.59 SQM)	Not Applicable	Circulation or storage space.
B00D - R0002 - Withdrawal Space - 1hb - (22.41 SQM)	Student Space (10)	
B00D - R0003 - Practical Activities - 1hb - (16.35 SQM)	Student Space (7)	
B00D - R0004 - Practical Activities - 1hb - (16.35 SQM)	Student Space (7)	
B00D - R0005 - Movement - (6.7 SQM)	Not Applicable	Circulation or storage space.
B00D - R0006 - Practical Activities - 1hb - (16.35 SQM)	Student Space (7)	
B00D - R0007 - Practical Activities - 1hb - (21.9 SQM)	Student Space (10)	
B00D - R0010 - Staff Room Annexe - (12.68 SQM)	Office (3)	
B00D - R0011 - Home Base - (53.67 SQM) - Teaching Space: 1	Student Space (24)	
B00D - R0012 - Home Base - (53.67 SQM) - Teaching Space: 1	Student Space (24)	
B00D - R0013 - Movement - (9.17 SQM)	Not Applicable	Circulation or storage space.
B00D - R0014 - Staff Room Annexe - (12.53 SQM)	Office (3)	
B00D - R0015 - Home Base - (53.67 SQM) - Teaching Space: 1	Student Space (24)	
B00D - R0016 - Home Base - (53.67 SQM) - Teaching Space: 1	Student Space (24)	
B00F - R0003 - Withdrawal Space - 1hb - (5.44 SQM)	Student Space (2)	
B00F - R0004 - Home Base - (43.99 SQM) - Teaching Space: 1	Student Space (20)	
B00F - R0005 - Practical Activities - 1hb - (17.31 SQM)	Student Space (8)	
B00F - R0006 - Practical Activities - 1hb - (17.07 SQM)	Student Space (7)	
B00F - R0007 - Home Base - (43.38 SQM) - Teaching Space: 1	Student Space (20)	
B00G - R0001 - Home Base - (47.91 SQM) - Teaching Space: 1	Student Space (22)	
B00G - R0002 - Movement - (16.43 SQM)	Not Applicable	Circulation or storage space.

Entity Location	Audit Condition Classification (Capacity)	Comment
B00G - R0003 - Staff Room Annexe - (8.09 SQM)	Office (2)	
B00G - R0008 - Withdrawal Space - 1hb - (11.24 SQM)	Student Space (5)	
B00G - R0009 - Movement - (50.83 SQM)	Not Applicable	Circulation or storage space.
B00G - R0010 - Home Base - (48.03 SQM) - Teaching Space: 1	Student Space (22)	
B00G - R1001 - Home Base - (48.32 SQM) - Teaching Space: 1	Student Space (22)	
B00G - R1002 - Practical Activities - 1hb - (24.34 SQM)	Student Space (11)	
B00G - R1003 - Movement - (12.9 SQM)	Not Applicable	Circulation or storage space.
B00G - R1005 - Withdrawal Space - 1hb - (13.79 SQM)	Student Space (6)	
B00G - R1006 - Home Base - (47.98 SQM) - Teaching Space: 1	Student Space (22)	
B00H - R0005 - Canteen - (45.16 SQM)	Not Applicable	Circulation or storage space.
B00H - R0008 - Communal Space - (186.12 SQM)	Student Space (86)	
B00H - R0009 - Movement - (31.64 SQM)	Not Applicable	Circulation or storage space.
B00H - R0012 - Raised Platform - (54.8 SQM)	Not Applicable	Circulation or storage space.
B00H - R0018 - Movement - (5.88 SQM)	Not Applicable	Circulation or storage space.
B00H - R0020 - Movement - (6.37 SQM)	Not Applicable	Circulation or storage space.
B00L - R0001 - Clerical Office - (15.26 SQM)	Office (3)	
B00L - R0002 - Tutorial Centre - (25.63 SQM)	Student Space (11)	
B00L - R0003 - Clerical Office - (11.92 SQM)	Office (2)	
B00L - R0005 - Duplicating Workroom - (7.3 SQM)	Office (1)	
B00L - R0010 - Clerical Office - (9.1 SQM)	Office (2)	
B00L - R0011 - Entry Vestibule - (8.15 SQM)	Not Applicable	Circulation or storage space.
B00L - R0013 - Movement - (18.59 SQM)	Not Applicable	Circulation or storage space.
B00N - R0002 - Practical Activities - (19.14 SQM)	Student Space (8)	
B00N - R0004 - Home Base - (60.57 SQM) - Teaching Space: 1	Student Space (28)	
B00N - R0005 - Withdrawal Space - 2hb - (11.66 SQM)	Student Space (5)	
B00N - R0006 - Home Base - (60.57 SQM) - Teaching Space: 1	Student Space (28)	
B00N - R0008 - Practical Activities - (18.31 SQM)	Student Space (8)	
B00N - R0010 - Home Base - P - (67.86 SQM) - Teaching Space: 1	Student Space (31)	
B00N - R0012 - Practical Activities - P - 2hb - (38.04 SQM)	Student Space (17)	
B00N - R0017 - Home Base - P - (67.79 SQM) - Teaching Space: 1	Student Space (31)	
BOC1 - R0004 - Home Base - (97.41 SQM) - Teaching Space: 1	Student Space (45)	
BOC1 - R0005 - Home Base - (97.42 SQM) - Teaching Space: 1	Student Space (45)	
BOC3 - R0001 - Movement - (6.67 SQM)	Not Applicable	Circulation or storage space.
BOC3 - R0004 - Home Base - (57.31 SQM) - Teaching Space: 1	Student Space (26)	